

USER MANUAL

Jump Starter Q6



Important Safety Instructions

EN



PLEASE READ AND UNDERSTAND PRODUCT SAFETY INFORMATION BEFORE USE.

Failure to follow the instructions may result in ELECTRICAL SHOCK, EXPLOSION, OR FIRE, which may result in SERIOUS INJURY, DEATH, DAMAGE TO DEVICE or PROPERTY. Do not discard this information.

This manual contains important safety operating instructions for the jump starter. If damages are caused by failure to follow the instruction, the warranty does not apply.

1. Keep the product in a place free from exposure to any liquid or corrosive materials.
2. Use of an attachment not recommended or sold by the manufacturer may result in a risk of fire, electric shock, or injury to persons.
3. Do not operate this product if it has received a sharp blow, been dropped, or otherwise damaged in any way. Take it to a qualified service person.
4. Do not disassemble this product. Take it to a qualified service person when service or repair is required. Incorrect reassembly may result in electric shock or fire risk.
5. To reduce the risk of electric shock, unplug this product before attempting any maintenance or cleaning. Turning off controls will not reduce this risk.
6. Avoid long exposure to direct sunlight which may cause damage to the device.
7. Exposing this product to open flames may cause it to explode.
8. If the battery is swollen, leaking liquid or smells bad, discard it immediately.
9. Make sure the battery connector is clean, and battery clamp and cables are kept intact before using the product.
10. Make sure the battery clamp is fully plugged in, or it may affect functions and cause damage to the product.

What Is Included



Jump Starter Q6



Jumper Cables

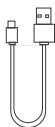

USB A to USB C
Cable



Wall Adapter



User Manual

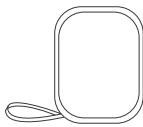

Portable Bag

Features

Powerful 1600A Peak Current

Capacity 16000mAh

Smart Jumper Cables

Dual USB-A Output Ports

Emergency LED Flashlight

Jump Start Vehicles



Gas 7.2L



Motorcycle12V



Yacht



Diesel 5.5L



Pick-up Truck



Lawn Mower

At A Glance

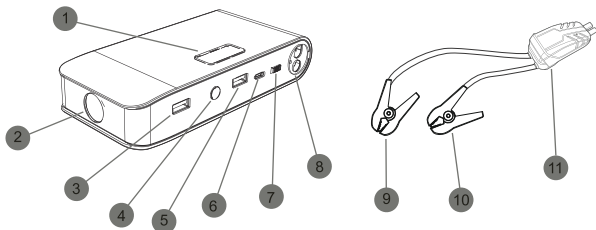

1. LCD Display
2. LED Light
3. Output 2 QC3.0
4. LED Light Button
5. Output 1 USB-A
6. Type C Input Port

7. Power Button
8. Jump Starting Port
9. Red Jumper Clamp
10. Black Jumper Clamp
11. Smart Clamp Plug

Jump Starting Your Car

1. Turn on your jump starter and make sure it is over 50% charged (Note: Push the power button to ON, and then press the LED button, which you could check the battery level)

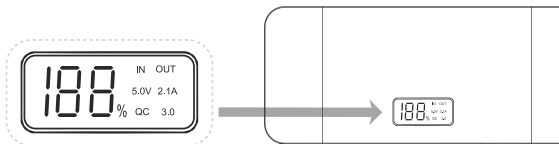

2. Insert jumper cables into jumping port, the cable indicator the red/green light flashes alternately

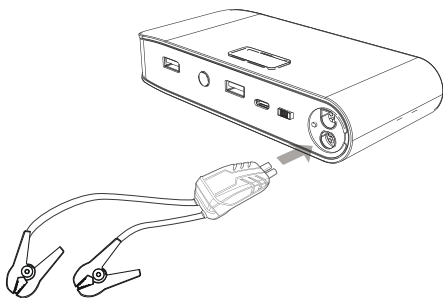

3. Connect red clamp to positive (+) terminal and black clamp to negative (-) of the car battery. The indicator light will turn green. If do not turn green, please follow the Mandatory start steps.

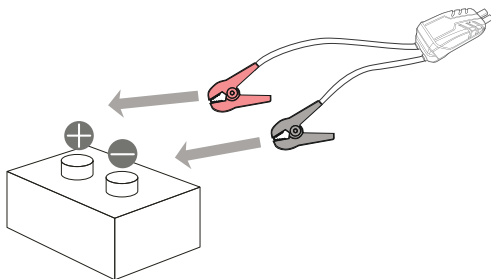

4. Start your car

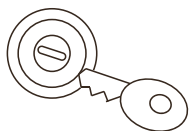

5. After successfully jump starting, promptly remove clamps from the car battery and put it in the storage bag.

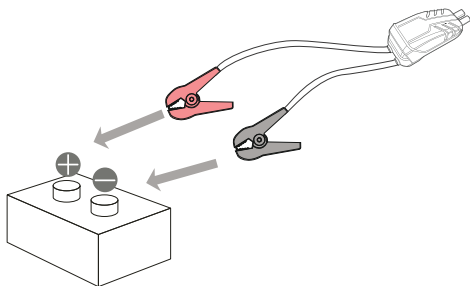

Tip: RST- Force Start Button

If you fail to jump start the car with normal steps, then please follow the mandatory start step to try again.

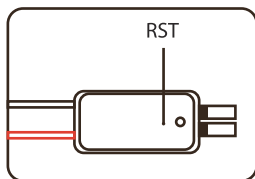

Mandatory start steps



1. Remove black clamp

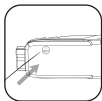

2. Please press "RST" button with needles until turn it green



3. Connect red clamp to "+" end and black clamp to "-" end of car battery (Don't reverse!)



4. Start the car
(if it fails, go back to step1)



5. Remove black clamp
Remove red clamp

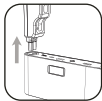

6. Pack away

LED Indicator Guide

LED Indicator of Jumper Cables	Situations
Solid red light	Detect the battery voltage is too low or too high. Check that the jumper starter has enough power
The red/green light flashes alternately	Ready to work
Solid red light with a long beep	Short cuirt. Please disconnect the cables from the battery
Solid red light with short beeps	Clamps connect wrong Make sure that the red clamp connects to positive (+) terminal and black clamp to negative (-) of the car battery.
After solid green light, the solid red light shows up	Fail to jump start the car within 30s. Please disconnect the cables from the battery and wait for 30s to reconnect.

Using The Flashlight

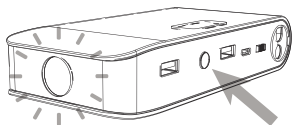
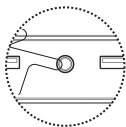

- Long press for 3s, flashlight on
- Press again, Strobe light on
- Press again, SOS light on
- Press again to turn light off

Technical Specifications

Model No.	Q6
Capacity	16000mAh
Starting Current	800A
Peak Current	1600A
Input	5V/3A
USB Output	QC3.0: 5V/9V 2A; USB-A Port: 5V/2.1A
Compatible Vehicle Type	Up to 7.2L Gas or 5.5L Diesel Engine
Starting Voltage	12V
Working Temperature	-20°C~65°C/-4°F~149°F

Trouble Shooting

Issue	Cause	Solutions
Cannot jump start	Clamps connect wrong.	Make sure that the red clamp connects to positive (+) terminal and black clamp to negative (-) of the car battery.
	30-Second timer to jump start has expired.	Jump starter timed out. Disconnect the cables from the battery and reconnect.
	Low battery status	Recharge the jump starter via USB cable until it has at least 3 solid lights.
Flashlight is not working	Low battery	Recharge the jump starter via USB cable.
No indicator light	Low battery	Please recharge the jump starter via USB cable.
	Power bank is in off mode.	Press the power on/off button to start the power bank mode.

Customer Service

QUESTIONS? WE ARE HERE TO HELP!

Thank you so much for choosing our jump starter! We're committed to providing the most professional and safe jump starter to customers around the world. If you encounter any problems while using the product, please don't hesitate to contact us.

Notice



This product complies with the radio interference requirements of the European community. This product can be used across EU member states.



This product is designed and manufactured with high quality materials and components, which can be recycled and reused.



This symbol means the product must not be discarded as household waste, and should be delivered to an appropriate collection facility for recycling. Proper disposal and recycling helps protect natural resources, human health and the environment. For more information on disposal and recycling of this product, contact your local municipality, disposal service, or the shop where you bought this product.

FCC Statement

This device complies with Part 15 of the FCC Rules. The operation is subject to the following two conditions: (1) This device may not cause harmful interference, and (2) this device must accept any interference received, including interference that may cause undesired operation.

Warning: Changes or modifications not expressly approved by the party responsible for compliance could void the user's authority to operate the equipment.

RoHS Statement

This product gets RoHS certified. The RoHS stands for Restriction of Hazardous Substances. RoHS, also known as Directive 2002/95/EC, originated in the European Union and restricts the use of specific hazardous materials found in electrical and electronic products.

ISO9001 Statement

This product is produced from an ISO 9001 certified manufacturer. An ISO 9001 quality management system is a systematic and process driven approach to managing your business. It is designed to support the company in ensuring you meet the needs of your customers, whilst delivering a consistent level of quality and satisfaction.

Contact us

Email: service@ibookoo.com
hongquan2022@outlook.com