

# ANYKIT

## 12-INCH CORDLESS SNOW SHOVEL

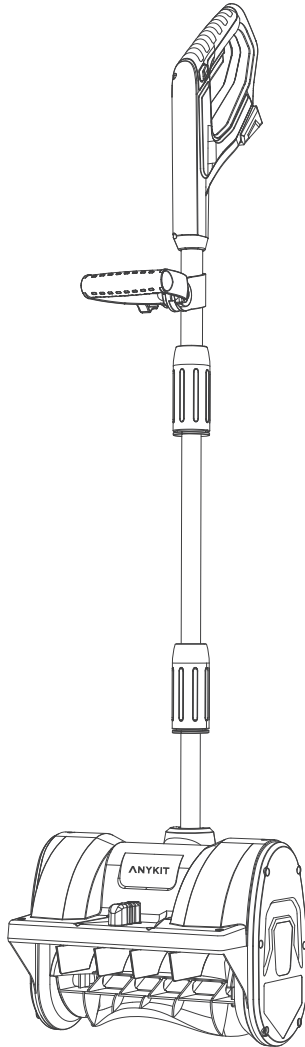

Model No.: ASYSN0330020



# TABLE OF CONTENTS

<b>ABOUT ANYKIT .....</b>	<b>01</b>
<b>READ BEFORE USE .....</b>	<b>02</b>
<b>SAFETY INSTRUCTIONS .....</b>	<b>03</b>
<b>SYMBOLS .....</b>	<b>10</b>
<b>PRODUCT DESCRIPTIONS .....</b>	<b>11</b>
<b>SPECIFICATIONS .....</b>	<b>11</b>
<b>OPERATING INSTRUCTIONS .....</b>	<b>12</b>
<b>CHARGING THE BATTERY PACK .....</b>	<b>17</b>
<b>TROUBLESHOOTING .....</b>	<b>18</b>
<b>MAINTENANCE AND TRANSPORTATION .....</b>	<b>19</b>
<b>WARRANTY .....</b>	<b>21</b>
<b>CUSTOMER SUPPORT .....</b>	<b>22</b>



## ABOUT ANYKIT

# ANYKIT

ANYKIT is passionate about designing tools to solve problems and make life easier. We focus on simplicity and ease of use, providing people with convenience in their everyday lives. Our goal is to enable DIY enthusiasts to embrace creativity and convenience.



**Follow Anykit on Amazon for More**

## READ BEFORE USE

By using this product, you signify that you have read, understood, and accept the terms and conditions here.

### **Read the following documents before using.**

- (1) Safety Guidelines
- (2) Quick Start Guide
- (3) User Manual

It is recommended to watch all tutorial videos on the official Anykit website and read the safety guidelines before use.

Prepare by reviewing the quick start guide and refer to this user manual for more information.

### **Video Tutorials**

Scan the QR code to watch the ASYSN0330020 tutorial videos, which demonstrate how to use the ASYSN0330020 safely.



### **ONLINE MANUAL**

Scan this QR code to get the manual in PDF, which can be enlarged and viewed on your mobile device.



# SAFETY INSTRUCTIONS

## ■ General Power Tool Safety Warnings

### ⚠ WARNING

Read all safety warnings, instructions, illustrations, and specifications provided with this power tool. Failure to follow all instructions listed below may result in electric shock, fire, and/or serious injury.

Save all warnings and instructions for future reference. The term "power tool" in the warnings refers to your mains-operated (corded) power tool or battery-operated (cordless) power tool.

## ■ Work Area Safety

- Keep work area clean and well lit. Cluttered or dark areas invite accidents.
- Do not operate power tools in explosive atmospheres, such as in the presence of flammable liquids, gases, or dust. Power tools create sparks that may ignite the dust or fumes.
- Keep children and bystanders away while operating a power tool. Distractions can cause you to lose control.

## ■ Electrical Safety

Power tool plugs must match the outlet. Never modify the plug in any way. Do not use any adapter plugs with earthed (grounded) power tools. Unmodified plugs and matching outlets will reduce risk of electric shock.

- Avoid body contact with earthed or grounded surfaces, such as pipes, radiators, ranges, and refrigerators. There is an increased risk of electric shock if your body is earthed or grounded.
- Do not expose power tools to rain or wet conditions. Water entering a power tool will increase the risk of electric shock.
- Do not abuse the cord. Never use the cord for carrying, pulling, or unplugging the power tool. Keep the cord away from heat, oil, sharp edges, or moving parts. Damaged or entangled cords

increase the risk of electric shock.

- When operating a power tool outdoors, use an extension cord suitable for outdoor use. Using a cord suitable for outdoor use reduces the risk of electric shock.
- If operating a power tool in a damp location is unavoidable, use a residual current device (RCD) protected supply. Using an RCD reduces the risk of electric shock.

## ■ Personal Safety

- Stay alert and watch what you are doing when operating a power tool. Do not use a power tool while you are tired or under the influence of drugs, alcohol, or medication. A moment of inattention while operating power tools may result in serious personal injury.
- Use personal protective equipment. Always wear eye protection. Protective equipment such as a dust mask, nonskid safety shoes, hard hat, or hearing protection used for appropriate conditions will reduce personal injuries.
- Prevent unintentional starting. Ensure that the switch is in the off position before connecting to the power source and/or battery pack, picking up, or carrying the tool. Carrying power tools with your finger on the switch or energising power tools that have the switch on invites accidents.
- Remove any adjusting key or wrench before turning the power tool on. A wrench or a key left attached to a rotating part of the power tool may result in personal injury.
- Do not overreach. Keep proper footing and balance at all times. This enables better control of the power tool in unexpected situations.
- Do not wear loose clothing or jewelry when operating. Keep your hair and clothing away from moving parts.
- If devices are provided for the connection of dust extraction and collection facilities, ensure that they are connected and properly used. Use of dust collection can reduce dust-related hazards.
- Do not let familiarity gained from frequent use of tools allow you to become complacent and ignore tool safety principles. A

careless action can cause severe injury within a fraction of a second.

## ■ For All Snow Shovels

- Walk. Do not run.
- Do not use on gravel surfaces unless the snow shovel is adjusted for such surfaces in accordance with the operating manual.
- Keep children away—All visitors should be kept a safe distance from the work area.
- Dress properly—Do not wear loose clothing or jewelry; they can be caught in moving parts.
- Wear rubber boots when operating the snow shovel.
- Keep hands away from moving parts.
- Keep guards in place and in working order.
- Do not force the snow shovel—it will perform better and safer at the rate for which it was designed.
- Do not overreach—Keep proper footing and balance at all times.
- If the snow shovel strikes a foreign object, follow these steps:
  - 1) Stop the snow shovel. Release the switch.
  - 2) Remove the battery pack.
  - 3) Inspect for damage.
  - 4) Repair any damage before restarting and operating the snow shovel.
- When not in use, the snow shovel should be stored indoors in a dry, locked-up place, out of reach of children.

## ■ Battery Tool Use and Care

- Recharge only with the charger specified by the manufacturer. A charger that is suitable for one type of battery pack may create a fire risk when used with another battery pack.
- Only use power tools with specifically designated battery packs. Use of any other battery packs may create a risk of injury or fire.
- When the battery pack is not in use, keep it away from other metal objects like paper clips, coins, keys, nails, screws, or other small metal objects that can make a connection from one terminal

to another. Shorting the battery terminals together may cause burns or a fire.

- Under abusive conditions, liquid may be ejected from the battery avoid contact. If contact accidentally occurs, flush with water. If liquid contacts eyes, seek medical help. Liquid ejected from the battery may cause irritation or burns.
- Do not use a battery pack or tool that is damaged or modified. Damaged or modified batteries may exhibit unpredictable behavior, resulting in fire, explosion, or the risk of injury.
- Do not expose a battery pack or tool to fire or excessive temperature. Exposure to fire or temperatures above 266°F may cause explosions.
- Follow all charging instructions and do not charge the battery pack or tool outside the temperature range specified in the instructions. Charging improperly or at temperatures outside the specified range may damage the battery and increase the risk of fire.

## **Battery Pack and Charger Safety Instructions**

-  If under extreme conditions and any electrolyte should escape from the battery, avoid contact with skin. If electrolytes come into contact with your skin, rinse them off with water. In the event of electrolyte contact with your eyes, it's essential to consult a doctor.
- Before using the charger and battery pack, read the instruction manual carefully.
- During the charging process, the current should match the specifications of the battery charger.
- Never let moisture, rain, or splashed water reach the charging location. The ambient temperature must not be less than 32°F or exceed 104°F during charging. Do not use or store snow shovels or batteries at temperatures above 120°F.
- Battery packs that are defective, damaged, or no longer rechargeable must be disposed of as hazardous waste. Hand them over at a designated collection point. Do not throw unusable battery packs into domestic waste, fire, or water.
- If the electrical cable is damaged, it must be replaced only by

the supplier or their repair workshop. Have repairs carried out only by an authorized specialist.

- Use only battery packs produced by the original manufacturer. Use only the charger supplied with your electric snow shovel.
- Always keep the surface of the charger free from dust and dirt.
- Insert the battery pack into the charger and follow the guidelines provided concerning polarity.
- Always remove the battery pack before working on the electric snow shovel.
- When the battery pack is outside the electric snow shovel, cover the contacts to avoid short circuits (e.g. from tools or metal surfaces).
- Do not throw battery packs into water or fire, as there is a risk of explosion!
- Protect the battery pack from impact and do not attempt to open it.
- Never discharge the battery pack completely, and recharge it occasionally if not used for a prolonged period.

 You should only use batteries with the specified configurations for charging. Other types of batteries may burst, causing personal injury or damage. It is recommended that the charger always be supplied via a residual current device with a rated current of 30 mA or less.

## **WARNING**

When using the product, the safety rules must be followed. For your own safety and that of bystanders, read these instructions before operating the product. Keep the instructions for later use.

## **Training**

- Read the instructions carefully. Be familiar with the controls and the proper use of the product.
- Never allow children to operate the equipment. Never allow adults to operate the equipment without proper instruction.

- Keep the area of operation clear of all persons, particularly small children.
- Exercise caution to avoid slipping or falling, especially when operating the snow shovel in reverse.

## **■ Preparation**

- Never operate the product while people, especially children or pets, are nearby.
- Wear eye protection, stout shoes, and long trousers at all times.
- Before use, always perform a visual inspection of the machine for damaged, missing, or misplaced guards or shields.

## **■ Operation**

- Prevent unintentional starting. Ensure the switch is in the off position before connecting to the battery pack, picking up, or carrying the appliance.
- Carrying the appliance with your finger on the switch or energizing the appliance that has the switch on invites accidents.
- Do not put hands or feet near or under rotating parts.
- Exercise extreme caution when operating on or crossing gravel driveways, walkways, or roads. Stay alert for hidden hazards or traffic.
- After striking a foreign object, stop the motor, remove the battery pack, thoroughly inspect the snow shovel attachment for any damage, and repair the damage before restarting and operating the snow shovel.
- If the tool should start to vibrate abnormally, stop the tool and check immediately for the cause. Vibration is generally a warning of trouble.
- Stop the tool whenever you leave the operating position, before unclogging the auger assembly housing, and when making any repairs, adjustments, or inspections.
- When clearing, repairing, or inspecting the snow shovel, stop the tool and make certain the auger assembly has stopped. Remove the battery pack to prevent someone from accidentally











starting the tool.

- Exercise extreme caution when operating on slopes.
- Never direct the discharge toward people or areas where property damage can occur. Keep children and others away.
- Do not overload the machine capacity by attempting to clear snow at too fast a rate.
- Disengage power when the snow shovel is transported or not in use.
- Never operate the snow shovel without adequate visibility or light. Always be sure of your footing and keep a firm hold on the handles. Walk, never run.
- Do not expose a battery pack or tool to fire or excessive temperature.

## **Service**

- Have your power tool serviced by a qualified repair person using only identical replacement parts. This will ensure that the safety of the power tool is maintained.
- Never service damaged battery packs. Service of battery packs should only be performed by the manufacturer or authorized service providers.

# SYMBOLS

	Indicates a potential personal injury hazard
	To reduce the risk of injury, user must read and understand operator's manual before using this product
	Risk of fire and burns. Do not expose battery, battery compartment, or electronic components to rain, water, or liquids
	Always wear safety goggles or safety glasses with side shields when operating this product that comply with ANSI Z87.1
	Keep bystanders a safe distance from the machine
	Do not use hands to unclog the auger assembly
	Keep feet away from rotating impeller
	To reduce the risk of injury, keep hands and feet away from rotating parts. Do not operate unless the discharge chute is in its proper place. If damaged, replace it immediately
	Thrown objects can ricochet and result in personal injury or property damage
	This product uses lithium-ion (Li-ion) batteries. Local, state, or federal laws may prohibit disposal of batteries in ordinary trash. Consult your local waste authority for information regarding available recycling and/or disposal options
	Type or characteristic of current
$n_0$	Rotational speed at no load
RPM	Rotational speed
V	Voltage

Hz	Frequency (cycles per second)
min	Time

## PRODUCT DESCRIPTIONS

### Description

Read this operating manual and safety rules before operating your snow shovel. Save this manual for future reference.

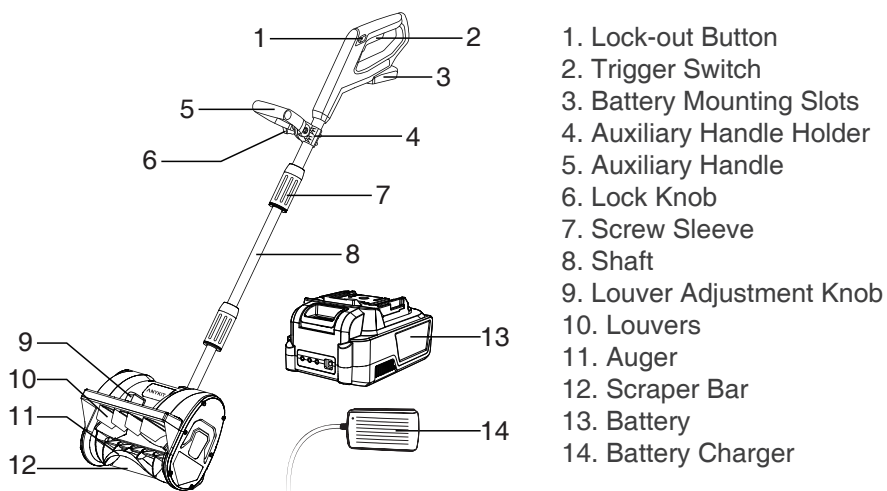

## SPECIFICATIONS

Model No.	ASYSN0330020
Rated voltage	DC 20V
Clearing width	12 in/305 mm
Maximum snow intake height	6 in/152 mm
Maximum throwing distance	20 ft/6 m
Battery type	Lithium-ion

Battery voltage	DC 20V $\overline{=}$
Battery capacity	4.0 Ah
Charger input	AC100-240V~60Hz65W
Charger output	21V $\overline{=}$ 1.5A
Charging time 4Ah battery	172 minutes
Working Environment	-4°F - 104°F / -20°C - 40°C (< 80% rh)
Charging Temperature	32°F - 104°F / 0°C - 40°C (< 80% rh)
Storage Conditions	14°F - 122°F / -10°C - 50°C (< 80% rh)

## OPERATING INSTRUCTIONS

### ■ Applications

This snow shovel is ideal for clearing snow from sidewalks, steps, decks, patios, and smaller driveways. The best clearing depth for this snow shovel is under 4 inches (10 cm).

### ■ Assembly and Adjustment

#### ⚠ WARNING

Before assembly, make sure that the appliance is switched off and the battery has been removed.

### ■ Connecting the Shaft

#### ⚠ WARNING

Be certain that the wing knob is fully tightened before operating the equipment; check it periodically for tightness during use to avoid serious personal injury.

1. Pull the snow shovel shaft out from the screw sleeve.
2. Align the arrow on the snow shovel shaft with the arrow on the coupler and push the snow shovel shaft into the coupler.

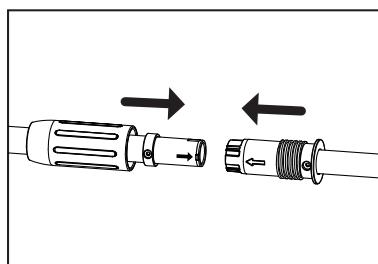

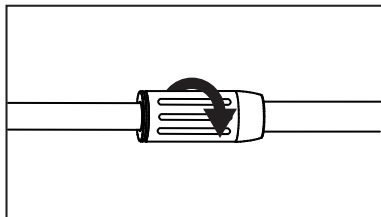

3. Tighten the screw sleeve securely.

### **⚠ WARNING**

If the two arrows do not match, the electrical connection cannot be connected, and the snow shovel will not work.

### **⚠ WARNING**

These three shafts should not be used until they are properly assembled during use to avoid serious personal injury.

## **■ Mounting the Auxiliary Handle**

1. Remove the lock knob from the auxiliary handle.

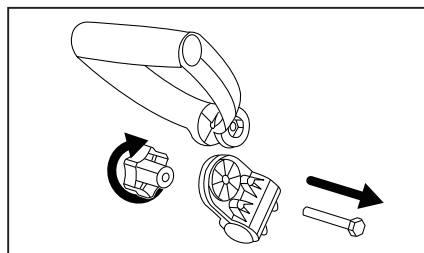
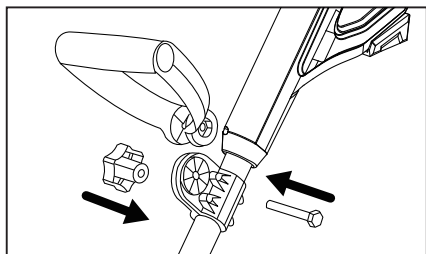

2. Set the auxiliary handle on the holder and put the bolt through the holes.

3. Adjust the auxiliary handle to a comfortable angle and tighten the lock knob.

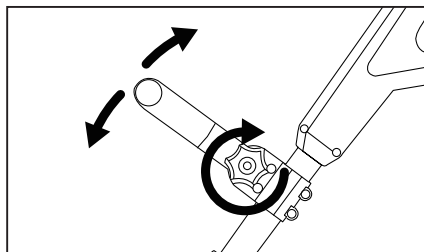

## ■ Adjusting the Auxiliary Handle Position

Loosen the lock knob, raise or lower the auxiliary handle to the desired position, and then tighten the lock knob.

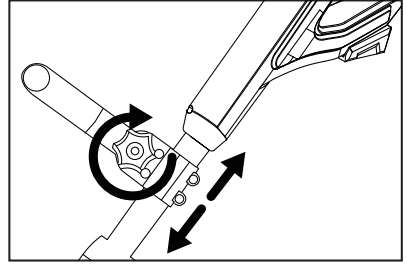

## ■ To Install/Remove the Battery Pack

### ⚠ WARNING

Always remove the battery pack from the product when you are assembling parts, making adjustments cleaning, or when it is not in use.

Removing the battery pack will prevent accidental starting that could cause serious personal injury.

**NOTE:** Fully charge the battery pack before first use.

## ■ To Install the Battery Pack

1. Align the ribs of the battery pack with the battery mounting slots in the snow shovel.

2. Slide the battery pack in until it snaps into position.

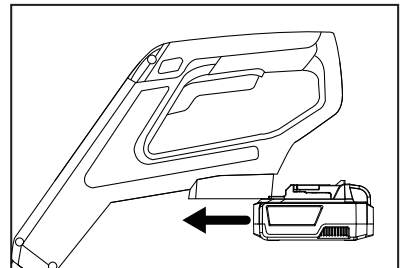

## ■ To Remove the Battery Pack

### ⚠ WARNING

Always be aware of the location of your feet, children, or pets around you when pressing the battery release button.

Never remove the battery pack from a high position. Serious injury could result if the battery pack falls.

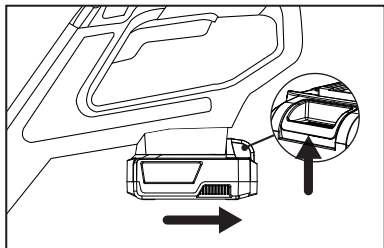

1. Hold the battery pack in the palm of your hand.
2. Press the battery-release button with your thumb; the battery pack will disengage from the latch.
3. Grasp the battery pack and remove it from the snow shovel.

## ■ Starting the Snow Shovel

### ⚠ WARNING

In order to avoid serious injury, the operator and unit must be in a stable position when starting the snow shovel.

**Step 1:** Verify that the battery pack is inserted into the battery compartment.

**Step 2:** Press and hold the lock-out button.

**Step 3:** While holding the lock-out button, press and hold the trigger switch.

**NOTICE:** The motor starts only when the lock-off button is pressed forward and the trigger switch is depressed at the same time.

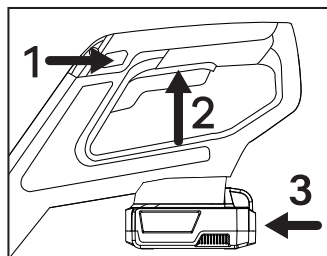

## ■ Stopping the Snow Shovel

Move the snow shovel away from the clearing area and release the trigger switch to stop the tool.

If the machine is stopped before removing the snow shovel from the clearing area, snow will accumulate and freeze in the snow removal blade, which can cause damage to the snow shovel.

### ⚠ WARNING

Always remove the battery pack from the snow shovel during work breaks and after finishing work.

## ■ Adjust the Direction of the Snow Discharge

To adjust the direction of the snow discharge, rotate the louver

adjustment knob. There are three directions to choose from: left, straight ahead, or right. The knob can be turned up to a maximum of 60°, which means you can adjust it up to 30° to the left or right.

Make sure to adjust the direction of the snow discharge before starting the machine to ensure safe and efficient operation.

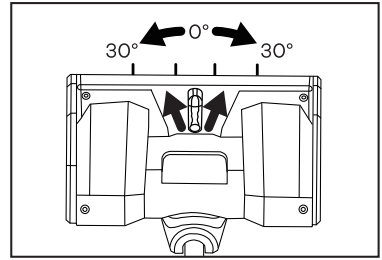

## ■ Using the Snow Shovel

### ⚠ WARNING

Always use proper eye protection that conforms to ANSI Z87.1 (CAN/CSA Z94.3) while operating this appliance.

### ⚠ WARNING

Never use the snow shovel on a rooftop, frozen lake, ice, or other unstable surfaces, which can result in death or serious injury.

### ⚠ WARNING

Make sure that the area to be cleared is free of stones, sticks, wires, gravel, and other objects that could be accidentally thrown by the snow shovel in any direction and cause serious personal injury to the operator and others.

### ⚠ WARNING

To prevent serious personal injury, remove the battery pack from the tool before servicing, cleaning, changing attachments, or removing material from the tool.

### ⚠ WARNING

**Do not immerse the battery pack in snow, water, or other liquids at any time. Battery packs are not waterproof.**

- Start the snow shovel by following the starting instructions. Push

the snow shovel forward after 3 to 5 seconds so that it rides on the scraper. The depth and weight of the snow will determine the forward speed. Do not push too hard.

- When using the snow shovel, hold the tool with a firm grip with both hands while in operation.
- Take notice of the direction of the wind before beginning. When possible, discharge snow in the same direction as the wind to prevent snow from being thrown back into your face.
- Some parts of the snow shovel may freeze under extreme weather conditions. Do not attempt to operate the tool with frozen parts.
- If the tool contacts any type of obstruction during operation, stop it and remove the battery pack. Check the tool carefully before using it.
- If the snow is too thick and deeper than the clearing depth, it may take more than one pass to clear.
- When finished, allow the tool to run for several minutes to clear all snow from the auger before storing.

## CHARGING THE BATTERY PACK

If the snow shovel stops repeatedly, check the remaining battery and charge the battery pack.

### Indicating the remaining battery (on battery pack)

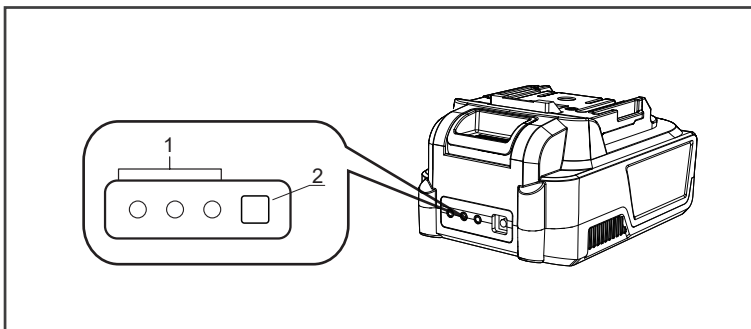

1. Indicator Lights 2. Check Button

Press the check button on the battery cartridge to indicate the battery charge level. The indicator lights illuminate for a few seconds.

Indicator Lights		Remaining Capacity
● Illuminated	○ Off	
● ● ●		66% to 100%
● ● ○		33% to 66%
● ○ ○		0% to 33%

When battery is low, charge the battery pack with the charger.

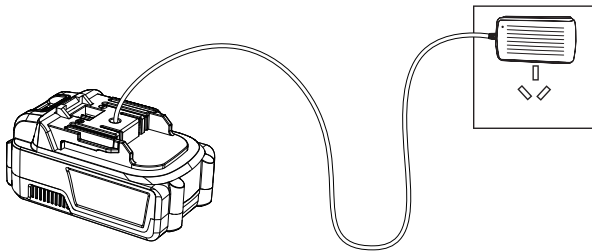

#### Charger Light Indicator

<b>Red Light</b>	Charging	<b>Green Light</b>	Fully Charged
------------------	----------	--------------------	---------------

## TROUBLESHOOTING

Problem	Possible Causes	Solution
The snow shovel does not start	Battery is not secure	To secure the battery pack, make sure the latches on the top of the battery pack snap into place
	Battery has low power capacity	Charge the battery pack according to the instructions

The snow shovel leaves a thin layer	The scraper bar is worn	Please contact our customer service team: info@anykit.com
Unexpected shutdown during work. No snow is thrown from the deck	Machine is overloaded. The auger is completely jammed by the heavy snow	Remove the snow from the auger and reduce the machine load intensity
	The battery pack or the machine has overheated	Allow the battery and/or tool to cool down before resuming work
Battery can not be charged after use	The battery pack has overheated	Allow the battery to cool down before charge

## MAINTENANCE AND TRANSPORTATION

### Cleaning and Maintenance

#### WARNING

All maintenance should be carried out by a qualified person; do not attempt to repair any defects yourself. When servicing, use only identical replacement parts. The use of any other parts may create a hazard or cause product damage.

### Cleaning

#### Clearing a Clogged Rotor Housing

Hand contact with the rotating rotor blades inside the rotor housing is the most common cause of injury associated with cordless snow shovels. Never use your hands to clear a clogged rotor housing.

#### To clear the rotor housing:

- Shut the motor off and remove the battery.
- Wait 10 seconds to be sure the rotor blades have come to a complete stop.

- Always use a clean-out tool, not your hands, to free the rotating blades.
- Wipe off any moisture using a soft cloth.

**NOTE:** Do not use strong detergents.

Household cleaners that contain aromatic oils such as pine and lemon, and solvents such as kerosene can damage the plastic housing and handles.

## ■ Storage

1. Remove the battery pack.
2. Clean the product and re-pack in original package.
3. Store the product and its accessories in a dark, dry, frost-free, well-ventilated place.
4. Always store the product in a place that is inaccessible to children.
5. We recommend using the original package for storage or covering the product with a cloth or enclosure to protect it from dust.
6. The battery must to be charged to more than 66% before storage
7. The battery pack needs to be recharged within 3-6 months of storage to avoid over-discharge, which can cause the battery pack to be unable to charge and use.
8. Do not fully charge the battery before storage, as this can cause dangerous situations such as battery swelling and fire.

## ■ Transportation

1. Remove the battery pack.
2. Re-pack in original package.
3. Protect the product from any heavy impact or strong vibrations which may occur during transportation in vehicles.
4. Secure the product to prevent it from slipping or falling over.

## WARRANTY

<b>30-Day Guarantee</b>	We will give you a full refund if you are not satisfied with the product.
<b>One-Year Warranty</b>	We offer a limited warranty that begins on the purchase date of the product.

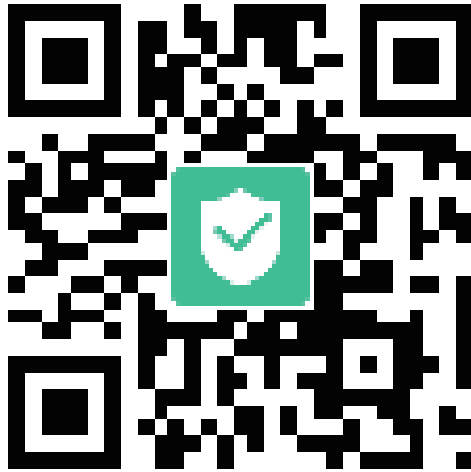

Visit [anykit.com](http://anykit.com) or scan the QR code for more details.

# CUSTOMER SUPPORT

If you have any questions or concerns about your product, please contact our Customer Support Team.



1-877-888-7979  
Mon-Fri 8am-5pm PST



[support@anykit.com](mailto:support@anykit.com)



[www.anykit.com](http://www.anykit.com)



[@anykit](https://twitter.com/anykit)



YouTube

[@anykit](https://www.youtube.com/anykit)



Facebook Messenger





© ANYKIT ASYSN0330020  
Designed by Anykit in California    Made in China