

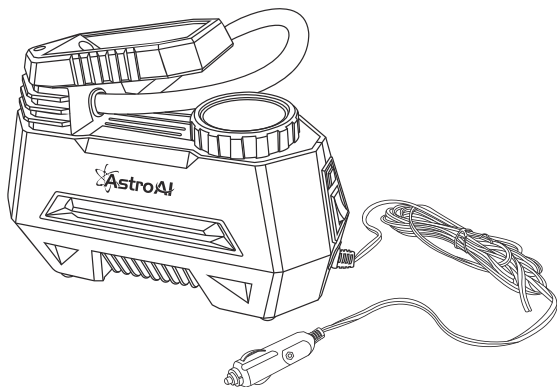

# 100PSI Portable Air Compressor User Manual



Thank you for purchasing the 100PSI Portable Air Compressor from AstroAI.

This product is a programmable Air Compressor Pump with digital display that is designed to be used to monitor air pressure while inflating. Once the pre-set air pressure is reached, the Air Compressor will automatically shut off.

For optimal performance and safety, please read and follow all of the instructions below before operating the device. Please keep this manual for future reference.

We hope you enjoy your new Air Compressor! Thank you again for choosing AstroAI, if you have any questions or concerns regarding your product, please contact us at [support@astroai.com](mailto:support@astroai.com).

## WARNING

- Please read the instructions carefully before use. Incorrect usage may damage the product.
- Check the preset pressure value before use. The preset pressure value should match the object to be inflated.
- PSI, KPA, Bar, KG/CM<sup>2</sup> are the pressure units, not the pressure levels.
- Please do not use this product in the rain or where there are any liquids.
- Keep out of reach of children, if there are children nearby make sure they are properly supervised.
- Keep the device away from fire, corrosive gases, liquids, and strong magnetic fields.
- Do not aim the nozzle at people or any part of a human body.
- Contains small accessories which are a choking hazard for young children.
- Risk of electric shock, do not use air compressor if it is damaged or if wires are exposed.
- Do not use it on a 24V car power. Connect the pump to a 12V DC, 10A cigarette lighter; Use an AC to DC power converter if you want to use AC power.
- Avoid extended and continuous use. The optimum time for continuous use is 15 minutes.
- After extended use, let the pump rest for 10 minutes before using it again.
- Do not store the air compressor in high-temperatures or in a humid environment.
- When not in use, disconnect the air compressor from all power sources.
- The air nozzle is compatible with all Schrader valves. For use with cars, small trucks and SUVs, motorcycles, and bicycles. The pump is not intended for use with high pressure or large volume applications.
- Do not over-inflate tires. High pressure air can cause injury.
- Move the product by using the handle. Do not drag the product by pulling the power cord or the air hose.

- During use, do not touch any parts of the air compressor apart from the switch and handle. The air pump gets hot during use and stays hot for some time after.
- Do not use chemical reagents to clean the air compressor. Only use mild soap and a cloth dipped in hot water to clean the plastic parts.

## DIAGRAM

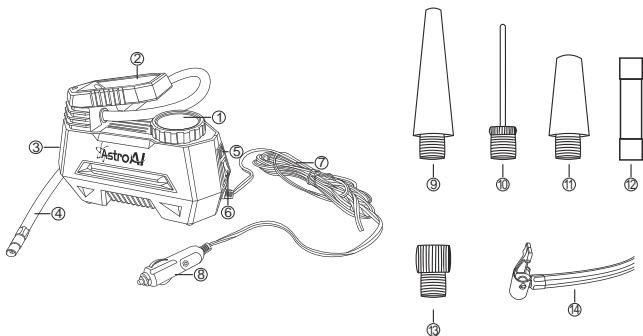

① Air Pressure Gauge

② Carrying Handle

③ LED Light

④ Inflation Tube

⑤ LED Light Switch

⑥ Inflation Switch

⑦ Power Cord

⑧ 12V Cigarette Lighter Plug

⑨ Long Cone Adapter

⑩ Needle Valve Adapter

⑪ Short Cone Adapter

⑫ Replacement Fuse

⑬ Valve Extender

⑭ Easy-Connect Schrader Valve Adapter

## OPERATION INSTRUCTIONS

- Ensure that your car engine is running before you use it.

- Plug the inflator pump into your car's 12V outlet securely, to ensure a strong connection.

- Use the "M" button to set your desired pressure unit (4 options: KPA, PSI, BAR, KG/CM<sup>2</sup>).

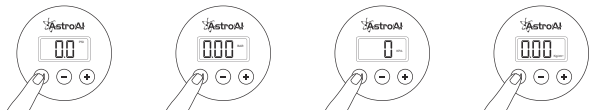

- Use the "+" and "-" buttons to set the chosen pressure. Use the tire pressure guide on the inside of the driver's door for guidance. Make sure that the preset pressure is higher than the current pressure of your tire.



- Remove the valve cap from the valve stem of your tire, then attach the air nozzle to the valve stem.

Tips: In order to get a strong seal, place the nozzle directly onto the tire valve. Putting the air chuck on the nozzle from an angle could result in an improper seal or inaccurate reading. Once the air chuck is placed, thread the nozzle to create a strong seal.

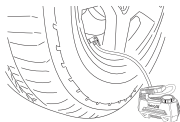

- Turn on pump with the power switch by pressing the inflation switch.



- After inflation is complete, turn off the inflation switch and disconnect the power cord from the 12V outlet, unscrew the valve connector, place the tire valve cap back on the valve stem.

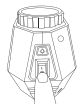

- The LED flashlight is controlled by the light switch. Press the button to switch on or off.

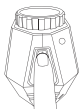

## SPECIFICATIONS

Working Voltage	DC 12V
Maximum Amps	10 Amps
Power	120W
Inflating Speed	1.23 CFM (35L/ Min)
Maximum Working Pressure	100 PSI
Display Units	KPA, PSI, BAR, KG/CM <sup>2</sup>
Continuous Operating Time	15 Minutes Maximum
Power Cable Length	10ft (3 m)
Dimensions	8.4*6.8*3.9in

## TROUBLESHOOTING //

Air Compressor will not inflate	<ul style="list-style-type: none"><li>● Ensure the in-line fuse is securely inserted correctly; replace fuse if necessary.</li><li>● Check vehicle cigarette lighter fuse, it should be rated at 10A or higher.</li><li>● Ensure there is a strong connection with the power cord and 12V socket.</li><li>● Preset tire pressure is lower than current tire pressure, increase the preset tire pressure to the manufacturer recommended level.</li></ul>
Air Compressor is operating abnormally	<ul style="list-style-type: none"><li>● The inflation nozzle is not connected properly to the tire's valve stem.</li><li>● The 12V socket is not connected securely.</li><li>● Preset tire pressure is lower than current tire pressure, increase the preset tire pressure to the manufacturer recommended level.</li></ul>
Air leaking through hose	<ul style="list-style-type: none"><li>● Ensure there is a firm connection between the air nozzle and the tire valve.</li></ul>
Slow inflation	<ul style="list-style-type: none"><li>● The inflation nozzle is not connected properly to the tire's valve stem.</li><li>● Excessive use will slow the inflation rate of the pump. Let cool for 10 minutes.</li></ul>
Shuts off after extended use	<ul style="list-style-type: none"><li>● If the air compressor continues to run for more than 15 minutes, it will shut off due to overheating protection. Please let it cool for 10 minutes.</li></ul>

## PRODUCT HIGHLIGHTS //

- Automatic Shut off: The air compressor automatically shuts off when the pre-set pressure value is reached.
- LCD Digital Display: Provides accurate measurements. It is easy to operate, read and understand.
- Longer Power Cord: The 10ft cable enables it to reach any part of the car easily.
- Portable Design: Easy to carry and store in a car.

## PACKAGE CONTENTS //

- 1 x AstroAI 12 Volt Air Compressor
- 1 x User Manual
- 1 x Inflation Needle
- 2 x Cone Inflation Adapters
- 1 x Schrader Valve Adapter
- 1 x Valve Extender
- 1 x Replacement Fuse

## 3 YEAR WARRANTY LIMITED WARRANTY FROM ASTROAI //

Each AstroAI Portable Air Compressor will be free from defects in its material and works. This warranty does not cover fuses and damage from neglect, misuse, contamination, alteration, accident, or abnormal conditions of usage or handling. This warranty covers the original purchaser only and is not transferable.

Questions or Concerns? We're happy to help! [support@astroAI.com](mailto:support@astroAI.com)