

CP-F56 (智能夹) 单色单面折页说明书-73*105mm-128G铜版印刷

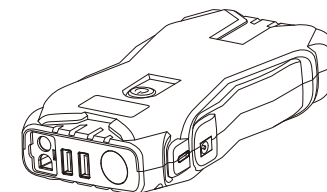

16000mAh Jump Starter



Model No.: J02
User Manual

USER MANUAL

Thank you for choosing the jump starter! Always follow basic safety precautions when using electrical appliances. Read all instructions carefully, please keep this instruction manual for easy reference.

A. PRODUCT LAYOUT:

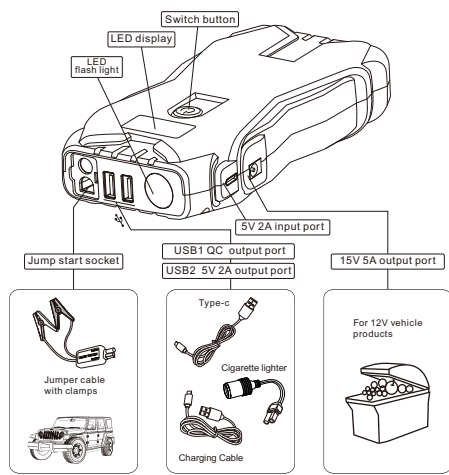

B. OPERATION GUIDANCE:

LED Display
Press the switch button to check the storage level of jump starter. On the screen, it shows the remaining power and activated output ports.
Different number displaying on screen shows different storage level of jump starter. The number will reach to 100% when the charging is completed.

Jump starter charging instruction:

1. Plug the Charging Cable to electronic devices with USB output.
 2. Connect 5V/2A input port of jump starter to charge.
- Or
1. Plug the car adaptor into the socket of cigarette lighter.
 2. Connect 5V/2A input port of jump starter to the other end of car adaptor.
- Note: Do not charge the jump starter unit immediately after starting engines, but at least 30 minutes later.**

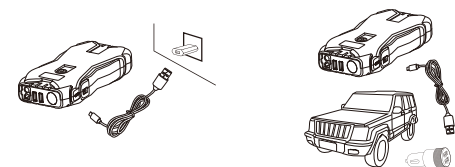

Jump start 12V vehicle instruction:

1. Make sure that the remaining of power is not less than 80%, fully charged is suggested.
2. Plug the cord of jumper cable into the jump start socket.
3. Connect the RED clamp to the vehicle's battery positive (+) terminal and connect the BLACK clamp to the vehicle's battery negative (-) terminal.
4. Start the vehicle, and interval time between each starting must be OVER 30s; if after 3 times failure, stop trying again; please check if there are problems of the vehicle engine or circuit, meanwhile, check the jump starter, if problem, please return it to the distributor.
5. When the vehicle is started, remove jumper cable from jump starter and disconnect red and black clamps to the vehicle battery terminals within 30 seconds.
6. Leave the vehicle's engine running.

Note:

1. This accessory is directly connected to the EC5 port, and the output current is very large (current above 500A), and there is no current protection circuit.
2. This accessory can only be used as an output port, and cannot be used as an input charging port, otherwise there is a risk of fire when charging the product battery.
3. When this accessory is used, it cannot be used as a long-term output port. When the product battery is lower than 12V, you cannot continue to use this port to continue output, otherwise the battery will be over-discharged and cause permanent damage.

Smart Cable Functions:

1. Low voltage protection
2. Reverse polarity protection with alarm
3. Short circuit protection
4. Reverse charge protection
5. Over charge and discharge protection.
6. Over-heating protection
7. Over current protection

- * Detecting: Green and Red LED flashing
- * Low voltage: Green LED off, Red LED solid
- * Ready to start: Green LED solid, Red LED off
- * Short circuit: Green LED off, Red LED solid, beeping
- * Reverse polarity: Green LED off, Red LED solid, discontinuous beeping
- * Reverse charge: Green LED off, Red LED solid, slow beeping
- * Over-heating: Green LED off, Red LED solid, fast beeping
- * Over current: Green and Red LED all solid
- * Timing protection (30 seconds): Green and Red LED all solid

Instructions:

1. Connect the smart cable to jump starter unit, if the "start" and "error" indicators will alternately flash with "green" and "red" lights, it proves the circuit normal. If only red light is on, it proves the voltage of the jump booster too low to start vehicle.
2. Correctly connect the smart cable to vehicles' battery terminals: positive (+) to positive (+), negative (-) to negative (-)
3. Smart cable will detect the circuit for 3", if the "start" indicator turns green, and "error" indicator turns off, then can start the vehicle (the green light will be on 30", if no start within 30", the smart cable will automatically shut down, and the green and red light all will be on at the same time. If want to start the vehicle again, should pull the smart cable out off the jump starter, and plug it into jump starter again.)

4. Start the vehicle; after the vehicle started, the "error" indicator will be red solid and beeping.
5. Immediately remove the smart cable from the vehicle battery terminals once vehicle started, and pull it from the jump starter unit.
6. If wrongly connect the smart cable to vehicles' battery terminals: positive (+) to negative (-), and negative (-) to positive (+), the circuit will be shut off immediately to protect the jump starter and vehicle; meanwhile the "error" indicator will be red solid and beeping.
7. Pull the smart cable out off the jump starter, and remove the clamps from the vehicle battery terminals, then repeat the right steps.

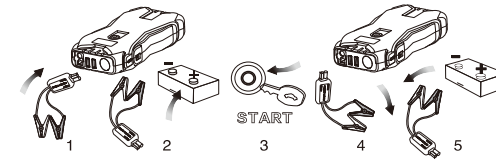

Charging cell phone or tablet instruction:

1. Plug the USB cable to USB 1 or USB 2 output port.
2. Select appropriate connector for your cell phone or pad.
3. Press the switch button to charge, the indicator will be on when the device is charging.

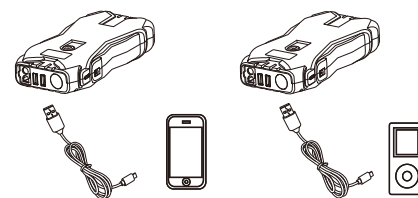

For power supply to 12V vehicle products or 12V electronics:

1. Plug the optional switch cable to 15V/5A output port.
2. Connect the optional switch cable and 12V vehicle products or 12V electronics.

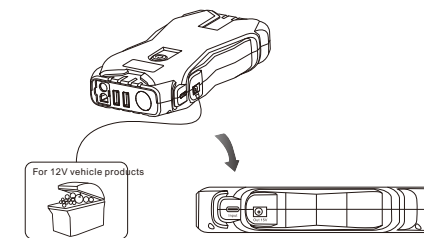

LED flash light:

Press and hold the switch button 3 seconds to start the LED light. There are 3 modes for LED light appear in order (illumination, strobe, SOS) if you press slightly.

D. TECHNICAL SPECIFICATIONS:

Size: 180*85*35mm
Weight: 395g
Input: 5V/2A
Output: 5V 2A; QC 5V/9V/12V; 12V/5A; 15V/5A; 12V jump start
Full charging time: approx 6.5h
Start current: 650A
Peak current: 1300A
Operation temp.: -20°C ~ 60°C / -4°F ~ 140°F
Protections: Short circuit proof, over charge protection and discharge protection
Lifetime: >1000 cycles

E. FAQ:

Q. How to turn off this appliance?
A. This appliance will power off automatically when no load is found or charging is completed.

Q. How many times can this appliance charge for my cell phone?
A. 4 times for iPhone mobile phone.

Q. How long will this appliance take to charge my mobile phone full?
A. Approx. 1 hour.

Q. How many times can this appliance on a full charge to the start the vehicle?
A. Approx. 20 times.

Q. How long will the power of battery of this appliance remain?
A. 3-6 months, however, we suggest to recharge it every 3 months.

C. PARTS LIST:

#	Parts name	Quantity	#	Parts name	Quantity
1	Jump starter unit	1	4	User manual	1
2	Jumper cable with clamps	1	5	Cigarette lighter	1
3	Charging Cable	1			

F. TROUBLE SHOOTING:

Finding	Cause	Remedies
No response when pressing the switch button.	Low voltage protection of jump starter is started.	Plug the charging cable into the input port to recharge in order to activate.

G. TOXIC AND HARMFUL SUBSTANCES:

Composition and amount of toxic and harmful substance in jump starter				
Pb	Hg	Cd	Cr(VI)	PBB
0	0	0	0	0
PBDE	DBP	BBP	DEHP	DIBP
0	0	0	0	0

0: Indicate all homogeneous materials' s hazardous substances content are below the MCV limit specified in the standard 2011/65/EU (RoHS) with amendment (EU)2015/863.

H. WARNING:

1. DO remove the jump starter unit from the vehicle within 30s.
2. DO NOT connect the two clamps. Otherwise, it may be dangerous!
3. DO NOT disassemble the host. Otherwise, it may be dangerous!

Always take care when using the appliance

- This appliance is not intended for using by young or infirm persons without supervision.
- Do not use as a toy.
- Do not allow the appliance to become wet.
- Do not immerse the appliance in water.
- Do not operate the appliance in explosive atmospheres, such as in the presence of flammable liquids, gases or dust.
- Do not modify or disassemble Jump starter. Only a suitably qualified technician may repair this unit.
- Do not expose the appliance to heat.
- Do not store in locations where the temperature may exceed 70°C.
- Charge only at ambient temperatures between 0°C- 60°C.
- Charge only using the charger provided with the appliance.
- Under extreme conditions, battery leakage may occur. Carefully wipe the liquid off using a cloth and avoid skin contact when you notice liquid on the batteries. In case of skin or eye contact, rinse immediately within clean water and seek medical attention.
- At the end of its useful life, discard the appliance with due care for our environment.

I. WARRANTY INFORMATION:

1. We offer a limited warranty for this product against any defects in material and workmanship for a period of 12 months since the date of the factory. The conditions of the warranty are as follows.
2. The warranty is only valid upon presentation of the original receipt (from dealer/retailer) by the original purchaser with the product to be repaired or replaced.
3. The warranty is invalid if the serial number, date of purchase and label has been removed.
4. The warranty does not cover damage or product failure resulting from normal wear and tear, physical abuse, improper installation, modification or repairs by unauthorized third parties.
5. We do not assume responsibility for any loss or damage incurred during shipment or as a result of a force majeure.
6. We are not liable for any incidental or consequential damages arising from the use or misuse of the product.
7. All warranty claims are limited to repair or replacement of defective product and at the sole discretion of us.
8. If we repair or replace the product, the product will be covered for the remaining time of the original warranty period. Repair or replacement may involve the use of reconditioned units which are equivalent in function. Replaced part or product becomes the property of us.
9. Consumable components such as batteries and accessories are not covered by the warranty.

