

**Robert Bosch GmbH**

Power Tools Division  
70745 Leinfelden-Echterdingen  
Germany

[www.bosch-pt.com](http://www.bosch-pt.com)

1 609 929 Y14 (2011.08) PS / 194 UNI



1 609 929 Y14

## PFS 105 E



**de** Originalbetriebsanleitung  
**en** Original instructions  
**fr** Notice originale  
**es** Manual original  
**pt** Manual original  
**it** Istruzioni originali  
**nl** Oorspronkelijke  
gebruiksaanwijzing  
**da** Original brugsanvisning  
**sv** Bruksanvisning i original  
**no** Original driftsinstruks  
**fi** Alkuperäiset ohjeet

**el** Πρωτότυπο οδηγιών χρήσης  
**tr** Orijinal işletme talimatı  
**pl** Instrukcja oryginalna  
**cs** Původní návod k používání  
**sk** Pôvodný návod na použitie  
**hu** Eredeti használati utasítás  
**ru** Оригинальное руководство по  
эксплуатации  
**uk** Оригінальна інструкція з  
експлуатації  
**ro** Instrucțiuni originale  
**bg** Оригинална инструкция

**sr** Originalno uputstvo za rad  
**sl** Izvirna navodila  
**hr** Originalne upute za rad  
**et** Algupärane kasutusjuhend  
**lv** Instrukcijas oriģinālvalodā  
**lt** Originali instrukcija



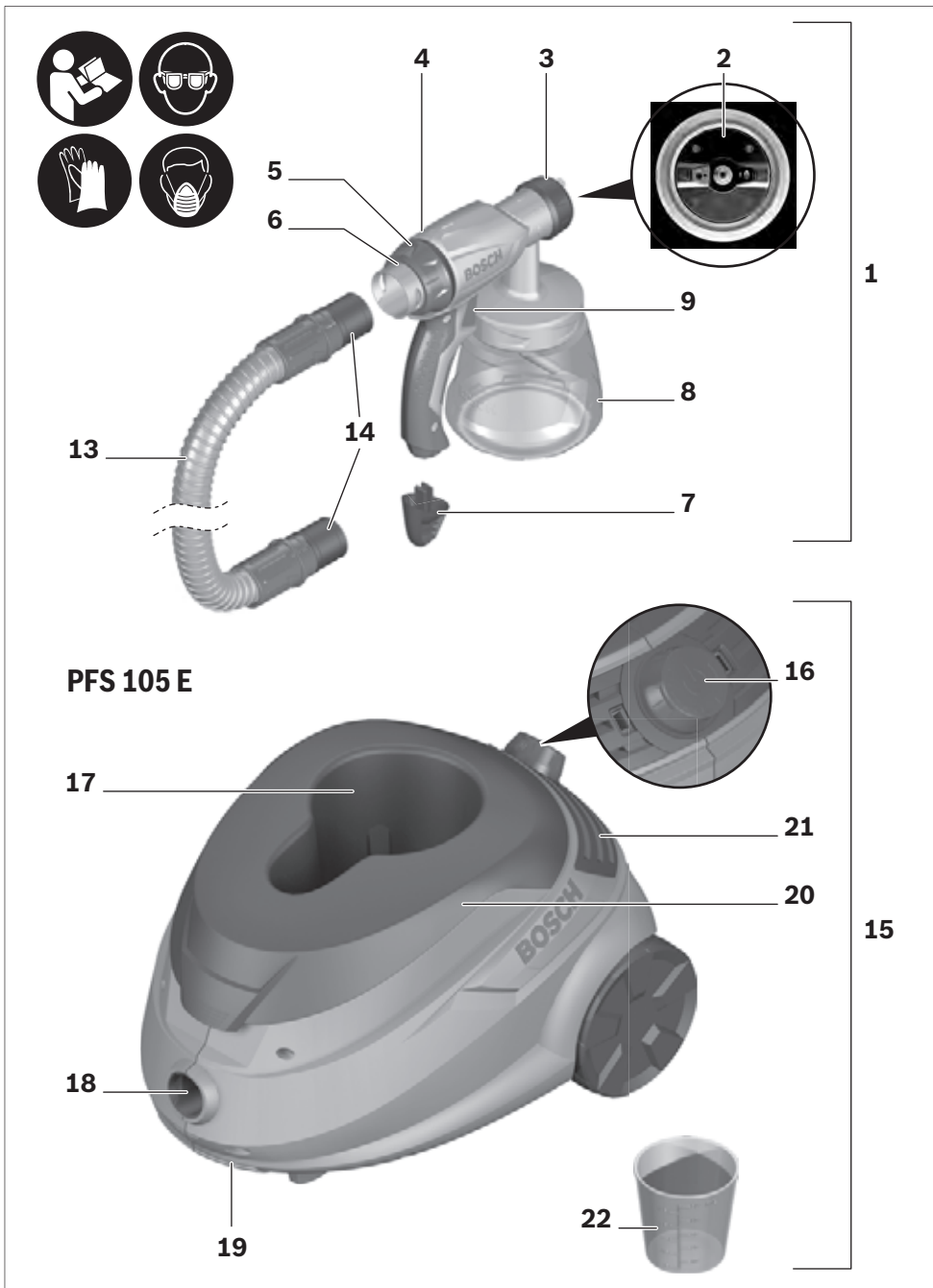

4 |

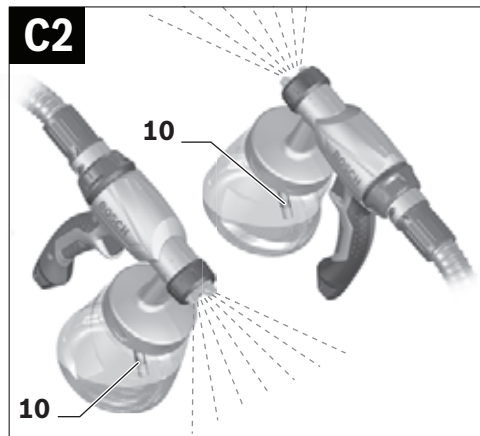
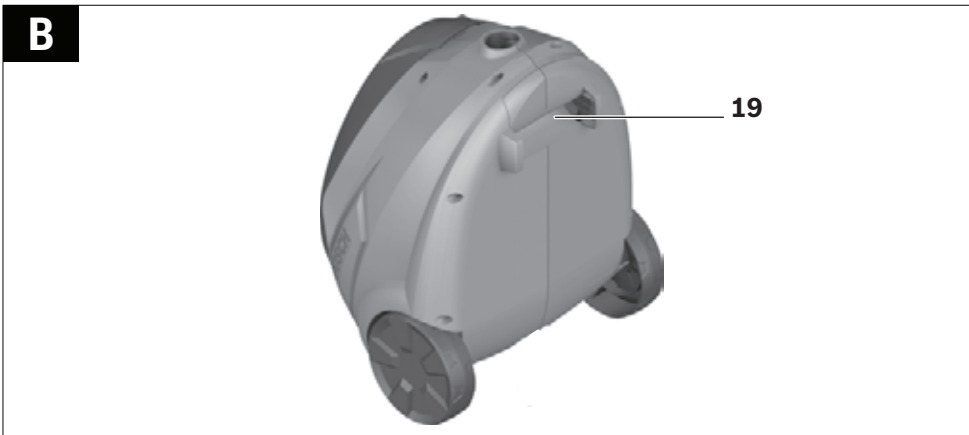
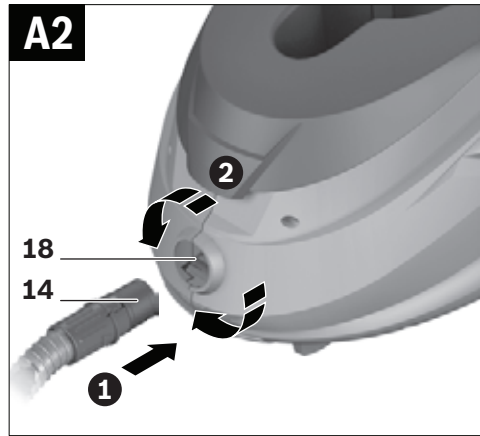
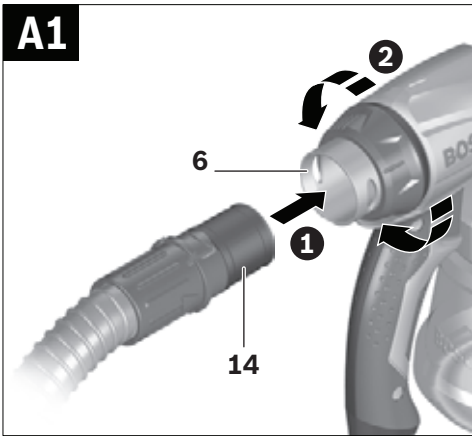

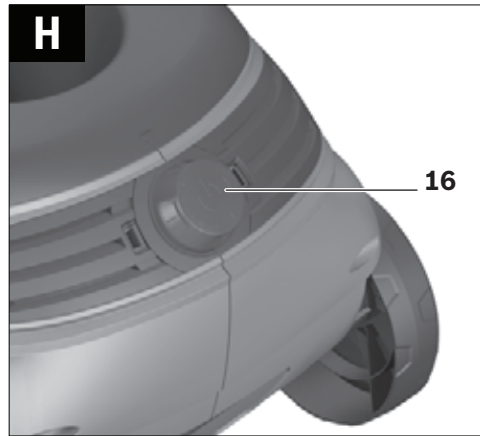
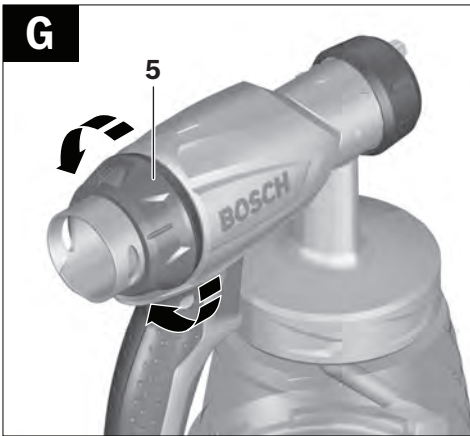
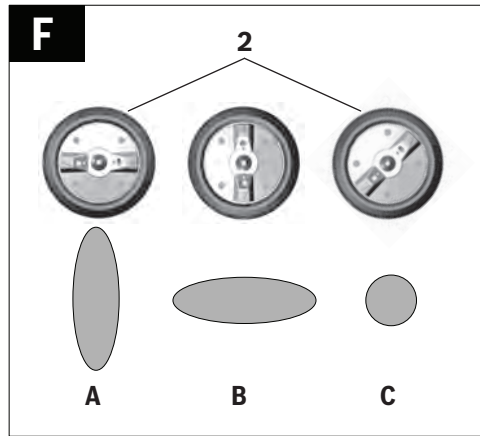
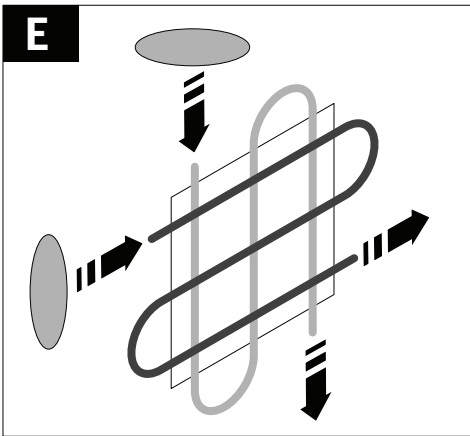
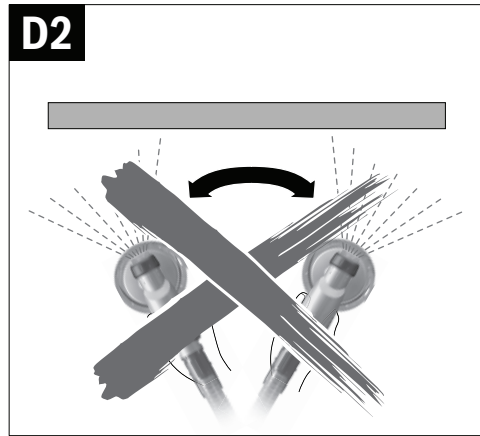
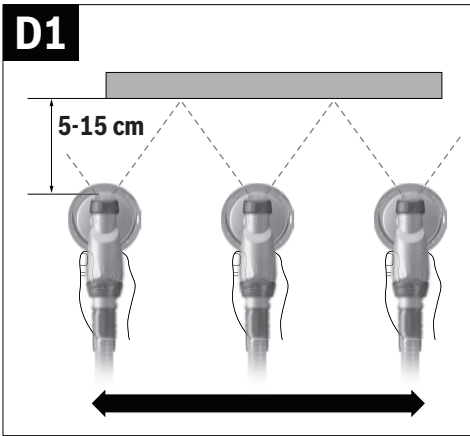

6 |

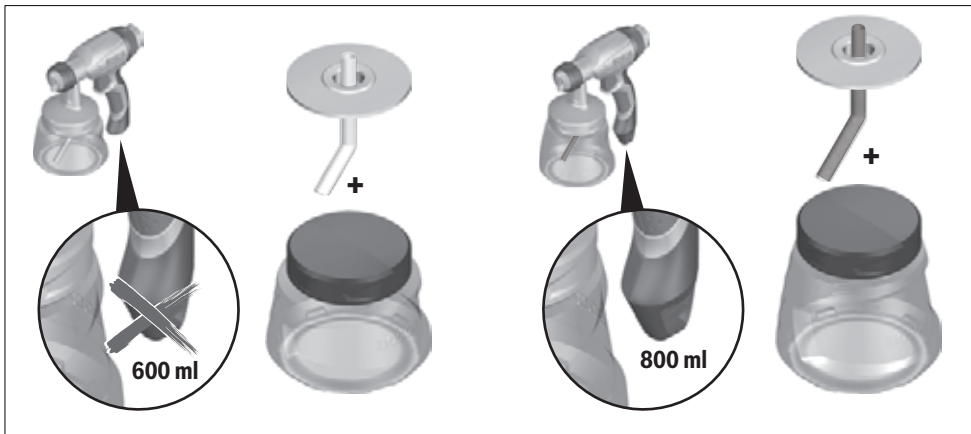
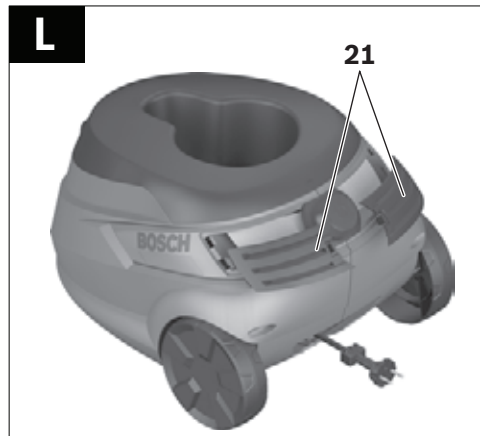
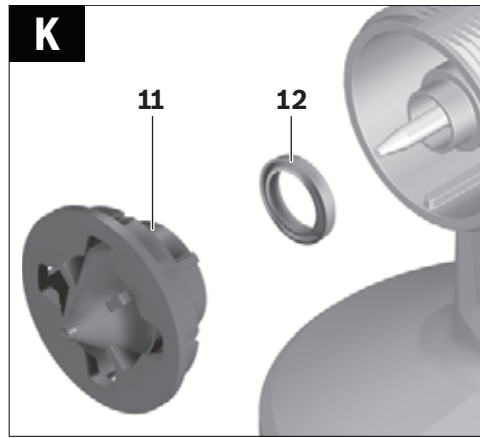
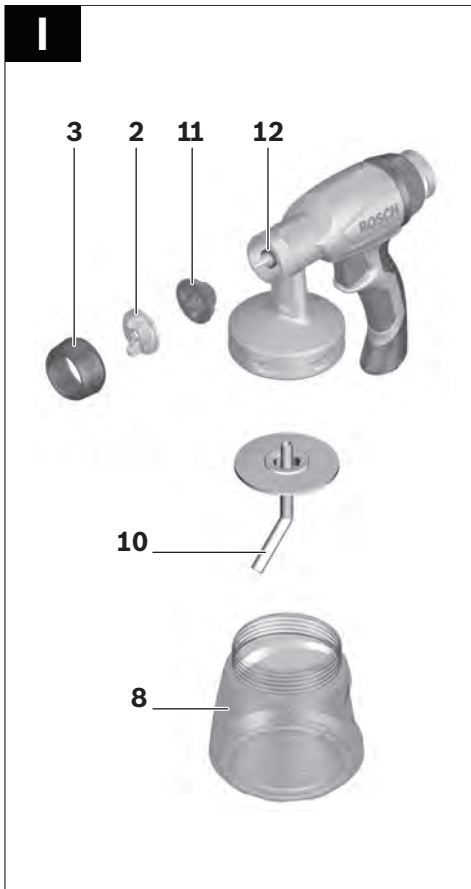

## 14 | English

**Entsorgung**

Sprühpistole, Elektroeinheit, Zubehör und Verpackungen sollen einer umweltgerechten Wiederverwertung zugeführt werden.

Werfen Sie Elektrowerkzeuge nicht in den Hausmüll!

**Nur für EU-Länder:**

Gemäß der Europäischen Richtlinie 2002/96/EG über Elektro- und Elektronik-Altgeräte und ihrer Umsetzung in nationales Recht müssen nicht mehr gebrauchsfähige Elektrowerkzeuge getrennt gesammelt und einer umweltgerechten Wiederverwertung zugeführt werden.

Änderungen vorbehalten.

**English****Safety Notes****General Power Tool Safety Warnings**

**⚠ WARNING** Read all safety warnings, instructions including Material Safety Data Sheets (MSDS), and container labels provided with the paints and solvents. Failure to follow the warnings and instructions may result in electric shock, fire and/or serious injury.

**Save all warnings and instructions for future reference.**

The term "power tool" in the warnings refers to your mains-operated (corded) power tool or battery-operated (cordless) power tool.

**Workplace safety**

▶ **Keep children and bystanders away while operating a power tool.** Distractions can cause you to lose control.

**Electrical Safety**

- ▶ **The plugs of power tools must match the outlet. Never modify the plug in any way. Do not use any adapter plugs with earthed (grounded) power tools.** Unmodified plugs and matching outlets will reduce the risk of electric shock.
- ▶ **Protect the machine from rain and moisture.** The penetration of water in a power tool increases the risk of electric shock.
- ▶ **Do not misuse the cord. Never use the cord for carrying, pulling or unplugging the power tool. Keep cord away from heat, oil, sharp edges and moving parts.** Damaged or entangled cords increase the risk of electric shock.
- ▶ **When operating a power tool outdoors, use an extension cord suitable for outdoor use.** Use of a cord suitable for outdoor use reduces the risk of electric shock.
- ▶ **When operating the power tool in damp/moist environments is unavoidable, use a residual current device**

**(RCD).** Use of a residual current device reduces the risk of electric shock.

**Personal safety**

- ▶ **Use safety equipment. Always wear eye protection.** Safety equipment such as dusk mask, non-skid safety shoes, hard hat, or hearing protection used for appropriate conditions will reduce personal injuries.

**Use and care of the power tool**

- ▶ **Do not use the power tool if the switch does not turn it on and off.** Any power tool that cannot be controlled with the switch is dangerous and must be repaired.
- ▶ **Store idle power tools out of the reach of children and do not allow persons unfamiliar with the power tool or these instructions to operate the power tool.** Power tools are dangerous in the hands of untrained users.
- ▶ **Use the power tool, accessories and application tools etc. in accordance with these instructions, taking into account the working conditions and the work to be performed.** Use of power tools for operations different from those intended could result in a hazardous situation.

**Service**

- ▶ **Have your power tool serviced by a qualified repair person using only identical replacement parts.** This will ensure that the safety of the power tool is maintained.

**Safety Warnings for Fine-spray Systems**

- ▶ **Keep area clean well lit and free of paint or solvent containers, rags, and other flammable materials.** Spontaneous combustion may occur. Fire extinguisher equipment shall be present and working at all times.
- ▶ **Provide for good ventilation in the spraying area and for sufficient fresh air in the complete room.** Evaporating inflammable solvents create an explosive environment.
- ▶ **Do not use materials with a flashpoint below 21 °C for spraying and cleaning. Use water-based materials, non-volatile hydrocarbons or similar materials.** Fast evaporating solvents create an explosive environment.
- ▶ **Do not spray in the vicinity of ignition sources, such as static electricity sparks, open flames, pilot lights, hot objects, engines/motors, cigarettes and sparks from plugging in or unplugging power cords or operating switches.** Such spark sources can ignite the spraying vicinity/environment.
- ▶ **Do not spray any liquid of unknown hazard potential.** Unknown materials can create hazardous conditions.
- ▶ **Wear additional protective equipment such as appropriate protective gloves and protective masks or respirators when spraying or handling chemicals.** Wearing protective equipment for the appropriate conditions reduces the exposure to hazardous substances.



- ▶ **Never point the spray jet against yourself, towards other persons or animals. Keep your hands and other body parts away from the spray jet. If the spray jet should penetrate the skin, seek medical attention immediately from a doctor.** The material being sprayed can even penetrate the skin through a glove and be injected into your body.
- ▶ **Do not treat an injection as a simple cut.** A high-pressure spray is able to inject toxins into the body and cause serious bodily injury. In the event that an injection occurs, seek medical attention immediately.
- ▶ **Be aware of possible hazards from the spray material. Observe the information on drums/tanks/tins as well as manufacturer information of the spray material, including the request to wear personal protective equipment.** The manufacturer's instructions are to be observed in order to reduce the risk of fire as well as injuries caused through toxins, carcinogens, etc.
- ▶ **Use only nozzles/nozzle inserts specified by the manufacturer. Never spray without the nozzle protection mounted.** Use of a special nozzle insert with the corresponding nozzle protection reduces the probability that a high-pressure jet penetrates the skin and injects toxins into the body.
- ▶ **Exercise caution when cleaning and changing nozzle inserts. If the nozzle insert should become clogged during spraying, follow the manufacturer's instructions for switching off the system and relieving the pressure before removing the nozzle.** Fluids under high pressure can penetrate the skin, inject toxins into the body and lead to serious injury.
- ▶ **Keep the plug of the mains cord and the trigger switch of the spray gun clear of paint and other fluids. Never hold the cord by its connectors to support it.** Failure to follow the instruction can lead to electric shock.
- ▶ **Supervise children.** This will ensure that children do not play with the fine-spray system.
- ▶ **Children or persons that owing to their physical, sensory or mental limitations or to their lack of experience or knowledge, are not capable of securely operating the fine-spray system, may only use this fine-spray system under supervision or after having been instructed by a responsible person.** Otherwise, there is danger of operating errors and injuries.

**Products sold in GB only:** Your product is fitted with an BS 1363/A approved electric plug with internal fuse (ASTA approved to BS 1362). If the plug is not suitable for your socket outlets, it should be cut off and an appropriate plug fitted in its place by an authorised customer service agent. The replacement plug should have the same fuse rating as the original plug. The severed plug must be disposed of to avoid a possible shock hazard and should never be inserted into a mains socket elsewhere.

**Products sold in AUS and NZ only:** Use a residual current device (RCD) with a rated residual current of 30 mA or less.

## Product Description and Specifications



**Read all safety warnings and all instructions.** Failure to follow the warnings and instructions may result in electric shock, fire and/or serious injury.

### Intended Use

The power tool is intended for atomising solvent-based and water-dilutable paints, finishes, primers, clear finishes, automotive finishes, staining sealers, wood sealer-preservatives, plant protectives, oil and disinfection agents.

The power tool is not suitable for spraying dispersions and latex paint, caustic solutions, acidic coating materials, coating materials with granules or solids as well as spray and drip-impeding materials.

### Product Features

The numbering of the components shown refers to the representation of the power tool on the graphic pages.

- 1 Spray gun
- 2 Air cap
- 3 Union nut
- 4 Mark for SDS connection
- 5 Thumbwheel for spraying capacity
- 6 Hose port (spray gun)
- 7 Handle extension (only for 800 ml container)
- 8 Container for spray material, 800 ml  
Container for spray material, 600 ml\*
- 9 Trigger switch
- 10 Suction tube with container seal  
green: for 800 ml container  
white: for 600 ml container\*
- 11 Nozzle
- 12 Nozzle seal
- 13 Air hose
- 14 SDS connector
- 15 Base unit
- 16 Control knob for On/Off and air-flow control
- 17 Set-down port for spray gun
- 18 Hose connection (base unit)
- 19 Handle
- 20 Accessory compartment
- 21 Air filter cover
- 22 Measuring cup

\*Accessories shown or described are not part of the standard delivery scope of the product. A complete overview of accessories can be found in our accessories program.

## 16 | English

**Technical Data**

| Fine-spray System  |       | PFS 105 E     |
|--|-------|---------------|
| Article number   |       | 3 603 B06 2.. |
| Rated power input  | W     | 350           |
| Spraying capacity  | g/min | 150           |
| Atomising output   | W     | 0 – 105       |
| Required time for application of paint on 5 m <sup>2</sup> | min   | 6             |
| Container capacity for spray material                      | ml    | 800           |
| Length of air hose   | m     | 3.4           |
| Weight according to EPTA-Procedure 01/2003                 | kg    | 4.9           |
| Protection class   |       | □/II          |

The values given are valid for a nominal voltage [U] of 230 V. For different voltages and models for specific countries, these values can vary. Please observe the article number on the type plate of your machine. The trade names of the individual machines may vary.

**Noise/Vibration Information**

Measured sound values determined according to EN 60745.

Typically the A-weighted sound pressure level of the product is 74 dB(A). Uncertainty K = 3 dB.

The noise level when working can exceed 80 dB(A).

**Wear hearing protection!**

Vibration total values  $a_h$  (triax vector sum) and uncertainty K determined according to EN 60745:

$$a_h < 2.5 \text{ m/s}^2, K = 1.5 \text{ m/s}^2.$$

The vibration emission level given in this information sheet has been measured in accordance with a standardised test given in EN 60745 and may be used to compare one tool with another. It may be used for a preliminary assessment of exposure.

The declared vibration emission level represents the main applications of the tool. However if the tool is used for different applications, with different accessories or poorly maintained, the vibration emission may differ. This may significantly increase the exposure level over the total working period.

An estimation of the level of exposure to vibration should also take into account the times when the tool is switched off or when it is running but not actually doing the job. This may significantly reduce the exposure level over the total working period.

Identify additional safety measures to protect the operator from the effects of vibration such as: maintain the tool and the accessories, keep hands warm, organise work patterns.

**Declaration of Conformity** 

We declare under our sole responsibility that the product described under "Technical data" is in conformity with the following standards or standardization documents: EN 60335 and the directives 2011/65/EU, 2006/42/EC, 2004/108/EC including their amendments.

Technical file (2006/42/EC) at:  
Robert Bosch GmbH, Dept. PT/ESC,  
D-70745 Leinfelden-Echterdingen

Dr. Egbert Schneider  
Senior Vice President  
Engineering

Dr. Eckerhard Strötgen  
Head of Product  
Certification

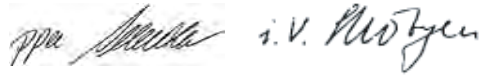

Robert Bosch GmbH, Power Tools Division  
D-70745 Leinfelden-Echterdingen  
Leinfelden, 22.08.2011

**Assembly**

- **Before any work on the machine itself, pull the mains plug.**

**Connecting the Air hose (see figures A1 – A2)**

- Take the air hose **13** out of the accessory compartment **20**.
- Remove the protective caps from both ends of the air hose.

Connecting to the spray gun:

- Firmly insert an SDS connector **14** of the air hose in alignment with the arrow mark into the hose port of the spray gun **6**.
- Turn the SDS connector until the lock can be heard to latch.

Connecting the base unit:

- Firmly insert the second SDS connector of the air hose in alignment with the arrow mark into the port of the base unit **18**.
- Turn the SDS connector until the lock can be heard to latch.

**Note:** After use, reattach the protective hose caps to the hose ends.

**Operation****Preparing for Operation**

- **Spraying on the sides of water bodies (lakes, rivers, etc.) or neighbouring surfaces in the direct catchment area is not permitted.**

When purchasing paint, varnish and spray material, pay attention to their environmental compatibility.

**Preparing the Spray Surface**

**Note:** Cover off the vicinity of the spray surface thoroughly and generously.

The spray mist contaminates the environment. When spraying in enclosures, surfaces not covered can become contaminated.

The spray surface must be clean, dry and grease-free.

- Roughen smooth surfaces and then remove the sanding dust.

### Suitable spray materials and recommended diluting agents

- ▶ **When diluting, pay attention that the spray material and the diluting agent correspond.** When using a faulty diluting agent, lumps can develop that can lead to clogging of the spray gun.

| Spray material  | Recommended dilution  |
|---|-----------------------|
| Wood preservatives, mordants/strip-pers, oils, varnishes, impregnations, rust-protection primers      | undiluted             |
| Disinfectants, plant protectants, water, wallpaper stripper   | undiluted             |
| Solvent or water-dilutable paints, primers, radiator paint, automotive top coats, thick-coat finishes | At least 10 % diluted |

The tool is not suitable for processing dispersion paint (wall paint/latex).

Please also observe the practical advice/tips of the spray material manufacturers.

### Diluting Spray Material

For spray material that needs to be diluted, proceed as follows:

- Take the measuring cup **22**.
- Stir the spray material thoroughly.
- Fill a sufficient quantity of spray material into the spray-material container **8**. (see “Filling in Spray Material”, page 17)
- Dilute the spray material by 10 % with paint thinner. Examples:

|                               |     |     |     |     |
|-------------------------------|-----|-----|-----|-----|
| Amount of spray material [ml] | 200 | 300 | 400 | 500 |
| Paint thinner [ml]            | 20  | 30  | 40  | 50  |

- Stir the spray material thoroughly.
- Carry out a test-spray run on a test surface. (see “Spraying”, page 17)

When the spraying pattern is perfect, start the spray job.

or

When the spraying result is not satisfactory or when no paint comes out, please continue as described under “Correction of Malfunctions” on page 19.

### Filling in Spray Material (see figures C1 – C2)

- ▶ **Before any work on the machine itself, pull the mains plug.**

- Unscrew the container **8** from the spray gun.
- Turn the suction tube **10** so that the spray material can be sprayed with almost no residue:

|   |   |
|---|---|
| For spray jobs on horizontal surfaces/objects | toward the <b>front</b> in nozzle direction |
| For spray jobs overhead                       | toward the <b>rear</b> in handle direction  |

- Fill the spray material into the container and screw the container firmly to the spray gun.

### Starting Operation

- ▶ **Observe correct mains voltage! The voltage of the power source must agree with the voltage specified on the nameplate of the machine. Power tools marked with 230 V can also be operated with 220 V.**
- ▶ **During operation, the base unit must always stand horizontally on a level surface. Never tilt the base unit or set it upright when switched on.**
- ▶ **Pay attention that the base unit cannot draw in dust or other contamination during operation.**
- ▶ **Make sure never to spray on the base unit.**

### Switching On

- Always place the base unit horizontally on a level and clean surface.
- Plug the mains plug into a socket outlet.
- Grasp the spray gun by the handle and point it at the spray surface.
- For switching on, turn the control knob **16** on the base unit toward the right to the stop. It is recommended to start with the maximum air flow. (“Adjusting the Air Flow”, see page 18)
- Pull the trigger switch **9** on the spray gun.

**Note:** When the base unit is switched on, air always flows out at the nozzle **11**.

### Switching Off

- Release the trigger switch **9** and turn the control knob **16** toward the left to the stop.
- Place down the spray gun in the set-down port **17**.
- Pull the mains plug from the socket outlet.

### Working Advice

#### Spraying (see figures D – E)

**Note:** Observe the wind direction when operating the power tool outdoors.

- Firstly, carry out a test-spray run and adjust the spray pattern and the spray material quantity according to the spray material. (For adjustments, see the following sections)
- Make sure to hold the spray gun vertical to the spray object at a uniform clearance between 5 – 15 cm.
- Begin the spraying procedure outside the target area.
- Move the spray gun evenly cross-wise or up-and-down, depending on the spray pattern setting. An even surface quality is achieved when the paths overlap by 4 – 5 cm.
- Avoid interruptions within the spray surface. Guiding the spray gun evenly will provide uniform surface quality.

Non-uniform clearance and spray angle lead to heavy formation of paint mist and thus to an uneven surface.

- End the spraying procedure outside the target area.

Never spray the container completely empty. When the suction tube no longer immerses in the spray material, the spray jet will break off, resulting in a non-uniform surface.







When coating material builds up on the nozzle and air cap, clean both parts with the corresponding solvent.

18 | English

**Adjusting the Spray Pattern (see figure F)**

► **Never actuate the trigger switch 9 while adjusting the air cap 2.**





- Loosen the union nut 3.
- Turn the air cap 2 to the requested position.
- Firmly retighten the union nut.

| Air cap   | Jet   | Application  |
|---|---|--|
|  |  | <b>A</b><br>Vertical flat jet for horizontal working direction       |
|  |  | <b>B</b><br>Horizontal flat jet for vertical working direction       |
|  |  | <b>C</b><br>Round jet for corners, edges and hard to reach locations |

**Adjusting the Spraying Capacity (see figure G)**

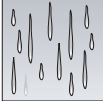
- To adjust the requested spraying capacity, turn the thumbwheel 5:

- I:** Min. spraying capacity,
- III:** Max. spraying capacity.



| Spraying capacity  | Adjustment   |
|--|--|
| Too much material on target area:<br>    | The spraying capacity must be reduced.<br>- Turn the thumbwheel 5 in direction <b>I</b> .<br>      |
| Not enough material on target area:<br> | The spraying capacity must be increased.<br>- Turn the thumbwheel 5 in direction <b>III</b> .<br> |

**Adjusting the Air Flow (see figure H)**

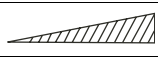
- Turn control knob 16 to adjust the air flow and the pressure for the spray material being used.

|                  |   |                  |
|------------------|---|------------------|
| Minimal air flow |  | Maximum air flow |
|------------------|---|------------------|

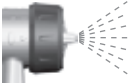
It is recommended to start with the maximum air flow.

| Air Flow   | Adjustment  |
|--|---|
| Too much fog of coating material:<br> | The air flow must be reduced.<br>- Turn control knob 16 toward the left.<br> |

**Air Flow**

Atomisation too coarse:

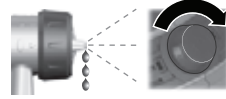

**Adjustment**

The air flow must be increased.

- Turn control knob 16 toward the right.

**Transport**

The filled spray gun or a closed container with spray material can be placed in the set-down port 17 for transport. The holding fixture retains the spray gun firmly in the set-down port. Spray material cannot run out.

- Place down the spray gun on the set-down port and push in against the resistance until tightly seated.

**Maintenance and Service**

**Maintenance and Cleaning**

► **Before any work on the machine itself, pull the mains plug.**

**Cleaning (see figures I – K)**

Proper cleaning is the requirement for flawless operation of the spray gun. Improper or lack of cleaning voids warranty claims.

Always clean the spray gun and the container with the respective diluting agent (paint thinner or water) for the spray material being used.

Never immerse the complete spray gun into the cleaning agent.

Never clean the nozzle and air holes of the spray gun with pointed metal objects.

Do not pour diluted spray material back into the original spray material drum/tin for storage.

Clean the spray gun thoroughly after having sprayed material hazardous to one's health.

- Switch the base unit off and pull the trigger switch 9 of the spray gun so that the spray material can flow back into the container.
- Unscrew the container 8 and empty the remaining spray material.
- Fill diluting agent (paint thinner or water) into the container and screw it to the spray gun.
- Shake the spray gun several times.
- Switch the base unit on and spray the diluting agent into an empty material tin.
- Repeat the last three steps until clear diluting agent emerges from the spray gun.
- Switch the base unit off again.
- Completely empty the container 8.
- Check if the suction tube with the container seal 10 is free of spray material and undamaged.
- Clean the outside of the container and the spray gun with a cloth moistened in paint thinner.
- Unscrew the union nut 3 and the air cap 2.

- Clean the nozzle **11** and the nozzle needle with diluting agent.
- From time to time, the nozzle seal **12** must also be cleaned.
- Remove the nozzle **11** and the nozzle seal **12**.  
If required, use a pointed object, as the nozzle seal is seated firmly to the spray gun.
  - Clean the nozzle seal with diluting agent.
  - Reinstall the nozzle seal in the spray gun. Pay attention that the groove points away from the spray gun.
  - Mount the nozzle onto the spray gun body and turn it to the correct position.
  - Mount the air cap **2** onto the nozzle and tighten with the union nut **3**.

#### Changing the Air Filter (see figure L)

The air filter must be replaced when soiled.

- Remove the air filter cover **21**.
- Change the air filter.
- Remount the air filter cover.

#### Material Disposal

Diluting agent and remainders of spray material must be disposed of in an environmentally-friendly manner. Observe the manufacturer's disposal information and the local regulations for disposal of hazardous waste.

Chemicals harmful to the environment may not be disposed of into soil, groundwater or bodies of water. Never pour chemicals harmful to the environment into the sewerage system!

### Correction of Malfunctions

| Problem                                | Cause  | Corrective Measure   |
|--|--|--|
| Spray material does not cover properly | Spraying capacity too low  | Turn thumbwheel <b>5</b> in direction <b>IIII</b>                        |
|  | Clearance to target area too large   | Reduce spray distance  |
|  | Not enough spray material on target area, too few spray paths sprayed over target area | Apply more spray paths over target area                                  |
|  | Spray material too viscous   | Thin down the spray material by 10% again and carry out a test-spray run |
| Spray material runs off after coating  | Too much spray material applied  | Turn thumbwheel <b>5</b> in direction <b>I</b>                           |
|  | Clearance to target area too close   | Increase spray distance  |
|  | Viscosity of spray material too low  | Add original spray material  |
|  | Spray material applied too often over same spot  | Remove spray material; reduce number of spray paths over same spot       |
| Atomisation too coarse                 | Spraying capacity too high   | Turn thumbwheel <b>5</b> in direction <b>I</b>                           |
|  | Air flow too low   | Turn control knob <b>16</b> toward the right                             |
|  | Nozzle <b>11</b> soiled  | Clean nozzle   |
|  | Too little pressure build-up in container <b>8</b>                                     | Screw container firmly against spray gun                                 |
|  | Spray material too viscous   | Thin down the spray material by 10% again and carry out a test-spray run |
|  | Air filter heavily soiled  | Changing the Air Filter  |
| Excessive paint mist                   | Too much spray material applied  | Turn thumbwheel <b>5</b> in direction <b>I</b>                           |
|  | Clearance to spray surface too large   | Reduce spray distance  |
|  | Viscosity of spray material too low  | Reduce air flow; turn control knob <b>16</b> toward the left             |
| Spray jet pulsates                     | Not enough spray material in container   | Refill spray material  |
|  | Venting hole on suction tube <b>10</b> clogged   | Clean suction tube and hole  |
|  | Air filter heavily soiled  | Changing the Air Filter  |
|  | Spray material too viscous   | Thin down the spray material by 10% again and carry out a test-spray run |
| Spray material drips from the nozzle   | Build-up of spray material on nozzle <b>11</b> and air cap <b>2</b>                    | Clean nozzle and air cap   |
|  | Nozzle <b>11</b> worn  | Replace nozzle   |
|  | Nozzle <b>11</b> loose   | Tighten union nut <b>3</b>   |

## 20 | English

| Problem                                   | Cause  | Corrective Measure   |
|---|--|--|
| No spray material emerges from the nozzle | Control knob <b>16</b> for air-flow control turned too far to the left | Turn control knob <b>16</b> toward the right                             |
|   | No pressure build-up in container <b>8</b>                             | Screw container firmly against spray gun                                 |
|   | Suction tube <b>10</b> loose   | Insert suction tube properly   |
|   | Nozzle <b>11</b> clogged   | Clean nozzle   |
|   | Suction tube <b>10</b> clogged   | Clean suction tube   |
|   | Venting hole on suction tube <b>10</b> clogged                         | Clean suction tube and hole  |
|   | Spray material too viscous   | Thin down the spray material by 10% again and carry out a test-spray run |

**Maintenance**

If the machine should fail despite the care taken in manufacturing and testing procedures, repair should be carried out by an after-sales service centre for Bosch power tools.

In all correspondence and spare parts order, please always include the 10-digit article number given on the type plate of the machine.

**After-sales Service and Customer Assistance**

Our after-sales service responds to your questions concerning maintenance and repair of your product as well as spare parts. Exploded views and information on spare parts can also be found under:

**www.bosch-pt.com**

Our customer service representatives can answer your questions concerning possible applications and adjustment of products and accessories.

**Great Britain**

Robert Bosch Ltd. (B.S.C.)  
P.O. Box 98  
Broadwater Park  
North Orbital Road  
Denham  
Uxbridge  
UB 9 5HJ  
Tel. Service: +44 (0844) 736 0109  
Fax: +44 (0844) 736 0146  
E-Mail: boschservicecentre@bosch.com

**Ireland**

Origo Ltd.  
Unit 23 Magna Drive  
Magna Business Park  
City West  
Dublin 24  
Tel. Service: +353 (01) 4 66 67 00  
Fax: +353 (01) 4 66 68 88

**Australia, New Zealand and Pacific Islands**

Robert Bosch Australia Pty. Ltd.  
Power Tools  
Locked Bag 66  
Clayton South VIC 3169  
Customer Contact Center  
Inside Australia:  
Phone: +61 (01300) 307 044  
Fax: +61 (01300) 307 045  
Inside New Zealand:  
Phone: +64 (0800) 543 353  
Fax: +64 (0800) 428 570  
Outside AU and NZ:  
Phone: +61 (03) 9541 5555  
www.bosch.com.au

**Republic of South Africa**

**Customer service**  
Hotline: +27 (011) 6 51 96 00

**Gauteng – BSC Service Centre**

35 Roper Street, New Centre  
Johannesburg  
Tel.: +27 (011) 4 93 93 75  
Fax: +27 (011) 4 93 01 26  
E-Mail: bsctools@icon.co.za

**KZN – BSC Service Centre**

Unit E, Almar Centre  
143 Crompton Street  
Pinetown  
Tel.: +27 (031) 7 01 21 20  
Fax: +27 (031) 7 01 24 46  
E-Mail: bsc.dur@za.bosch.com

**Western Cape – BSC Service Centre**

Democracy Way, Prosperity Park  
Milnerton  
Tel.: +27 (021) 5 51 25 77  
Fax: +27 (021) 5 51 32 23  
E-Mail: bsc@zsd.co.za

**Bosch Headquarters**

Midrand, Gauteng  
Tel.: +27 (011) 6 51 96 00  
Fax: +27 (011) 6 51 98 80  
E-Mail: rbsa-hq.pts@za.bosch.com