

USE AND CARE GUIDE

LED EMERGENCY REMOTE HEAD

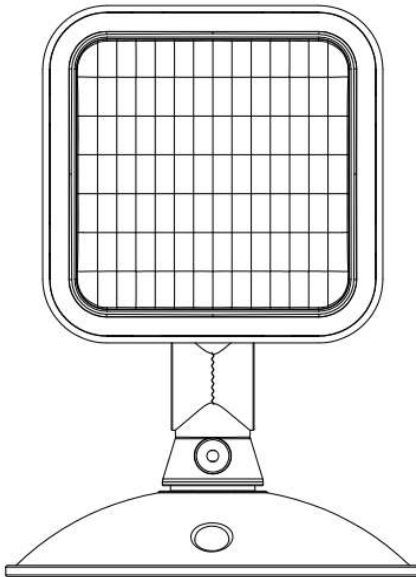

Questions, problems, missing parts? Before returning to the store,
call Commercial Electric Customer Service
8 a.m. - 7 p.m., EST, Monday - Friday, 9 a.m. - 6 p.m., EST, Saturday

1-877-527-0313

HOMEDEPOT.COM

THANK YOU

We appreciate the trust and confidence you have placed in Commercial Electric through the purchase of this emergency light. We strive to continually create quality products designed to enhance your home. Visit us online to see our full line of products available for your home improvement needs. Thank you for choosing Commercial Electric!

Table of Contents

Safety Information.....	2	Maintenance.....	7
Warranty.....	2	Battery Replacement.....	8
Pre-Installation.....	3	Troubleshooting.....	8
Installation.....	5		

Safety Information

IMPORTANT SAFEGUARDS. READ AND FOLLOW ALL SAFETY INSTRUCTIONS.

When using electrical equipment, basic safety precautions should always be followed including the following:

- Make all electrical connections in accordance with local codes, ordinances, and the National Electric Code.
- This product is for indoor use only.
- Do not mount this product near a gas or electric heater.
- Use caution when servicing batteries. Battery acid can cause burns to skin and eyes. If acid is spilled on skin or eyes, flush acid with fresh water and contact a physician immediately.
- This product should be mounted in a location and at a height where it will not be readily subjected to tampering by unauthorized personnel.
- The use of accessories is not recommended by the manufacturer, and may cause unsafe conditions.
- Do not use this product for anything other than its intended use.
- All service shall be performed by qualified service personnel. This product must be installed and maintained in accordance with the applicable installation codes by a person familiar with the construction operation of the product and the hazards involved.
- Maximum mounting height is 9.75 ft (2.97 m)



WARNING: Before beginning installation, turn off electricity by removing the fuse or turning off the circuit breaker.



WARNING: Disconnect power before servicing the product. All service should be performed by a qualified electrician.



WARNING: Changes or modifications to this unit not expressly approved by the party responsible for compliance could void the user's authority to operate the equipment.

NOTICE: This equipment has been tested and found to comply with the limits for a Class B digital device, pursuant to Part 15 of the FCC Rules. These limits are designed to provide reasonable protection against harmful interference in a residential installation. This equipment generates, uses and can radiate radio frequency energy and, if not installed and used in accordance with the instructions, may cause harmful interference to radio communications. However, there is no guarantee that interference will not occur in a particular installation. If this equipment does cause harmful interference to radio or television reception, which can be determined by turning the equipment off and on, the user is encouraged to try to correct the interference by one or more of the following measures:

- Reorient or relocate the receiving antenna.
- Increase the separation between the equipment and receiver.
- Connect the equipment into an outlet on a circuit different from that to which the receiver is connected.
- Consult the dealer or an experienced radio/TV technician for help.

SAVE THESE INSTRUCTIONS

Warranty

WHAT IS COVERED

The manufacturer warrants this lighting fixture to be free from defects in materials and workmanship for a period of five (5) years, and five (5) years for the battery, from date of purchase. This warranty applies only to the original consumer purchaser and only to products used in normal use and service. If this product is found to be defective, the manufacturer's only obligation, and your exclusive remedy, is the repair or replacement of the product at the manufacturer's discretion, provided that the product has not been damaged through misuse, abuse, accident, modifications, alterations, neglect, or mishandling.

WHAT IS NOT COVERED

This warranty shall not apply to any product that is found to have been improperly installed, set-up, or used in any way not in accordance with the instructions supplied with the product. This warranty shall not apply to a failure of the product as a result of an accident, misuse, abuse negligence, alteration, faulty installation, or any other failure not relating to faulty material or workmanship. This warranty shall not apply to the finish on any portion of the product, such as surface and/or weathering, as this is considered normal wear and tear.

The manufacturer does not warrant and specifically disclaims any warranty, weather express or implied, of fitness for a particular purpose, other than the warranty contained herein. The manufacturer specifically disclaims and liability and shall not be liable for any consequential or incidental loss or damage, including but not limited to any labor / expense costs involved in the replacement or repair of said product.

Contact the Customer Service Team at 1-877-527-0313 or visit www.HomeDepot.com.

Pre-Installation



IMPORTANT: When constructing or remodeling and prior to installing, be sure to check with the local fire marshal or code enforcement office to ensure the correct color guidelines for your municipality are being followed.

PLANNING INSTALLATION

Before beginning assembly, installation, or operation of the product, make sure all parts are present. Compare parts with the package contents list. If any part is missing or damaged, do not attempt to assemble, install, or operate the product. Contact customer service for replacement parts.



NOTE: Keep your receipt and these instructions for proof of purchase.

TOOLS REQUIRED

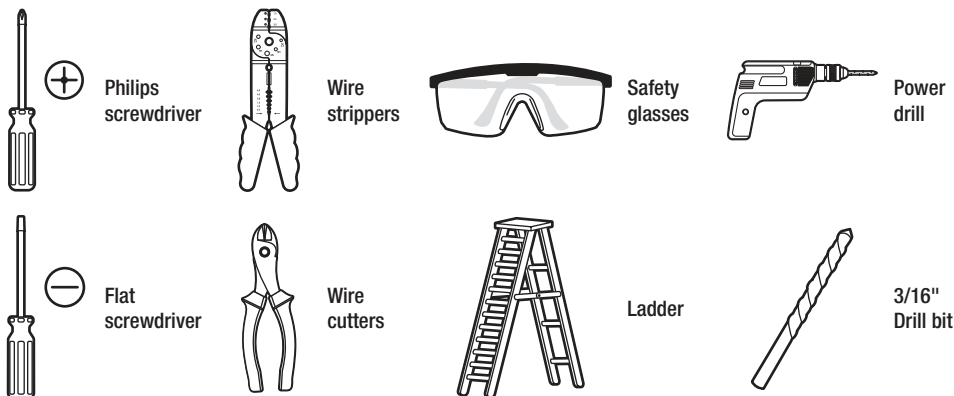

HARDWARE INCLUDED



NOTE: Hardware not shown to actual size.

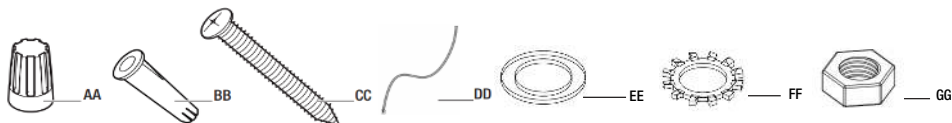

Part	Description	Quantity
AA	Small Wire nut	3
BB	Wall anchor	2
CC	Mounting screw	2
DD	Connection Wire	1
EE	Rubber gasket	1
FF	Washer	1
GG	Hex nut	1

Pre-Installation (continued)

PACKAGE CONTENTS

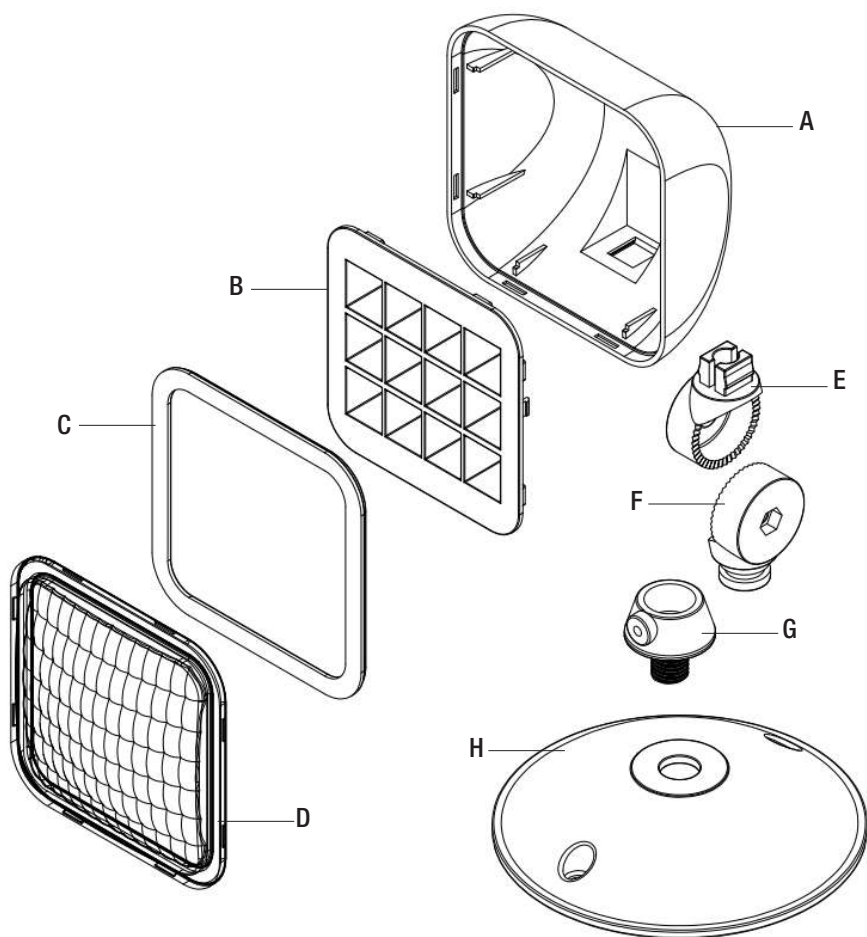

Part	Description	Quantity
A	Rear cover	1
B	Reflector	1
C	Silicone pad	1
D	Lens	1
E	Left rotation	1
F	Right rotation	1
G	Bracket	1
H	Canopy	1

Installation

1 Preparing the emergency head

- The rubber gasket (EE) set into bracket (G), then put the bracket (G) into canopy (H), use washer (FF) and hex nut (GG) to screw up.

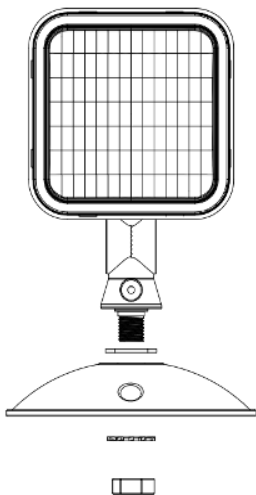

2 Installing the emergency head

- Use mounting screw (CC) and wall anchor (B B) to the wall.

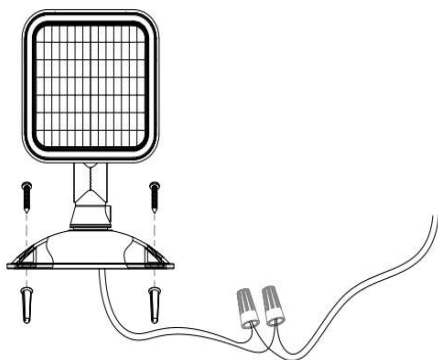

3 Connecting The Wiring

- Make wire connecting using wire nuts (AA).
- For 3.6-9.6V applications, use the brown and gray wires. Connect the brown wire to positive "+", Connect the gray wire to negative "-".

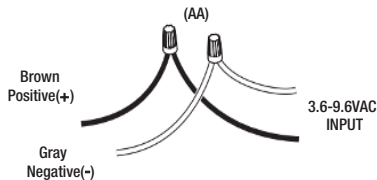

4 Completing the installation

- Direction of rotation. Screw 1, Position the head left and right. Screw 2, Position the head up and down.

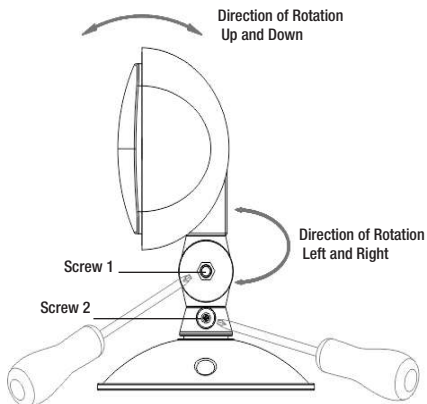

Maintenance



NOTE: National Electric Code (NEC) and NFPA life safety code regulations require that routine tests need to be performed.

TESTING OPERATION

With AC Power applied to the unit, the EXIT sign and A/C Power LED indicator should illuminate. When pushing the TEST button (I), the LED indicator should turn off, the EXIT sign will remain illuminated and the emergency heads will illuminate.

TESTING THE BATTERY

Test the unit's battery once per month. Additionally, every 12 months, a full 90-minute test should be performed. While disconnected from the main power supply, the EXIT sign and emergency heads should illuminate for a minimum of 90 minutes on battery back up power.

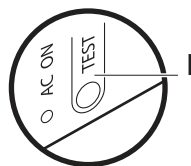

Battery Replacement

This fixture uses a Ni-Cd Rechargeable AA1000 mAh 9.6 V battery.

To remove the battery:

- Bend the battery catches away from the battery and remove the battery from the housing.
- Disconnect the battery leads from the board terminal.
- Connect the new battery to the board terminal.
- Place the new battery in the battery location and ensure it is seated behind the battery catches (1).

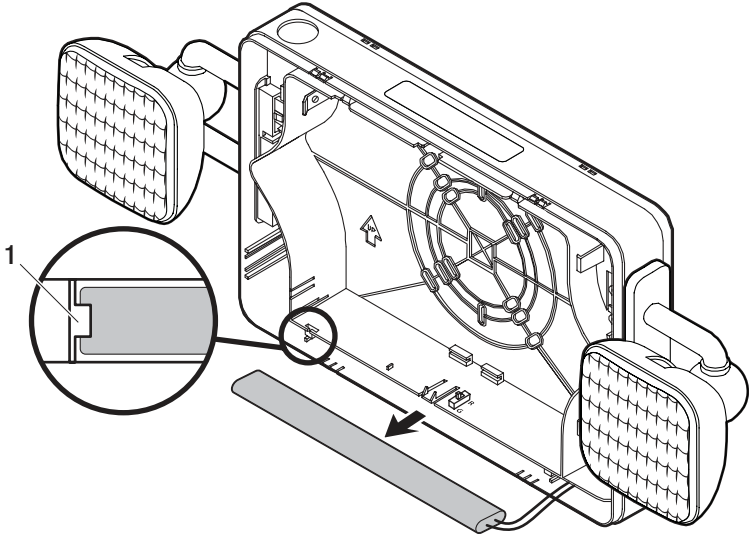

Troubleshooting

Problem	Possible Cause	Solution
The LED charge indicator does not illuminate.	AC power supply is off.	Ensure the unit has AC power supply. Restore the power at the breaker/fuse box.
	The unit is incorrectly wired.	Ensure the unit is wired correctly.
	The battery isn't connected.	Ensure the battery is connected.
The LED emergency heads do not illuminate.	The battery is discharged.	Verify the unit is properly wired and connected to an AC power source. Allow the unit to charge for 24 hours and then re-test.
	The battery isn't connected.	Ensure the battery is connected.

If the above troubleshooting does not resolve the issue, contact a qualified electrician, or call Commercial Electric customer service at 1-877-527-0313.



Questions, problems, missing parts? Before returning to the store,
call Commercial Electric Customer Service
8 a.m. - 7 p.m., EST, Monday-Friday, 9 a.m. - 6 p.m., EST, Saturday

1-877-527-0313

HOMEDEPOT.COM

Retain this manual for future use.