



REFRIGERATION AND  
AIR CONDITIONING

# Instructions

## AK-XM 103A



080R9285



RI8NJ402

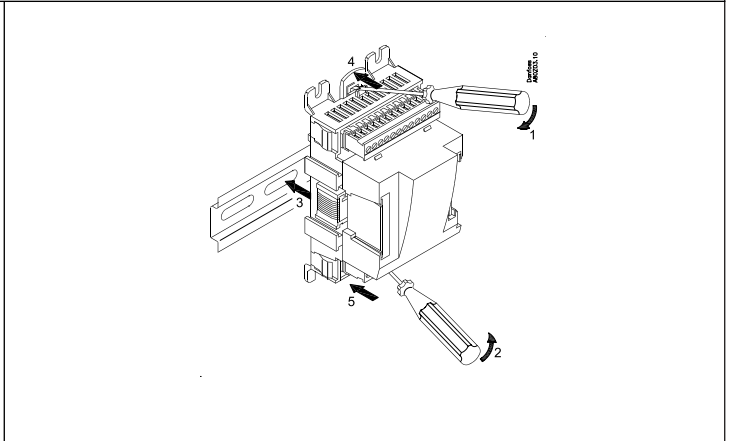
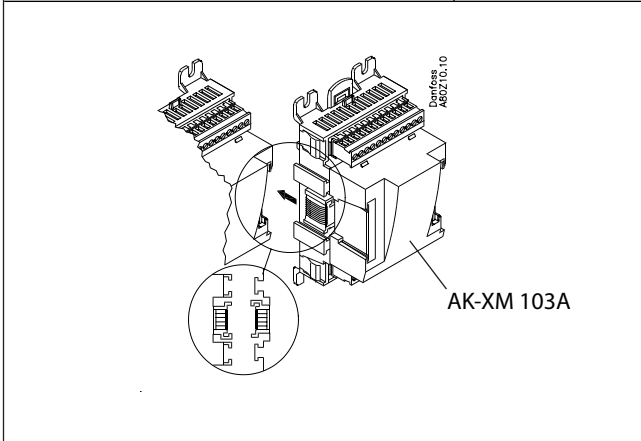
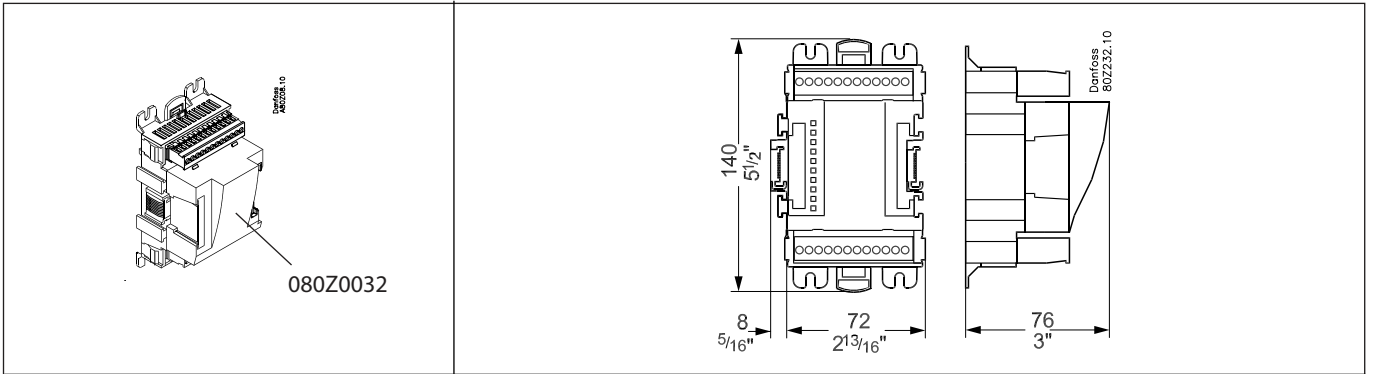

**CE**  
 $-20^{\circ} < t_{amb} < 55^{\circ}C$   
 $-0^{\circ}F < t_{amb} < 130^{\circ}F$   
 0 - 95% RH, non condensing  
 IP10 / VBG4  
 UL: E357029

**Warning**  
 Ensure power is disconnected before adding or removing Modules

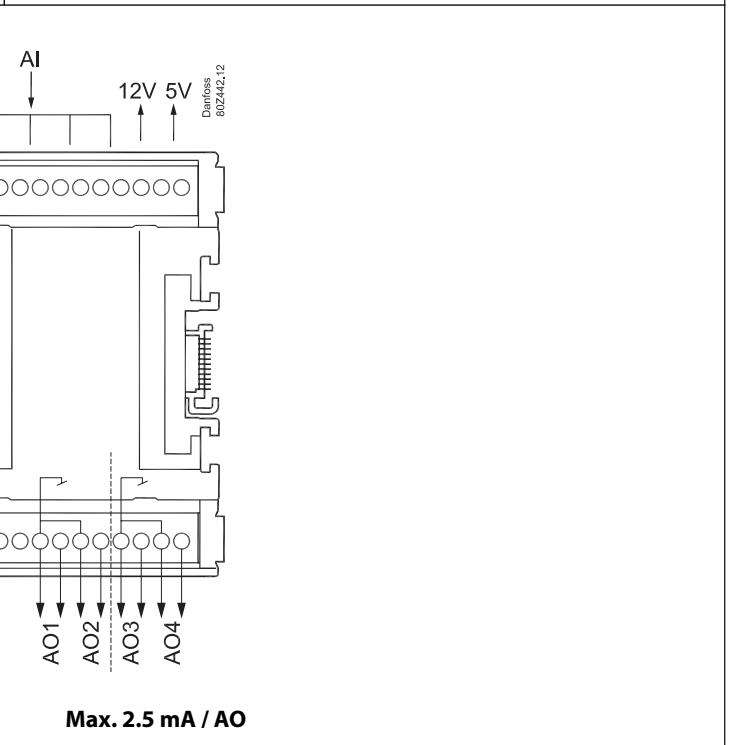
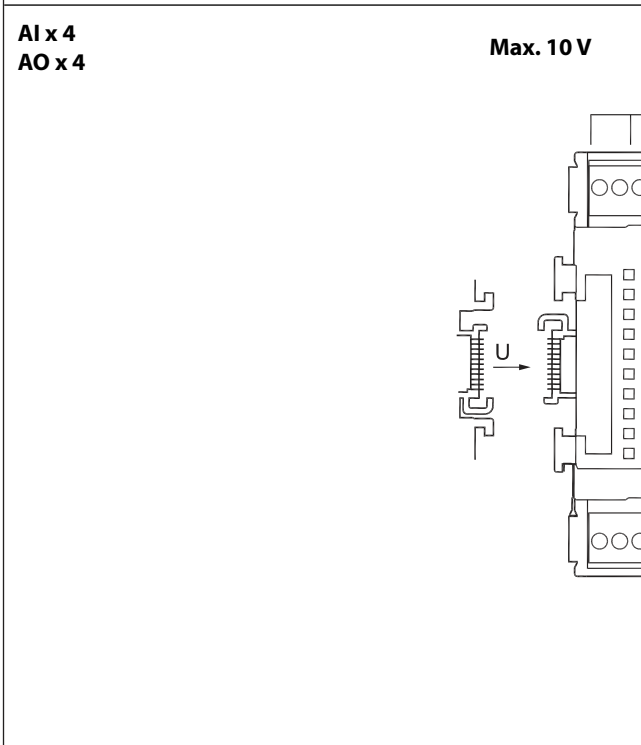

**Point**

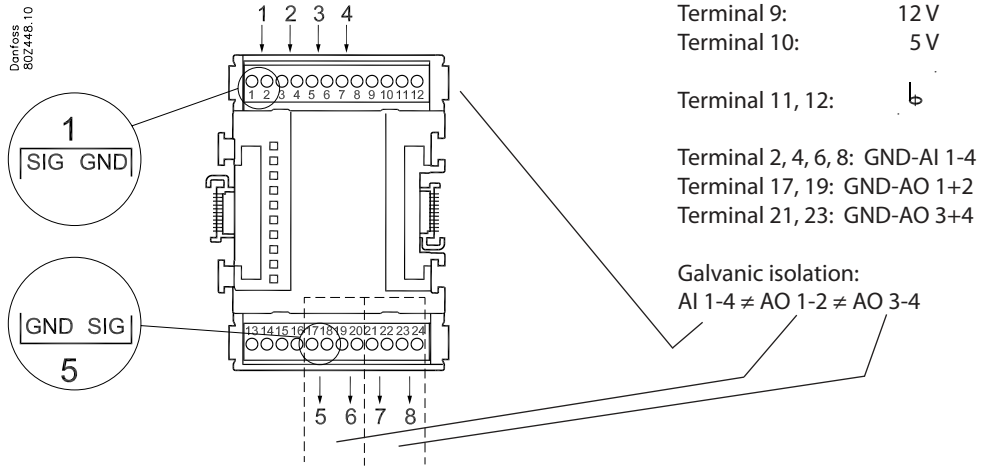

AI	Signal	Signal type
<b>S (sensor)</b> Pt 1000 ohm/0°C 	S1 S2 Saux1 SSA2 SdA	Pt 1000
<b>P (pressure)</b> AKS 32R  AKS 32 	POA POB PcA PcB	AKS 32R AKS 2050 MBS 8250 -1 - xx bar AKS 32 -1 - zz bar
<b>U (voltage)</b> 	...	0 - 5 V 0 - 10 V
<b>On/Off</b> 	Ext. Main switch Day/ Night Door	<b>Active at:</b> Closed / Open
<b>AO</b> 		0-10 V

**Address**

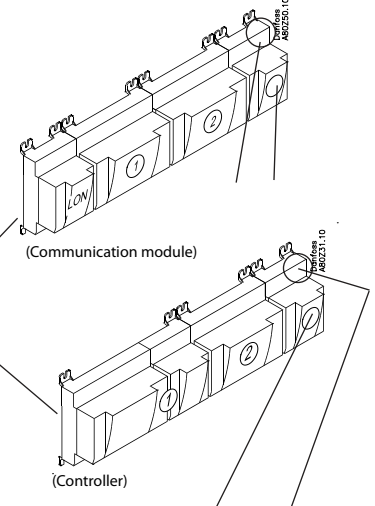

Signal	Signal type / Active at	Module	Point	Terminals
			1 (AI 1)	1 - 2
			2 (AI 2)	3 - 4
			3 (AI 3)	5 - 6
			4 (AI 4)	7 - 8
			5 (AO 1)	17 - 18
			6 (AO 2)	19 - 20
			7 (AO 3)	21 - 22
			8 (AO 4)	23 - 24

The Product contains electrical components And may not be disposed together with domestic waste. Equipment must be separate collected with Electrical and Electronic waste. According to Local and currently valid legislation.