

平面展开图:

DDPAI

mola E3

User Guide

1 PACKAGE CONTENTS

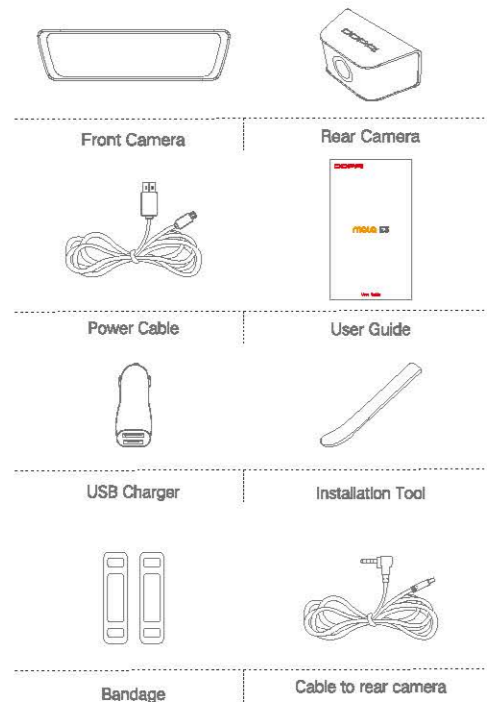

2 PRODUCT OVERVIEW

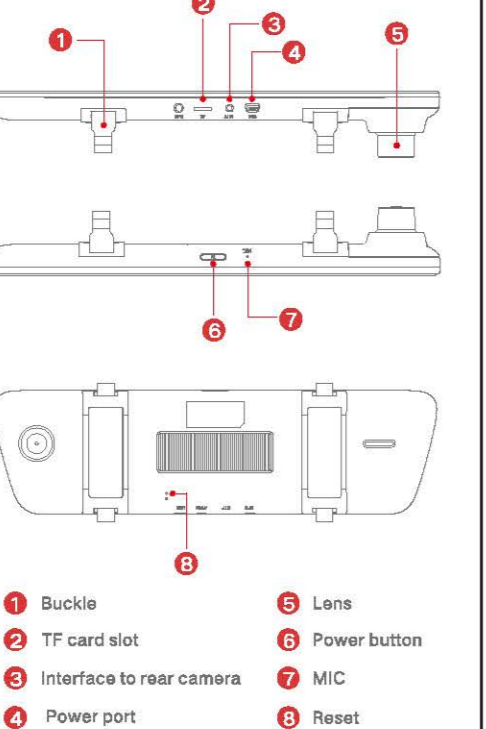

3 INSTALLATION

1. Bind the front camera on the original rearview mirror with the buckle, and adjust the Angle of the front camera after it is firmly installed.

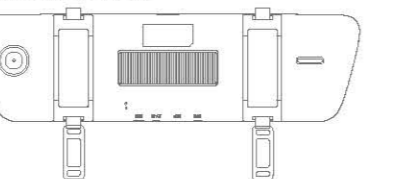

2. Connect the front camera and the car charger (plugged into cigarette lighter socket) through the power cable. As shown in below figure.

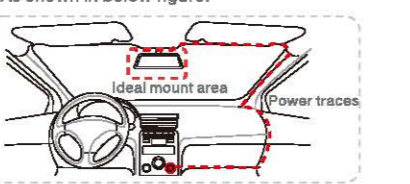

3. Install the rear camera. As shown in below figure.

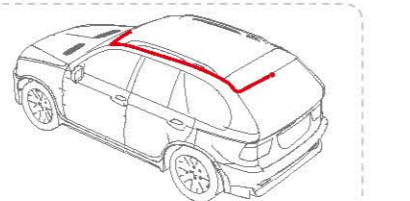

4. Turn on the engine after installation, The Dash Cam powers up and starts recording.

4 SCREEN INTRODUCTION

After power-on, tap screen to display the menu.

Switch to album: Swipe the screen to the right to enter the album page, you can view the playback video, emergency files, and snapshot files.

Adjust the preview area: Drag the trapezoid icon to move the current preview area.

Settings: Click the Settings icon to enter the camera Settings page.

Album: Click the icon to enter the album page to view the playback video, emergency files, and snapshot files.

Snapshot: Click the snapshot icon to capture photos. When capture with video clip is turned on in the App camera settings, a video of 10/20/30 seconds duration (settable) can be generated.

MIC: Click the MIC icon, open or close the recording.

Screen brightness: Slide up and down to adjust the screen brightness.

Switch to the front preview: Swipe the screen to the left to switch to the front preview.

5 INSTALL DDPAI APP

For Android / IOS phones, search for "DDPAI" in the Google Play Store or Apple App Store. Download the App and install it on your phone.

Note: In order to connect to camera Wi-Fi, please list the App in your trust application list and make sure the camera's Wi-Fi is on.

6 APP INSTRUCTION

6.1 On the Road

DDPAI users community, from here you can find nearby users, see the newest activities, user experience, installation tutorial etc.

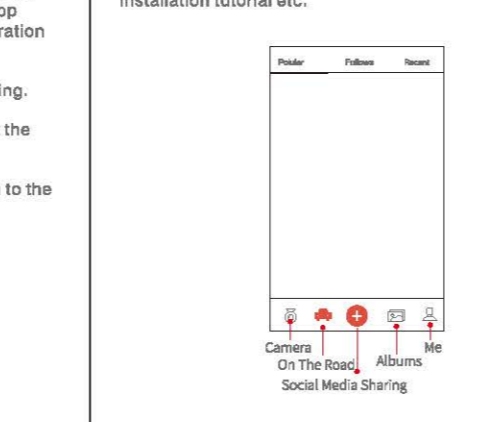

6.2 Camera

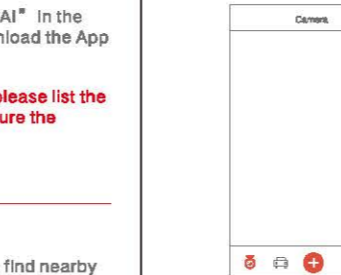

Rotate your smart phone or press expand icon, turn preview screen to landscape mode.

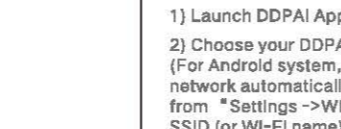

Playback: Tap and left/right drag timeline bar at the screen bottom to create the starting point of the recording you wish to preview, then tap on thumbnail when you have made your selection, or wait for 5 sec for buffering, now you can watch the history recording.

Pair Smart Phone to Dash Cam
1) Launch DDPAI App, tap on camera, then tap on +.
2) Choose your DDPAI Dash Cam from the network list (For Android system, App will start to search Dash Cam network automatically. For IOS phone: turn on WLAN from "Settings -> WLAN"). The Dash Cam's default SSID (or Wi-Fi name) is DDPAI_mola E3_XXXX.
3) Enter the password (the default password is '1234567890').
4) Click ADD CAMERA, wait a few seconds until the preview screen show.

Preview/ Playback
Connect to Dash Cam via direct Wi-Fi, to see recent videos and real-time display.
1) Open the DDPAI App, and add your Dash Cam.
2) Select Camera tab, then tap on button, this will bring you to preview page.

6.3 Social Media Sharing

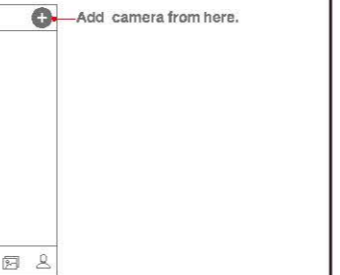

Tap on icon to share picture, video on social media like Facebook, Twitter etc.

6.4 Album

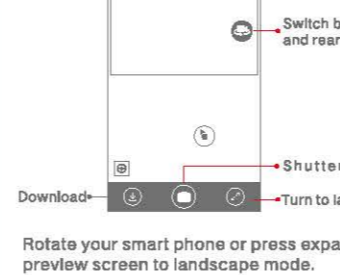

View images, videos and emergency clips, you also can edit and share them from here.

6.5 Me



Settings, help center and about us.

Settings: From here you can set Dash Cam's name and password, camera volume, resolution, G-Sensor sensitivity, parking mode, format sd card, and so on.

Help: How to use the Dash Cam.

About: Update firmware, contact us, Information about the Dash Cam.

7 DOWNLOAD IMAGES AND VIDEOS

Tap on from preview screen, you can select image or video to download.

Download image files:
Download manually by: Taping on download image files from preview screen, this will bring you to download page, you can select or just simply tap on the images which you want to download.
The image files can be downloaded automatically by: Going into "Me->Settings", turn on "Capture files auto download".

7 DOWNLOAD VIDEO FILES

- Select download video files from preview screen.
- Drag time line bar to create the starting point.
- Tap on download icon to start download.
- Tap on finish icon when you have made your selection.

8 SPECIFICATIONS

CPU: H.264 hardware encoding, HiSilicon processor
Touch Screen: 9.35 inch LCD touch screen
Front Camera Image Sensor: 4MP CMOS sensor
Rear Camera Image Sensor: 2MP CMOS sensor
Front Camera Lens: 130° wide angle, F1.4
Rear Camera Lens: 125° wide angle, F2.0
Image Resolution: front 2560X1440, rear 1920X1080
Video Resolution: Front Output 2560X1440, Front Preview 640*360; Rear Output 1920X1080; Rear Preview 640*360
Storage: Class 10 TF card up to 128 GB, loop recording
Wi-Fi: Wi-Fi/ 2.4GHz
Video Output: Wireless video output, support Android/iOS device
G-Sensor: Built-in 3 Gyro sensor, motion locking, adjustable sensitivity via App or touch screen
RAM: 1GB

9 FCC STATEMENT

This device complies with Part 15 of the FCC Rules. Operation is subject to the following two conditions:
(1) This device may not cause harmful interference.
(2) This device must accept any interference received, including interference that may cause undesired operation.

Warning: Changes or modifications not expressly approved by the party responsible for compliance could void the user's authority to operate the equipment.

NOTE: This equipment has been tested and found to comply with the limits for a Class B digital device, pursuant to Part 15 of the FCC Rules. These limits are designed to provide reasonable protection against harmful interference in a residential installation. This equipment generates uses and can radiate radio frequency energy and, if not installed and used in accordance with the instructions, may cause harmful interference to radio communications. However, there is no guarantee that interference will not occur in a particular installation. If this equipment does cause harmful interference to radio or television reception, which can be determined by turning the equipment off and on, the user is encouraged to try to correct the interference by one or more of the following measures:

- Reorient or relocate the receiving antenna.
- Increase the separation between the equipment and receiver.
- Connect the equipment into an outlet on a circuit different from that to which the receiver is connected.
- Consult the dealer or an experienced radio/TV technician for help.

RF warning statement:

The device has been evaluated to meet general RF exposure requirement. The device can be used in portable exposure condition without restriction.

FCC Radiation Exposure Statement:

This equipment complies with FCC radiation exposure limits set forth for an uncontrolled environment. This equipment should be installed and operated with minimum distance 20cm between the radiator & your body.

CAUTION

- The product's optimal temperature range is -20 °C — 70 °C.
- Install the device near the rear-view mirror to obtain the best open-field view. Do NOT install the Dash Cam in a location that will obstruct your required driving view.
- The Dash Cam supports a class 10 micro SD card up to 128GB. Format the SD card via App before using, and format it regularly to maximize the lifetime of the memory card.
- Do not use cardboard, paper towel, or napkin to clean the lens.
- Do not attempt to repair, dismantle, or modify the Dash Camera hardware by yourself.
- Do not install the product in an environment with high humidity, or combustible gases or liquids.
- Drawings for illustration purpose only. Actual product may vary due to product enhancement.

CUSTOMER SUPPORT

For customer support and firmware updates please visit www.en.ddpai.com.
You can also email a Customer Support expert at feedback@ddpai.com.

OTHER

This product is made in China.
Manufacturer Name: DDPAI Technology Co., Ltd
Manufacturer Address: Floor 12, Yihua finance building, software park, Yuehai Sub district, Nanshan district, Shenzhen
The Warranty Period: 1 year
Recommended life: 2 year