

DOMYOS

# Run 100E-B

---

 103.6 lb  
47 kg

 MAX 286.6 lb  
MAXI 130 kg

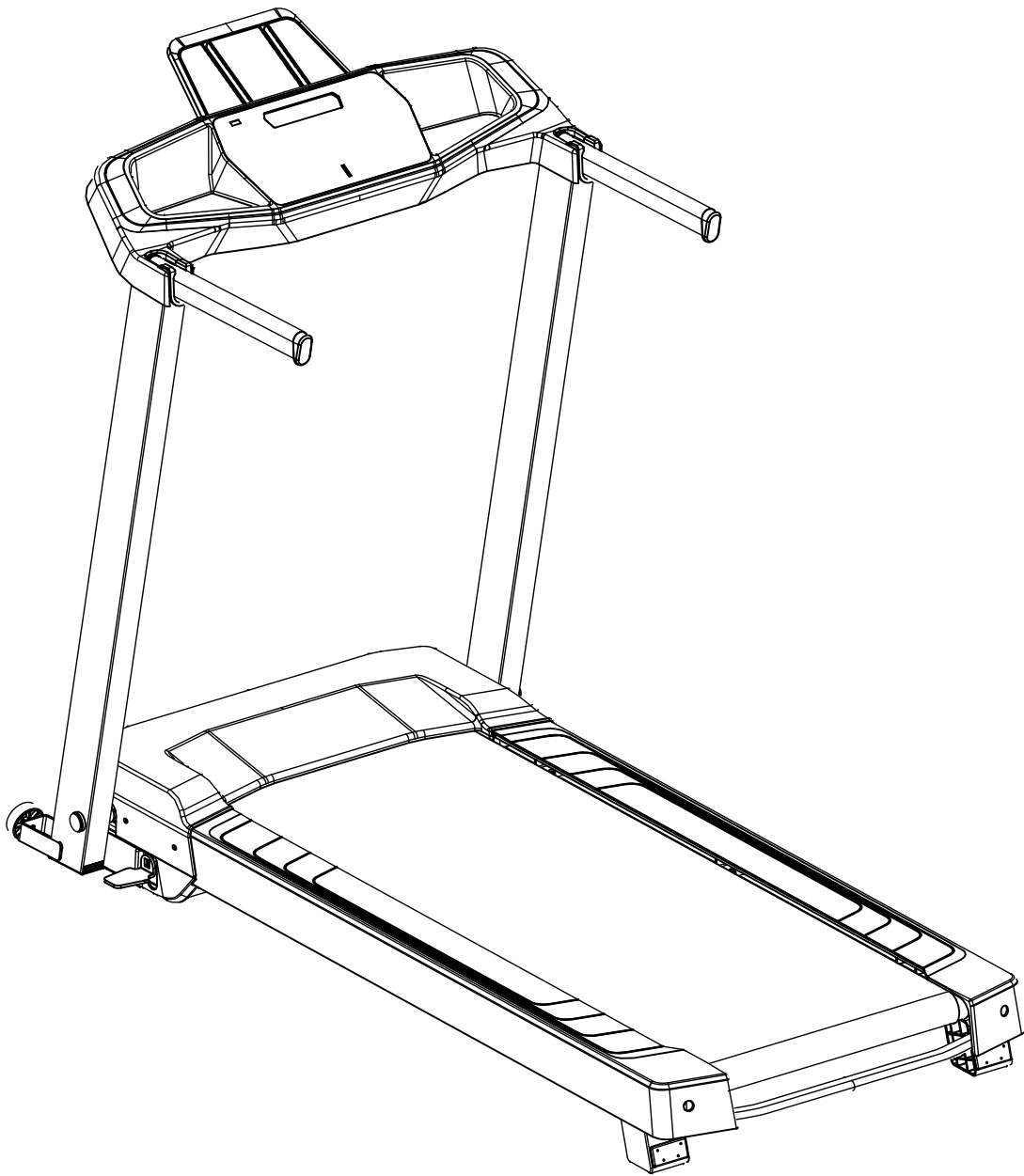

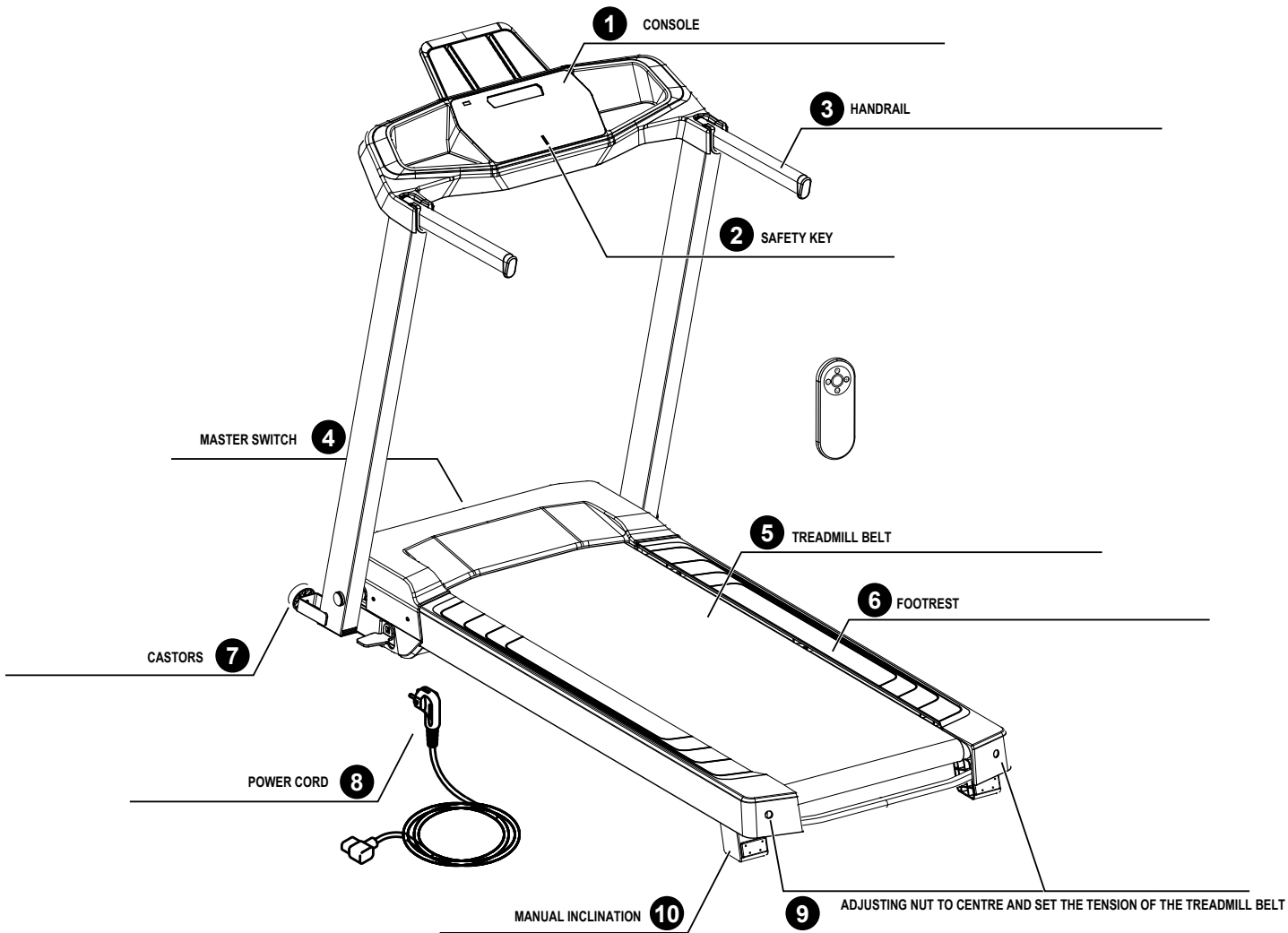

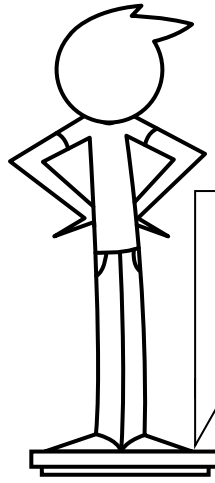
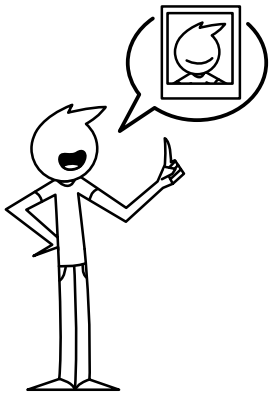

**MAXI**

**130 kg  
286.6 lbs**

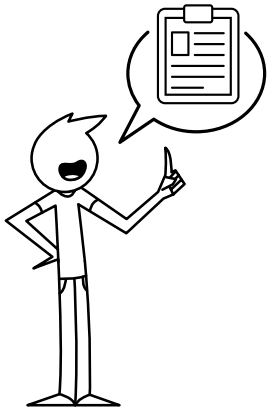

115 cm  
45.2 in

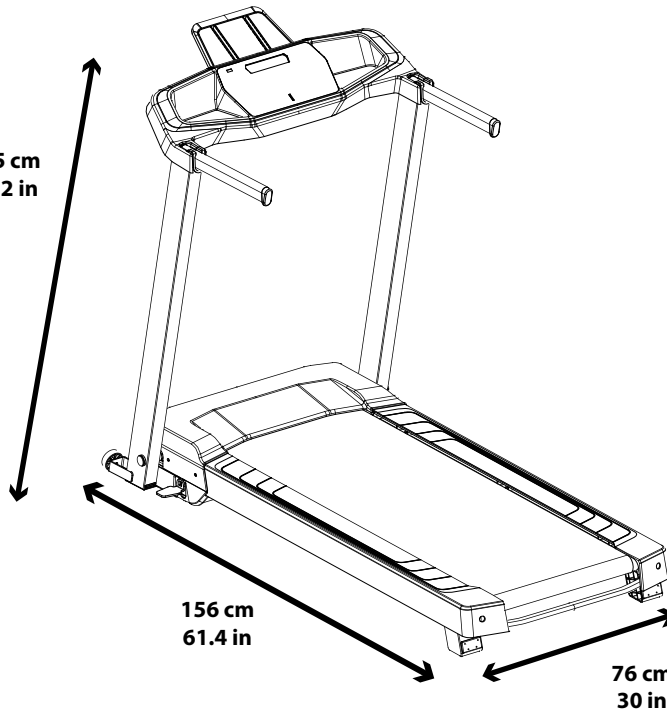

**47 KG  
103.6 LBS**

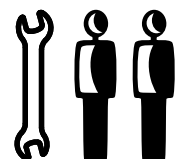
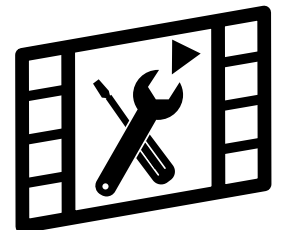
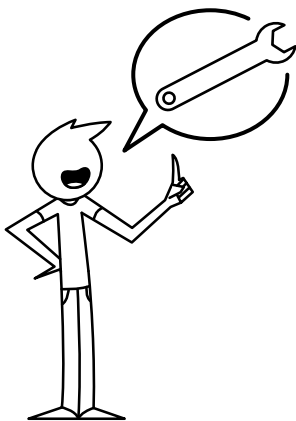

**45 min**

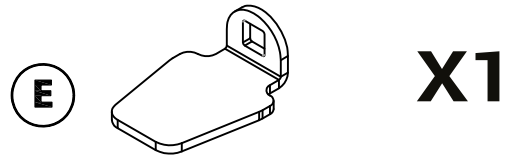
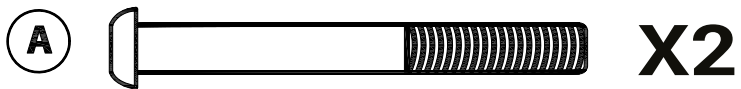
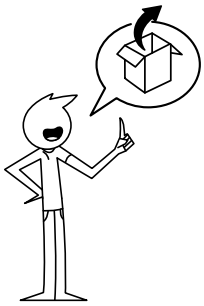

**1**

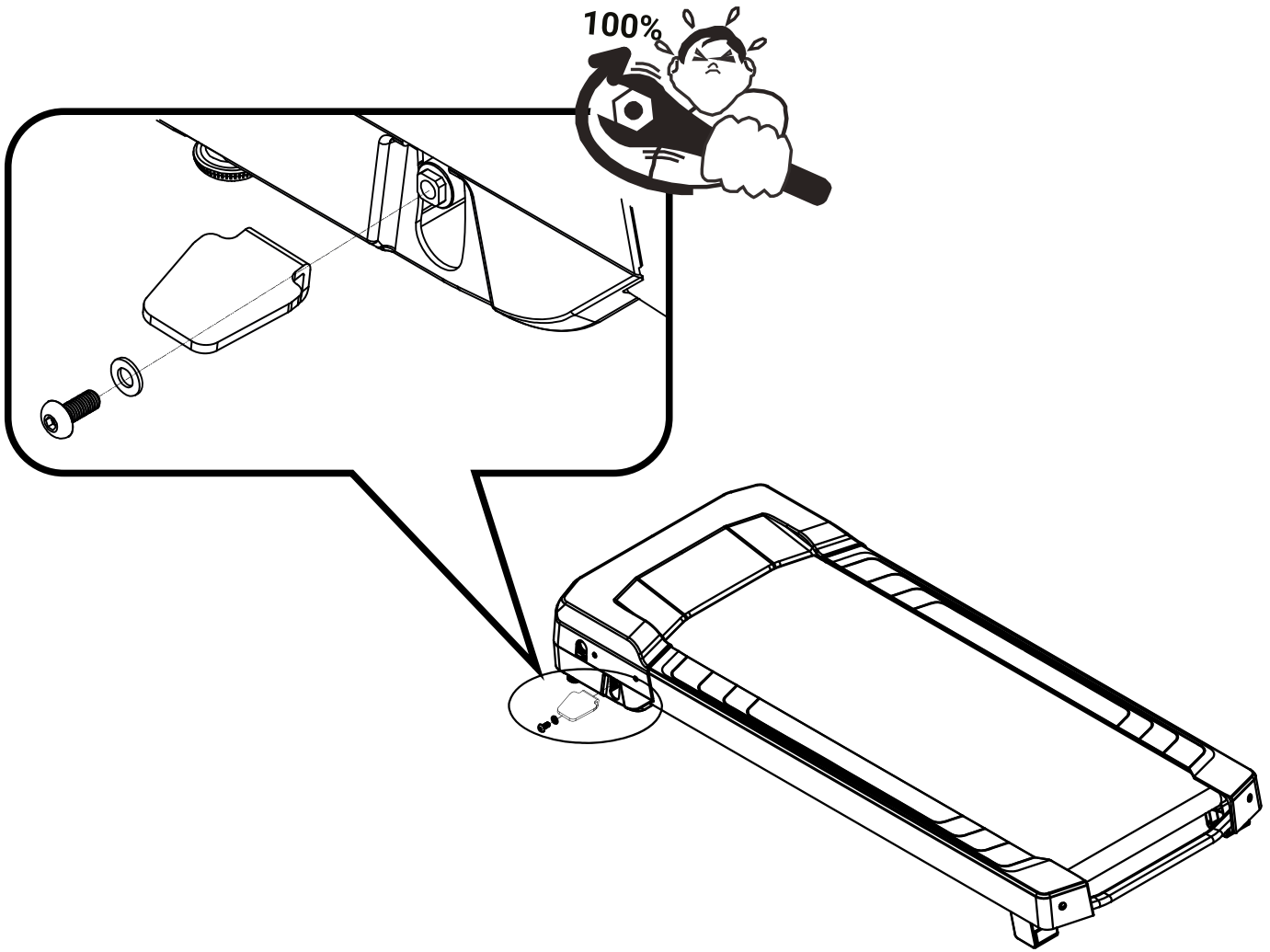
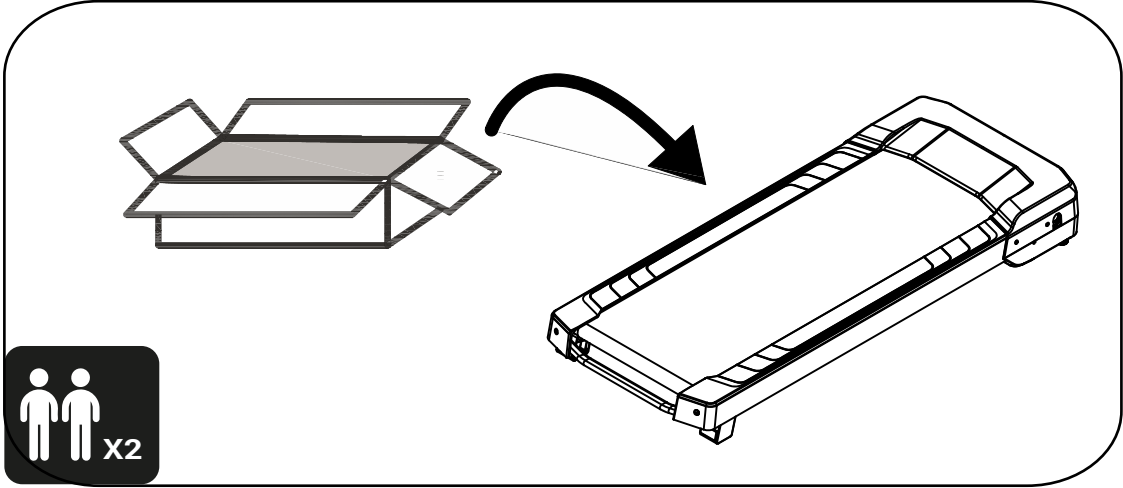

**2**

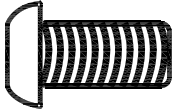
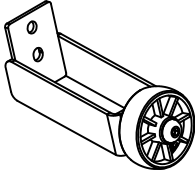
**B**  **X4**       **X2**

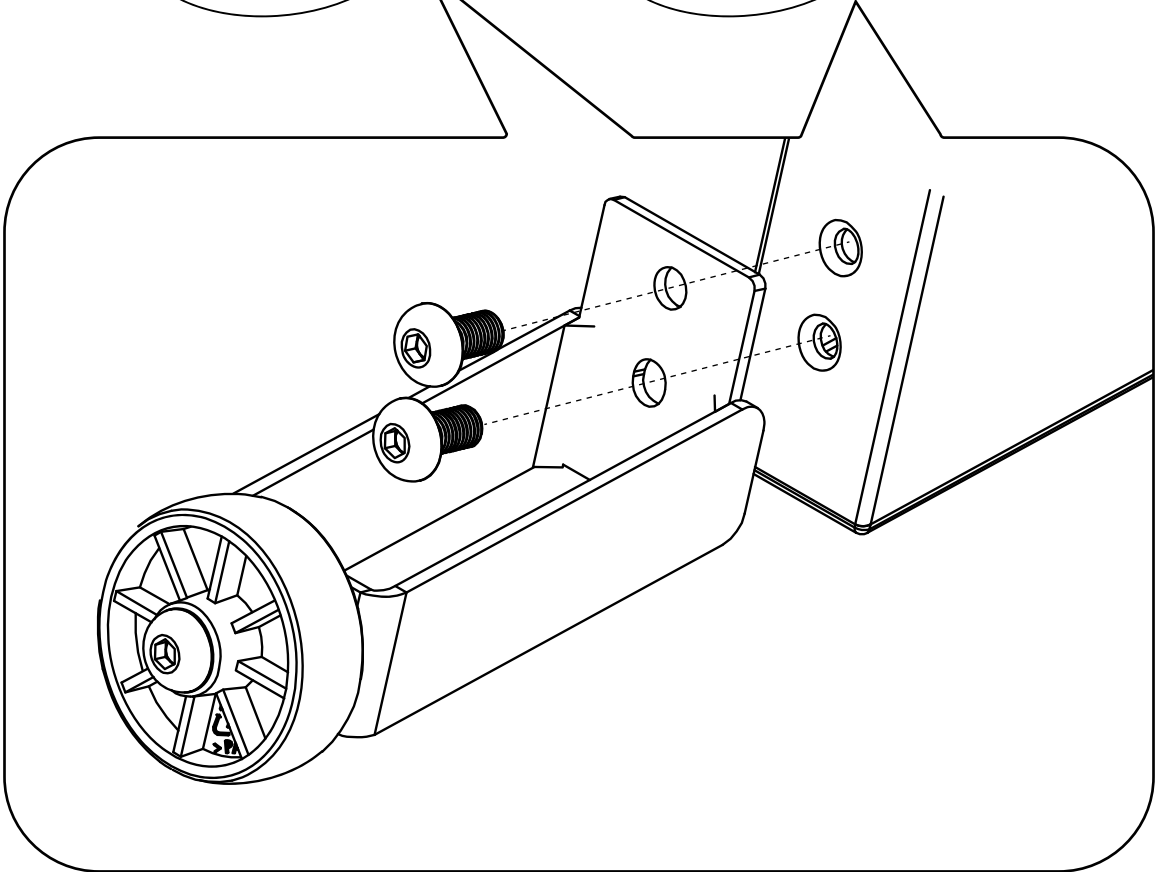
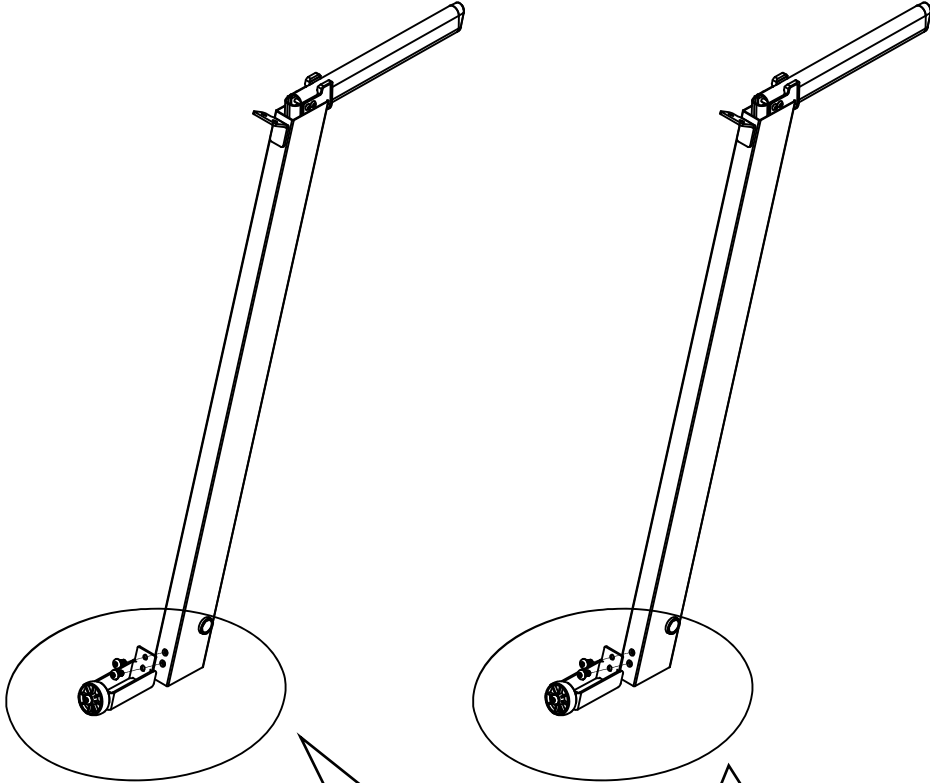

# 3

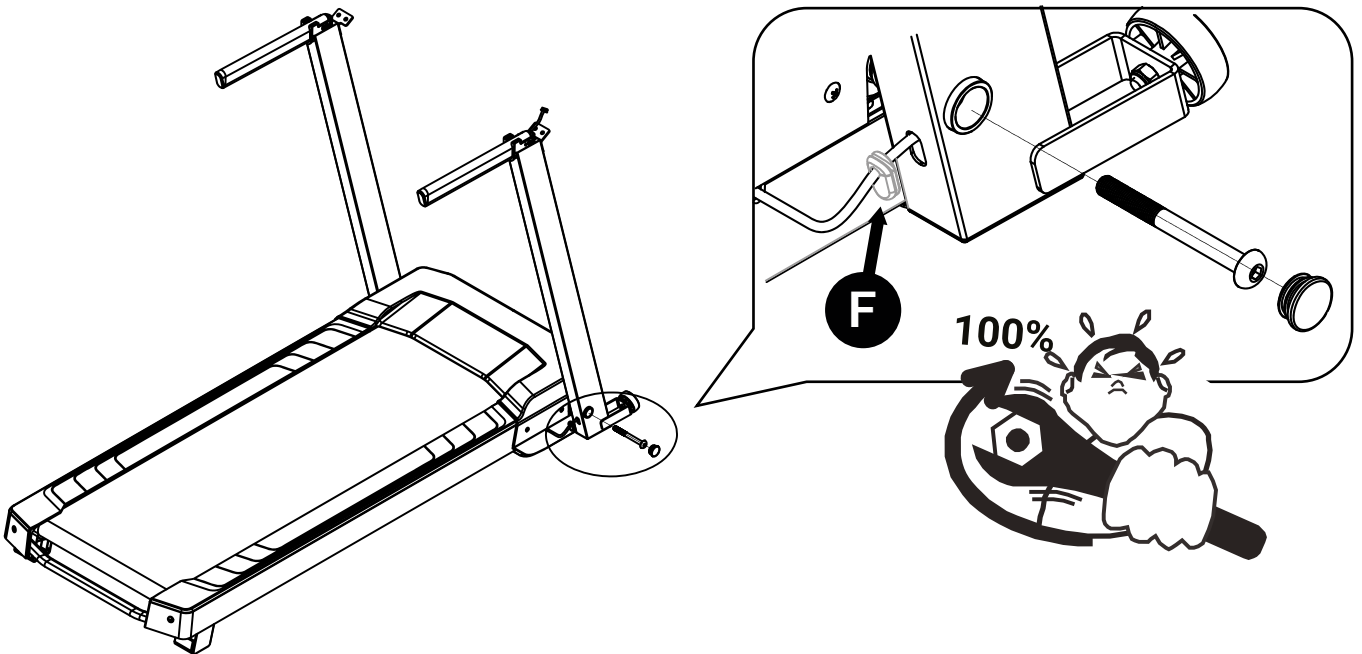
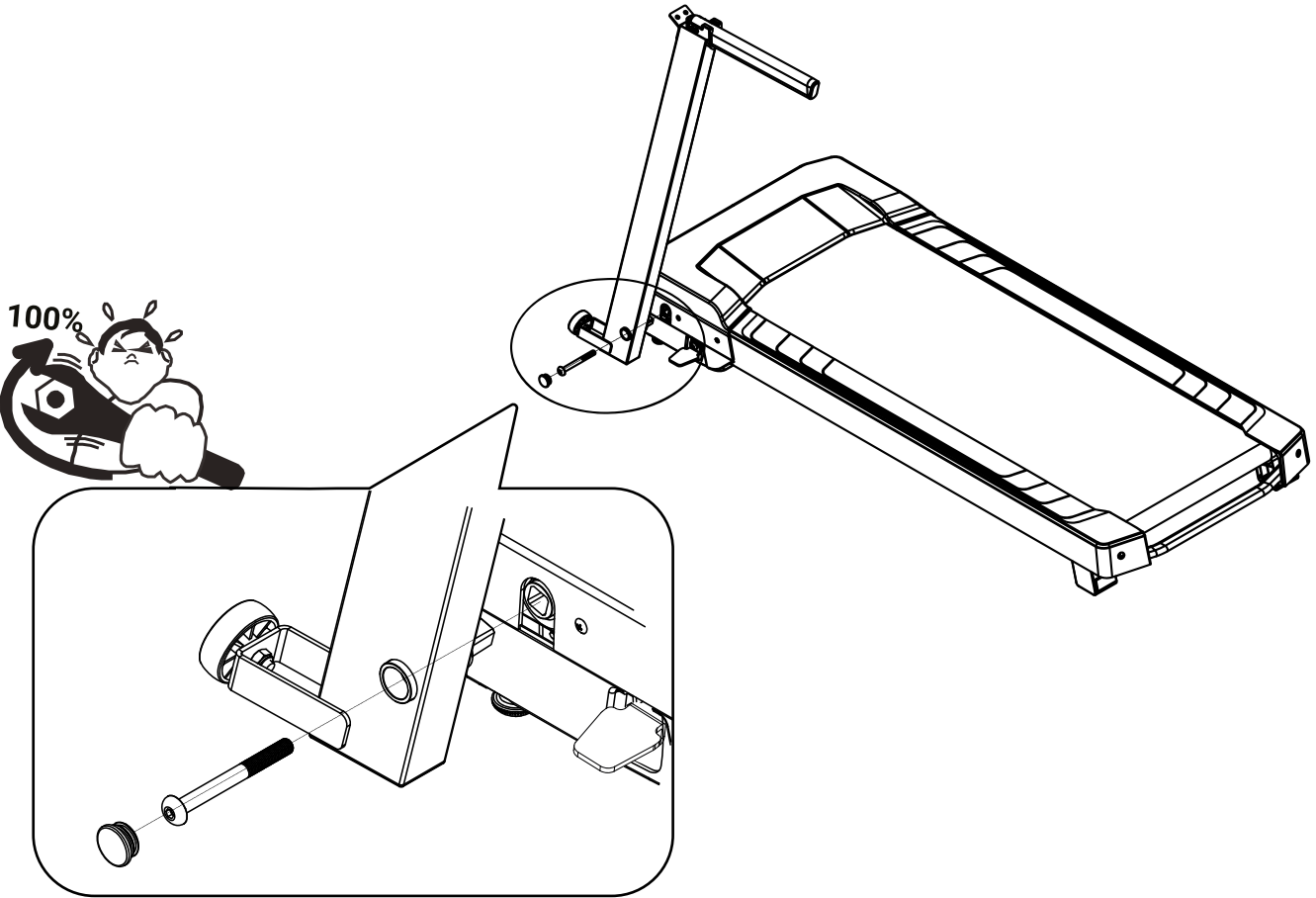
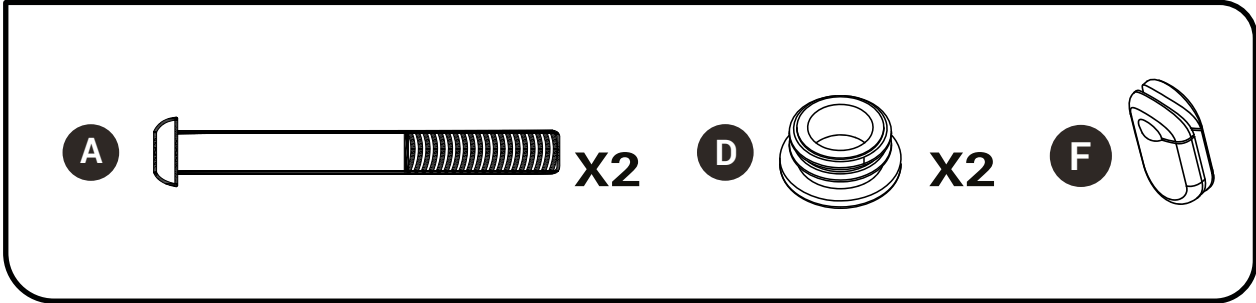

4

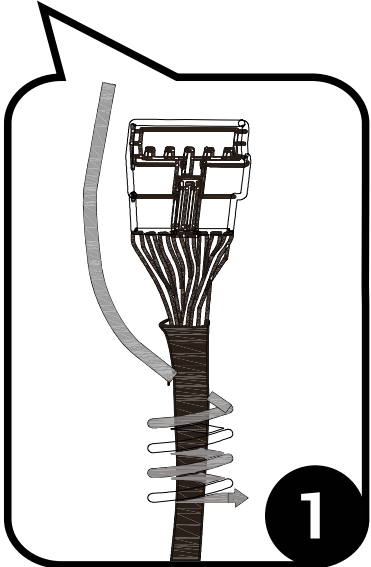
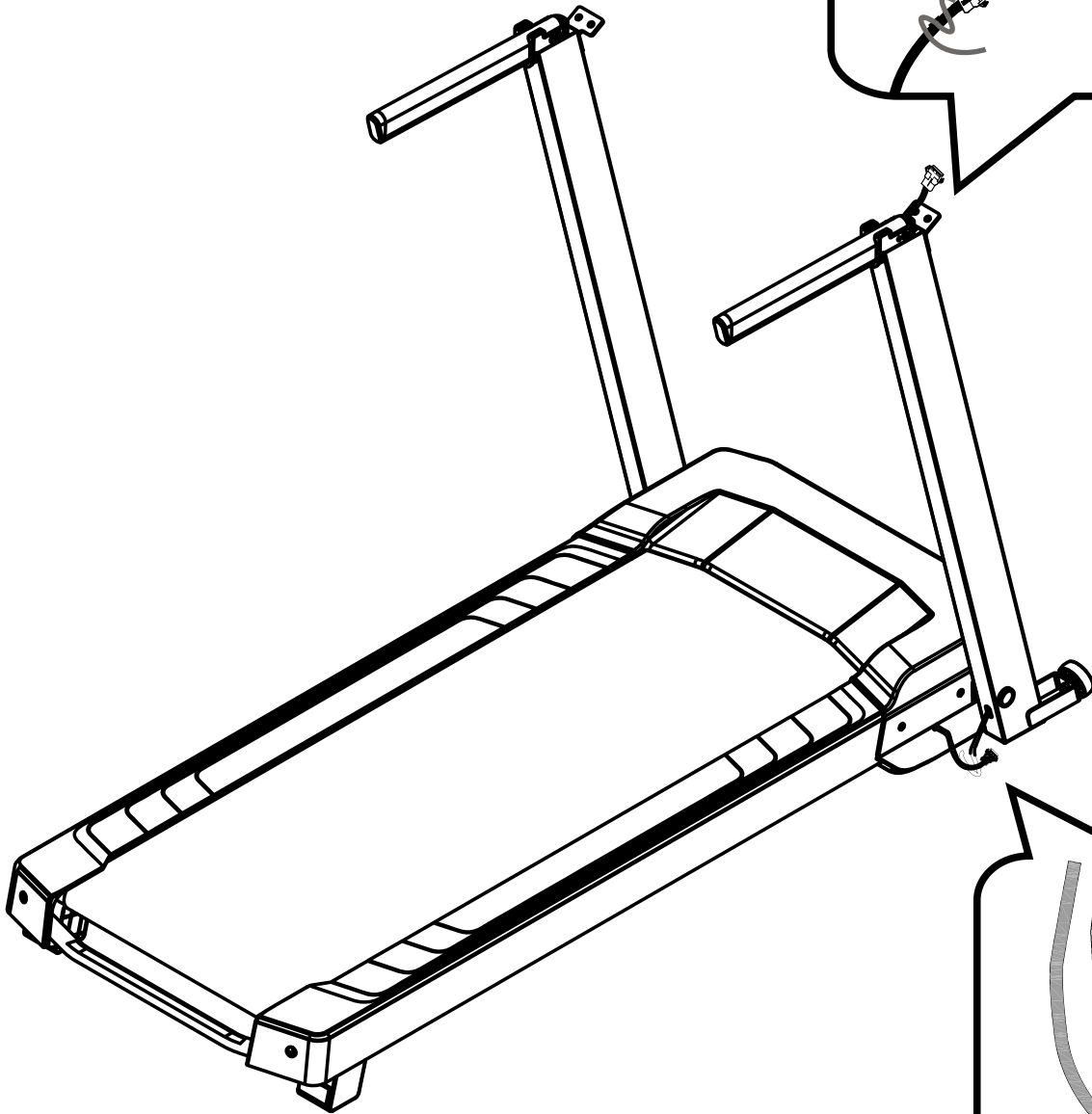
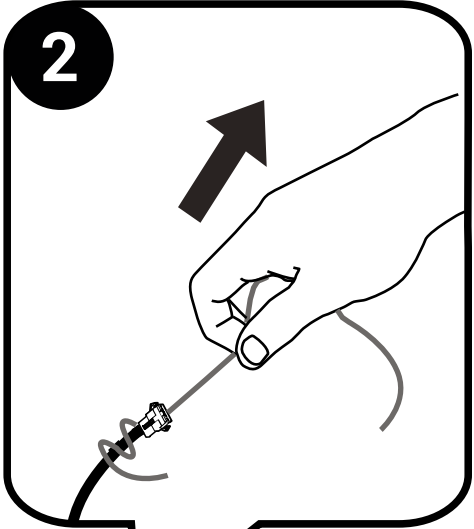
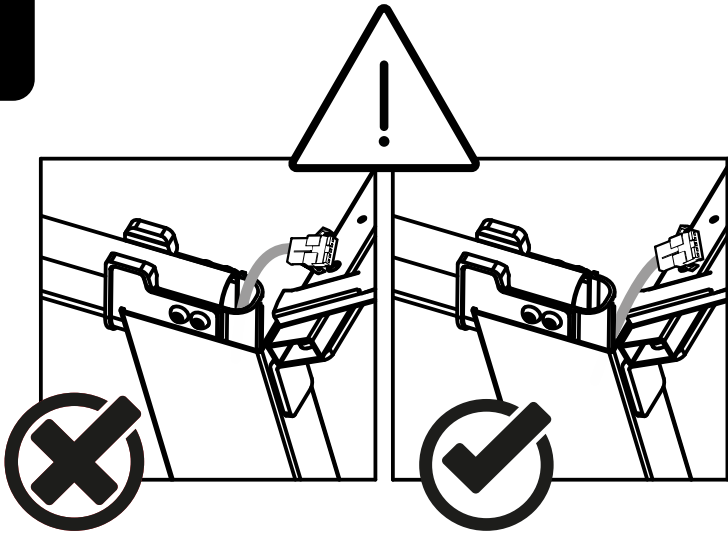

**5**

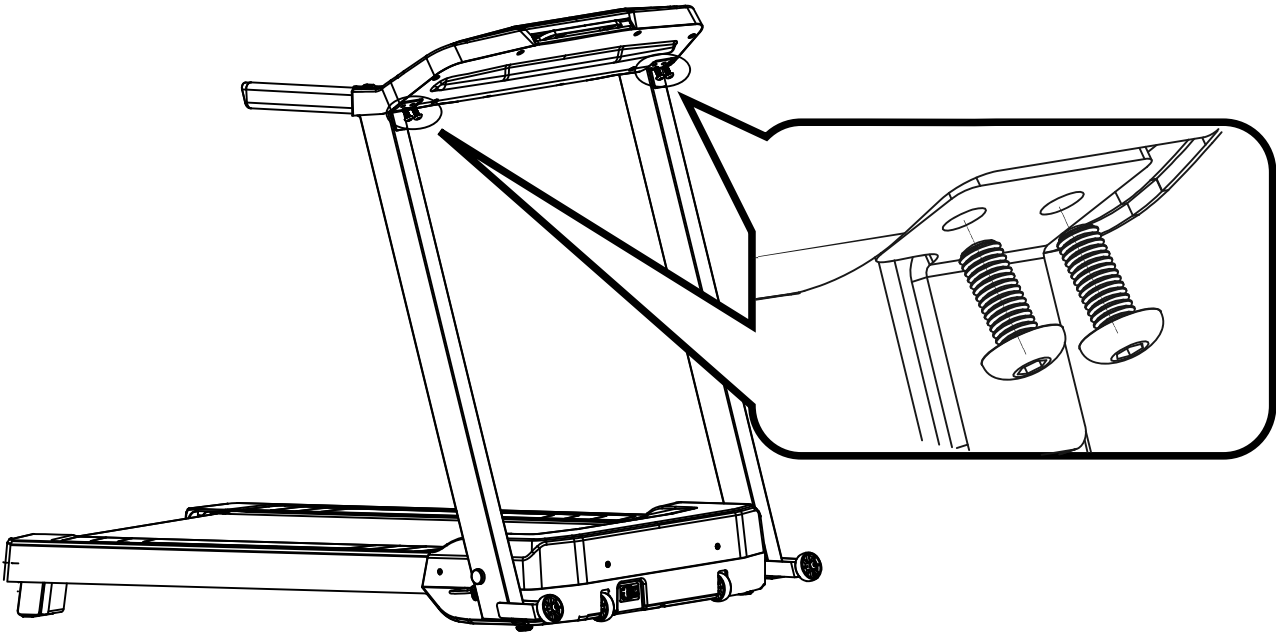
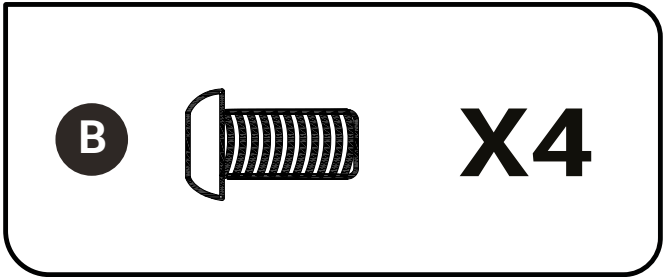
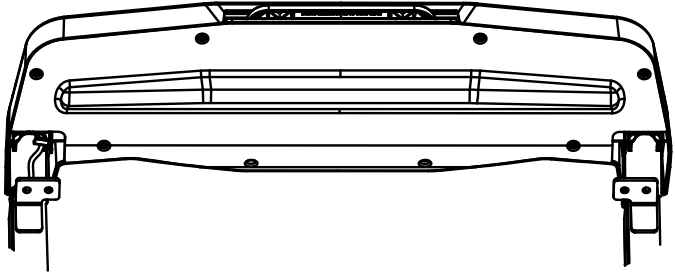
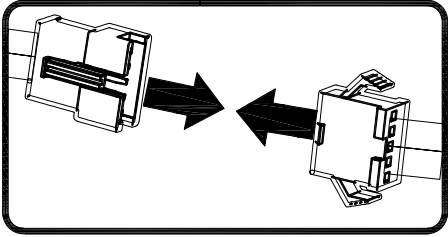
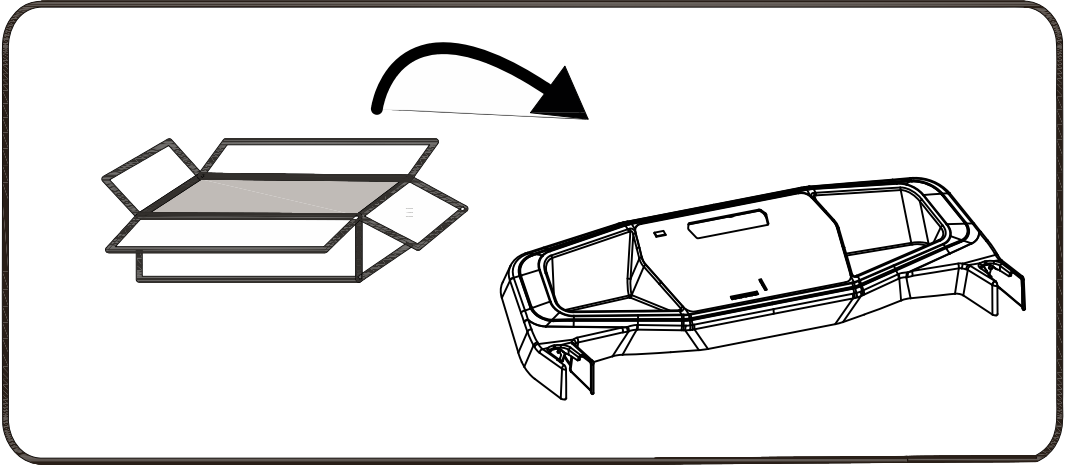

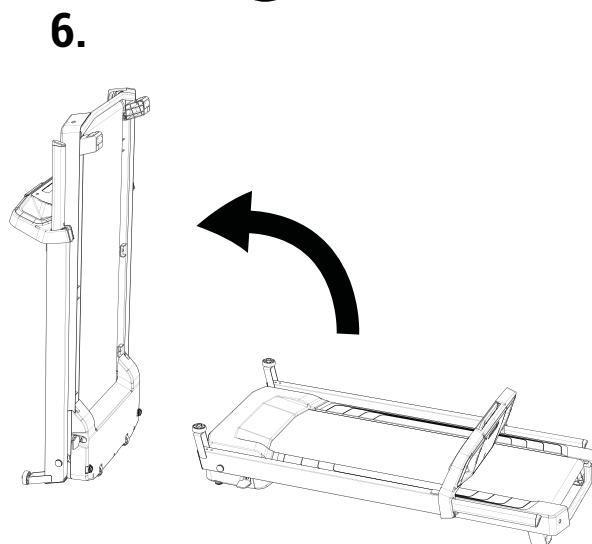
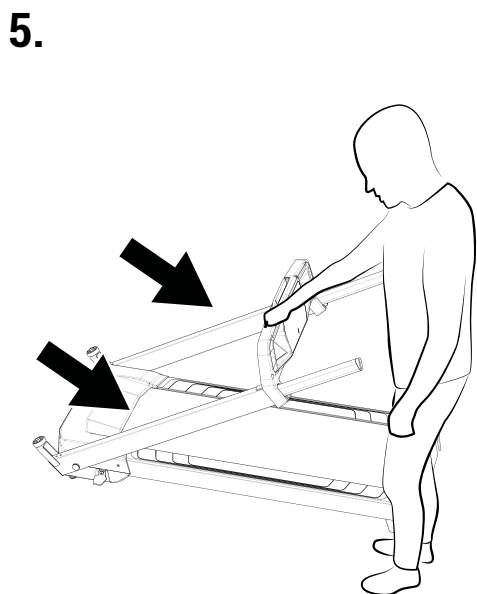
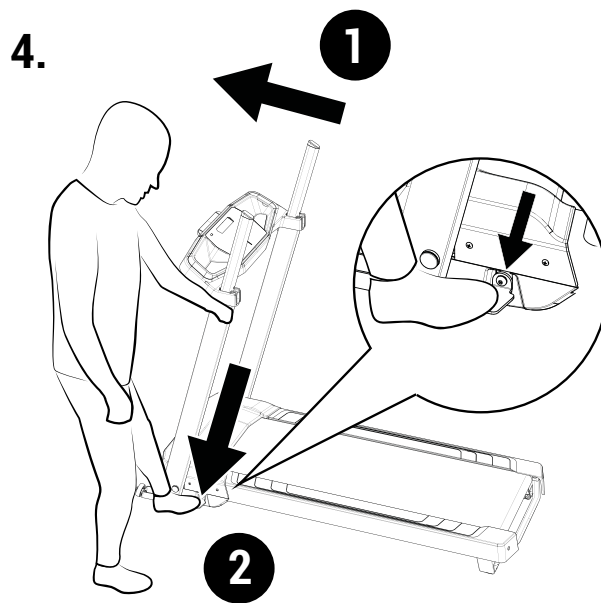
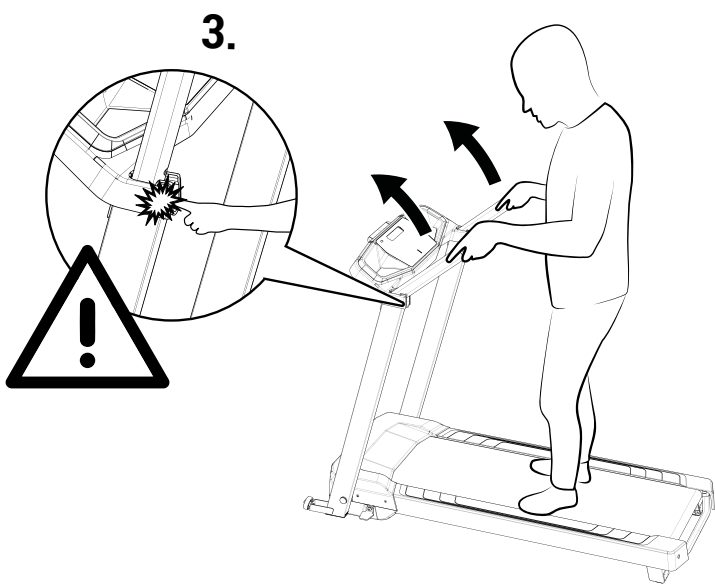
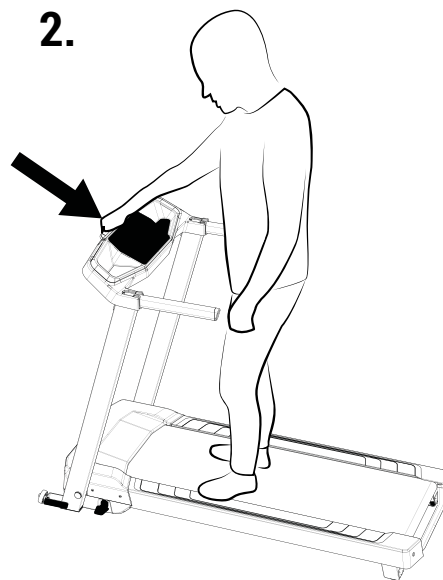

# MOVING

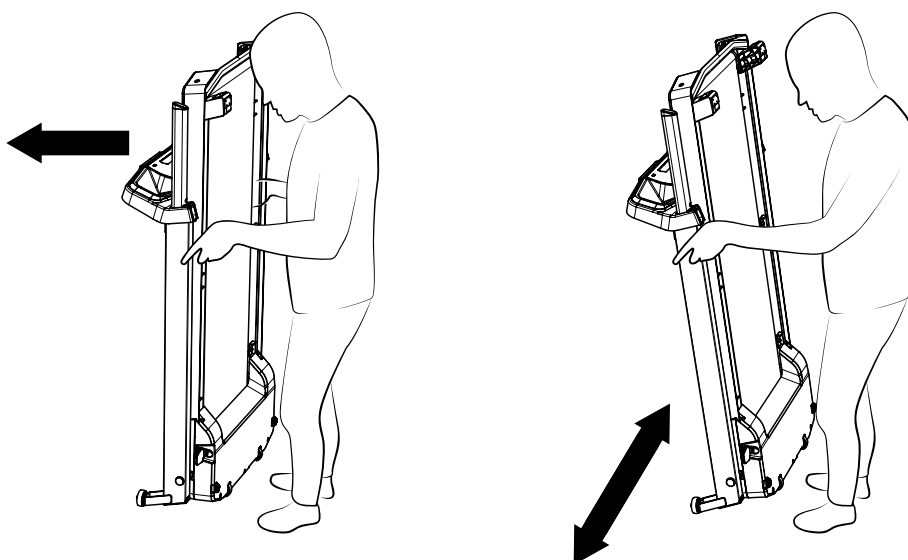
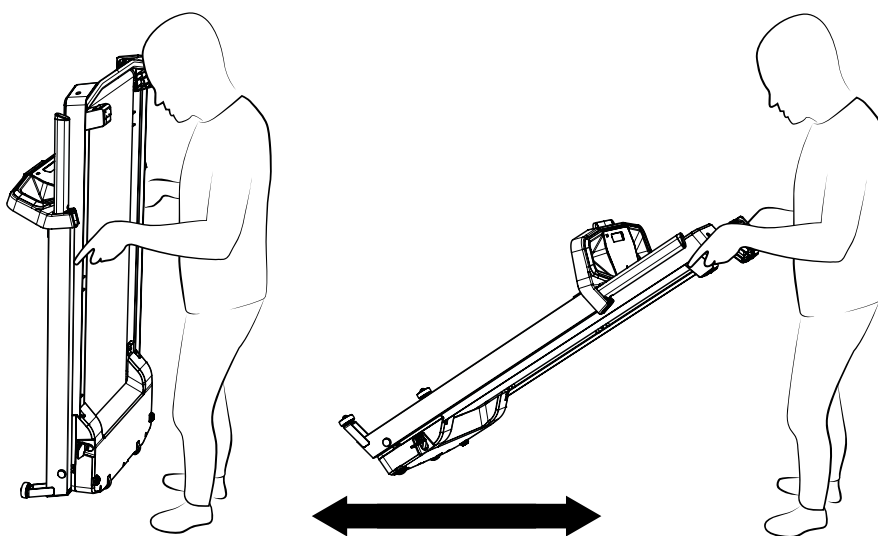

# MANUAL INCLINATION

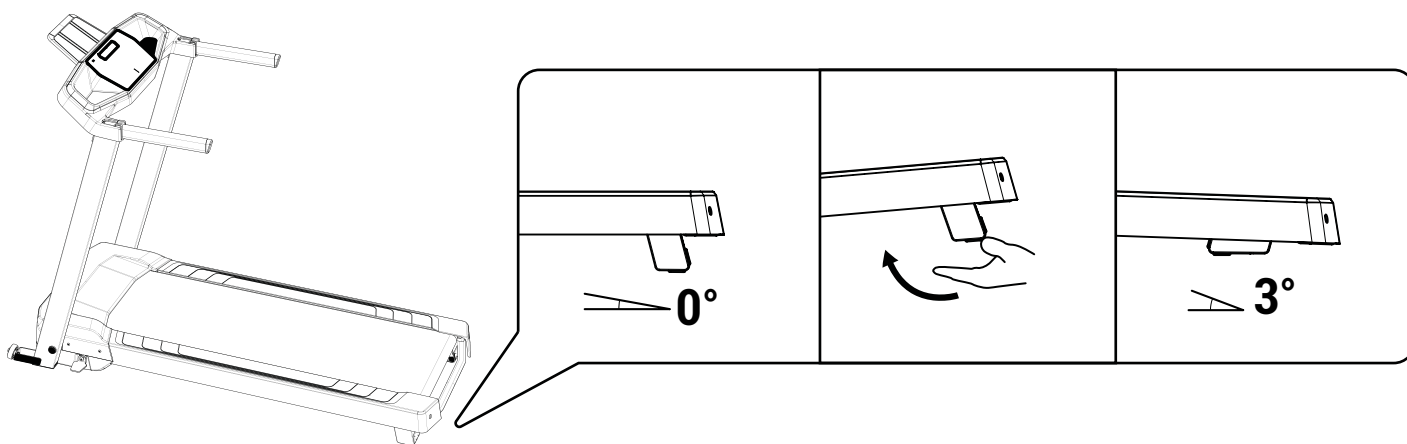



# CALORIE BURN

Calories



SPEED (km/h)

**Calorie 1**

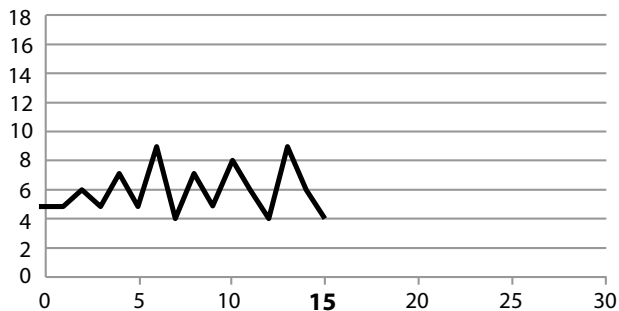

**Calorie 2**

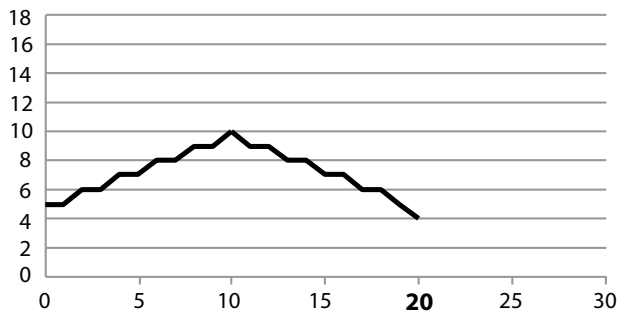

**Calorie 3**

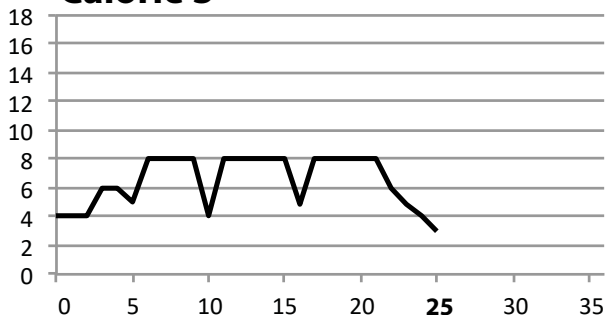

**Calorie 4**

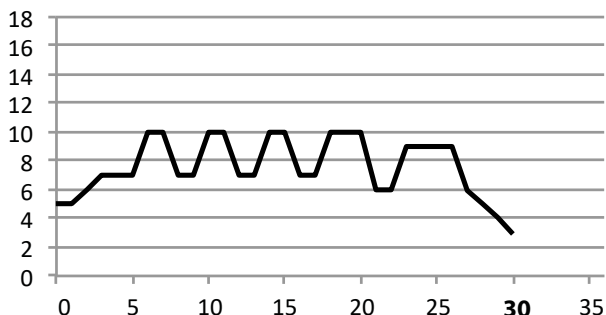

**Calorie 5**

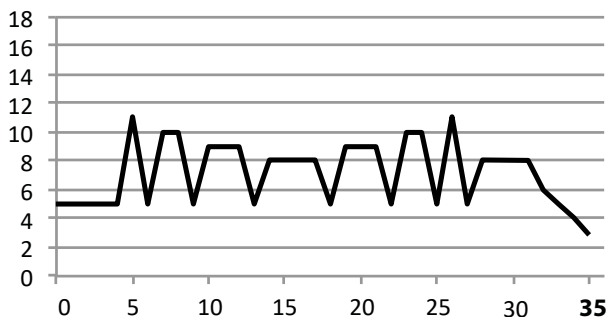

**Calorie 6**

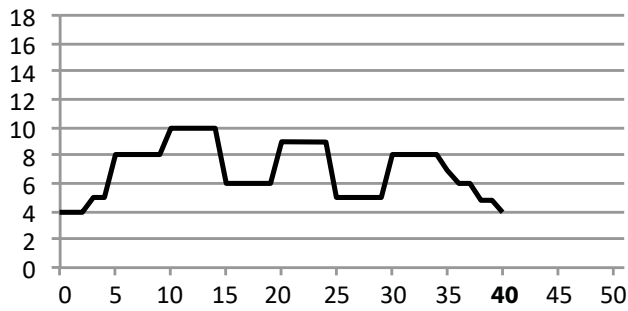

**Calorie 7**

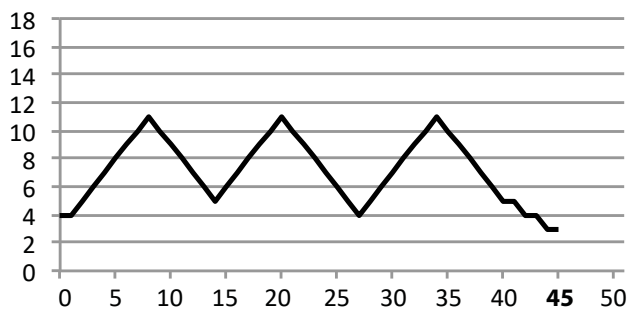

**Calorie 8**

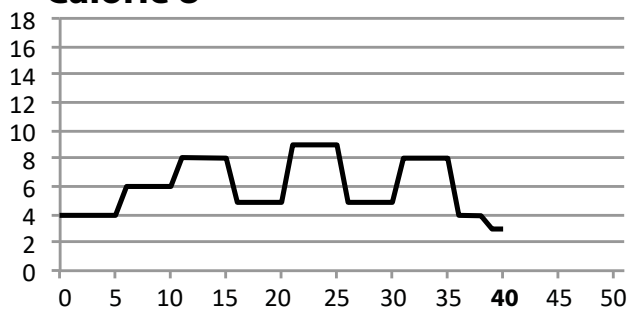

**Calorie 9**

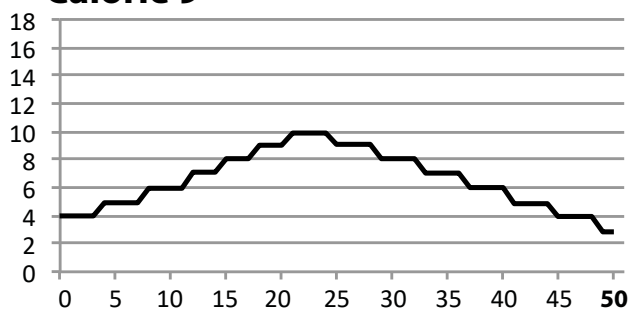

**Calorie 10**

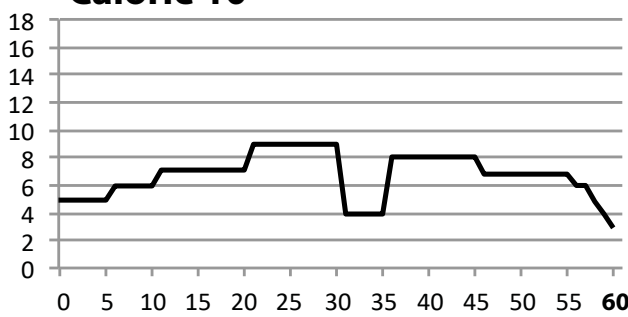

# ENDURANCE

ENDURANCE



— Speed (km/h)

### Endurance 1

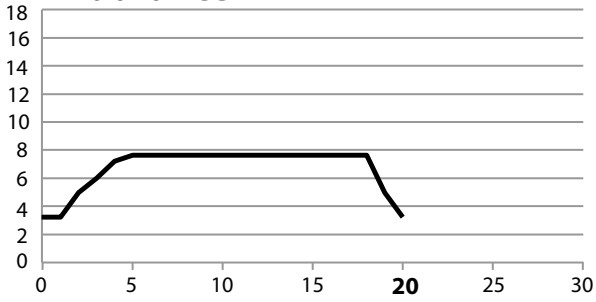

### Endurance 6

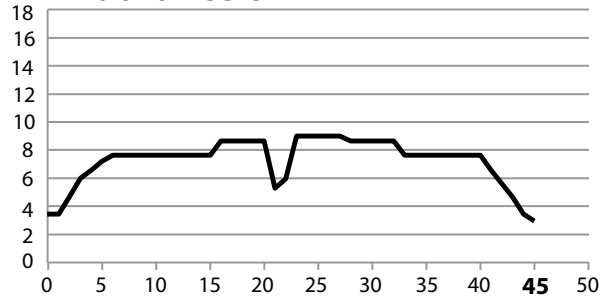

### Endurance 2

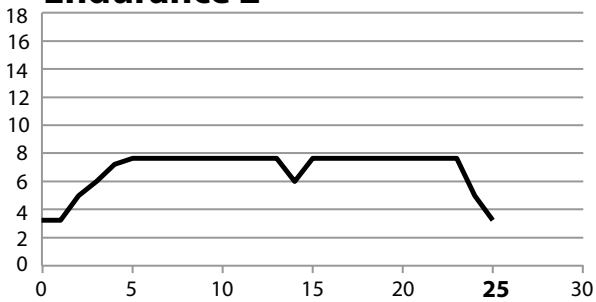

### Endurance 7

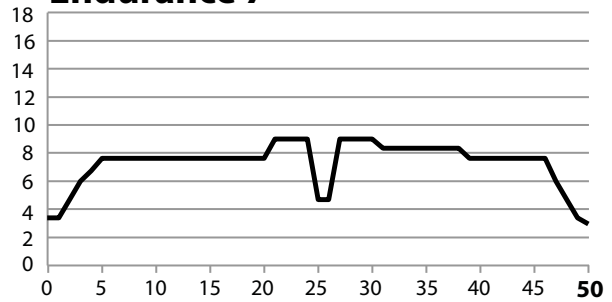

### Endurance 3

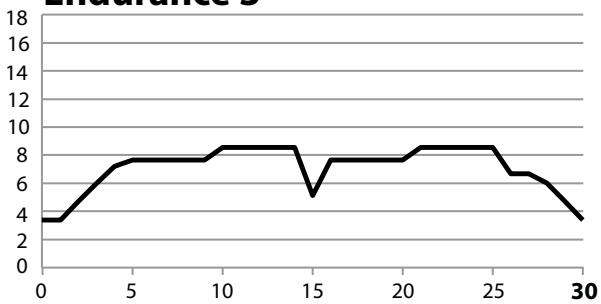

### Endurance 8

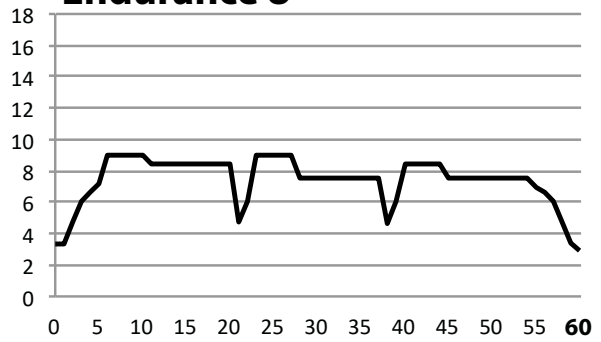

### Endurance 4

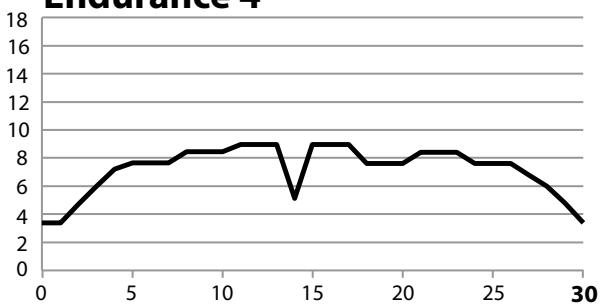

### Endurance 9

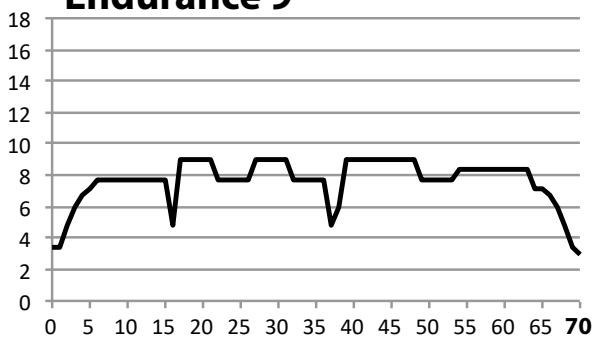

### Endurance 5

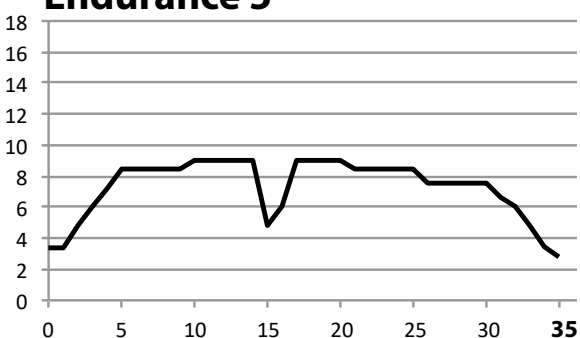

### Endurance 10

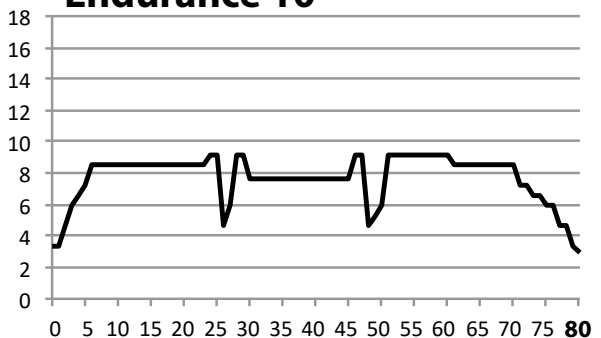



# TRAINING

INTERVAL



— Speed (km/h)

### Training 1

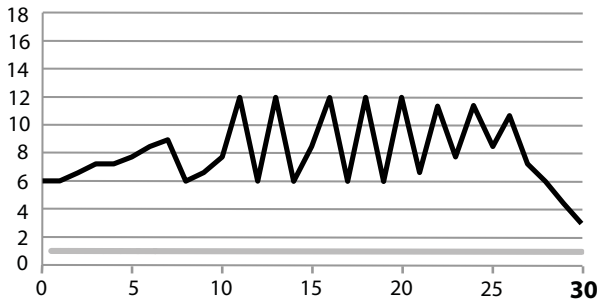

### Training 6

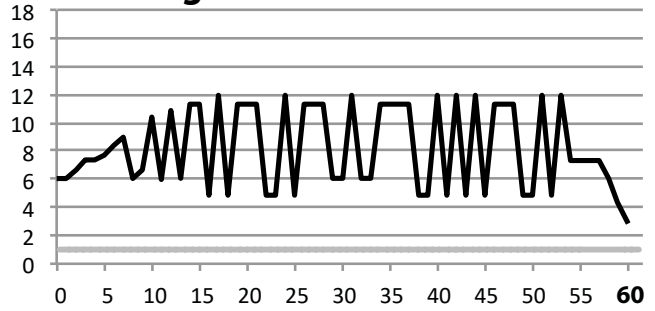

### Training 2

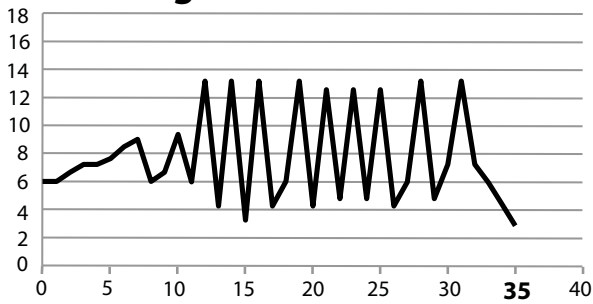

### Training 7

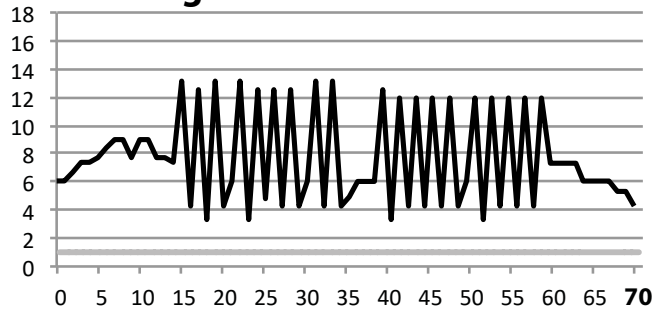

### Training 3

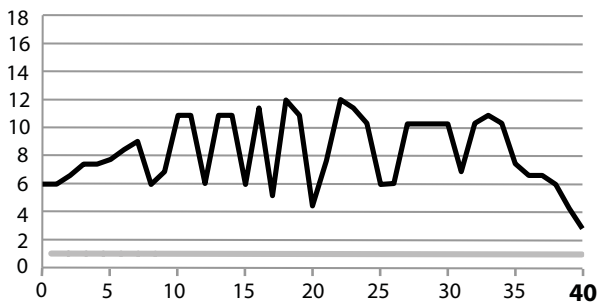

### Training 8

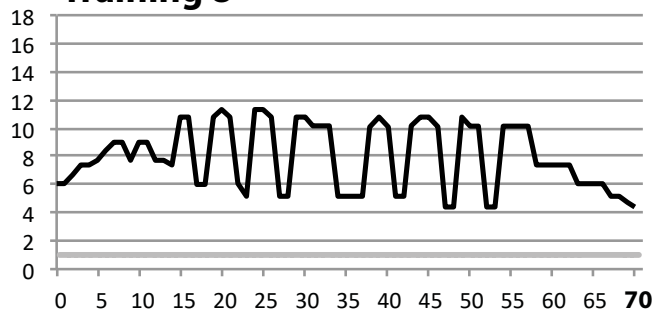

### Training 4

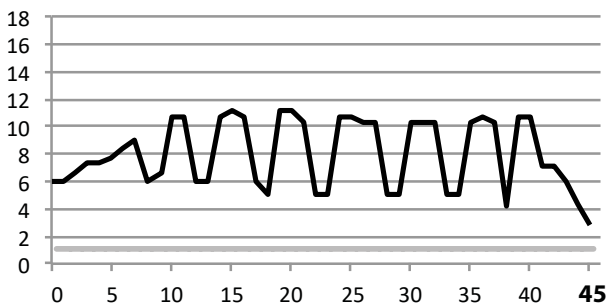

### Training 9

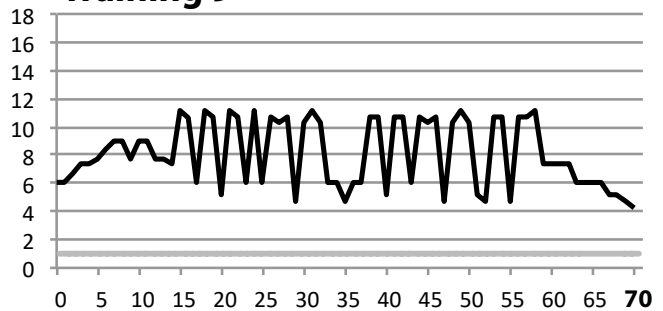

### Training 5

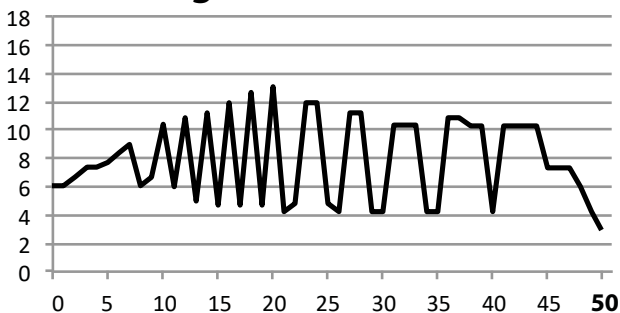

### Training 10

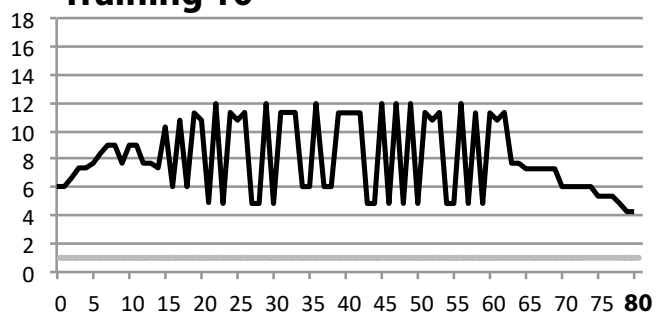

You have chosen a DOMYOS product and we would like to thank you for your trust in us. Whether you are a beginner or a high-level sportsman or woman, DOMYOS is by your side to help you stay fit or get fit. Our teams always strive to design the best products for your needs. However, should you have any comments, suggestions or questions, we would love to hear them on our website [deathlon.com](http://deathlon.com). The site also contains tips for your practice and assistance for potential issues.

**PRESENTATION**

The practice of walking or running on a treadmill provides a full cardio and muscle workout, for beginners to advanced users. The benefits of this practice are as follows:

- Improve your breathing and cardiovascular system
- Keep in shape
- Rehabilitate with suitable exercises
- Lose weight when combined with a suitable diet

**TECHNICAL CHARACTERISTICS**

This treadmill is designed for running from 1 to 14km/h. The running surface is 45cm x 120cm. Your treadmill has 6 display functions: time, distance, speed, rhythm, calories and heart rate directly on the console. To assist you in your practice, 30 programmes are pre-installed in the console and classified by category: 10 «Calorie» programmes, 10 «Endurance» programmes, 10 «Interval Training» programmes. The power consumption of the treadmill can range from 750 to 850 watts for a 90 kg user at 14 km/h. Sound pressure level measured at 1 meter from the surface of the machine and at a height of 1.60 meters above the ground 70 dBA (at max speed 14 km/h, without runners). The sound level emitted under no-load conditions is lower than that emitted during operation with load. This treadmill is designed for domestic use of up to 5h a week.

**START-UP**

- Plug in the power cord.
- Move the switch near the power cord to «I».
- Stand on the treadmill footrest.
- Attach the safety key clip to your garment.
- Insert the safety key into the slot on the console.
- Your screen lights up and displays GO
- Your treadmill is ready to use!

**OPERATION OF THE CONSOLE**

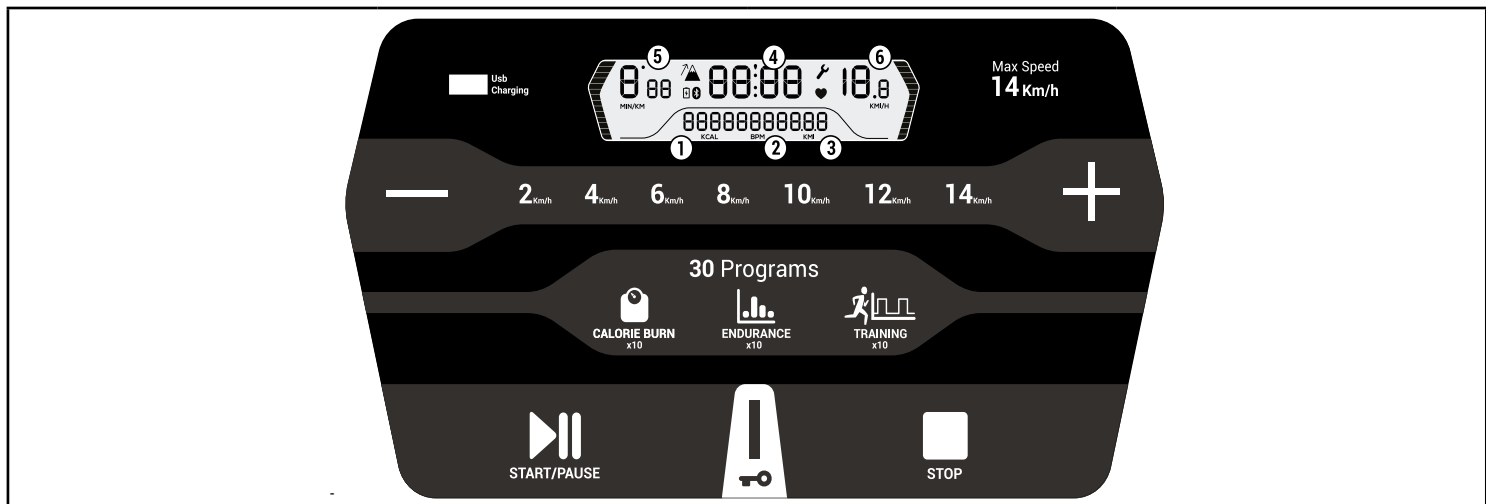

	Adjustment of speed in increments of 0.1km/h and in increments of 0.5km/h with a long press		Calories consumed
	Speed short cut to reach desired speed more quickly		Heartbeat by minute HRM belt sold separately
	USB port for recharging the battery of a phone or tablet		Distance travelled
	START / PAUSE button to start and pause your session		Duration of session
	Security key. The treadmill works with a security key to hang to your clothing. In an emergency, remove the key so that the treadmill stops.		Rhythm in min/km
	STOP button to end the session		Speed in km/h
	«CALORIE BURN» programme selection from C1 to C10		Treadmill maintenance
	«ENDURANCE» programme selection from E1 to E10		«INTERVAL TRAINING» programme selection from T1 to T10

**CHANGE UNITS MI/KM, CHECK DISTANCES AND USAGE TIME**

You can access the settings screen by pressing the STOP and + buttons simultaneously, safety key not inserted.

Screen 1: displays total usage time for the treadmill.

Screen 2: displays the total number of kilometres run on the treadmill.

Screen 3: displays MI or KM units.

To change units, press + or -.

To switch screens, press one of the programme buttons.

You can return to the main screen at any time by pressing STOP.

## ACTIVATE/DEACTIVATE THE BEEP ON THE CONSOLE:

When you press a button on the console, a beep notifies you that your action has been taken into account. You can deactivate this beep. To access the start-up/welcome screen on the console, press the STOP button several times, safety key inserted, Press the + button to activate the beep / Press the - button to deactivate the beep.

## REMOTE CONTROL

The RUN100E treadmill is equipped with a remote control. The remote control allows you to remotely control the speed of the treadmill, in order to allow a completely natural running. To pair the remote control, simultaneously press the STOP and + button on the remote control for 5 seconds.

## HEART RATE

The RUN100E treadmill is equipped with a receiver that is compatible with all heart rate monitor straps, which are sold separately.

## QUICK START

The quick start mode allows you to exercise without following a specific program, by managing the speed and distance for yourself. Select quick start mode: Press START/PAUSE and your session begins automatically at 1km/h.

## PROGRAMMES

The RUN100E treadmill offers 30 pre-installed programmes to vary your sessions and meet your goals. (see details in accompanying booklet)

The programs are divided into 3 goal categories:



- 10 BURN CALORIES programmes from C1 to C10: lets you work out with the aim of losing body fat during or after exercise
- 10 ENDURANCE programmes from E1 to E10: lets you improve aerobic capacity and basic endurance. Perfect for training for long distance runs or endurance sports.
- 10 INTERVAL TRAINING programmes from T1 to T10: lets you improve aerobic performance to stay stronger longer.

Each programme is divided into multiple segments. Each segment corresponds to a duration and speed setting. Two consecutive segments can have the same settings.

At any moment, before starting or during the programme, you can modify the speed using the + or - buttons, to adjust it to your level.

## PROGRAMME SELECTION:

Programme selection can only be done when the treadmill is stopped.

Choose your goal by pressing the logos   

The display will indicate the programme number, total duration and maximum speed attained during the programme. Press the same goal button show the programmes 1 to 10. The + and - buttons allow you to adjust the maximum speed of a selected programme. This new data will be applied proportionally to the whole program.

Press START to start the program. To exit the programme menu and return to the home screen, press the STOP button.

## COMPATIBLE WITH THE DOMYOS E-CONNECTED APPLICATION

You can connect your treadmill via Bluetooth to the Domyos E-Connected application and to partner applications, available on tablet and smartphone. Bluetooth connection between the treadmill and telephone can be done from the application.

## RECOMMENDATIONS FOR USE

If you are a beginner, start by training for several days at a low speed, without overexerting yourself, and taking rest periods if necessary. Gradually increase the number or duration of sessions. During your workout, be sure to ventilate the room in which the treadmill is located.

### Maintenance/Warm-up: Progressive effort from 10 minutes

To maintain or rehabilitate, work out every day for at least 10 minutes. This type of exercise helps work the muscles and joints gently and can be used as a warm-up before more strenuous physical activity. To increase muscle tone in the legs, choose a greater incline and increase the duration of the exercise.

### Aerobic exercise for weight loss: Moderate effort for 35 to 60 minutes

This type of workout allows you to burn calories effectively. There is no need to force beyond its limits, the frequency (at least 3 times per week) and the duration of the sessions (35 to 60 minutes) will lead to the best results. Exercise at medium speed (moderate effort without shortness of breath). To lose weight, in addition to regular physical activity, it is essential to follow a balanced diet.

### Improve your endurance: High effort for 20 to 40 minutes

This type of training allows a significant reinforcement of the cardiac muscle and improvement of the respiratory work. Practice at least 3 times a week at a steady pace (fast breathing). As you train, you will be able to hold this effort longer, at a better pace. Training at a faster rate (anaerobic work and red zone work) is reserved for athletes and requires appropriate preparation.

### Warming down

After each workout, walk a few minutes at low speed to gradually bring the body to rest. This phase of calm returns to normal cardiovascular and respiratory systems, blood flow and muscles. This makes it possible to eliminate counter effects such as lactic acids whose accumulation is one of the major causes of muscle pain (cramps and muscle aches).

### Stretching:

We advise you to stretch after each session to relax your muscles and promote your recovery.

## MAINTENANCE

Every 200 km, the treadmill shows "GO SERVICE", you must carry out maintenance on your treadmill: walking belt tension, lubrication, screw tightness, etc You can find all of our maintenance tips on our website.

To get rid of the "SERVICE" word, safety key inserted, click on the STOP and + buttons at the same time for three seconds.

## WALKING BELT TENSION

The tension of the running belt should be 1.7 (+/- 0.1). This is the motor current tension.

### After verifying the tension on the console:

- If the value is lower, you must tighten the running belt. (You can do this by turning the two rear roller screws clockwise).
- If the value is higher, you must reduce the tension of the running belt. (You can do this by turning the two rear roller screws anticlockwise).

### A half turn of the key = 0.03

To adjust: select the "running belt tension" tab in the MAINTENANCE section.

### How to verify the tension on the console:

Place your feet securely on the footboards.

When the safety key is removed, press and hold the "START" and "STOP" buttons for three seconds.

Start is shown on the console, press the "START" button and insert the safety key.

The treadmill starts at 5 km/h and shows the running belt tension. (Adjust if necessary).

Press the "STOP" button to finish.

# AFTER-SALES SERVICE

<b>UK</b> Do you need assistance? Find us at <a href="http://www.supportdecathlon.com">www.supportdecathlon.com</a> , or if you don't have an internet connection, call our Customer Loyalty Team at 0207 064 3000.	<b>FRANCE</b> Besoin d'assistance ? Retrouvez-nous sur le site internet <a href="http://www.supportdecathlon.com">www.supportdecathlon.com</a> (coût d'une connexion internet).	<b>ESPAÑA</b> ¿Necesita asistencia? Nos puede encontrar en el sitio web <a href="https://support.decathlon.es/servicios-posventa-decathlon">https://support.decathlon.es/servicios-posventa-decathlon</a> (coste de conexión a internet) o contacte con su tienda habitual y/o el centro de atención al cliente, con el ticket de compra, a +34 91 623 31 22 para ayudarlo a abrir un dossier spv (servicio de post venta, llamada gratuita desde un teléfono fijo desde España).	<b>ITALIA</b> Hai bisogno di assistenza? Ci puoi contattare dal sito <a href="https://support.decathlon.it/">https://support.decathlon.it/</a> per aprire un dossier di assistenza post vendita.	<b>BELGIQUE</b> Besoin d'assistance? Retrouvez le service après vente sur le site internet <a href="http://www.supportdecathlon.com">www.supportdecathlon.com</a> (coût d'une connexion internet) ou contactez le centre de relation clientèle au 02 208 26 60 (tarif local).
<b>NEDERLAND</b> Hulp nodig? U vindt de dienst na verkoop terug op de website <a href="http://www.supportdecathlon.com">www.supportdecathlon.com</a> (kosten internetverbinding) of contacteer de klantendienst op 088 33 22 888 (lokaal tarief).	<b>PORTUGAL</b> Necessita de assistência? Encontre-nos no site <a href="http://www.supportdecathlon.com">www.supportdecathlon.com</a> ou nos contacte através do nosso Centro de apoio técnico tendo em mãos uma prova de compra (cartão Decathlon ou factura de caixa) pelo número 800 919 970* Serviço pós venda gratuito para os produtos Domyos, ver condições de garantia. *Chamada gratuita.	<b>DEUTSCHLAND</b> Brauchen Sie Hilfe? Sie finden uns auf der Internetseite: <a href="http://www.supportdecathlon.com">www.supportdecathlon.com</a> oder Sie rufen unser Customer - Relationship - Center an unter: 0049-7153-5759900 Halten Sie bitte Ihre Rechnung bereit.	<b>BELGIË</b> Hulp nodig? U vindt de dienst na verkoop terug op de website <a href="http://www.supportdecathlon.com">www.supportdecathlon.com</a> (kosten internetverbinding) of contacteer de klantendienst op 02 208 26 60 (lokaal tarief).	<b>中国</b> 你需要帮助吗？ 请访问我们的网站 <a href="http://support.decathlon.com">http://support.decathlon.com</a> 或拨打我们的全国免费客服电话 4009-109-109。温馨提示：拨打电话前，请找到您的购物凭证。
<b>EN - OTHER COUNTRIES</b> Need help? Find us on our website <a href="http://www.supportdecathlon.com">www.supportdecathlon.com</a> (cost of an internet connection) or go to the front desk of one of the stores where you bought the product, with proof of purchase.	<b>FR - AUTRES PAYS</b> Besoin d'assistance? Retrouvez-nous sur le site internet <a href="http://www.supportdecathlon.com">www.supportdecathlon.com</a> (coût d'une connexion internet) ou présentez-vous à l'accueil d'un magasin de l'enseigne où vous avez acheté votre produit, muni d'un justificatif d'achat.	<b>ES - OTROS PAÍSES</b> ¿Necesita asistencia? Nos puede encontrar en el sitio web <a href="http://www.supportdecathlon.com">www.supportdecathlon.com</a> (coste de conexión de internet) o preséntese con el justificante de compra en la recepción de la tienda de la marca donde haya comprado el producto.	<b>DE - ANDERE LÄNDER</b> Brauchen Sie Hilfe? Besuchen Sie unsere Internet-Site <a href="http://www.supportdecathlon.com">www.supportdecathlon.com</a> (Kosten des Internetanschlusses) oder wenden Sie sich an die Empfangsstelle des Geschäfts der Marke, in welchem Sie Ihr Produkt gekauft haben. Legen Sie bitte Ihren Kaufnachweis vor.	<b>IT - ALTRI PAESI</b> Bisogno di assistenza? Ci potete trovare sul sito Internet <a href="http://www.supportdecathlon.com">www.supportdecathlon.com</a> (costo di una connessione Internet) o potete recarvi all'accoglienza di un negozio del marchio in cui avete comprato il prodotto, muniti di un giustificativo di acquisto.
<b>NL - ANDERE LANDEN</b> Hulp nodig? Raadpleeg de website <a href="http://www.supportdecathlon.com">www.supportdecathlon.com</a> (kosten internetverbinding) of contacteer het onthaal van de winkel waar u het product heeft gekocht.	<b>PT - OUTROS PAÍSES</b> Precisa de assistência? Contacte nos através do site da Internet <a href="http://www.supportdecathlon.com">www.supportdecathlon.com</a> (custo de uma ligação à Internet) ou dirija-se à recepção da loja da marca onde adquiriu o seu produto, com o respectivo comprovativo de compra.	<b>PL - INNE KRAJE</b> Potrzebujesz pomocy? Znajdź nas na stronie internetowej <a href="http://www.supportdecathlon.com">www.supportdecathlon.com</a> (koszt jednego połączenia internetowego) lub wraz z dowodem zakupu zgłoś się do punktu obsługi sklepu firmowego lub tam, gdzie dokonałeś zakupu produktu.	<b>HU - MÁS ORSZÁGOK</b> Segítségre van szüksége? Keresse meg minket internetes honlapunkon <a href="http://www.supportdecathlon.com">www.supportdecathlon.com</a> (internetsatlakozás ára), vagy forduljon személyesen egyik üzletünk vevőszolgálatához, amely üzletben vásárolta a termékét, a vásárlási bizonylattal.	<b>RO - ALTEȚĂRI</b> Aveți nevoie de asistență? Ne puteți găsi pe site-ul <a href="http://www.supportdecathlon.com">www.supportdecathlon.com</a> alii trgovino, v kateri ste izdelek kupili, pri čemer je potrebno dokazilo o nakupu.
<b>SK - OSTATNÉ KRAJINY</b> Potrebujete asistenciu? Nájdite si nás na internetových stránkach <a href="http://www.supportdecathlon.com">www.supportdecathlon.com</a> (cena internetového pripojenia), alebo sa obráťte na oddelenie styku so zákazníkmi v obchode, kde ste svoj výrobok zakúpili a popritom nezabudnite predložiť doklad o kúpe.	<b>CS - OSTATNÍ ZEMĚ</b> Potřebujete pomoc? Kontaktujte nás na našich internetových stránkách <a href="http://www.supportdecathlon.com">www.supportdecathlon.com</a> (cena za internetové připojení) nebo přijďte na recepci jedné z prodejen značky, kde jste koupili váš výrobek, a předložte doklad o nákupu.	<b>SV - ANDRA LÄNDER</b> Behöver du hjälp? Hitta oss på hemsidan <a href="http://www.supportdecathlon.com">www.supportdecathlon.com</a> (kostnad för internetanslutning tillkommer) eller gå till kundtjänsten i butiken där du köpte produkten, med ditt inköpsbevis.	<b>HR - OSTALE ZEMLJE</b> Potrebna vam je pomoć? Pronađite nas na internetskoj stranici <a href="http://www.supportdecathlon.com">www.supportdecathlon.com</a> (po cijeni naknade za korištenje interneta) ili savjet potražite u trgovini u kojoj ste kupili proizvod, uz predočenje računa.	<b>SL - DRUGE DRŽAVE</b> Potrebujete pomoč? Obiščite našo spletno stran <a href="http://www.supportdecathlon.com">www.supportdecathlon.com</a> ali trgovino, v kateri ste izdelek kupili, pri čemer je potrebno dokazilo o nakupu.
<b>TR - DİĞER ÜLKELER</b> Yardıma mı ihtiyacınız var? <a href="http://www.supportdecathlon.com">www.supportdecathlon.com</a> internet sitesinden bize ulaşabilirsiniz (bir internet bağlantısı ücreti karşılığında) veya bir satın alma kanıtı ile birlikte, ürünü satın aldığınız mağazanın danışma bölümüne başvurabilirsiniz.	<b>LT - KITOS ŠALYS</b> Ar jums reikia pagalbos? Susiraskite mus <a href="http://www.supportdecathlon.com">www.supportdecathlon.com</a> interneto svetainėje ir (arba) kreipkitės į parduotuvės, kurioje įsigijote gaminį, informacijos skyrių pateikdami pirkinio dokumentą	<b>SR - DRUGE ZEMLJE</b> Da li vam treba pomoć? Potražite nas na našem veb-sajtu <a href="http://www.supportdecathlon.com">www.supportdecathlon.com</a> i/ili dođite na prijemni pult prodavnice u kojoj ste kupili proizvod sa potvrdom o kupovini	<b>LV - CITAS VALSTIS</b> Vai jums ir nepieciešama palīdzība? Mūs var atrast vietnē <a href="http://www.supportdecathlon.com">www.supportdecathlon.com</a> , un/vai dodieties uz veikala reģistratūru, kurā iegādājāties produktu, uzrādot pirkumu apliecināšu dokumentu	<b>ET - MUUD RIIGID</b> Kas vajate abi? Leidke meid <a href="http://www.supportdecathlon.com">www.supportdecathlon.com</a> veebilehel ja/või minege koos ostutšekiga sellesse kauplusesse, kust te oma toote ostsite
<b>EL - ΑΛΛΕΣ ΧΩΡΕΣ</b> Χρειάζεστε βοήθεια; Επικοινωνήστε τον δικτυακό μας τόπο, στη διεύθυνση <a href="http://www.supportdecathlon.com">www.supportdecathlon.com</a> (με το κόστος μιας σύνδεσης στο διαδίκτυο) ή απευθυνθείτε στην υποδοχή οποιούδήποτε καταστήματος της αλυσίδας από την οποία αγοράσατε το προϊόν σας, μαζί με την απόδειξη αγοράς.	<b>BG - ДРУГИ ДЪРЖАВИ</b> Имате нужда от помощ? Моля, посетете нашия сайт: <a href="http://www.supportdecathlon.com">www.supportdecathlon.com</a> (цената на интернет връзка) или отидете в отдела «Обслужване на клиентъ» на магазина, където сте купили продукта, като носите със себе си документ, доказващнаправената покупка.	<b>KK - БАСҚА ЕЛДЕР</b> Сізге көмек керек пе? Бізді <a href="http://www.supportdecathlon.com">www.supportdecathlon.com</a> веб-сайтынан табыңыз же/немесе сатып алғаныңызды растайтын құжатпен өнімді сатып алған дүкеннің қабылдау бөліміне барыңыз	<b>RU - ДРУГИЕ СТРАНЫ</b> Нужна поддержка? Обратитесь к нам через наш интернет-сайт <a href="http://www.supportdecathlon.com">www.supportdecathlon.com</a> (стоимость подключения к интернету) или подойдите в отдел обслуживания клиентов в магазине той сети, в которой вы купили ваш продукт, с товарным чеком.	<b>UK - ІНШІ КРАЇНИ</b> Вам потрібна допомога? Шукайте нас на вебсайті <a href="http://www.supportdecathlon.com">www.supportdecathlon.com</a> і/або підійдіть на інформаційну стійку магазину, де ви придбали продукт, із підтвердженням покупки
<b>VI - QUỐC GIA KHÁC</b> Cần hỗ trợ? Hãy liên hệ với chúng tôi qua trang web <a href="http://www.supportdecathlon.com">www.supportdecathlon.com</a> (cần có kết nối internet) hoặc đến đại lý chính hãng mà bạn đã mua sản phẩm, mang theo minh chứng mua hàng.	<b>ID - NEGARA LAIN</b> Perlu bantuan? Kunjungi situs internet kami <a href="http://www.supportdecathlon.com">www.supportdecathlon.com</a> (biaya koneksi internet) atau datanglah ke toko merek di mana Anda membeli produk Anda, dengan membawa bukti pembelian.	<b>ZH - 其他国家</b> 需要帮助？ 请登录 <a href="http://support.decathlon.com">http://support.decathlon.com</a> 与我们联系（普通上网费用）或携带购物发票至您购买产品的商店信息咨询处咨询。	<b>JA - その他の国</b> ヘルプが必要ですか？ サイト <a href="http://www.supportdecathlon.com">www.supportdecathlon.com</a> をご覧ください（インターネット接続料）。もしくは製品購入を証明するものをご持参の上、お買い上げいただいた取扱店にお越しく下さい。	<b>ZT - 其他國家</b> 需要幫助？ 請登陸 <a href="http://support.decathlon.com.cn/">http://support.decathlon.com.cn/</a> 與我們聯繫（普通上網費用）或攜帶購物發票至您購買產品的商店的信息諮詢處諮詢。
<b>TH - ประเด็นอื่น ๆ</b> ต้องการรับความช่วยเหลือ？ พบกับเราได้ที่เว็บไซต์ <a href="http://www.supportdecathlon.com">www.supportdecathlon.com</a> (อาจมีค่าใช้จ่ายในการเชื่อมต่ออินเทอร์เน็ต) หรือที่แผนกของห้างร้านที่คุณได้ซื้อผลิตภัณฑ์พร้อมกันหลักฐานการซื้อผลิตภัณฑ์	<b>KO - 기타 국가</b> 도움이 필요하십니까? 당사의 웹사이트 <a href="http://www.supportdecathlon.com">www.supportdecathlon.com</a> 을 방문하거나(인터넷 연결 비용), 구매 증명서를 지참하고 제품을 구매한 매장의 프론트 데스크를 방문하십시오.	<b>KM - ប្រទេសផ្សេងៗ ទៀត</b> តើអ្នកត្រូវការជំនួយទេ? ស្វែងរកយើងនៅលើគេហទំព័រ <a href="http://www.supportdecathlon.com">www.supportdecathlon.com</a> របស់យើង (តម្លៃនៃការភ្ជាប់អ៊ីនធឺណិត) ឬក៏ទៅតាមហាងមួយដែលអ្នកបានទិញផលិតផលជាមួយនឹងវត្ថុតាងនៃការទិញ។	<b>AR - دول أخرى</b> هل تحتاج إلى مساعدة؟ اتصل على عبر موقعنا الإلكتروني <a href="http://www.supportdecathlon.com">www.supportdecathlon.com</a> (تكلفة الاتصال بالإنترنت) أو توجه إلى المحل الذي اشتريته منه المنتج والذي يوجد به علامة الشركة، واحرص على تقديم إثبات الشراء	



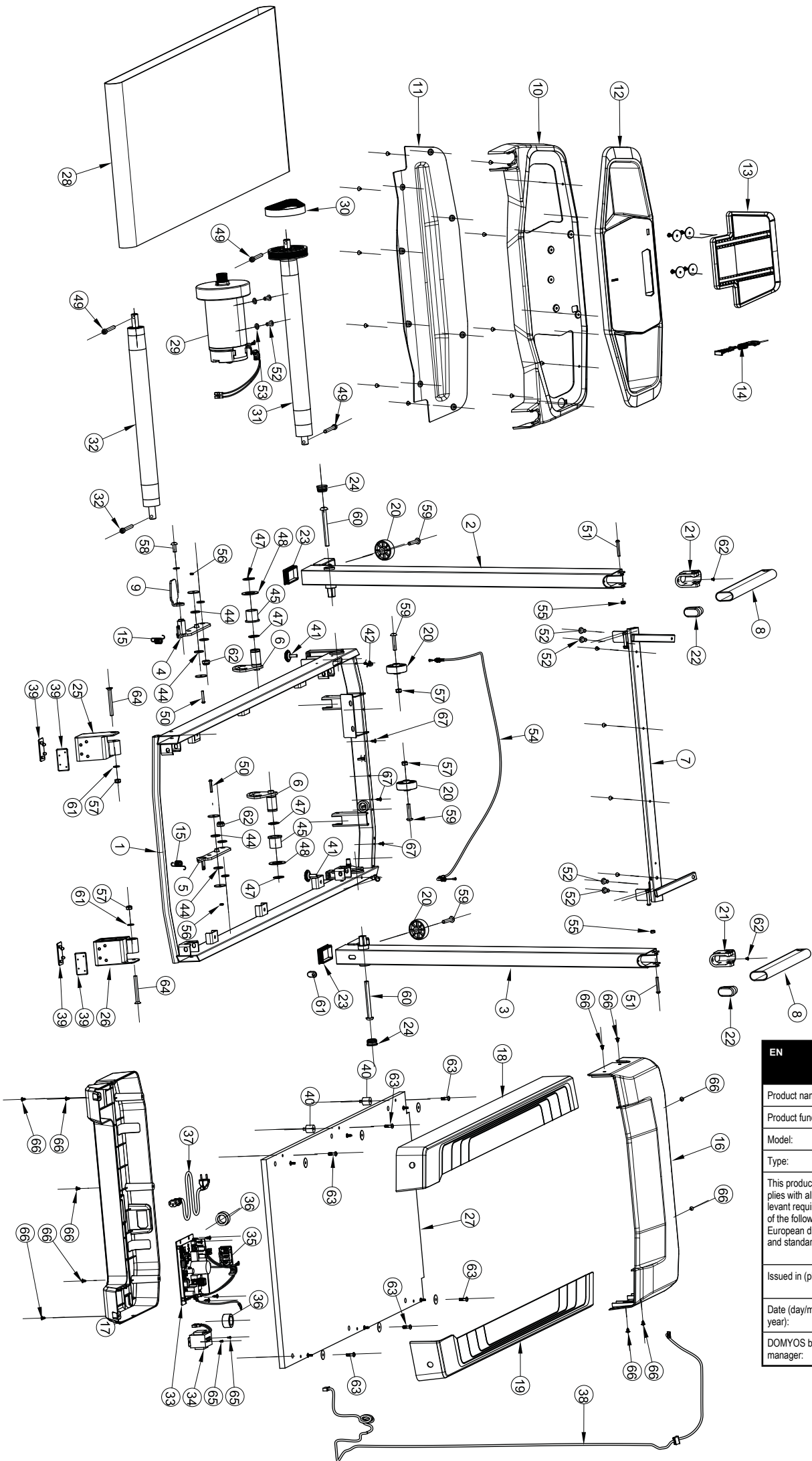

EN	EC DECLARATION OF CONFORMITY
Product name:	RUN100E
Product function:	Treadmill
Model:	8607158
Type:	2529652
This product complies with all the relevant requirements of the following European directives and standards:	2006/42/CE 2006/95/CE 2004/108/CE - EN 60335-1 - EN 55014-1 - EN 55014-2 - EN 61000-3-2 - EN 61000-3-3 - EN ISO 20957-1 EN 957-6
Issued in (place):	MARCQ-EN-BA-ROEUL
Date (day/month/year):	2024-08-28
DOMYOS brand manager:	Duarte Miguel

DOMYOS

# Run 100E-B

---

---

Keep these instructions

