



Detex Corporation, 302 Detex Drive, New Braunfels, Texas 78130-3045
830-629-2900 / 800-729-3839 / Fax 800-653-3839 / Text photos only: 830-481-6433 / INTERNET: www.detex.com

INSTALLATION INSTRUCTIONS FOR 03W ADVANTEX TRIM

DWG #: 100717

Table of Contents	Page
Device parts breakdown view & part numbers.....	2
Assemble Trim.....	2
Door Prep - Interior Door Face.....	3
Mark Cylinder Tailpiece Length.....	3
Trim Cylinder Tailpiece.....	4
Assemble Trim to Door.....	4

TOOLS AND SUPPLIES

- Safety Glasses
- (Always put on safety glasses prior to beginning installation of unit)**
- Pencil
- Center Punch
- Hammer
- Drill Motor
- Drill Bits & Taps
- Screw Driver (Phillips Drive)
- Tape Measure

For WARRANTY information,
scan code below or
go to www.detex.com/warranty

For device installation videos,
scan code below or
go to www.detex.com/videos



Owner's Copy



ITEM	PART NO.	QTY	DESCRIPTION
1	101620-9	1	TRIM PLATE, 03W, BRUSHED STAINLESS STEEL FINISH (630)
2	ECL-445-X-X	1	CYLINDER, RIM, 5 PIN
	IC7R-X		CYLINDER, RIM, INTERCHANGEABLE, 7 PIN
3	100752-X	1	CYLINDER COLLAR, TALL
4	100464-9	4	SEX NUT, 1/4-20
5	100301-1	1	CYLINDER BRACKET, 1" LONG

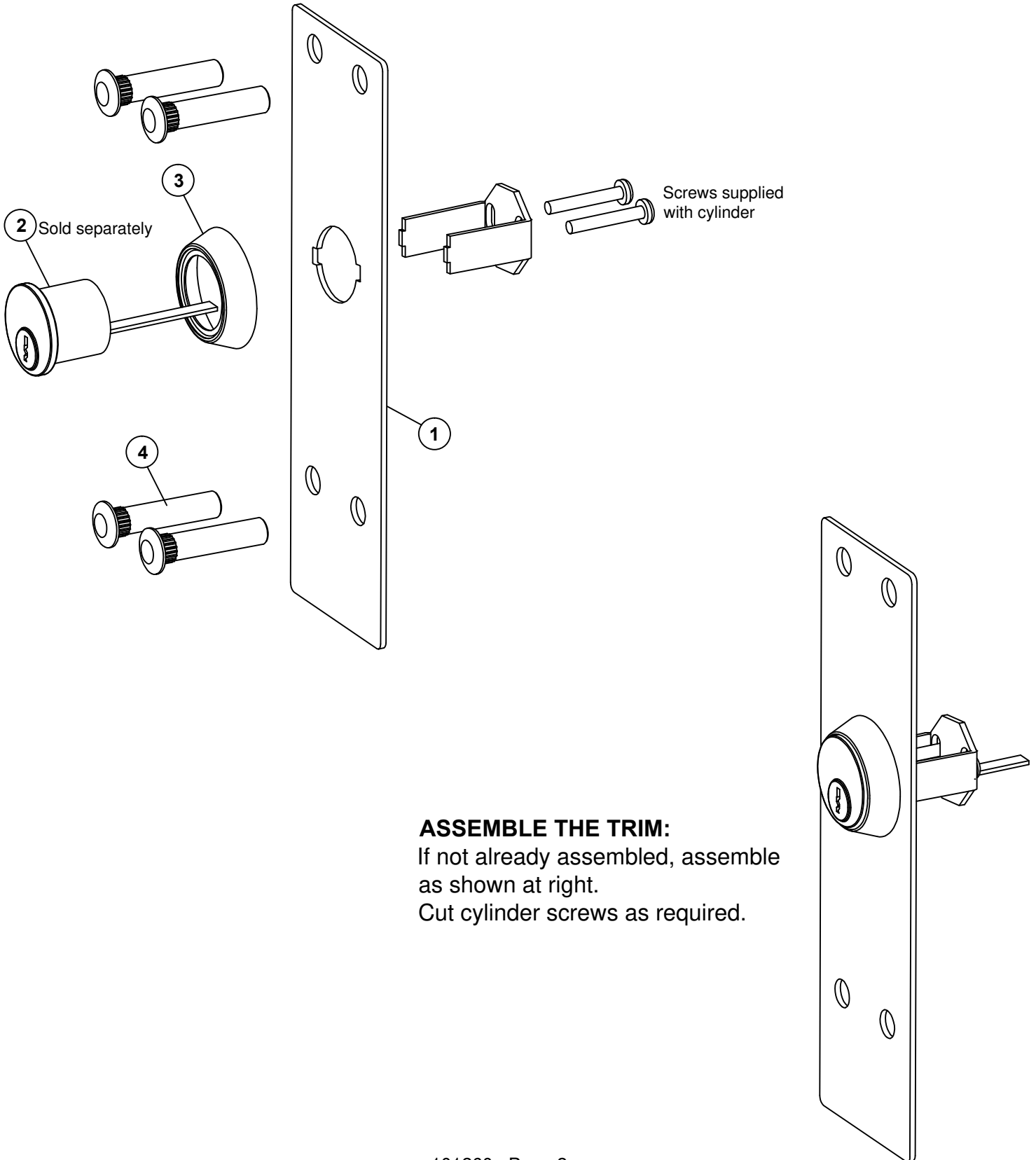

Door Preparation - Interior Door Face

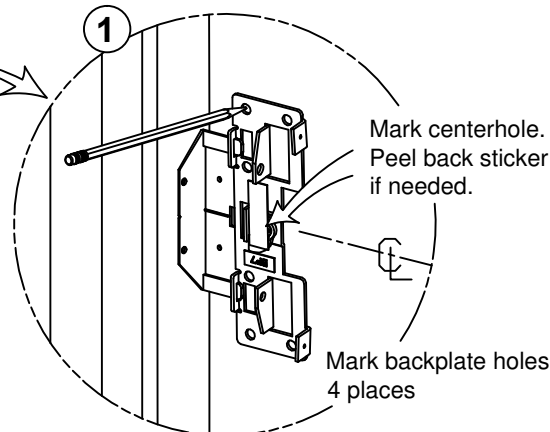
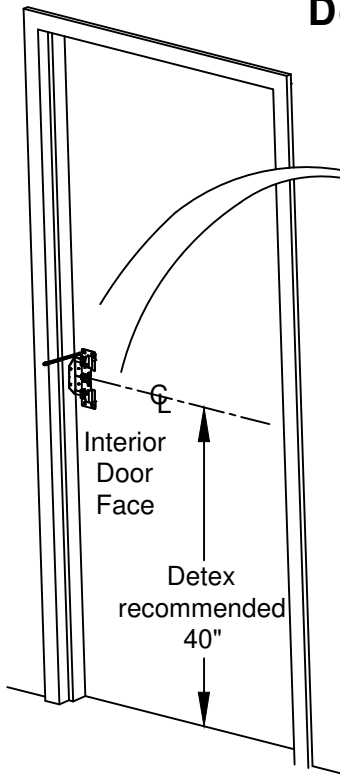

(backplate supplied with exit device)

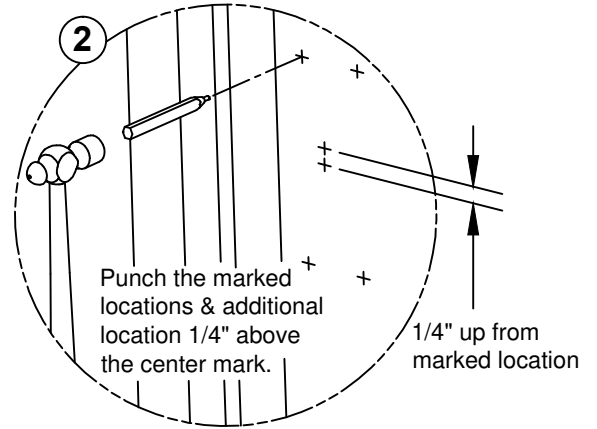

Note: All holes MUST be drilled STRAIGHT and LEVEL

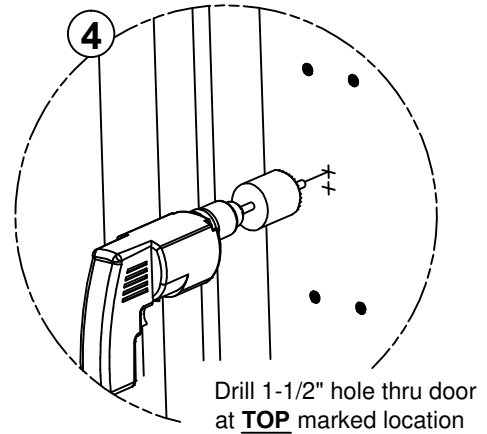
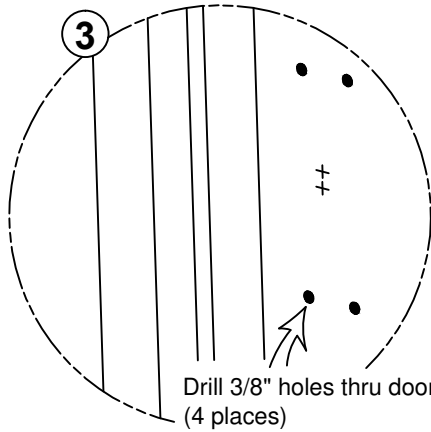

Mark Cylinder Tailpiece Length

Assemble the trim and backplate to the door, making sure that cylinder tailpiece enters the backplate cam

Mark tailpiece where it sticks thru the cam

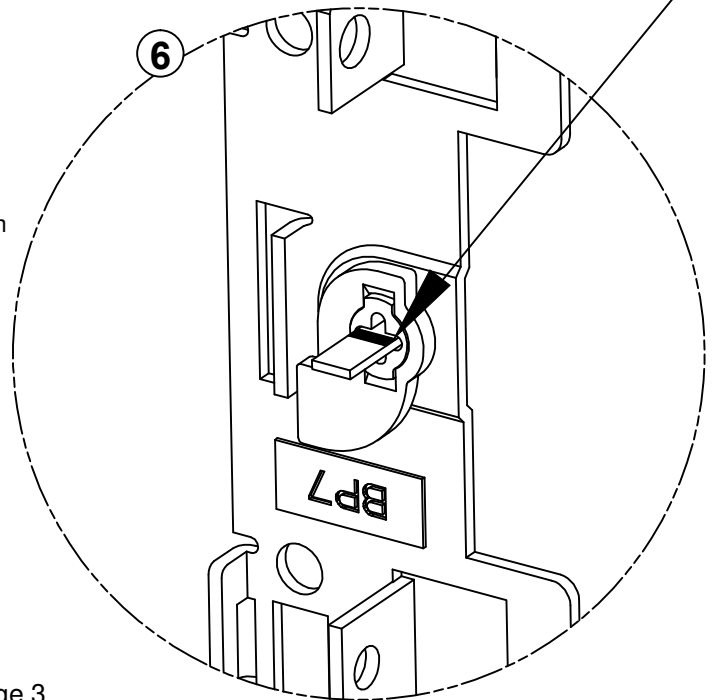
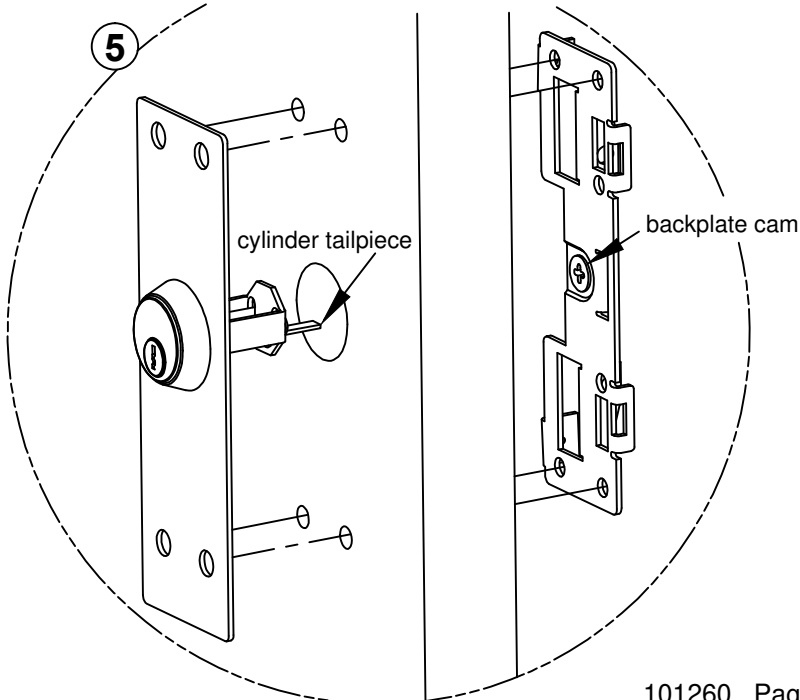

Trim Cylinder Tailpiece

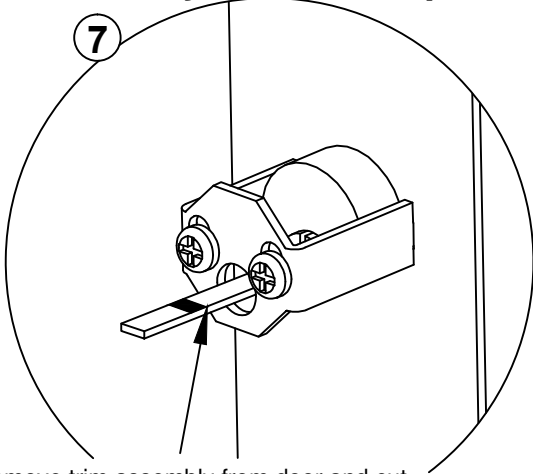

Remove trim assembly from door and cut the tailpiece just inside of the mark.

Caution: Tailpiece must not extend past the cam.

Assemble Trim to Door

8 Install sex nuts

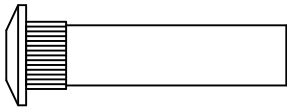

It may be necessary to hammer the sex nuts into the trim plate.

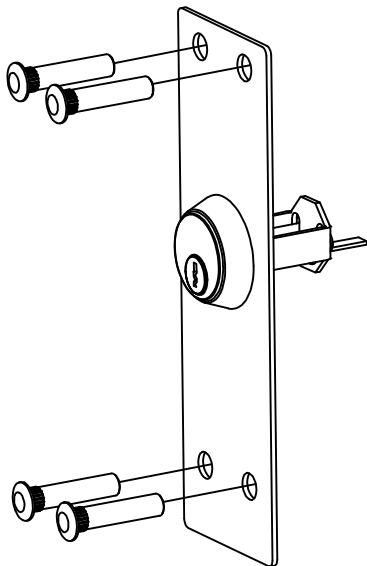

9

With the key out of the cylinder, assemble the trim and backplate to the door, making sure that cylinder tailpiece enters the backplate cam.

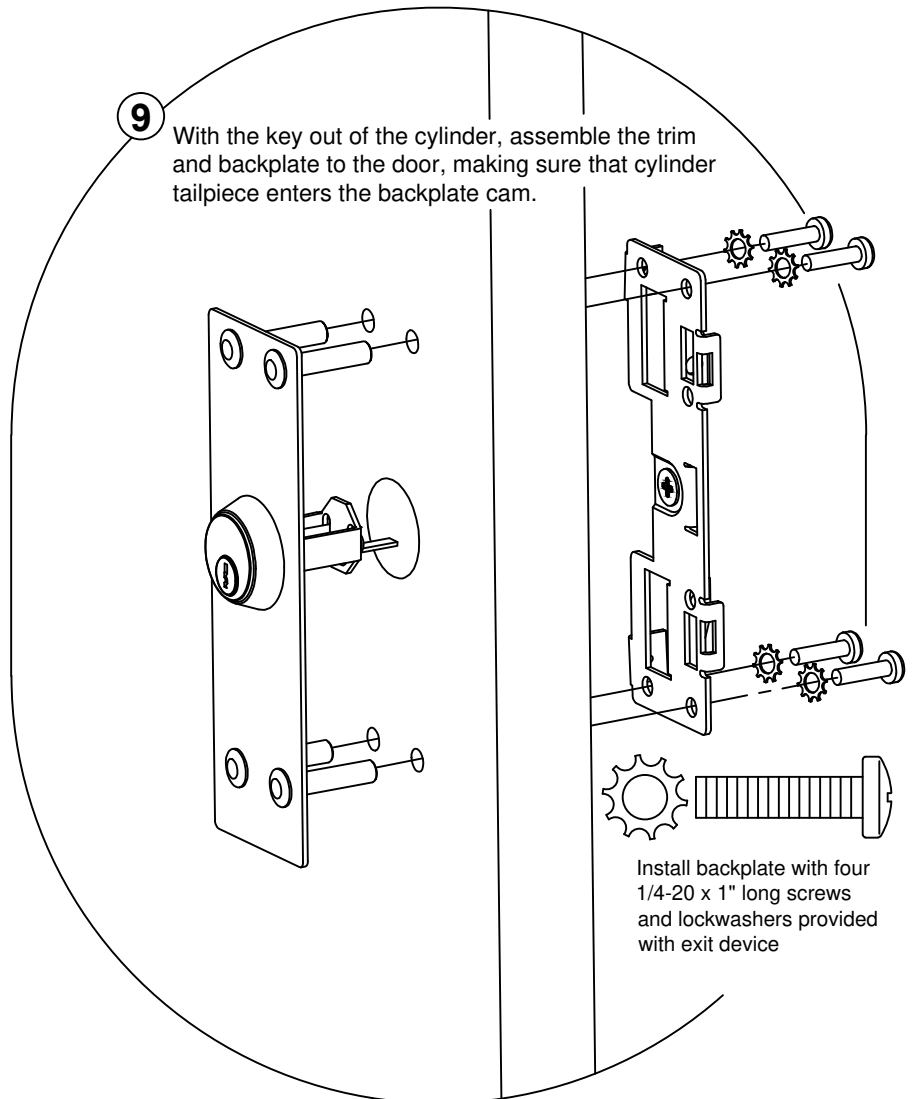

Install backplate with four 1/4-20 x 1" long screws and lockwashers provided with exit device

Key should turn freely in both directions when fully assembled to door.

Resume with panic hardware instruction.