



Detex Corporation, 302 Detex Drive, New Braunfels, Texas 78130-3045
830-629-2900 / 800-729-3839 / Fax 800-653-3839 / Text photos only: 830-481-6433 / INTERNET: www.detex.com

INSTALLATION INSTRUCTIONS FOR MORTISE 03CM TRIM

DWG #: 103295

Table of Contents	Page
Device parts breakdown view & part numbers.....	2
Door Prep - Trim Side, Install Trim, Install Mortise Lock....	3
Install Mortise Cylinder, Secure Cylinder.....	3

TOOLS AND SUPPLIES

- Safety Glasses
- (Always put on safety glasses prior to beginning installation of unit)**
- Pencil
- Center Punch
- Hammer
- Drill Motor
- Drill Bits & Taps
- Screw Driver (Phillips Drive)
- Tape Measure

For WARRANTY information,
scan code below or
go to www.detex.com/warranty

For device installation videos,
scan code below or
go to www.detex.com/videos

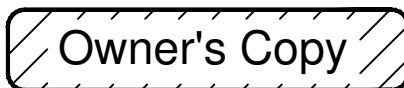

ITEM	PART NO.	QTY	DESCRIPTION
1	103296-9	1	TRIM PLATE, 03WM, BRUSHED STAINLESS STEEL FINISH (630)
2	102281-X	1	CYLINDER, MORTISE, 5 PIN
3	100752-X	1	CYLINDER COLLAR, TALL
4	102235-9	1	PULL, 03C
5	102264-1	1	SCREW, MACH, 1/4-20 X 1/2" UNDERCUT, PFH
6	102271-136	1	SCREW, MACH, 1/4-20 X 2-1/4", PFH, STAINLESS STEEL
	102271-144	1	SCREW, MACH, 1/4-20 X 2-3/4", PFH, STAINLESS STEEL
7	102272-2	1	WASHER, #14, FINISHED, STAINLESS STEEL

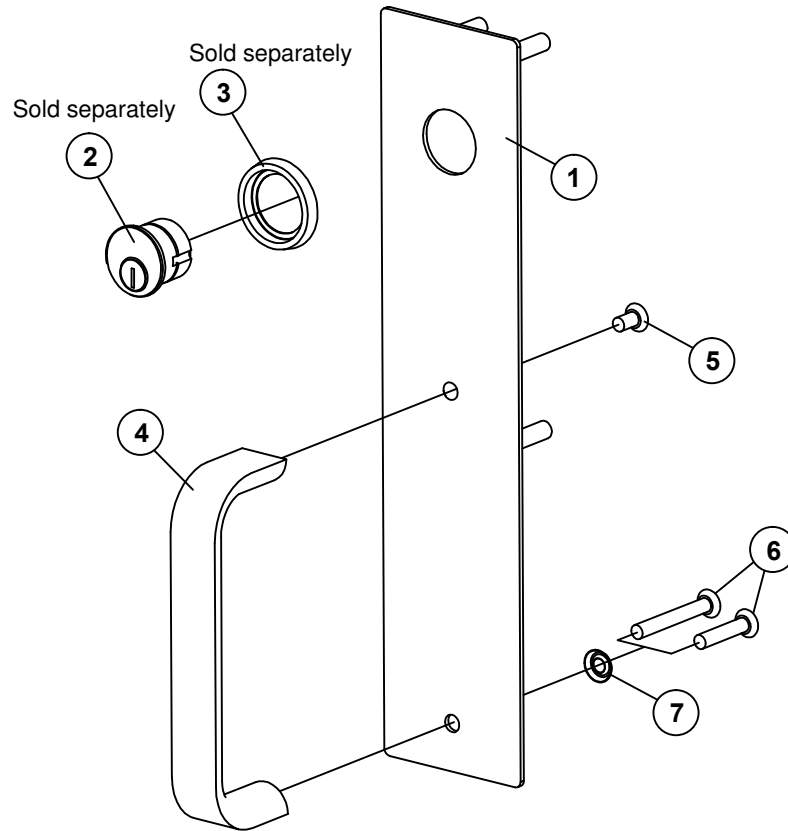

STEP 1: PREP DOOR

MARK & DRILL HOLES - TRIM SIDE:

Use plastic template to mark TRIM holes (LHR shown)

NOTE: The height from the finished floor to the trim/device centerline that Detex recommends is 40".

If unsure of trim/device centerline location, use the method below and at right to determine correct trim location.

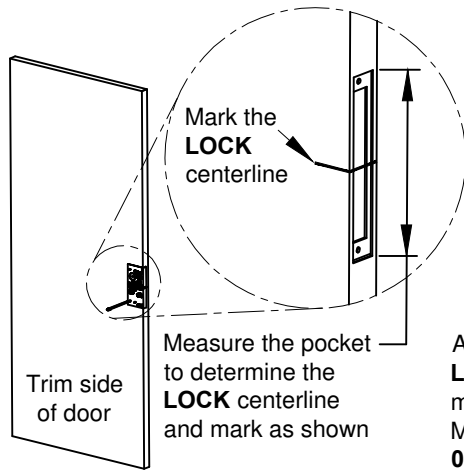

MARK HOLES:

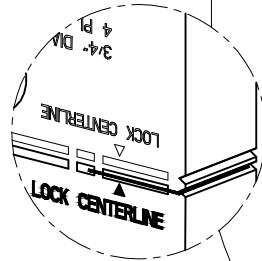

Align the plastic template **LOCK CENTERLINE** with the mark previously made as shown. Mark the four **A** locations and the **03 INPUT** location.

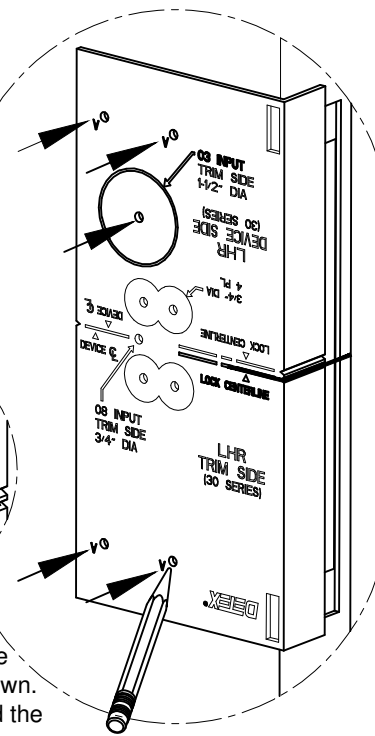

DRILL HOLES:
Drill 1-1/4" diameter hole thru trim side only

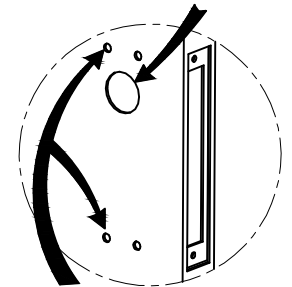

Drill 3/8" diameter holes thru trim side only, 4 places

STEP 2: PREP & INSTALL TRIM

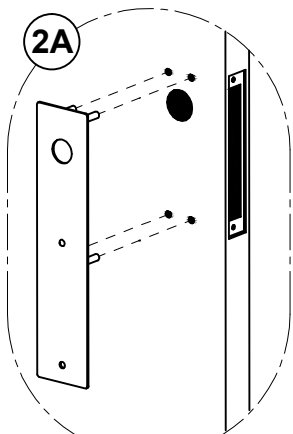

Place trim onto door

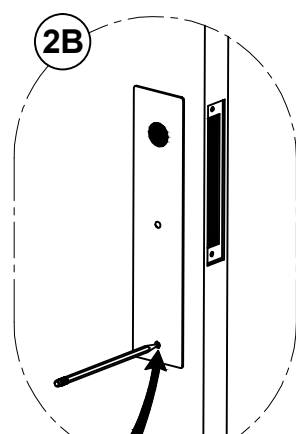

Mark and drill 3/8" diameter (1/2" max) hole thru door

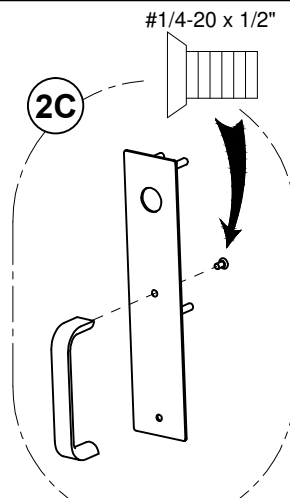

Assemble top of pull to trim with screw provided

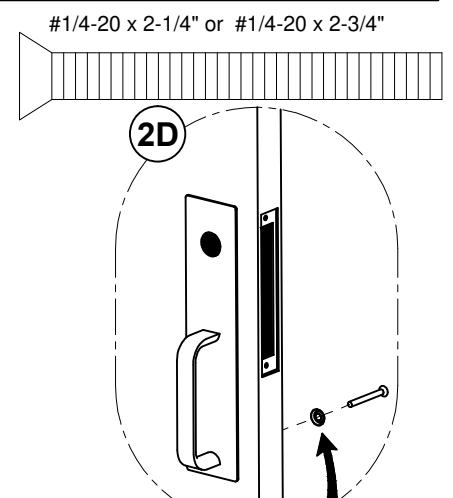

Fasten bottom of pull with screw and finish washer provided

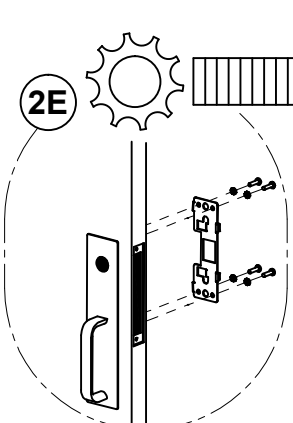

Install backplate with four 1/4-20 x 1" long screws and lockwashers provided with exit device

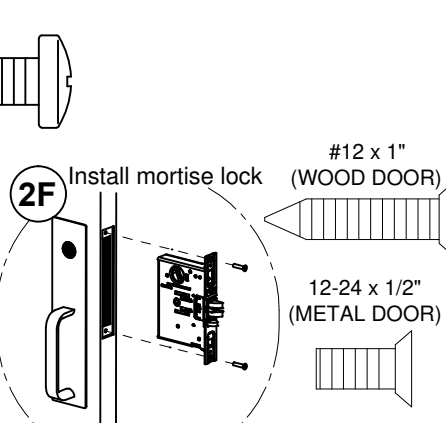

Mortise lock and mounting hardware provided with exit device. Fasten screws loosely.

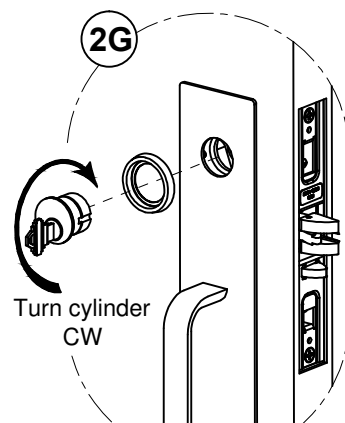

Install collar & lock cylinder

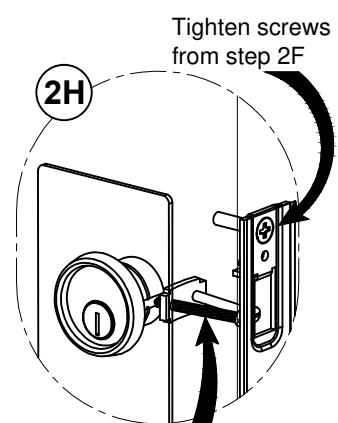

Tighten screw nearest trim side of door only

TRIM INSTALLATION COMPLETE
Continue installation using device instructions