



USER MANUAL

27" 1080P Frameless PC Monitor • EM2FPAB27B

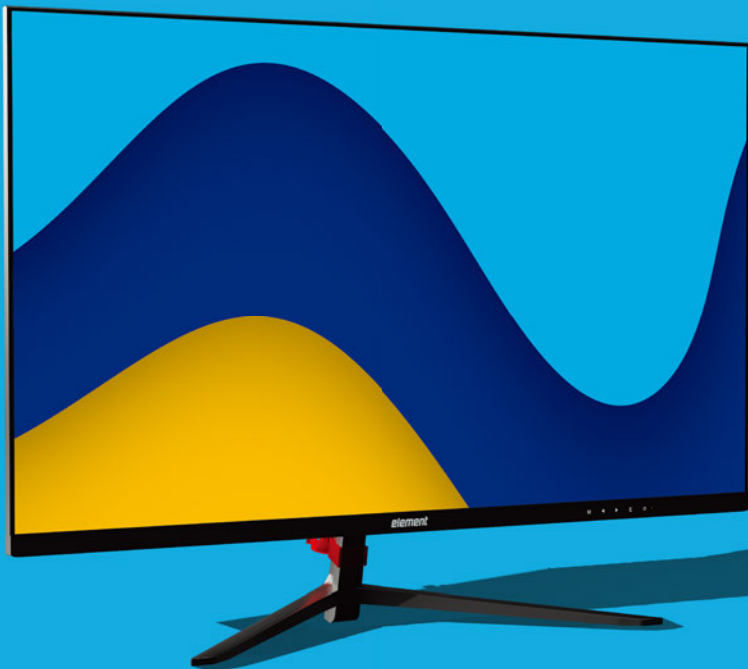

Table of Contents

Opening the Package	3
Package Contents	3
Installation.....	3
Installing the Monitor Stand Assembly.....	4
Removing the Stand for Wall Mounting	6
Identifying Front and Rear Panel	7
Front View	7
Panel Tilt Adjustment.....	7
Rear View with Buttons	8
Rear View with Connections.....	9
Connections.....	10
Connect signal cables to your video Card before you use monitor.....	10
On Screen Display (OSD) Menu.....	11
Luminance	11
Image Setup	11
Color Temp.....	11
OSD Setting.....	12
Reset	12
Extra	12
Supported VGA Resolution.....	13
Supported HDMI Resolution	13
Troubleshooting	14
Specification	17

Opening the Package

The Element monitor display is packaged in a carton. The size and weight of the product might be too heavy for 1 person to handle. In the event of that happening; it is recommended that the display package must be handled by a minimum of 2 or more persons. Since the glass can be easily scratched or broken, please handle the product gently. Never place the unit on a surface with the glass facing downwards unless it is on protective padding. When opening the carton, check that the product is in good condition and that all standard accessories and items are included. Save the original box and all packing materials for future shipping needs.

Package Contents

Element Monitor x 1
Monitor Base x1
Monitor Neck x 1
Monitor Base Screw x 1 (M4 x 10mm)
Monitor Neck Screw x 2 (M4 x 10mm)
Monitor Hinge Screw x 4(M4 x 4.5mm)
HDMI Cable x 1
Hinge Cover x 1
Rubber x 1
AC Adapter x 1
User Manual x 1

Installation

Please read the user manual carefully before performing the installation. When an extension cord is required, use one with the correct power rating. Use only the Element provided power cable or AC adapter approved for use with this device. The product should be installed on a flat surface to avoid tipping. Space should be maintained between the back of the product and the wall for proper ventilation. Avoid installing the product in the kitchen, bathroom or other places with high humidity dust or smoke, so as not to shorten the service life of the electronic components. Please ensure the product is installed with the screen in landscape orientation. Any 90° clockwise or counterclockwise installation may induce poor ventilation and successive component damage.

Installing the Monitor Stand Assembly

1. With the packing foam still on, lay the monitor screen facing down on a table and open the top half of the packing foam. Install the neck to the base and insert the 1 base screws from the bottom. Tighten the screws to secure the base. Insert the rubber to the bottom of the base.

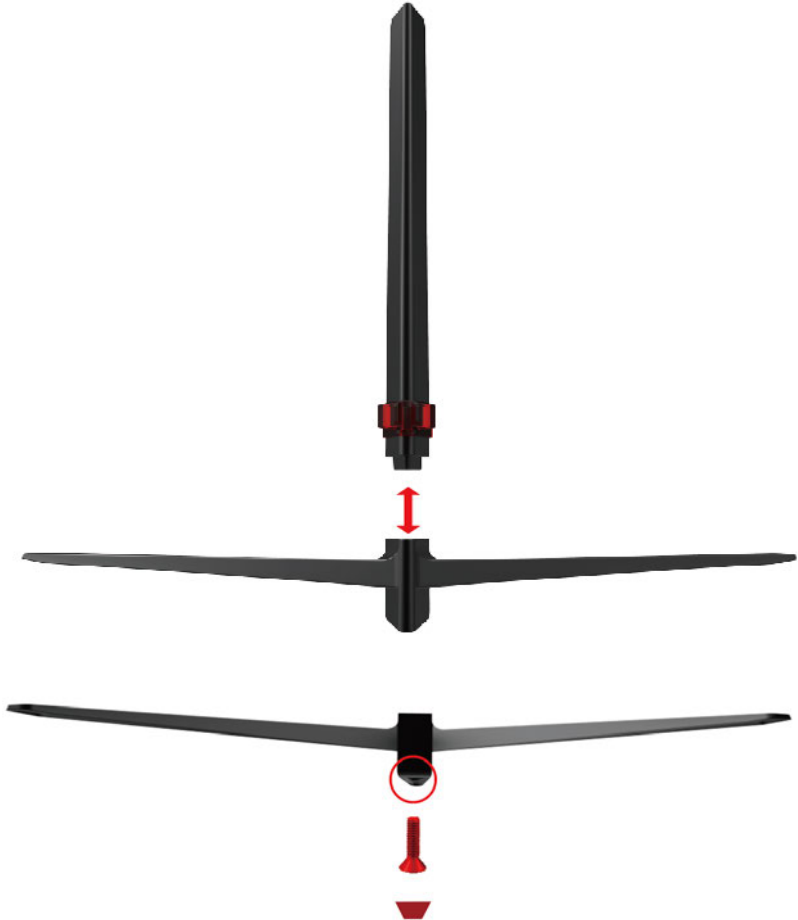

2. Install the assembled stand to the back of the monitor and screw in the 4 pcs M4*4.5 neck screws to secure the stand to the monitor.



3. Install the hinge cover to the back of the neck.



4. To finalize your installation of the monitor, please read the following:
 - a. If you are placing the display on a stand, we would recommend you to use a display safety strap (not included) in order to minimize the possibility of the display toppling over.
 - b. Securely install all screws and connections.

Removing the Stand for Wall Mounting

1. To uninstall the stand assembly, lay the monitor facing downwards on a table. Remove the hinge cover and unscrew the four screws to remove the stand.



2. The mounting pattern is 100mm x 100mm using M4 x 10mm screws.

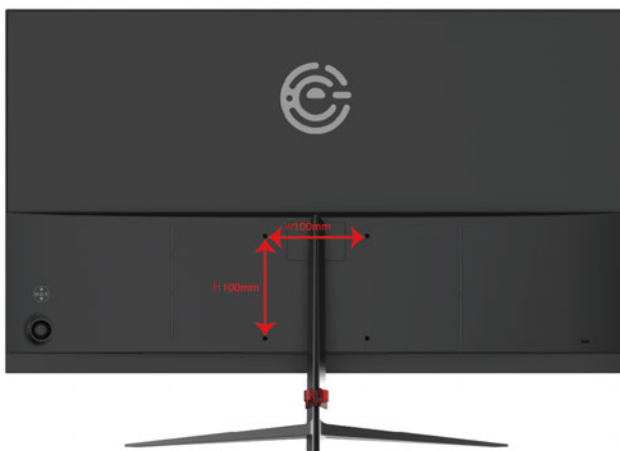

Identifying Front and Rear Panel

Front View



Indicator Light –the light is blue when the monitor is turned on. The light is off when the monitor is turned off. The light is red when there is no signal given to the monitor.

Panel Tilt Adjustment

The screen can be adjusted by inclining forward and backward; however, the specific adjustment depends on the specific model of the device. Generally, it may be inclined $-5^{\circ} \sim 15^{\circ}$.

Please Note:

- When adjust the angle of the monitor, be sure not to touch or press the LCD screen.

Rear View with Buttons



Buttons from right to left

1. **M** – This button activates the On Screen Display (OSD). While the OSD is active, this button will act as the select button to open up an option for adjustment.
2. **▲** – With no OSD, this button increases the volume of the monitor's speakers. With the OSD turned on, this button moves the selection upwards. This button will also increase the value of an adjustment while an option is open.
3. **▼** – With no OSD, this button decreases the volume of the monitor's speakers. With the OSD turned on, this button moves the selection downwards. This button will also decrease the value of an adjustment while an option is open.
4. **E** – When the OSD is active, this button acts as the EXIT button and exits out of the option or OSD. This button switches between all the different inputs of the monitor.
5. **⏻** – This button turns the monitor on or off.

Rear View with Connections

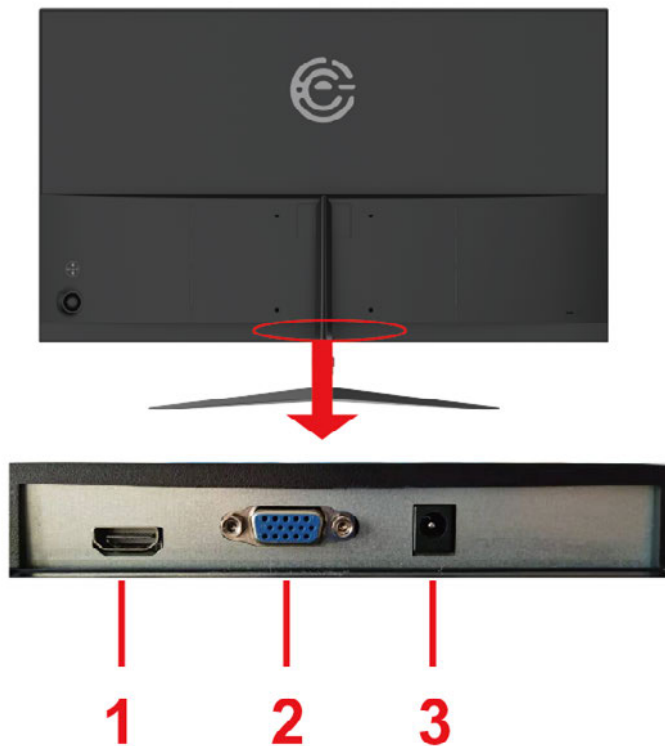

1. **HDMI**– HDMI stands for High Definition Multimedia Interface. This connection is for computers with HDMI video output.
2. **VGA**– VGA stands for Video Graphics Array. This connection is for computers to send video signals to the monitor by an analog signal. This method of connection is the most commonly used connection.
3. **DC IN**– This connection is for electricity supplied from the included power adapter.

Connections

Connect signal cables to your video card before you use your monitor...



1. Make sure the power of the LED MONITOR is turned off.
2. Obtain a HDMI or VGA cable and connect one end to the back of the monitor and the other end to the back of the computer.
3. Turn on the power of both the LED MONITOR and the computer.

On Screen Display (OSD) Menu

Luminance

1. Brightness adjustment
This option will adjust your monitors brightness. Use the up and down buttons to increase or decrease brightness setting.
2. Contrast adjustment
This option will adjust the amount of difference between white values and black values. Use the up and down buttons to increase or decrease contrast setting.
3. ECO Mode adjustment
This option will allow to choice Standard/Game/Movie/Internet mode.
4. DCR function
This option turns on or off the dynamic contrast option of the monitor. Dynamic Contrast automatically adjusts the contrast of the monitor based off the video signal provided.
5. Overdrive adjustment (OD)
This option can accelerate the pixel response time of the LCD display. There are three Options (Weak/Medium/Strong) to choose from. the strong option is with smallest response time.

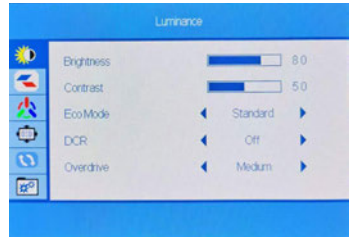

Image Setup

1. H. position adjustment
This selection will adjust the horizontal position of the video on your monitor. This mode is only available in VGA mode. Use the up and down buttons to move your video display area left to right.
2. V. position adjustment
This selection will adjust the vertical position of the video on your monitor. This mode is only available in VGA mode. Use the up and down buttons to move your video monitor area up and down.
3. Clock adjustment
To press menu into main choice menus, press menu into Clock adjustment, and then press up or down to adjust.
4. Phase adjustment
To press menu into main choice menus, press menu into Phase adjustment, and then press up or down to adjust.
5. ImageRatio adjustment
Choose screen size, like Wide(16:9), 4:3 or Auto.



Color Temp

1. Color Temp
This selection will change the amounts of red, green, and blue present in the image. Warm mode will give more red, Cool mode will give more blue and User mode will allow you to make your own adjustments to the red, green and blue levels.
2. Low blue adjustment
Use the ON/OFF option to adjust the low blue function.

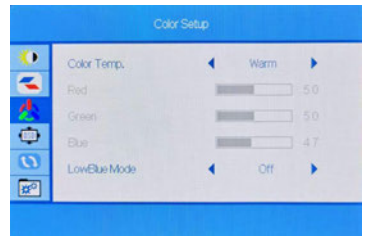

OSD Setting

1. Language adjustment
This selection will allow you to select the language you want the menu to appear in.
2. OSD H-position adjustment
This selection will change the horizontal position of the On Screen Display Menu. Use the up and down buttons to change the position left to right.



3. OSD V-position adjustment
This selection will change the vertical position of the On Screen Display Menu. Use the up and down buttons to move the display up and down.
4. Timer OSD
This selection will adjust OSD menu display time on the screen.
5. Transparency
This selection will adjust OSD menu transparency on the screen.

Reset

1. Auto Image adjustment
This selection will automatically adjust your image setting to the best viewing. This mode is only available in VGA mode.
2. Auto Color adjustment
This selection will automatically adjust your color setting to the best viewing. This mode is only available in VGA mode.
3. Reset
This selection will reset the monitor to factory statement.

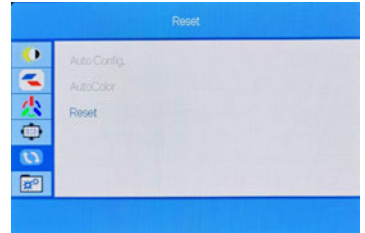

Extra

1. Input Select Signal source adjustment
Press UP or DOWN to select VGA, HDMI source.

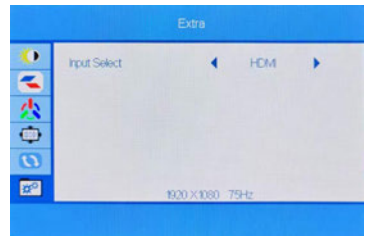

Supported VGA Resolution

RESOLUTION & REFRESH RATE
1920 x 1080 @ 50Hz,60Hz,75Hz
1680 x 1050 @ 60Hz,75Hz
1600 x 900 @ 60Hz,75Hz
1440 x 900 @ 60Hz,75Hz
1366 x 768 @ 60Hz,75Hz
1280 x 1024 @ 60Hz,75Hz
1280 x 800 @ 60Hz,75Hz
1280 x 720 @ 50Hz,60Hz,75Hz
1024 x 768 @ 60Hz,70Hz,75Hz
800 x 600 @56Hz, 60Hz,72Hz,75Hz
720 x 576 @ 56Hz,60Hz,72Hz,75Hz
720 x 480 @ 60Hz,75Hz
640 x 480 @ 60Hz,72Hz,75Hz

Supported HDMI Resolution

RESOLUTION & REFRESH RATE
1920 x 1080 @ 50Hz,60Hz, 75Hz
1680 x 1050 @ 60Hz , 75Hz
1600 x 900 @ 60Hz , 75Hz
1440 x 900 @ 60Hz , 75Hz
1280 x 1024 @ 60Hz, 75Hz
1280 x 960 @ 60Hz, 75Hz
1280 x 720 @ 60Hz, 75Hz
1024 x 768 @ 60Hz, 70Hz,75Hz
800 x 600 @ 56Hz,60Hz, 72Hz,75Hz
720 x 576 @ 50Hz,60Hz, 75Hz
720 x 480 @ 60Hz, 75Hz
640 x 480 @ 60Hz,72Hz, 75Hz

*Specifications are subject to change without notice.

Troubleshooting

Problem	Possible solutions
THERE IS NO LED DISPLAY or SCREEN SAYS NO SIGNAL	<p>Make sure you switched to the correct source. Check both sources to see video is on the other source. Check your video cable. It might be corrupt. Swap out the video cable for another one to see if the monitor will work. Check your power plug. See if it is fully plugged in on both the monitor and the wall.</p>
MONITOR SAYS "SIGNAL OUT OF RANGE"	<p>If you have a CRT monitor, please connect the CRT monitor to the computer and change the refresh rate down to 60 Hz via your video card's display settings menu. After the setting of 60 Hz has been changed, you can then use the LED Monitor on the computer.</p> <ol style="list-style-type: none"> 1. To change the setting go to display settings by right clicking on your desktop with nothing selected. Choose the PROPERTIES option. 2. Click on the SETTINGS tab, verify the resolution is NOT higher than 1920 x 1080, and click on the ADVANCED button. 3. Click on the MONITOR tab and change the refresh rate to 60 Hz. 4. Click on OK 2-3 times to finalize your change. <p>If you do NOT have a CRT monitor or it's already broken, please make sure both the LED monitor and your computer is turned off.</p> <ol style="list-style-type: none"> 1. Turn on the LED monitor and the computer. 2. While the computer is turned on, press the "F8" key on your keyboard continuously until a selection menu appears and select the "Safe Mode" option. 3. When you've entered Safe Mode please uninstall any video card driver and monitor driver by using either the "Add / Remove Programs" icon or going into "System 4. Properties" and manually removing anything under "Monitors" and "Display Adapters". After removing all the drivers, please reboot your computer and you should be able to see windows. Please install your monitor driver first, then your video card driver. Please remember to make sure your refresh rate should be at 60Hz.
I CAN'T OPEN THE OSD	<p>You need to have a valid video signal going through the monitor before you can turn on the OSD.</p>

Problem	Possible solutions
<p>I CANNOT GET THE RESOLUTION 1920 x1080</p>	<p>Sometimes your video card will not read the monitor correctly and will not allow you to achieve the resolution you want. Rebooting your computer will solve the situation.</p> <p>You can also make sure your video card's video drivers are up to date. You can find what video card you have by clicking on START then RUN. Type in "DXDIAG". When the diagnostic window pops up, click on the DISPLAY tab. The program will tell you what video chipset you have. Copy that name then search it with an online search engine like GOOGLE™. Find your video card company's web address and search for newer drivers. If updating your drivers does not work, you probably have one of the older video cards and cannot achieve a widescreen resolution. You'll need to upgrade your video card to a newer one.</p>
<p>THE VIDEO IS TOO BRIGHT NO MATTER WHAT I ADJUST</p>	<p>Sometimes having older video cards this type of problem might happen due to newer LEDs having to provide HD video capability and not being fully compatible with older video cards. You can try adjusting the contrast to a lower value and adjust the brightness to compensate.</p>
<p>THE WORDS AND VIDEO ARE TOO BLURRY</p>	<p>Are you using the monitor's native resolution? If not you'll need to switch resolution to the native 1920 x 1080 at 60 Hz to make the words clearer.</p> <p>If the words are still blurry, please try enabling or disabling CLEAR TYPE function from windows.</p>
<p>THE COLORS ARE NOT CORRECT</p>	<p>Sometimes the colors are not correct because your DVI or DP or HDMI cable is loose or corrupt. Please try reconnecting your cable or swap out your current cable to see if the problem persists.</p>
<p>HOW DO I RESET THE MONITOR</p>	<p>Make sure there is a valid video signal to the monitor and press menu to open the OSD. Look for RESET under the OTHER options.</p>
<p>I CHANGED MY COLOR SETTINGS NOW I CAN'T GET THE FACTORY DEFAULT BACK.</p>	<p>Open the OSD, under OTHER, select RESET to reset all values back to factory default.</p>

Problem	Possible solutions
<p>THE WORDS ARE TOO SMALL AT 1920 x1080</p>	<p>At the native resolution of 1920 x 1080, some people might feel that the words are too small to read. You can change the size of the words in Windows Operating System via its display properties.</p> <p>For Windows XP</p> <ol style="list-style-type: none"> 1. Right click on the background with nothing selected. Left click on the PROPERTIES option. 2. Click on the SETTINGS tab. 3. Under SETTINGS, click on the ADVANCED button. 4. Under GENERAL tab, change the size of the words by selecting the option NORMAL SIZE and change it to LARGE SIZE. 5. Click on OK on all windows to exit. 6. Once you have finished rebooting, the computer is ready for use. <p>For Windows VISTA or Windows 8 or Windows 10</p> <ol style="list-style-type: none"> 1. Right click on the Wallpaper. Left click on the PERSONALIZE option. 2. Click on ADJUST FONT SIZE (DPI) option on the left column and 3. Click on CONTINUE. 4. In there you can change the size of the words by changing from the option DEFAULT SCALE to LARGE SCALE. 5. Click on APPLY to finalize your selection. 6. Once you have finished rebooting, the computer is ready for use.
<p>I CANNOT GET 144Hz REFRESH RATE ON MY MONITOR</p>	<p>Make sure your video card supports that feature. Also make sure you are using DisplayPort to connect from your computer to your monitor.</p>

Specification

Display panel	
Active Area / Screen Size	27" (diagonal 27")
Aspect Ratio	Widescreen 16 : 9
Resolution	Native: 1920 x1080
Brightness	250 cd/m ²
Dynamic Contrast	1,000,000:1 (3,000:1 typical)
Response Time	14 ms (With OD function on)
Refresh Rate	75 Hz Maximum Refresh Rate
Viewing Angle	Typical 178/178 Degree (Horizontal/Vertical)
Colors	16.7 million of colors (72% NTSC)
LED Backlight lifetime	≥30,000 hours
Monitor Display	
Dimension	With Stand: 24.18"x 17.06" x 6.22" Without Stand: 24.18"x14.14" x1.67"
Wall Mount Pattern	100mm x 100mm Screw Size M4 x 10mm
Base Screws	M4 x 10mm (1pcs)
Neck Screws	M4 x 10mm (2pcs)
Hinge Screw	M4 x 4.5mm (4pcs)
Power input	Input: 12VDC 3A
Tilt	-5° ~ 15°
Speaker Specification	NA
Features	
On Screen Display Control (OSD)	Luminance, Image Setup, Color Temp, OSD Setting, Reset, Extra
OSD Language	English (Default), French, Spanish
ECO Mode	Standard, Movie, Game, Internet
Preset Game Mode	NA
Blue Light Elimination	Available
I/O	HDMI x 1, VGA x 1
Compliance	FCC, cTUVus, CEC, RoHS

*Specifications are subject to change without notice.

FCC STATEMENT

This device complies with Part 15 of the FCC Rules. Operation is subject to the following two conditions:

- (1) This device may not cause harmful interference, and
- (2) This device must accept any interference received, including interference that may cause undesired operation.

LET'S REGISTER YOUR PRODUCT



It's super easy, just head on over to elementelectronics.com/register

BENEFITS OF REGISTERING YOUR PRODUCT:



Support

Get assistance quickly by pre-registering your product.



News & Offers

Take advantage of the latest news and special offers from Element.



Updates

Stay current with important product updates and notifications.

WE'RE HERE TO HELP

Find resources and get help for product setup, connecting devices, technical issues, downloading manuals and more!

We're available 24 hours a day, 7 days a week



elementelectronics.com



1.888.842.3577



customerservice@elementelectronics.com