

EUREKA®

INSTRUCTION MANUAL

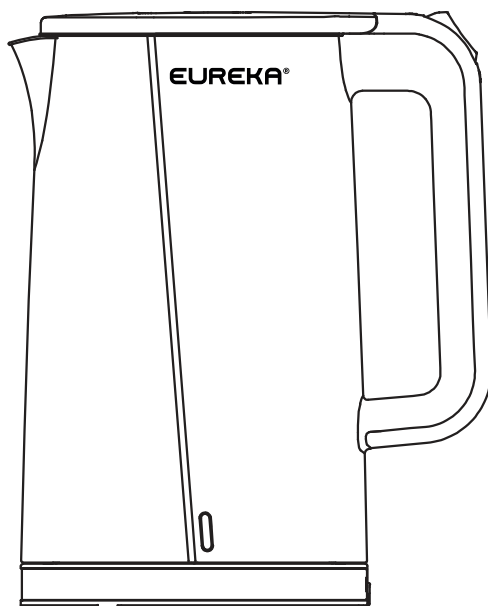

EKD 1.7L

***360 DEGREE ROTATION
AUTOMATIC CORDLESS KETTLE***

General Safety Instructions

- Before using this kettle, please read the instruction manual carefully.
- Please keep the instruction manual, warranty card, the sales receipt and if possible, the box with inner packaging.
- This kettle is intended exclusively for private and not for commercial use.
- Switch off the kettle and remove the plug from the socket when the kettle is not in use. When you disconnect the power cord of the kettle, grasp and pull the plug, not the cord/kettle.
- Switch off the kettle before cleaning it.
- Keep the kettle out of reach of children. Do not leave children unsupervised with the kettle
- This appliance can be used by children aged from 8 years and above if they have been given supervision or instruction concerning use of the appliance in a safe way and if they understand the hazards involved. Cleaning and user maintenance shall not be done by children unless they are older than 8 and supervised. Keep the appliance and its cord out of reach of children aged less than 8 years old. The unit can be used by person with reduced physical, sensory or mental capabilities or lack of experience and knowledge if they have been given supervision or instruction concerning use of the appliance in a safe way and understand the hazards involved. Children shall not play with the appliance.
- Test the kettle and the cord/cable regularly for damage. Check if the kettle is operating properly. If there is damage of any kind or if the kettle is not operating properly, stop using the kettle and unplug it immediately.
- Do not attempt to repair the kettle by yourself, only authorized and qualified personnel may repair this kettle.
- Keep the kettle and cord/cable away from heat, direct sunlight, water, moisture, sharp edges and the like.
- Use only original accessories, do not use incompatible products.
- Do not use the kettle outdoors.
- The base and exterior of the kettle are not water-resistant, keep it dry at all times.
- Under no circumstances must the kettle be placed in water or any liquid or come in contact with liquid. Do not handle the kettle with wet or moist hands. If the kettle become wet or moist, remove the main plug from the socket immediately.
- DO NOT touch the content of the kettle.
- Use the kettle only for its intended purpose.
- The kettle is only to be used with the base provided.
- If the cord/cable is damaged, it must be replaced by the manufacturer, its service agent or similarly qualified persons in order to avoid a hazard.
- Avoid water spillage on connector during use.
- WARNING! If the kettle is overfilled, boiling water may be expelled.

Special Safety Instructions for the Kettle

- The water level must be between the MAX and MIN marks.
- Switch the kettle off before removing from the base.
- Always ensure that the lid is tightly closed.
- The base and exterior of the kettle must not become wet.
- Kettle body used must match with the kettle base.

First Use of the Kettle

- Before using the kettle for the first time, fill the kettle with cold water and boiled it twice without any additives.

1. Fill the kettle with water. Do not overfill. Use the water level indicator.
2. Place the kettle on the base.

3. Electrical connection
 - Check whether the electrical voltage which you intend to use is the same as that of the kettle. Details can be found on the label on the base of the kettle.
 - Only connect the kettle to a properly installed socket.
4. Switch the kettle to position '1'. The control lamp on the water indicator shows that the water is being boiled.
5. After boiling, the kettle switches off automatically.
Disconnect the kettle from the main electricity supply.
Do not open the lid when pouring.
6. This appliance is intended to be used in household and similar applications such as:
 - staff kitchen areas in shops, offices and other working environments;
 - farm houses;
 - by clients in hotels, motels and other residential type environments;
 - bed and breakfast type environments.

Cleaning

Always remove the plug from the main supply before cleaning the kettle.
The exterior of the kettle should be cleaned, if necessary, with a slightly damp cloth without additives.
The calcium filter can be removed for cleaning

Power Supply: AC220-240V 50-60Hz 1850-2200W

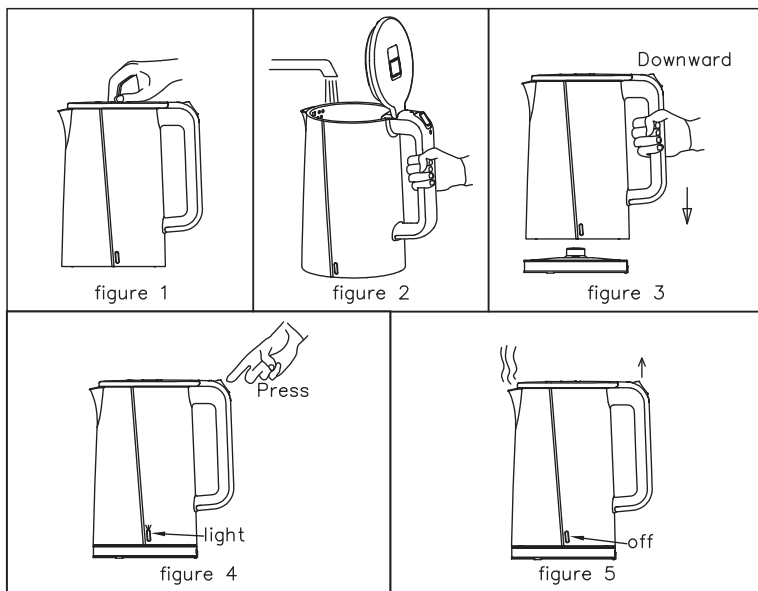

EUREKA[®]

Thank you for patronizing our products!

For more comments and suggestions,
please call our hotline numbers:

0998-584-2057 / 0917-814-5356

 eurekahomeappliances.com

 /EurekaHomeAppliances

 /EurekaHomeAppliancesPH

 @EurekaHomeAppliances