



finder®

12.B2 Toolbox app manual CONFIGURATION



INDEX

INTRODUCTION

DEVICE CONFIGURATION	3
CONFIGURATION PAGE	5

CONFIGURATION GENERAL PARAMETERS

TIME AND DATE	6
COORDINATE SETTINGS	7

CONFIGURABLE FUNCTIONS

COMMON PARAMETERS TO ALL FUNCTIONS	8
CHANNELS	9
PERIOD TYPE	9
TIMER (CLASSIC)	10
TIMER WITH CORRECTION ASTRO OVERLAY	10
PULSE	11
ASTRO	11
CYCLIC	12
RANDOM	12

CONFIGURATION MANAGEMENT

HOW TO SEND THE CONFIGURATION	13
SAVING CONFIGURATION SETTINGS	14

EXTERNAL CHANNELS

TYPE 13.21-B000 ASSOCIATION (CHANNELS C, D, E, F)	15
TYPE 13.21-B000 REMOVAL	17

EXTERNAL INPUTS

TYPE 1Y.P2 ASSOCIATION	18
TYPE 1Y.P2 REMOVAL	21

FINDER TOOLBOX APP



Free app for configuring Finder devices with your smartphone.
Series available for configuration: S12 - S18 - S7M - S70 - S84.

Available on:



INTRODUCTION

DEVICE CONFIGURATION

01

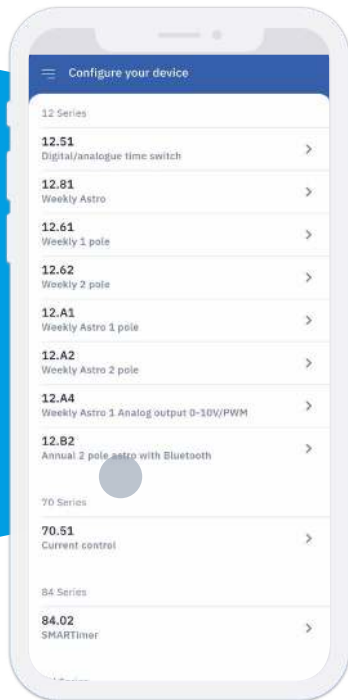

To start configuration, open the Toolbox app and select 12.B2 from the list.

Select "Communication channel" to continue.

02

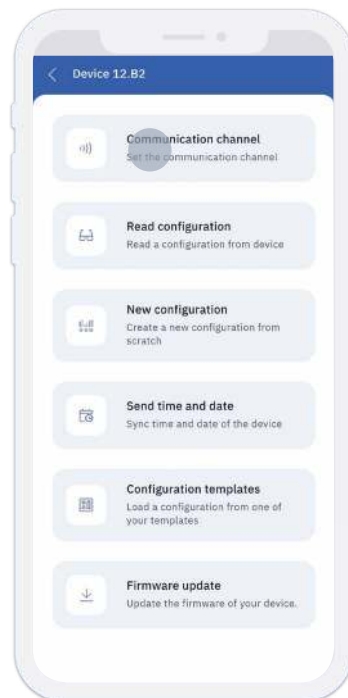

03

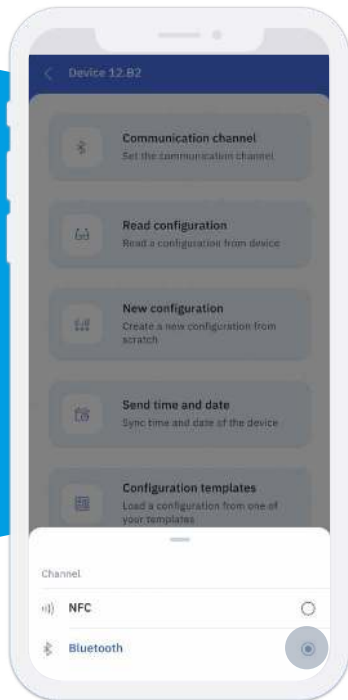

Next, you can choose the communication channel to configure the Type 12.B2.

- **NFC:** useful for configuring the device without powering it. It is not possible to associate external channels and input interfaces.
- **Bluetooth:** the device must be powered but you have access to all functions.

NOTE: to use Type 12.B2 with Bluetooth, you need to enable Bluetooth and Location (or GPS) on your smartphone.

If you selected “**Bluetooth**”, push the joystick down on the Type 12.B2 you wish to configure to proceed. If you selected “**NFC**”, place your smartphone on the face of the Type 12.B2 you wish to configure.

04

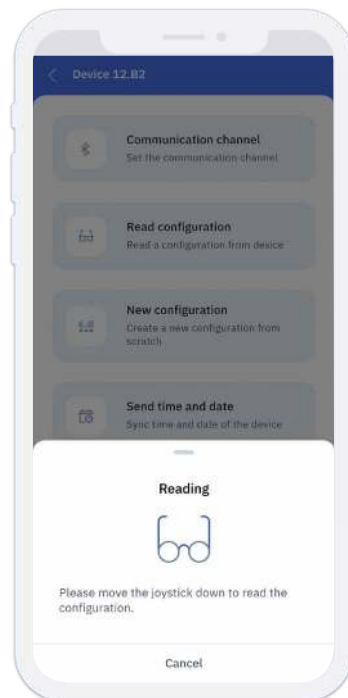

CONFIGURATION PAGE

The screenshot displays the configuration page for device 12.B2. The page is organized into several sections, each with a list of settings and a 'Send to device' button at the bottom.

- Settings** (toggle on):
 - Time and date**: Local time / Europe
 - Coordinate settings**: Italy / 10
 - Timer (classic)**: No events
 - Timer with correction astro overlay**: One event
 - Pulse**: No events
 - Astro**: No events
 - Cyclic**: No events
 - Random**: No events
- Remote channels**:
 - Channel C**: Not configured
 - Channel D**: Not configured
 - Channel E**: Not configured
 - Channel F**: Not configured
- Remote inputs**:
 - Input 1**: Button 1: Configured, Button 2: Configured
 - Input 2**: Not configured
 - Input 3**: Not configured
 - Input 4**: Not configured

Callout boxes provide additional context:

- General parameters of date, time, location and time zone**: Points to the 'Time and date' and 'Coordinate settings' sections.
- Configurable functions, effective programming of the device.**: Points to the 'Timer', 'Pulse', 'Astro', 'Cyclic', and 'Random' sections.
- Association of external channels Type 13.21-B000**: Points to the 'Remote channels' section.
- Association and configuration of external inputs Type 1Y.P2**: Points to the 'Remote inputs' section.

Send to device button is located at the bottom of the page.

CONFIGURATION GENERAL PARAMETERS

TIME AND DATE

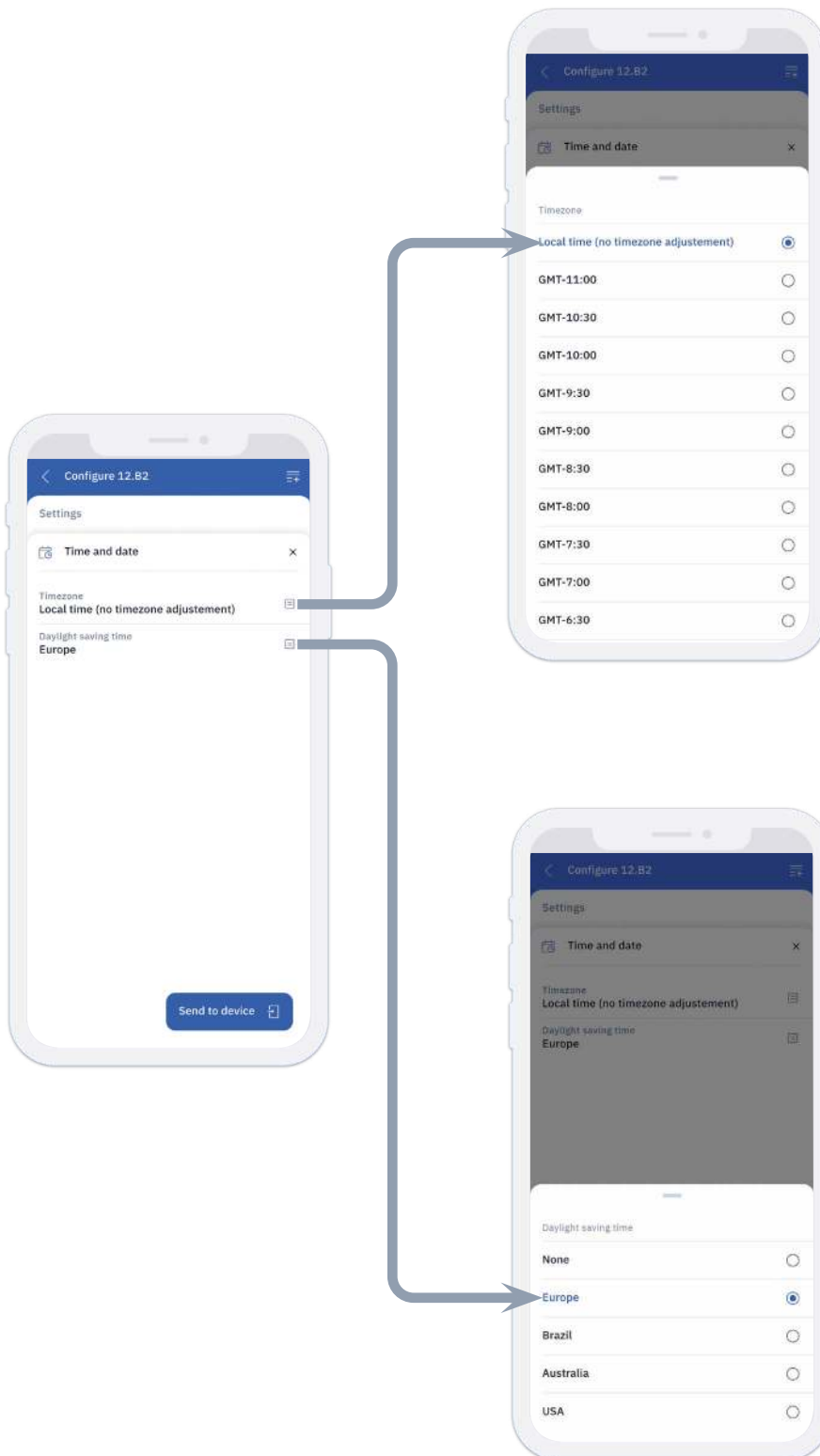

The Type 12.B2 default settings are “Local time” and daylight saving time “Europe”.

It is possible to switch from daylight saving time to standard time automatic for countries that follow the rules of:

- Europe
- Australia
- Brasil
- North America

COORDINATE SETTINGS

01

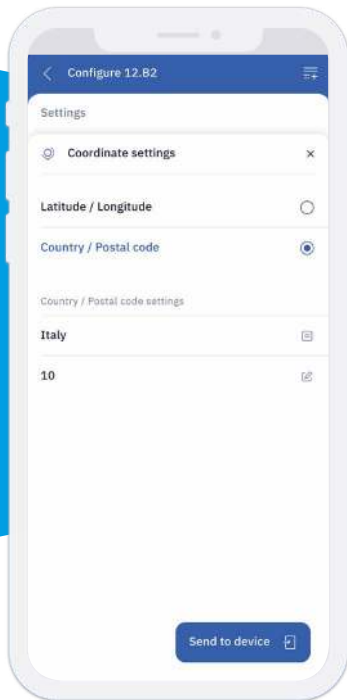

Country/Postal code

The fastest way to identify the device's geographical location is to enter the country and the first two digits of the postal code where the device is located. If your country is not available, enter your latitude and longitude manually.

Latitude/Longitude

If the country is not available in the previous option, manually enter the latitude, longitude and time zone where the device is located.

02



CONFIGURABLE FUNCTIONS

COMMON PARAMETERS TO ALL FUNCTIONS

All functions have some common parameters, such as:

- The **channel** (internal or external) on which the program I am configuring must run
- The **period type** that the program is to follow
- The **weekdays** in which the program must be repeated

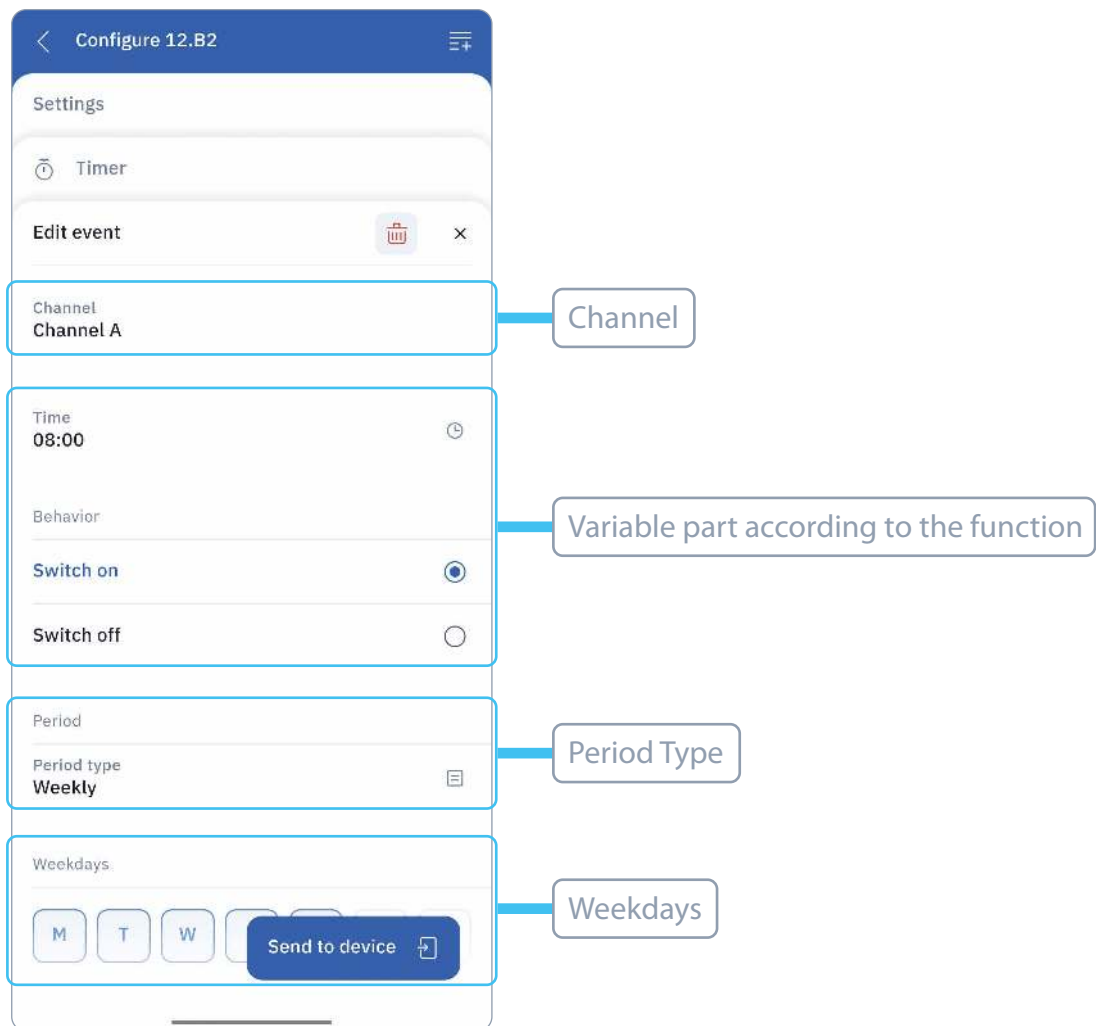

CHANNELS

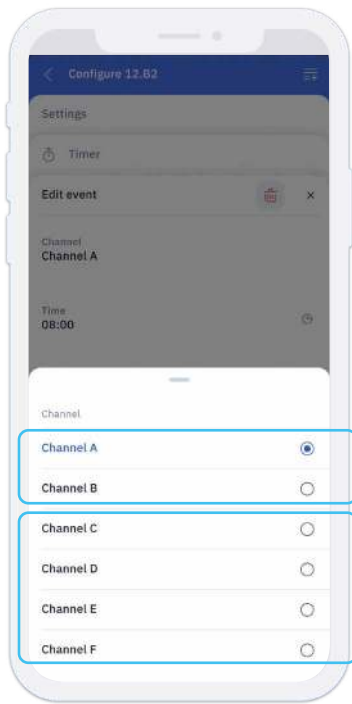

INTERNAL CHANNELS

Channels A and B refer to the internal relays of the Type 12.B2 being configured.

EXTERNAL CHANNELS

Channel C, D, E, F refer to external channels Bluetooth relays Type 13.21-B000.

NOTE: once associated, the P1 pushbuttons of Type 13.21-B000 will be disabled.

NOTE: the Types 13.21-B000 once associated with a Type 12.B2 to be used with the YESLY system must be associated with the system, reset to factory data and associated again.

PERIOD TYPE

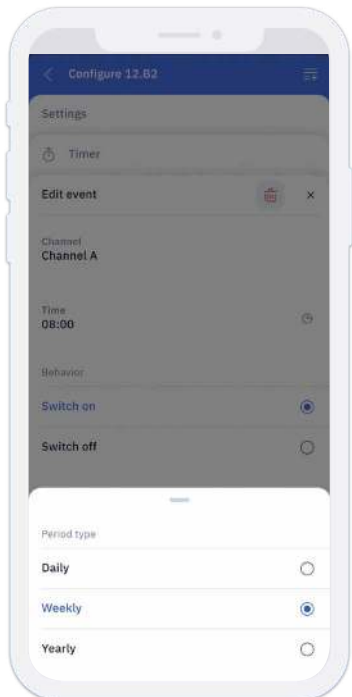

Type 12.B2, being an annual clock, requires a configuration relating to the type of period to be configured:

- **WEEKLY:** "standard" programming runs every day, low priority. Max 60
- **YEARLY:** programming runs between 2 specific dates. Medium priority. Max 20
- **DAILY:** performed on a specific day of the year. Eg. Christmas Day High priority Max 20

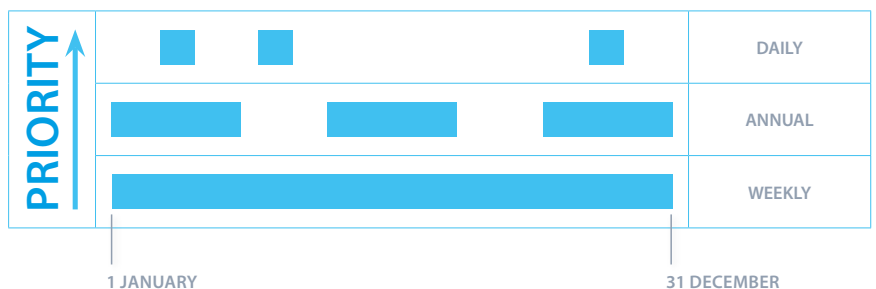

TIMER (CLASSIC)

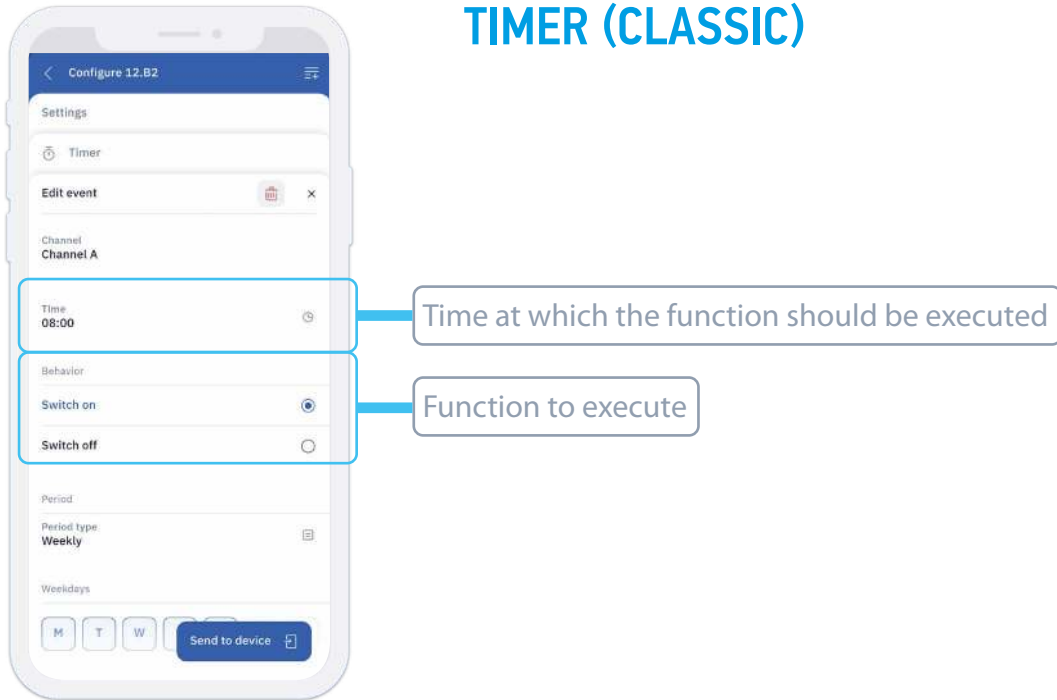

TIMER WITH CORRECTION ASTRO OVERLAY

With the **TIMER WITH CORRECTION ASTRO OVERLAY** function, it is possible to ensure an on or off priority at the time of the function to ensure, for example, that the output is switched off at dawn.

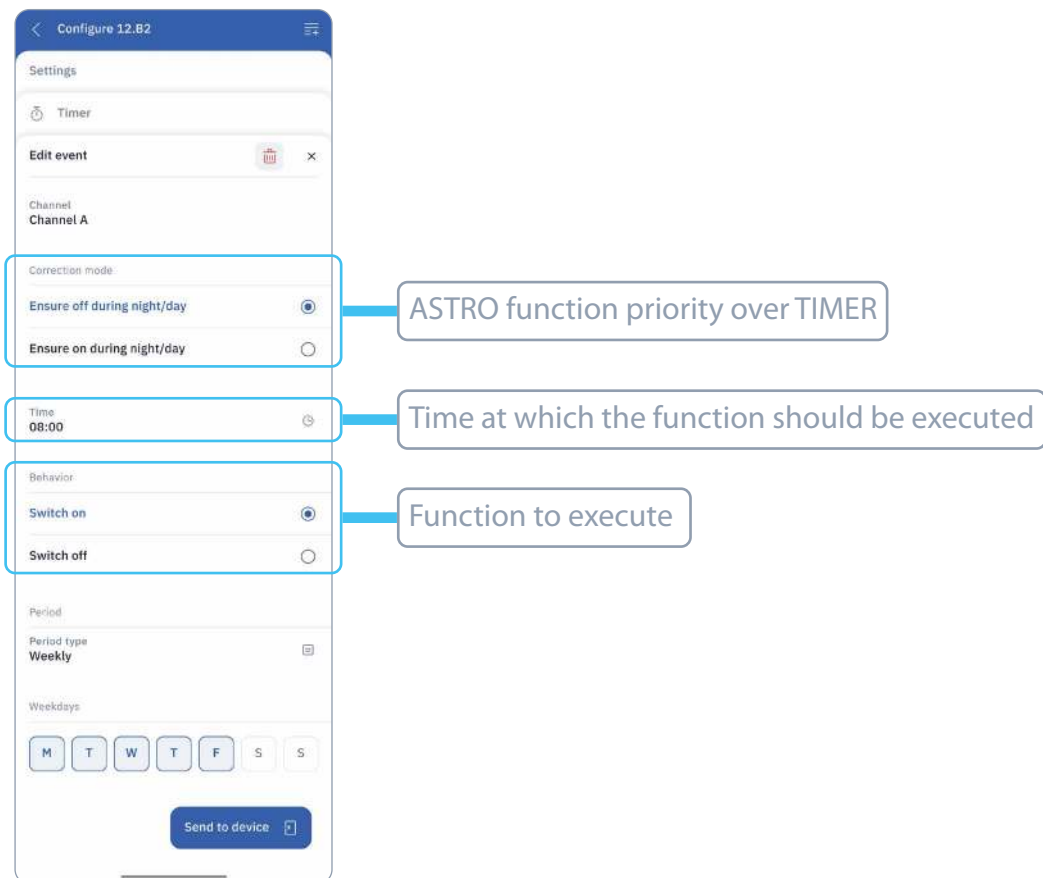

PULSE

With the **PULSE** function, it is possible to set the activation of the selected channel at a specific time for a time from 1 second to 90 minutes.

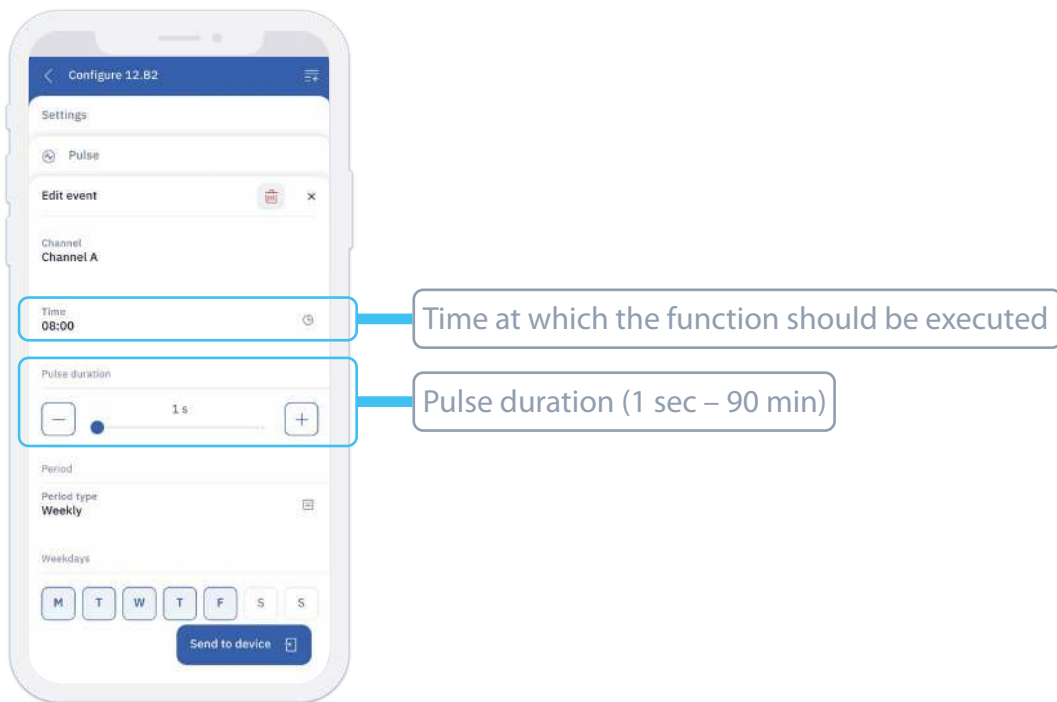

ASTRO

The **ASTRO** function allows “light-dependent” management by enabling or disabling the channel according to the sunrise and sunset times. It is possible to set an offset from the natural time.

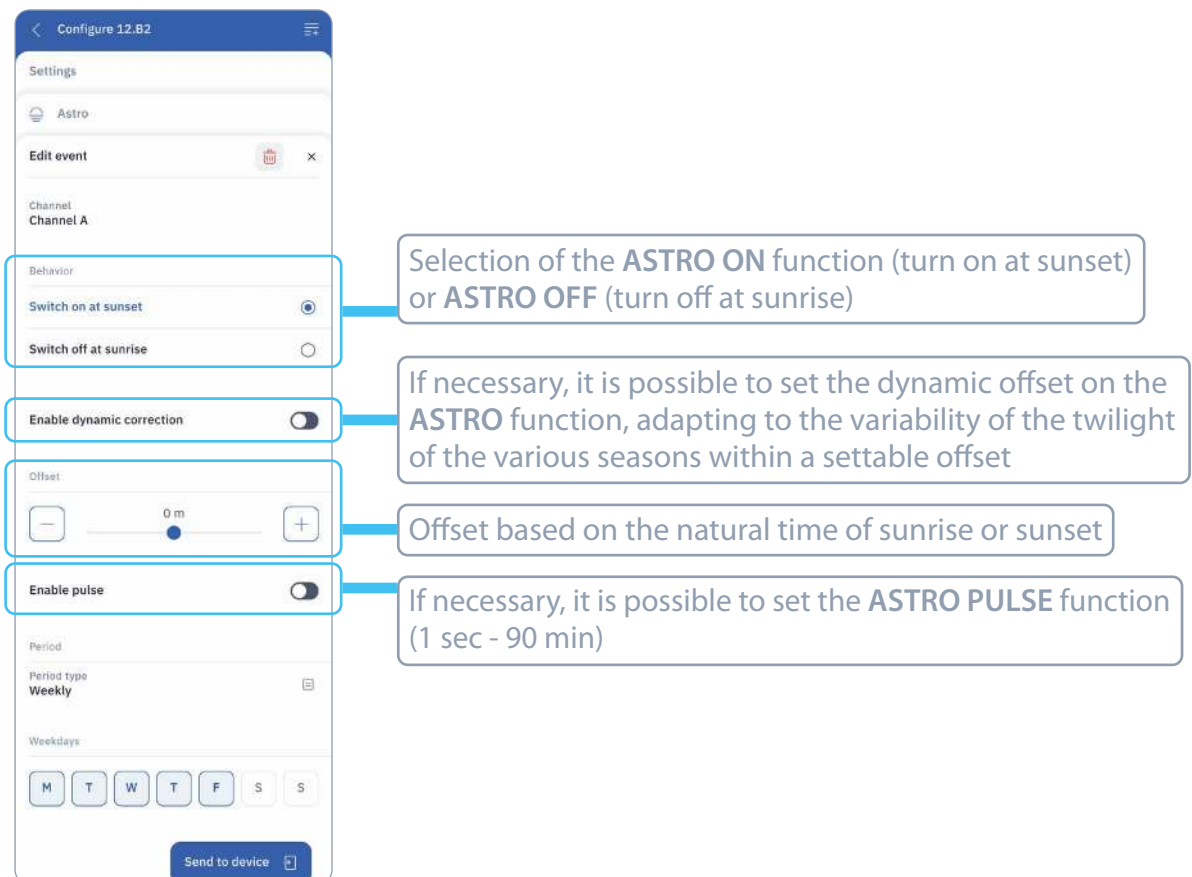

CYCLIC

The logic of the **CYCLIC** function is similar to that of pause and work. It is necessary to set a start time, a function end time then the time of the complete work cycle and the time of the pulse at the ON start.

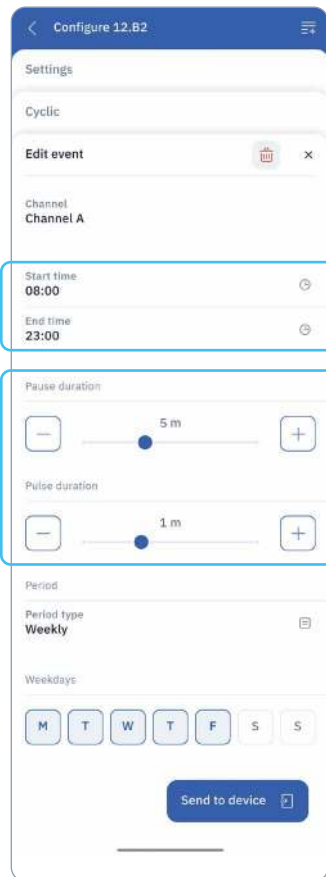

Times within which the function must be active

Period duration: duration of the complete work cycle
Pulse duration: duration of contact switching on

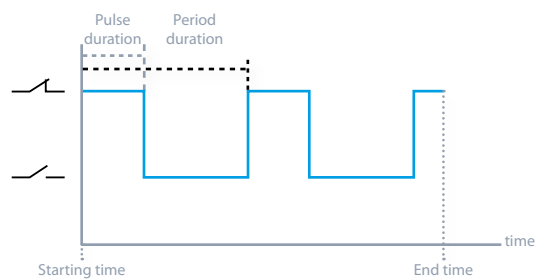

RANDOM

With the **RANDOM** function, you can carry out random switching. Eg. to simulate your presence at home when you are on holiday.

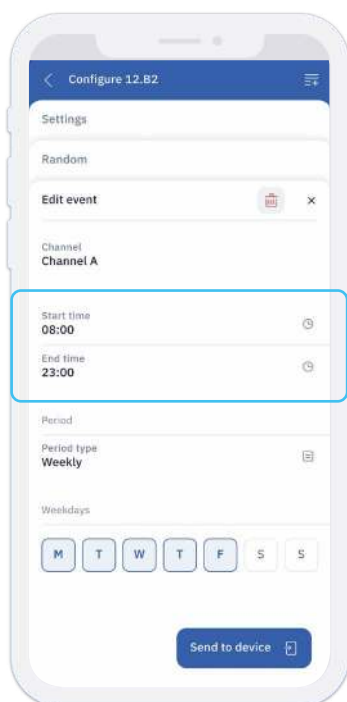

Times within which the function must be active

CONFIGURATION MANAGEMENT

HOW TO SEND THE CONFIGURATION

01

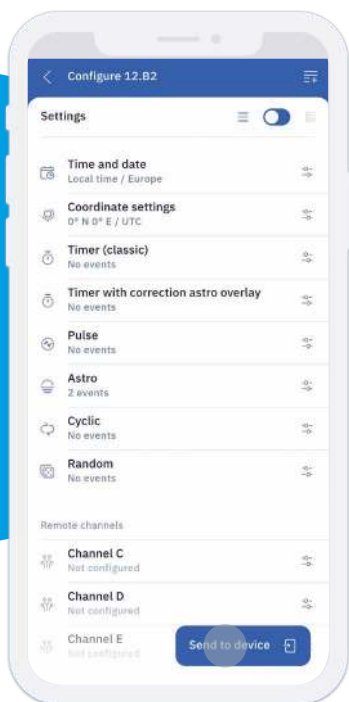

Once the configuration setup is completed, press “Send to device” to continue.

You can:

- **Send time and date:** Send only the time and date (no postal code and coordinates).
- **Send configuration:** Send all configuration settings as well as time, date, postal code and coordinates.

NOTE: if in Bluetooth mode, the transfer is automatic (press the joystick down if the transfer is not immediate).

In NFC mode, it is necessary to touch the back of the phone against the front of the Type 12.B2.

02

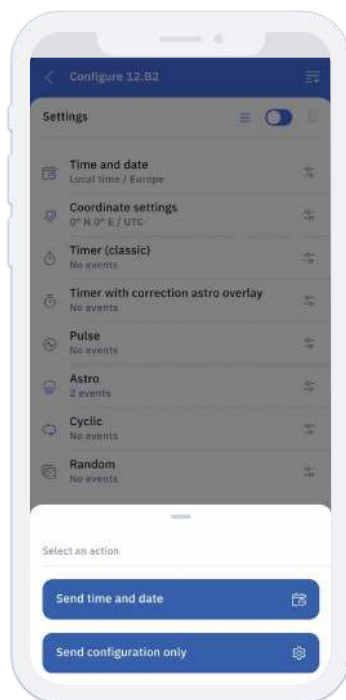

SAVING CONFIGURATION SETTINGS

01

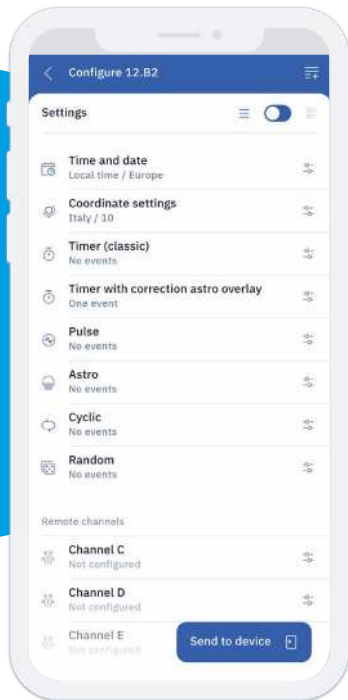

Once the configuration setup is completed, select the icon in the top right of the app to save it.

Enter the name of the configuration and select "Save".

NOTE: the saved programming does not include the association of both external input and output channels, but the programs relating to channels B, C, D, E, F will still be saved.

It will therefore be necessary to associate different devices to the different Type 12. B2 on which the saved programming will be applied.

02

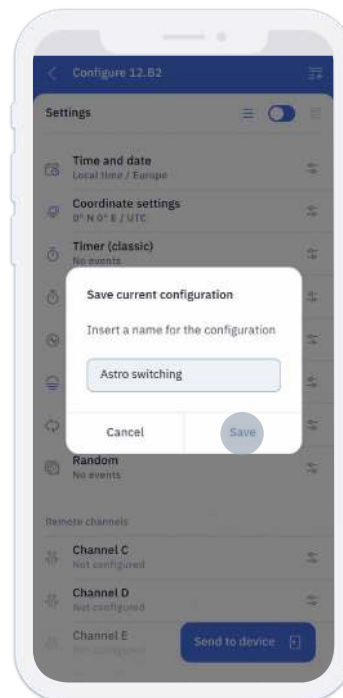

EXTERNAL CHANNELS

TYPE 13.21-B000 ASSOCIATION (CHANNELS C, D, E, F)

01

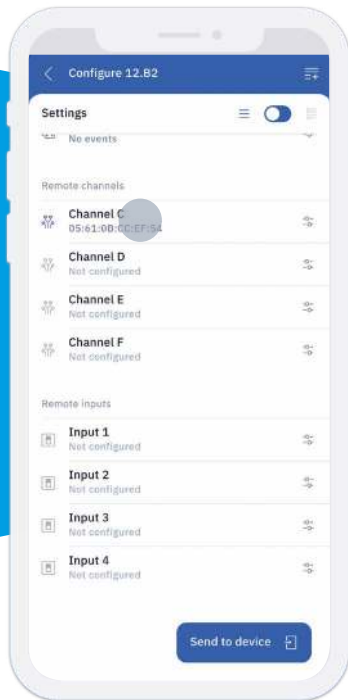

To associate an external channel, select it from the list on the main screen.

Eg: Channel C

Before powering up Type 13.21-B000, wire a button between terminals L and P1 as it will be used for association.

Press "Configure" to continue.

02

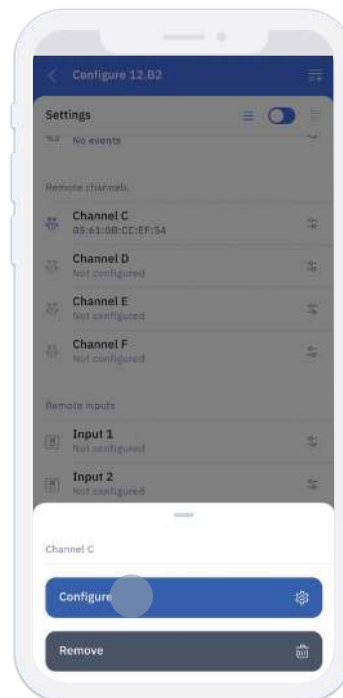

03

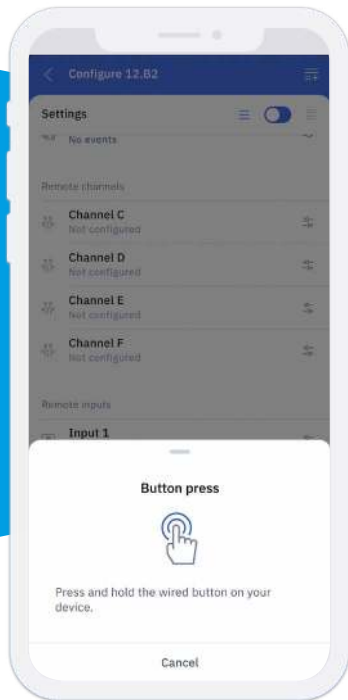

Press and hold down the button between terminals L and P1 of Type 13.21-B000.
When prompted, release the button.

NOTE: once associated, the P1 pushbuttons of Type 13.21-B000 will be disabled.

Now the device is associated, it is good practice to mark the channel on the Type 13.21-B000 for easier identification.

NOTE: once the Type 13.21-B000 has been associated with a Type 12.B2, it must be reset to factory settings before being associated with another 12.B2 or YESLY system.

04

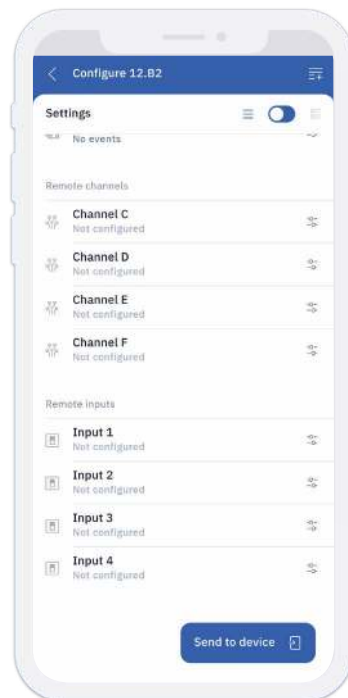

TYPE 13.21-B000 REMOVAL

01

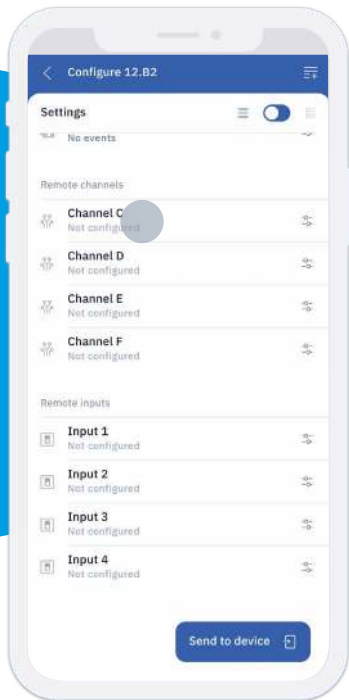

Selected the external channel you want to remove.

Select "Remove".

NOTE: you must be near the device for this operation to be successful.

02

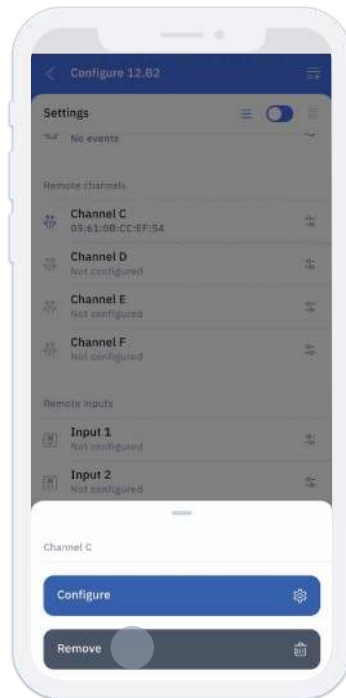

EXTERNAL INPUTS

TYPE 1Y.P2 ASSOCIATION

01

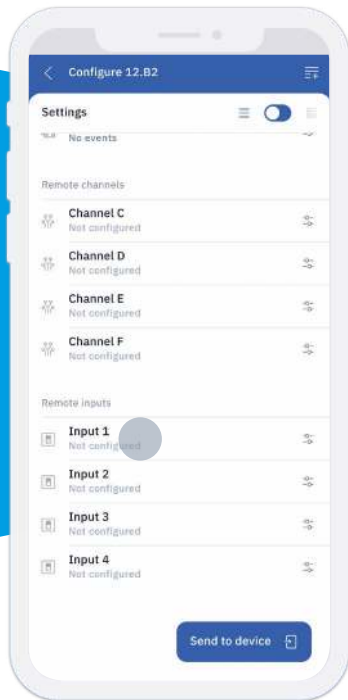

To associate an external input, select it from the list on the main screen.

Eg: Input 1

NOTE: check that the Type 1Y.P2 input interface has not been previously configured as a “scenario” in a YESLY system.

Press “Configure” to continue.

02

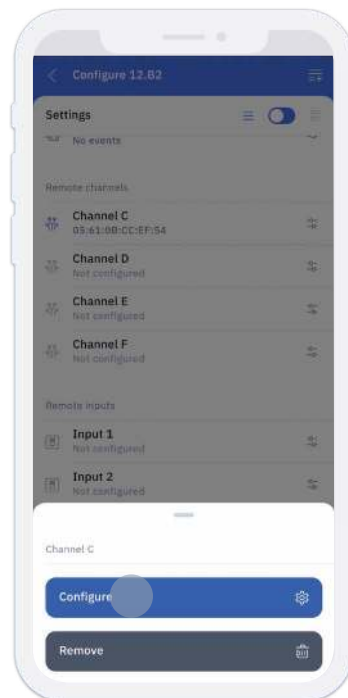

03



Select the buttons (P1, P2) you want to use.

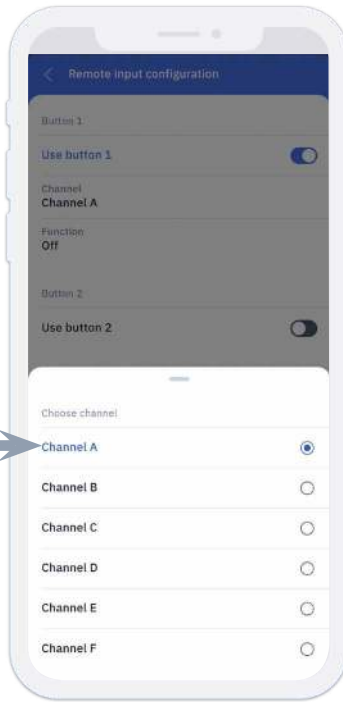

You can associate the button with either an internal or remote channel.

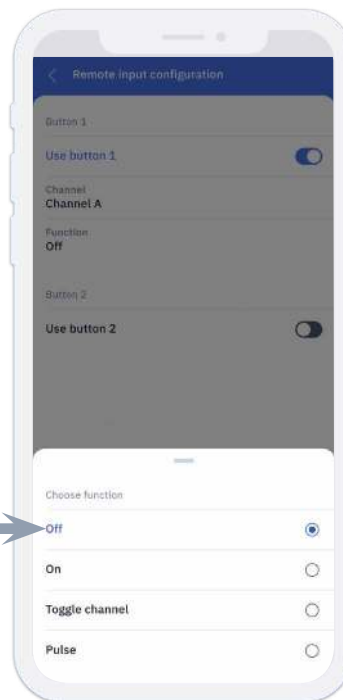

You can set various functions to the button, including:

- **OFF:** forcing off
- **ON:** forcing on
- **Toggle:** step relay, switches the output at each pressure
- **Pulse:** like a staircase timer, it keeps the channel on for a specific time (resettable)

04

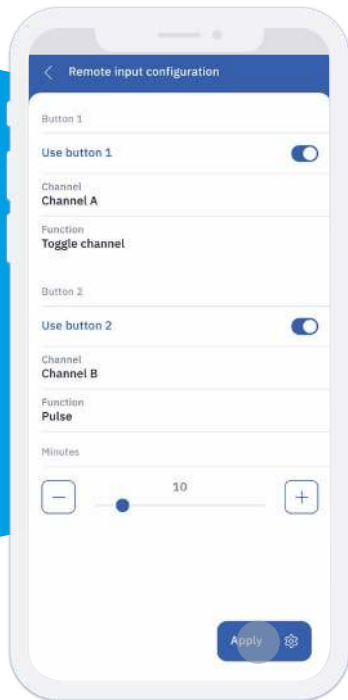

To complete the configuration, select "Apply".

Press and hold the required wired push button connected to the Type 1Y.P2 (these buttons should be connected between P1-L1 or P2-L2). When prompted release the wired push button. Wait for the configuration to be transferred to the Type 12.B2.

05

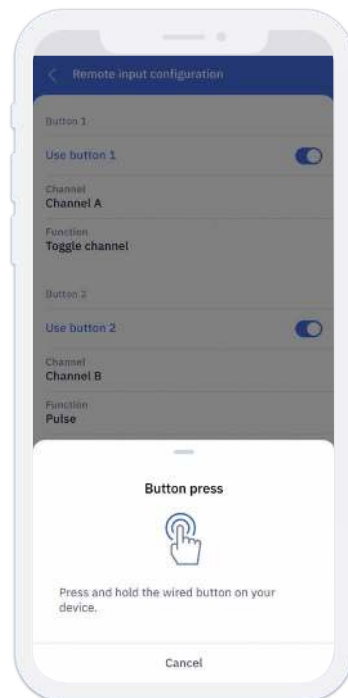

TYPE 1Y.P2 REMOVAL

01

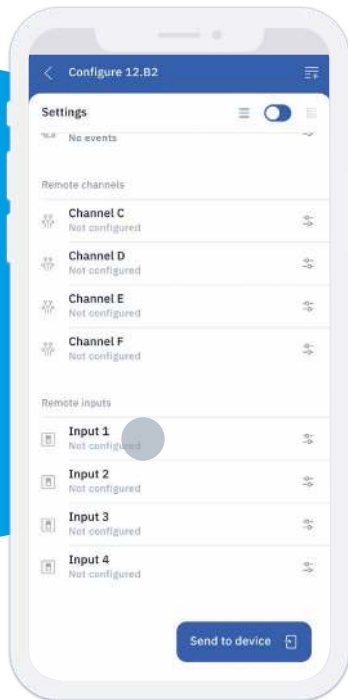

Select the external input you want to remove.

Select "Remove".

NOTE: you must be near the device for this operation to be successful.

02

