

## ARCTIC 12V FRENCH DOOR REFRIGERATOR

MODEL (LIPPERT PN)  
FCR20DCAFA-SV (2022120378)

---

## TROUBLESHOOTING AND SERVICE MANUAL

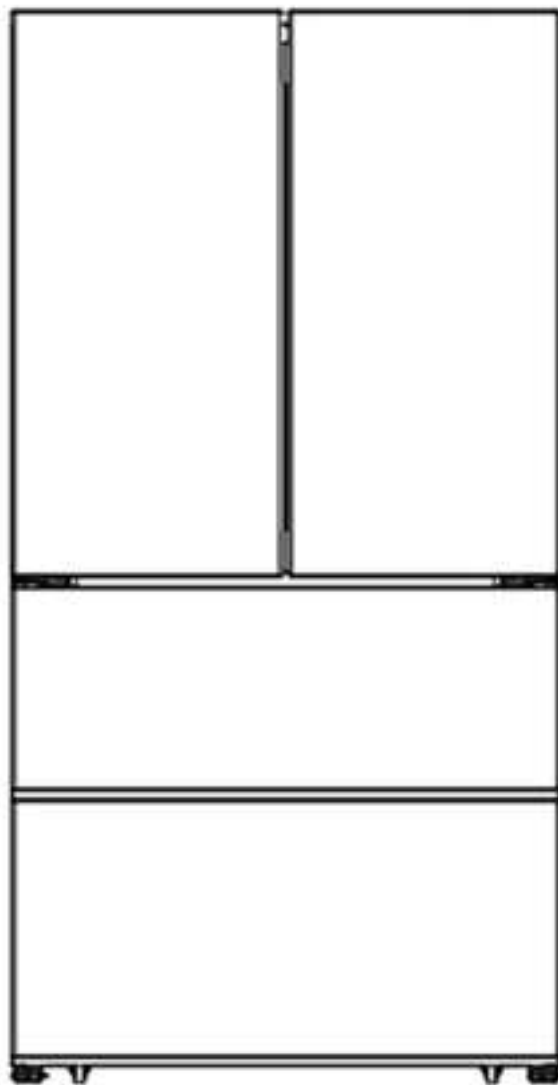

\* Picture shown here is for reference only.

This manual contains the product's basic information, safety, maintenance, replaceable parts, fault diagnosis and basic troubleshooting procedures.

# TABLE OF CONTENTS

<b>Introduction</b> .....	2
<b>Safety</b> .....	2
<b>Important Safety Instructions</b> .....	3
Precautions/Warnings.....	3
Refrigerant.....	3
<b>Maintenance and cleaning</b> .....	4
<b>Exterior Cleaning</b> .....	4
<b>Interior cleaning</b> .....	4
<b>Door Seals Cleaning</b> .....	4
<b>Replaceable Parts List</b> .....	5
<b>Troubleshooting</b> .....	6
Normal Phenomena.....	6
Troubleshooting.....	8
<b>Specification</b> .....	9
Climate Class.....	9

## Introduction

This document provides an overview on replaceable parts for Furrion® Arctic 12V French Door Refrigerator, as well as basic troubleshooting and service information.

Please keep this user manual in a safe place for future reference. This will ensure safe use and reduce the risk of injury. Be sure to pass on this manual to new owners of this product.

For more detailed operation, including general safety instructions, warnings and cautions, scan the QR code or click the link to go to the Instruction Manual:

<https://support.lci1.com/documents/ccd-0006076>



**NOTE:** Images used in this document are for reference only when assembling, installing and/or operating this product. Actual appearance of provided and/or purchased parts and assemblies may differ.

## Safety

Read and understand all instructions before installing or operating this product. Adhere to all safety labels.

This manual provides general instructions. Many variables can change the circumstances of the instructions, i.e., the degree of difficulty, operation and ability of the individual performing the instructions. This manual cannot begin to plot out instructions for every possibility, but provides the general instructions, as necessary, for effectively interfacing with the device, product or system. Failure to correctly follow the provided instructions may result in death, serious personal injury, severe product and/or property damage, including voiding of the Lippert limited warranty.



The "WARNING" symbol above is a sign that a procedure has a safety risk involved and may cause death or serious personal injury if not performed safely and within the parameters set forth in this manual.



Failure to follow instructions provided in this manual may result in death, serious personal injury and/or severe product and property damage, including voiding of the component warranty.



The "CAUTION" symbol above is a sign that a safety risk is involved and may cause personal injury and/or product or property damage if not safely adhered to and within the parameters set forth in this manual.

## ⚠ CAUTION

**Always wear eye protection when performing service, maintenance or installation procedures. Other safety equipment to consider would be hearing protection, gloves and possibly a full face shield, depending on the nature of the task.**

## Important Safety Instructions

### Precautions/Warnings

## ⚠ WARNING

- This appliance is intended to be used in household and similar applications.
- Do not store explosive substances such as aerosol cans with a flammable propellant in this appliance.
- If the supply cord is damaged, it must be replaced by the manufacturer, its service agent or similarly qualified persons in order to avoid a hazard.
- Keep ventilation openings, in the appliance enclosure or in the built-in structure, clear of obstruction.
- Do not use mechanical devices or other means to accelerate the defrosting process, other than those recommended by the manufacturer.
- Do not damage the refrigerant circuit.
- Do not use electrical appliances inside the food storage compartments of the appliance, unless they are of the type recommended by the manufacturer.
- The refrigerant and insulation blowing gas are flammable. When disposing of the appliance, do so only at an authorized waste disposal center. Do not expose to flame.
- When positioning the appliance, ensure the supply cord is not trapped or damaged.
- Do not locate multiple portable socket-outlets or portable power supplies at the rear of the appliance.
- To avoid a hazard due to instability of the appliance, it must be fixed in accordance with the instructions.

### Refrigerant

## ⚠ DANGER

### **RISK OF FIRE OR EXPLOSION**

- Flammable refrigerant used. Do not use mechanical devices to defrost refrigerator. Do not puncture refrigerant tubing.
- Flammable refrigerant used. To be repaired only by trained service personnel. Do not puncture refrigerant tubing.

## ⚠ CAUTION

### **RISK OF FIRE OR EXPLOSION**

- Flammable refrigerant used. Consult repair manual/owner's guide before attempting to service this product. All safety precautions must be followed.
- Dispose of property in accordance with federal or local regulations. Flammable refrigerant used.
- Risk of fire or explosion due to puncture of refrigerant tubing. Follow handling instructions carefully. Flammable refrigerant used.

The refrigerant isobutane (R600a) is contained within the refrigerant circuit of the appliance, a natural gas with a high level of environmental compatibility, which is nevertheless flammable.



During transportation and installation of the appliance, be certain that none of the components of the refrigerant circuit become damaged.

If the refrigerant circuit should become damaged:

- Avoid open flames and sources of ignition;
- Thoroughly ventilate the room in which the appliance is situated.

## Maintenance and cleaning



### **ELECTRIC SHOCK!**

#### **Always disconnect power before cleaning or maintenance**

- Do not clean the appliance with metal objects, steam cleaner, ethereal oils, organic solvents or abrasive cleansers.
- Do not use sharp objects to remove frost from the appliance.
- Use a plastic scraper.

## Exterior Cleaning



### **Don't use Thinner, Car detergent, Clorox, ethereal oil, abrasive cleansers or organic solvent such as Benzene for cleaning as they may damage the surface of the appliance and may cause fire.**

To maintain good appearance of your appliance, you should clean it regularly.

Wipe the digital panel and display panel with a clean, soft cloth.

Spray water onto the cleaning cloth instead of spraying directly on the surface of the appliance. This helps ensure an even distribution of moisture to the surface.

Clean the doors and cabinet surfaces with a mild detergent and then wipe dry with a soft cloth.

## Interior cleaning

You should clean the appliance interior regularly. Follow the below steps:

- Wipe the inside of the refrigerator freezer with a weak solution of baking soda, and then rinse with warm water using a wrung-out sponge or cloth.
- Wipe completely dry before replacing the shelves and baskets. Thoroughly dry all surface and removable parts.



### **Only after the interior is completely dry the appliance should be switched back on.**

## Door Seals Cleaning

Take care to keep door seals clean. Sticky food and drinks can cause seals to stick to the cabinet and tear when you open the door.

Wash seals with a mild detergent and warm water.

Rinse and dry it thoroughly after cleaning.

**NOTE:** Only after the door seals are completely dry the appliance should be powered on.

## Replaceable Parts List

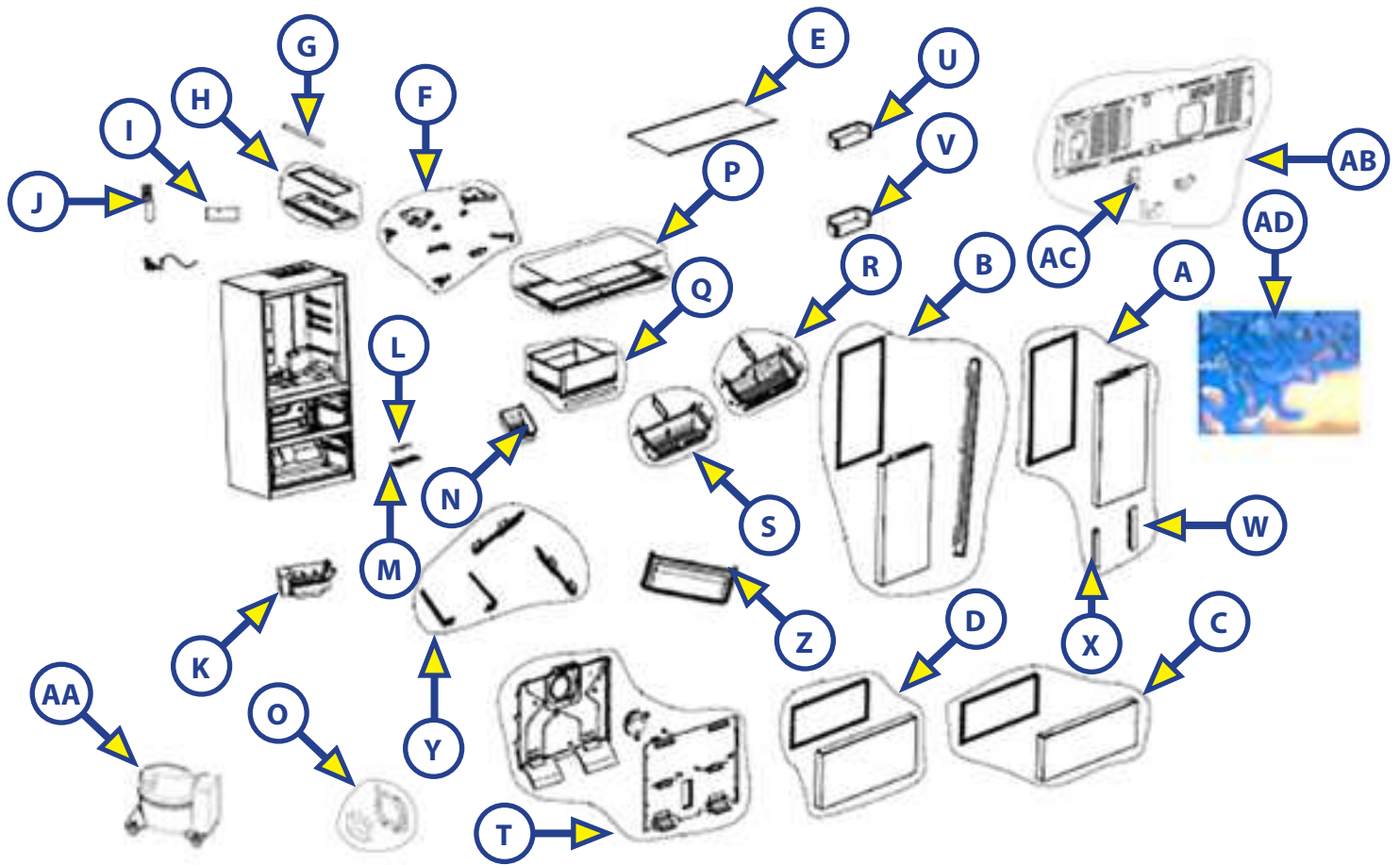

Callout	Part #	Description	Model
A	<a href="#">2022433402</a>	Right Refrigerator Door Assembly	FCR20DCAFA-SV
B	<a href="#">2022433403</a>	Left Refrigerator Door Assembly	FCR20DCAFA-SV
C	<a href="#">2022433404</a>	Upper Freezer Drawer Door Assembly	FCR20DCAFA-SV
D	<a href="#">2022433405</a>	Lower Freezer Drawer Door Assembly	FCR20DCAFA-SV
E	<a href="#">2022453299</a>	Glass Shelf Assembly	FCR20DCAFA-SV
F	2022453300	Hinge Kit	FCR20DCAFA-SV
G	2022453301	Cooler LED Light	FCR20DCAFA-SV
H	<a href="#">2022453302</a>	Cooler Lamp Assembly	FCR20DCAFA-SV
I	2022453303	Main Control Panel	FCR20DCAFA-SV
J	<a href="#">2022453304</a>	Water Valve Connector Kit	FCR20DCAFA-SV
K	<a href="#">2022453305</a>	Ice Maker Assembly	FCR20DCAFA-SV
L	2022453306	Freezer LED Light	FCR20DCAFA-SV
M	2022453307	Freezer Lamp Cover	FCR20DCAFA-SV
N	<a href="#">2022453308</a>	Ice Storage Box	FCR20DCAFA-SV
O	<a href="#">2022453309</a>	Condenser Fan Assembly (Including: Condenser Fan, Fan Mounting Bracket and Sealing Sponge Stick on Fan Mounting Bracket)	FCR20DCAFA-SV
P	<a href="#">2022453310</a>	Vegetable Glass Shelf Frame Assembly	FCR20DCAFA-SV
Q	<a href="#">2022453311</a>	Vegetable Drawer Assembly	FCR20DCAFA-SV

Callout	Part #	Description	Model
R	<a href="#">2022453312</a>	Freezer Upper Drawer Assembly	FCR20DCAFA-SV
S	<a href="#">2022453313</a>	Freezer Lower Drawer Assembly	FCR20DCAFA-SV
T	<a href="#">2022453314</a>	Freezer Motor Assembly	FCR20DCAFA-SV
U	<a href="#">2022453315</a>	Balcony (Upper Door Bin)	FCR20DCAFA-SV
V	<a href="#">2022453316</a>	Gallon Bin (Lower Door Bin)	FCR20DCAFA-SV
W	<a href="#">2022453317</a>	Vertical Display Panel Multh	FCR20DCAFA-SV
X	<a href="#">2022453318</a>	Display Panel	FCR20DCAFA-SV
Y	2022453319	Drawer Glides Assembly	FCR20DCAFA-SV
Z	<a href="#">2022453320</a>	Upper Drawer #2	FCR20DCAFA-SV
AA	<a href="#">2022128891</a>	Compressor Driver Board	FCR20DCAFA-SV
AB	<a href="#">2022453321</a>	Water Valve Kit	FCR20DCAFA-SV
AC	<a href="#">2022453322</a>	Water Valve-2	FCR20DCAFA-SV
AD	<a href="#">2022453323</a>	Blue Water Valve Clip	FCR20DCAFA-SV

## Troubleshooting

### **WARNING**

**Before troubleshooting, disconnect the power supply.**

#### **IMPORTANT!**

When the compressor is being turned on, the refrigerator creates some sounds/noises, like gurgling - this is perfectly normal.

Repairs to refrigerators/freezers may only be performed by competent service engineers. Improper repairs can give rise to significant hazards for the user. If your appliance needs repairing, please contact your specialist dealer or your local Service Centre.

## Normal Phenomena

Normal Phenomena	Cause
Button failure	Please check the control board whether the fridge under lock mode. When under lock mode, all buttons can't work.
Low voltage, the compressor can't start	Charge the RV-batteries by connecting the RV to the shore power.
Long time to start	When the surrounding ambient temperature is high, it will take a while to feel the compartments cooling.
Middle beams feel hot	Middle beams feel hot after a period of time of the appliance running, it belongs to the normal phenomenon.
Dew drops	When external air flows into the cool inner surface of the fridge, dew drops can be formed. If the humidity of the installed location is high or during the rainy season, dew drops can form on the outer side of the fridge. This is a natural phenomenon that occurs during the humid weather. Wipe the water drops with a dry cloth.

Normal Phenomena	Cause
Noise	<p>When you operate the fridge for the first time, the fridge will operate at high speed to cool fast and the sound can seem louder. When the internal temperature falls below a certain level, the noise will subside.</p> <p>When the operation of the compressor is starting or ending; various parts expanding/contracting or various control devices operating or temperature change within the fridge, you will hear the sounds, these are normal sounds.</p>
Compressor hot	<p>When working, the temperature of the compressor housing may rise to more than 176 °F (80 °C) - please do not touch the compressor, it may cause serious injury.</p>
Compressor long time running	<p>When the ambient temperature too high or put too much fresh foods into the refrigerator, it will take long time to cool down until the appliance run at the setting temperature.</p>
Abnormal odors in refrigerator	<p>Odorous foods shall be packaged tightly; check for bad foods; the inside of refrigerator shall be cleaned.</p>
Ice maker failing to work normally	<p>Check the ice maker switch is turned on; whether the freezer compartment door is closed or ajar; Whether the water valve is opened; whether water supply is obstructed, or water pressure is too low; Whether the temperature of freezer compartment is high due to just power connection or frequent use.</p>
Water leakage from ice outlet upon power-on for the first time	<p>During power up, the system will undergo a self-check process which will allow a little water flow out of the ice maker. This is normal, and should be dried up.</p>
Ice frozen together when ice maker operates stably	<p>If ice is not used frequently, ice cubes may freeze together; take out the frozen ice cubes from the ice storage box, break into pieces and then put back, or discard directly.</p>

## Troubleshooting

Before calling for service, review this list. It may save you both time and expense. This list includes common occurrences that are not the result of defective workmanship or materials in this appliance.

Fault	Possible Cause	Remedial Action
No display on the display panel	The fuse for the domestic supply is switched off.	Check whether the power is on; the fuse must be switched on.
Alarm sound	Door has been open for more than 1 minute.	Close the door completely.
The compressor is not working	Compressor will turn on/off normally to maintain temperature.	Do the cavity compartments maintain a cold temperature - everything is normal.
	The unit is in defrosting mode, no power.	Check all wiring connections and fuses.
	The unit was not turned off during storage, and over temped.	Disconnect power so that no display or cavity light illuminates, and reconnect power. This will reset power to the unit.
Compressor runs too long	The fridge has recently been disconnected for a period of time; Put too much fresh or hot food ; Doors are opened too frequently or too long.	It takes some hours for the refrigerator to cool down completely ; Hot food will cause the fridge to run longer until the desired temperature is reached ; Warm air entering the fridge cause it to run longer. Open the door less often.
Vibrating noise	Floor is uneven or weak ; Items placed on the top of the fridge are vibrating; Fridge is touching wall or cabinets.	Be sure floor is level and solid and can adequately support refrigerator; Remove items; Move refrigerator so that does not touch the wall or cabinets.

## Specification

Specifications	
Total Capacity	19.6cu.ft.
Freezer Capacity	7.25cu.ft
Refrigerator Capacity	12.31cu.ft.
Noise (dB)	≤42dB
Door Type	French door
Handle	Recessed handle
Control Type	LED Display with electronic control
No. of Shelves	3
No. of Crisper	Total 4 drawers, 2 in fridge compartment, 2 in freezer compartment
Cooling Type	Compression cooling system
Refrigerant	R600a
Rated Voltage	DC 12V
Rated Current	15A
Power Consumption	566kwh/year
Off-Grid Rating	4.9Ah@77°F(25°C)
Temperature Range	Refrigerator: 32°F to 43°F (0°C to 6°C) adjustable- Freezer: -10°F to 5°F (-23°C to -15°C) adjustable
Working Temperature Range	50°F to 110°F (10°C to 43°C)
Defrost	Automatic
Certification	CSA

## Climate Class

- Extended temperate(SN): this refrigerating appliance is intended to be used at ambient temperatures ranging from 50 °F (10 °C) to 90 °F(32 °C);
- Temperate(N): this refrigerating appliance is intended to be used at ambient temperatures ranging from 61 °F(16 °C) to90 °F(32 °C);
- Subtropical(ST): this refrigerating appliance is intended to be used at ambient temperatures ranging from 61 °F(16 °C) to 100 °F(38 °C);
- Tropical(T): this refrigerating appliance is intended to be used at ambient temperatures ranging from 61 °F(16 °C) to 109 °F(43 °C).



This marking indicates that this product should not be disposed with other household wastes. To prevent possible harm to the environment or human health from uncontrolled waste disposal, recycle it responsibly to promote the sustainable reuse of material resources. To return your used device, please use the return and collection systems or contact the retailer where the product was purchased. They can take this product for environmental safe recycling.



# FURRION®

Furrion, LLC (Furrion) are wholly owned subsidiaries of Lippert Components, Inc. (Lippert)  
Furrion, LLC (Furrion) sont des filiales en propriété exclusive de Lippert Components, Inc. (Lippert)  
Furrion, LLC: 52567 Independence Ct., Elkhart, IN, 46514

Furrion Innovation Center & Institute of Technology  
Centre d'innovation et institut de technologie Furrion  
22244 Innovation Drive, Elkhart, IN 46514-5514, USA  
Toll free/Numéro gratuit/Línea telefónica gratuita: 1-800-789-3341  
Email/Courriel/Correo electrónico: [customerservice@lci1.com](mailto:customerservice@lci1.com)

©2007-2025 Furrion, LLC. All rights reserved.

©2007-2025 Furrion, LLC. Tous droits réservés.

For Patent Info: [www.Lippert.com/patents](http://www.Lippert.com/patents)

Pour des informations sur les brevets: [www.Lippert.com/patents](http://www.Lippert.com/patents)

[SUPPORT.LCI1.COM/FURRION](http://SUPPORT.LCI1.COM/FURRION)



The contents of this manual are proprietary and copyright protected by Lippert. Lippert prohibits the copying or dissemination of portions of this manual unless prior written consent from an authorized Lippert representative has been provided.

Any unauthorized use shall void any applicable warranty.

The information contained in this manual is subject to change without notice and at the sole discretion of Lippert. Revised editions are available for free download from [lippert.com](http://lippert.com).

Please recycle all obsolete materials.

Les renseignements contenus dans le présent manuel peuvent seulement être distribués sous forme de document complet, à moins de recevoir l'approbation explicite de Lippert Components pour distribuer des parties individuelles. Tous les renseignements contenus dans le présent manuel peuvent être modifiés sans préavis. Les éditions révisées pourront être téléchargées gratuitement sur le site [lci1.com](http://lci1.com). Ces renseignements sont considérés comme étant factuels jusqu'à ce qu'une version révisée les rende désuets.

Veillez recycler tout le matériel désuet.

For all concerns or questions, please contact Lippert.

Communiquer avec Lippert Components si vous avez des questions ou des préoccupations.  
Ph: 432-LIPPERT (432-547-7378) | Web: [lippert.com](http://lippert.com) | Email: [customerservice@lci1.com](mailto:customerservice@lci1.com)