

## 17 CU. FT. 12V REFRIGERATOR, STAINLESS STEEL, FRENCH DOORS

MODEL (LIPPERT PN)

BCD-455WTE-B-04H (2022302290)

---

## TROUBLESHOOTING AND SERVICE MANUAL

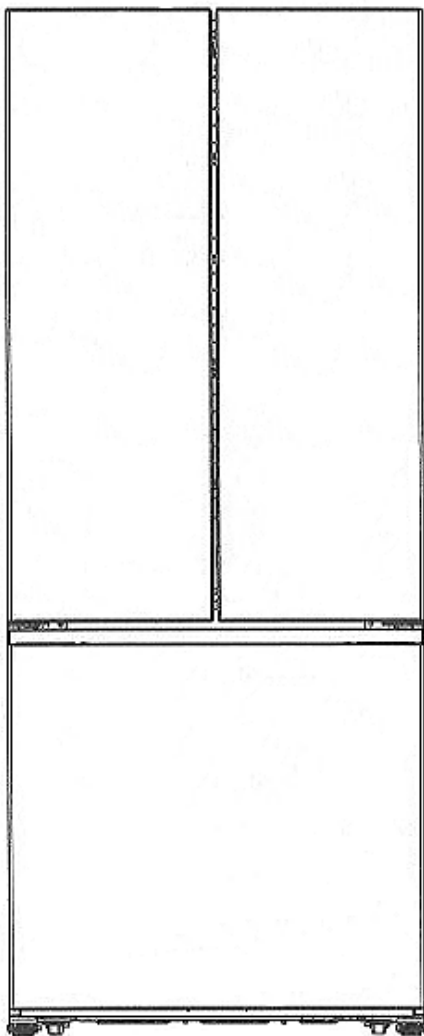

\* Picture shown here is for reference only.

This manual contains the product's basic information, safety, maintenance, replaceable parts, fault diagnosis and basic troubleshooting procedures.

# TABLE OF CONTENTS

<b>Introduction</b> .....	2
<b>Safety</b> .....	2
<b>Important Safety Instructions</b> .....	3
Precautions/Warnings .....	3
Electric Shock Hazard .....	3
<b>Power Source Requirement</b> .....	4
<b>Wire Connection Diagram</b> .....	5
<b>Maintenance and cleaning</b> .....	5
<b>Replaceable Parts List</b> .....	6
<b>Troubleshooting</b> .....	7
<b>Specifications</b> .....	8

## Introduction

This document provides an overview on replaceable parts for Furrion® Everchill 10.7 Cu. ft. 12V Refrigerator, Stainless Steel, French Doors as well as basic troubleshooting and service information.

**NOTE:** Images used in this document are for reference only when assembling, installing and/or operating this product. Actual appearance of provided and/or purchased parts and assemblies may differ. For more detailed operation, including general safety instructions, warnings and cautions, see Instruction Manual at: <https://support.lci1.com/documents/ccd-0009735> or scan this QR code



## Safety

Read and understand all instructions before installing or operating this product. Adhere to all safety labels. This manual provides general instructions. Many variables can change the circumstances of the instructions, i.e., the degree of difficulty, operation and ability of the individual performing the instructions. This manual cannot begin to plot out instructions for every possibility, but provides the general instructions, as necessary, for effectively interfacing with the device, product or system. Failure to correctly follow the provided instructions may result in death, serious personal injury, severe product and/or property damage, including voiding of the Lippert limited warranty.

### **WARNING**

The "WARNING" symbol above is a sign that a procedure has a safety risk involved and may cause death or serious personal injury if not performed safely and within the parameters set forth in this manual.

### **WARNING**

Failure to follow instructions provided in this manual may result in death, serious personal injury and/or severe product and property damage, including voiding of the component warranty.

### **CAUTION**

The "CAUTION" symbol above is a sign that a safety risk is involved and may cause personal injury and/or product or property damage if not safely adhered to and within the parameters set forth in this manual.

## ⚠ CAUTION

Always wear eye protection when performing service, maintenance or installation procedures. Other safety equipment to consider would be hearing protection, gloves and possibly a full face shield, depending on the nature of the task.

### Important Safety Instructions



## ⚠ CAUTION



**TO REDUCE THE RISK OF ELECTRIC SHOCK, DO NOT REMOVE COVER (OR BACK). NO USER-SERVICEABLE PARTS INSIDE. REFER SERVICING TO QUALIFIED SERVICE PERSONNEL.**



This symbol indicates that dangerous voltage constituting a risk of electric shock is present within your refrigerator.



This symbol indicates that there are important operating and maintenance instructions in the literature accompanying your refrigerator.

### Precautions/Warnings

1. Do not use your refrigerator near water.
2. Clean only with a damp cloth.
3. Do not block any ventilation openings. Install in accordance with the manufacturer's instructions.
4. Do not install near any heat sources, such as radiators, heat registers, stoves, or other apparatus (including amplifiers) that produce heat.
5. Refer all servicing to qualified service personnel. Servicing is required when your refrigerator has been damaged in any way, such as liquid has been spilled or objects have fallen into your refrigerator, your refrigerator has been exposed to rain or moisture, does not operate normally, or has been dropped.
6. To reduce the risk of fire or electric shock, do not expose your refrigerator to rain, moisture, dripping, or splashing, and no objects filled with liquids should be placed on top of it.
7. Your refrigerator is not intended for use by persons (including children) with reduced physical, sensory, or mental capabilities, or lack of experience and knowledge, unless they have been given supervision or instruction concerning use of your refrigerator by a person responsible for their safety.
8. Children should be supervised to ensure that they do not play with your refrigerator.

### Electric Shock Hazard



Failure to follow these instructions can result in electric shock, fire, or death.

1. Keep ventilation openings, in both your refrigerator and the built-in structure, clear of obstruction.
2. Do not touch the interior of your refrigerator with wet hands. This could result in frostbite.
3. Do not use mechanical devices or other means to accelerate the defrosting process, other than those recommended by the manufacturer.
4. Do not damage the refrigerant circuit.
5. Do not damage the refrigerant tubing when handling, moving, or using your refrigerator.

6. DANGER-Never allow children to play with, operate, or crawl inside your refrigerator. Risk of child entrapment. Before you throw away your old refrigerator:
  - Take off the door.
  - Leave the shelves in place so that children may not easily climb inside.
7. Do not use electrical appliances inside the food storage compartments of the appliance unless they are of the type recommended by the manufacturer.
8. To avoid a hazard due to instability of the appliance, it must be fixed in accordance with the instructions.
9. Make sure the power source is disconnected on your refrigerator before carrying out user maintenance on it.
10. If a component part is damaged, it must be replaced by the manufacturer, its service agent, or similar qualified persons in order to avoid a hazard.
11. Follow local regulations regarding disposal of your refrigerator due to flammable refrigerant and gas. All refrigeration products contain refrigerants, which under the guidelines of federal law must be removed before disposal. It is the consumer's responsibility to comply with federal and local regulations when disposing of this product.
12. Do not store explosive substances such as aerosol cans with a flammable propellant in this appliance.
13. This appliance is intended to be used in the recreational vehicle.
14. Disposal of your old appliance: By ensuring this product is disposed of correctly, you will help prevent potential negative consequences for the environment and human health, which could otherwise be caused by inappropriate waste handling of this product. For more detailed information, please contact your local city office, your household waste disposal service or the shop where you purchased the product.
15. If the SUPPLY CORD is damaged, it must be replaced by the manufacturer, its service agent or similarly qualified persons in order to avoid a hazard.
16. There is a power switch for the refrigerator. Before any maintenance, please disconnect the switch.

## Power Source Requirement

This appliance is Class III appliances, it must only be supplied at safety extra low voltage. It should have a circuit breaker for full disconnection from the appliance and power supply mains. Before using, the appliance should be disconnected from main power supply, and conduct wiring connections by reference to the wiring diagram.

Do not connect the unit to AC power supply.

1. In order for normal use, the connection must be reliable. Besides the power source proper connection, the wire of the unit and outer wire must meet the following requirement:

Wire Size	The Max Length (Feet)
14 AWG	3.2 Feet
13 AWG	8 Feet
12 AWG	13 Feet
10 AWG	20 Feet
8 AWG	33 Feet
6 AWG	50 Feet
Remarks	14 AWG wire is not recommended. 13 AWG wire or larger is recommended.
	This DC unit is not equipped with a power source. Please purchase a power source from an authorized dealer.

2. When using an adapter or converter AC to DC, No DC power supply is recommended.
3. It is recommended that only authorized or qualified professionals perform repair services on unit.

## Wire Connection Diagram

Fig. 1

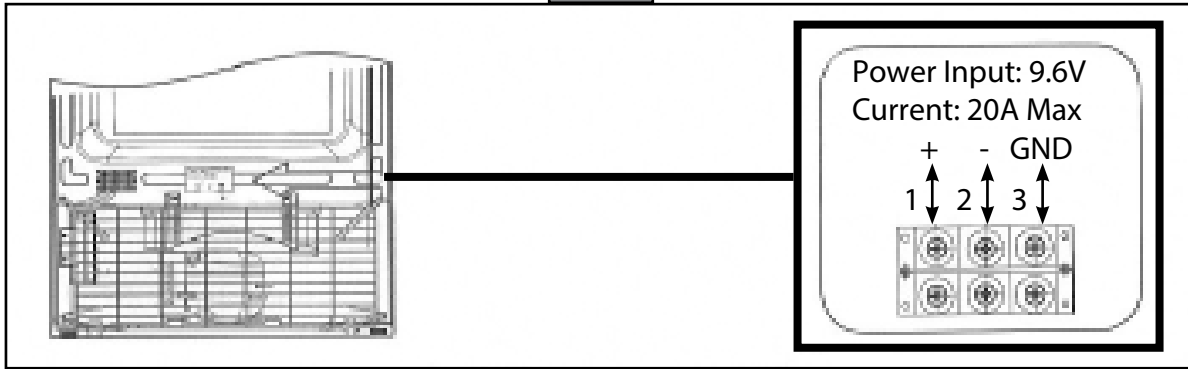

1. Connect 1 terminal with Positive pole of 12V DC (Fig. 1).
2. Connect 2 terminal with Negative pole of 12V DC (Fig. 1).
3. If the unit is installed in an RV, the 3 GND terminal should be connected directly to the RV chassis (Fig. 1).

## Maintenance and cleaning



When cleaning, Do not stretch your hands into the bottom of the refrigerator, since you might be scratched by sharp metal corners.

- Clear off the dusts accumulated on the rear panel and side plates of the refrigerator often.
- After using detergent, be sure to rinse it with clean water, and then wipe it dry.
- Do not use bristle brush, steel wire brush, detergent, soap powder, alkaline detergent, benzene, gasoline, acid, hot water and other corrosive or soluble items to cleanse the cabinet surface, door gasket, plastic decorative parts, etc., so as to avoid damage.
- Carefully wipe dry the door gasket, clean the groove. After the cleaning, fix the four corners of the door gasket first, and then embed it segment by segment into the door groove.
- Take care of the frozen foods in the event of an extended non-running of the refrigerating appliance (such as interruption of power supply or failure of the refrigerating system).
- Try to open the refrigerator door as least as possible, this way food can safely and freshly be kept for hours even in hot summer.

## Replaceable Parts List

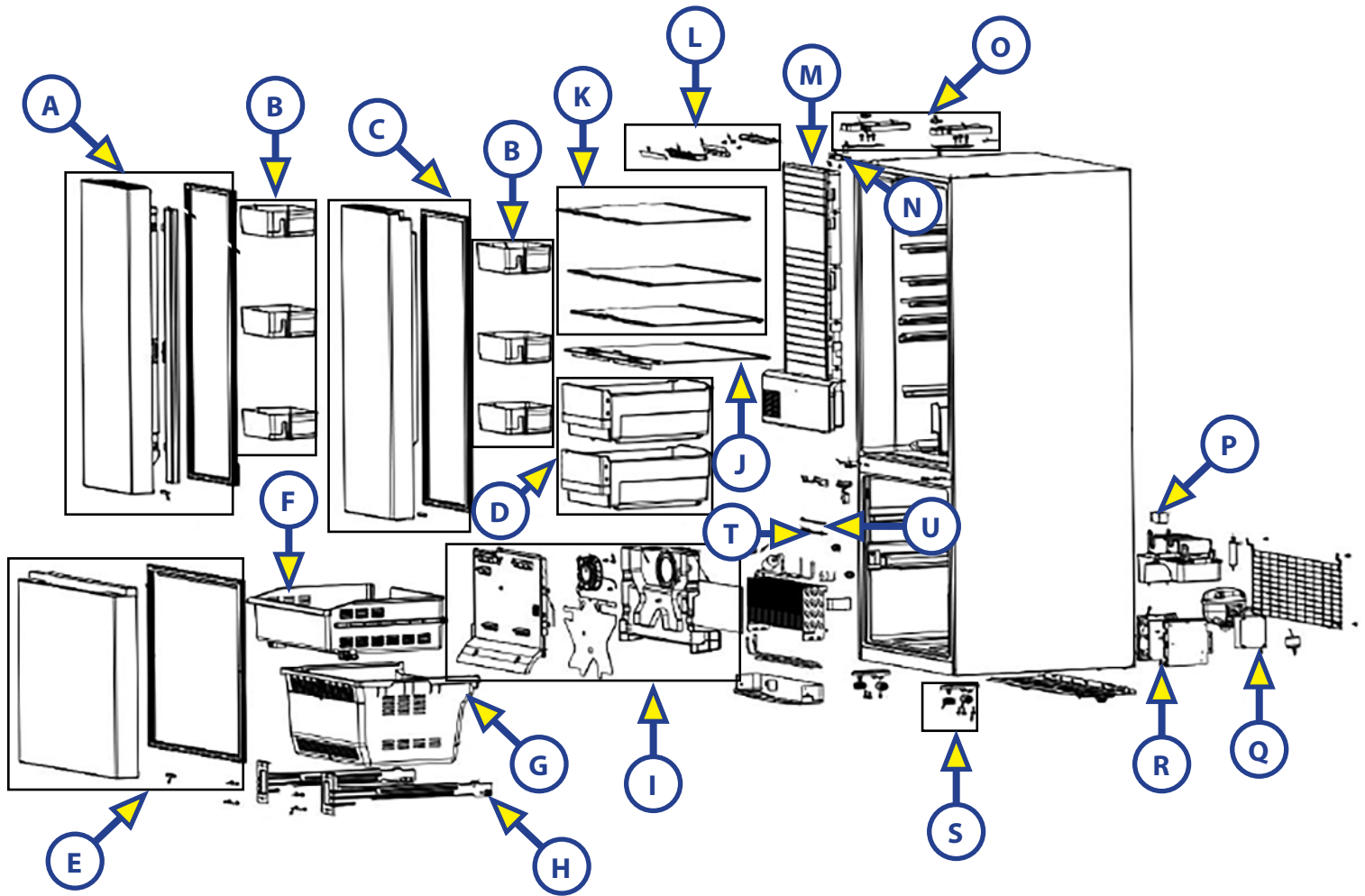

Callout	Part #	Description	Model
A	<a href="#">2022302275</a>	Refrigerator Door Assembly, LHH	BCD-455WTE-B-04H
B	2022451393	Door Shelf Compartment	BCD-455WTE-B-04H
C	<a href="#">2022302276</a>	Refrigerator Door Assembly, RHH	BCD-455WTE-B-04H
D	2023001005	Crisper Drawer	BCD-455WTE-B-04H
E	<a href="#">2022302084</a>	Freezer Door Assembly	BCD-455WTE-B-04H
F	2023001001	Freezer Drawer Upper	BCD-455WTE-B-04H
G	2023001002	Freezer Drawer Lower	BCD-455WTE-B-04H
H	2023004457	Drawer Rail	BCD-455WTE-B-04H
I	<a href="#">2023020659</a>	Freezer Fan Assembly	BCD-455WTE-B-04H
J	2023001004	Crisper Drawer Glass Shelf	BCD-455WTE-B-04H
K	2023001003	Glass Shelf	BCD-455WTE-B-04H
L	<a href="#">2023020660</a>	Control Panel Assembly	BCD-455WTE-B-04H
M	2023004467	Refrigerator Air Duct Component	BCD-455WTE-B-04H
N	2023004469	Guider French	BCD-455WTE-B-04H
O	2023020661	Refrigerator Hinge Kit	BCD-455WTE-B-04H
P	2022455250	Terminal Block	BCD-455WTE-B-04H
Q	2022455251	Compressor Board	BCD-455WTE-B-04H
R	<a href="#">2022451391</a>	Circuit Board	BCD-455WTE-B-04H
S	2023020662	Foot Adjuster Assembly	BCD-455WTE-B-04H

Callout	Part #	Description	Model
T	2023004474	Light Cover Bracket	BCD-455WTE-B-04H
U	2023004475	LED Light	BCD-455WTE-B-04H

## Troubleshooting

Problem	Possible Causes
Refrigerator does not operate	Refrigerator is unplugged.
	The circuit breaker is tripped/fuse blown.
Compressor turns on and off	The room temperature is warmer than normal.
	Door is left open or is frequently opened.
	The refrigerator does not have the correct clearances.
	The refrigerator has recently been disconnected for a period of time.
Refrigerator compartments are too warm	Temperature control is not set correctly.
	Door is left open or is frequently opened.
	The door gasket does not seal properly.
	A large amount of warm or hot food was stored recently. Wait for the refrigerator to reach its selected temperature.
	The refrigerator has recently been disconnected for a period of time.
Vibrating or rattling (slight vibration is normal)	Leveling legs need adjusting.
	Refrigerator is placed on an uneven or weak surface.
	The refrigerator is touching the wall. Re-level the refrigerator and move it away from the wall.
Temperature of external refrigerator surface is warm	The exterior refrigerator walls can be as much as 30°F (-1.1C) warmer than room temperature.
	This is normal while the compressor works to transfer heat from inside the refrigerator cabinet.
Moisture collects inside the refrigerator	Door is left open or is frequently opened.
Moisture forms on outside of refrigerator	Is normal in hot and humid weather. Air carries moisture into the refrigerator when doors are opened.
Bubbling or gurgling sounds (like boiling water)	This is the normal sound of refrigerant (used to cool refrigerator) circulating throughout the system.
Popping or cracking sounds when compressor comes on	This is normal. Metal parts undergo expansion and contraction, like hot water pipes. The sound will level off or disappear as refrigerator runs.
The door will not close properly	The refrigerator is not on a level surface.
	The gasket is dirty.
	The storage basket is out of position.

**NOTE:** If the above descriptions are inapplicable to troubleshooting, do not disassemble and repair it yourself. Repairs carried out by inexperienced persons may cause injury or serious malfunctioning.

This product should be serviced by a qualified technician and only genuine spare parts should be used.

## Specifications

Total Volume	16 Cu.Ft. (453)
Refrigerant	R600a
Refrigerant Amount	2.3oz.
Rated Voltage	DC 12V
Rated Current	14.5A
LED Lamp Power	1W
Defrost Power	120W
Net Weight	187 lb. (85kg)

[This page is intentionally left blank]



# FURRION®

Furrion, LLC (Furrion) are wholly owned subsidiaries of Lippert Components, Inc. (Lippert)  
Furrion, LLC (Furrion) sont des filiales en propriété exclusive de Lippert Components, Inc. (Lippert)  
Furrion, LLC: 52567 Independence Ct., Elkhart, IN, 46514

Furrion Innovation Center & Institute of Technology  
Centre d'innovation et institut de technologie Furrion  
22244 Innovation Drive, Elkhart, IN 46514-5514, USA  
Toll free/Numéro gratuit/Línea telefónica gratuita: 1-800-789-3341  
Email/Courriel/Correo electrónico: customerservice@lci1.com

©2007-2025 Furrion, LLC. All rights reserved.  
©2007-2025 Furrion, LLC. Tous droits réservés.

For Patent Info: [www.Lippert.com/patents](http://www.Lippert.com/patents)  
Pour des informations sur les brevets: [www.Lippert.com/patents](http://www.Lippert.com/patents)

[SUPPORT.LCI1.COM/FURRION](http://SUPPORT.LCI1.COM/FURRION)



The contents of this manual are proprietary and copyright protected by Lippert. Lippert prohibits the copying or dissemination of portions of this manual unless prior written consent from an authorized Lippert representative has been provided. Any unauthorized use shall void any applicable warranty. The information contained in this manual is subject to change without notice and at the sole discretion of Lippert. Revised editions are available for free download from [lippert.com](http://lippert.com).

Please recycle all obsolete materials.

Les renseignements contenus dans le présent manuel peuvent seulement être distribués sous forme de document complet, à moins de recevoir l'approbation explicite de Lippert Components pour distribuer des parties individuelles. Tous les renseignements contenus dans le présent manuel peuvent être modifiés sans préavis. Les éditions révisées pourront être téléchargées gratuitement sur le site [lci1.com](http://lci1.com). Ces renseignements sont considérés comme étant factuels jusqu'à ce qu'une version révisée les rende désuets.

Veuillez recycler tout le matériel désuet.

For all concerns or questions, please contact Lippert.  
Communiquer avec Lippert Components si vous avez des questions ou des préoccupations.  
Ph: 432-LIPPERT (432-547-7378) | Web: [lippert.com](http://lippert.com) | Email: [customerservice@lci1.com](mailto:customerservice@lci1.com)