

---

# greenworks

14" 10A ELECTRIC DETHATCHER  
2500600G(2517102)

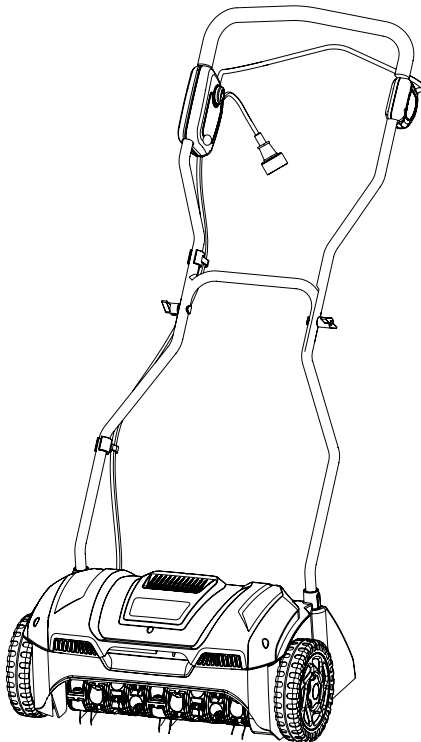

Owner's Manual

**TOLL-FREE HELPLINE: 1-888-90WORKS** (888.909.6757)

---

**⚠** Read and follow all safety rules and operating instructions before using this product.

# CONTENTS

---

|                                     |    |
|-------------------------------------|----|
| Contents .....                      | 2  |
| Specifications .....                | 2  |
| Important Safety Instructions.....  | 3  |
| Specific Safety Rules.....          | 5  |
| Symbols.....                        | 6  |
| Electrical.....                     | 8  |
| Know Your Electric Dethatcher ..... | 10 |
| Assembly .....                      | 11 |
| Operation.....                      | 14 |
| Maintenance .....                   | 16 |
| Troubleshooting .....               | 20 |
| Warranty .....                      | 21 |
| Exploded View.....                  | 22 |
| Parts List.....                     | 23 |

# SPECIFICATIONS

---

## 14" 10A ELECTRIC DETHATCHER

|                        |                                |
|------------------------|--------------------------------|
| Motor .....            | 120 V, AC only, 60 Hz, 10 Amps |
| Speed.....             | 3,500 RPM                      |
| Dethatching Path ..... | 14" (36 cm)                    |
| Unit Weight.....       | 23 lb 12 oz (10.8 kg)          |
| Dethatching depth..... | 3/8" (1 cm)                    |
| Wheel size.....        | 7" (17.8 cm)                   |



# IMPORTANT SAFETY INSTRUCTIONS

---

---

## **WARNING**

**READ ALL SAFETY WARNINGS AND ALL INSTRUCTIONS.** WHEN USING ELECTRIC GARDENING APPLIANCES, BASIC SAFETY PRECAUTIONS SHOULD ALWAYS BE FOLLOWED TO REDUCE THE RISK OF FIRE, ELECTRIC SHOCK, AND PERSONAL INJURY, INCLUDING THE FOLLOWING:

---

---

## **WARNING**

TO AVOID MISTAKES THAT COULD CAUSE SERIOUS INJURY, DO NOT PLUG IN THE DETHATCHER UNTIL THE FOLLOWING STEPS HAVE BEEN READ THOROUGHLY.

---

- READ and become familiar with this entire instruction manual. LEARN the tool's applications, limitations, and possible hazards.
- AVOID DANGEROUS CONDITIONS. DO NOT use in wet or damp areas or expose to rain.
- DO NOT use in the presence of flammable liquids or gases.
- KEEP BYSTANDERS AT A SAFE DISTANCE. NEVER allow children near the tool.
- DRESS FOR SAFETY. DO NOT wear loose clothing, gloves, neckties, or jewellery (rings, watches, etc.) when operating tool. Loose clothing can get caught and pull you into moving parts.
- Use Safety Glasses – Always use face or dust mask if operation is dusty.
- When servicing use only identical replacement parts.
- ALWAYS remove the power cord plug from the electric outlet when making adjustments, changing parts, or cleaning.
- Avoid Unintentional Starting – Don't carry plugged-in appliance with finger on switch. Be sure switch is off when plugging in.
- DO NOT abuse the power cord. Do not use it to carry the tool. Keep cord away from heat, oil, sharp edges, or moving parts. Replace damaged cords immediately; they may create a shock or fire hazard.
- NEVER LEAVE A RUNNING TOOL UNATTENDED. Turn the power switch to OFF. Do not leave the tool until it has come to a complete stop.
- DO NOT OVERREACH. Keep proper footing and balance at all times.
- DISCONNECT TOOLS. Disconnect tools from their power supplies when not in use, prior to servicing and when changing accessories such as blades, etc.
- Keep all safety devices in place.
- Know locations and functions of all controls. When using electric gardening appliances, basic safety precautions should always be followed to reduce the risk of fire, electric shock, and personal injury, including the following:
- Dress Properly. Do not wear loose clothing or jewellery that can get caught in moving parts. The wearing of protective gloves and safety footwear is recommended. Wear protective hair covering to contain long hair.
- Ground Fault Circuit Interrupter (GFCI) protection should be provided on the circuit(s) or outlet(s) that will be used. Outlets with built-in GFCI protection are available, and may be used as an added safety measure.

---

**SAVE THESE INSTRUCTIONS**

---

# IMPORTANT SAFETY INSTRUCTIONS

---

- Check Damaged Parts – Before further use of the appliance, a guard or other part that is damaged should be carefully checked to determine that it will operate properly and perform its intended function. Check for alignment of moving parts, binding of moving parts, breakage of parts, mounting, and any other condition that may affect its operation. A guard or other part that is damaged should be properly repaired or replaced by an authorized service center unless indicated elsewhere in this manual. MAINTAIN TOOLS PROPERLY. ALWAYS keep tools clean and in good working order.
- MAINTAIN TOOLS PROPERLY. ALWAYS keep tools clean and in good working order.
- CHECK FOR DAMAGED PARTS. Check for proper alignment of moving parts, binding, breakage, or any other conditions that may affect the tool's operation. Any part that is damaged should be properly repaired or replaced before use.
- KEEP CLEAN AND FREE OF OIL OR GREASE. Always use only a clean cloth when cleaning. Do not use solvents, brake fluids, gasoline, or other petroleum products to clean the tool, as they may damage plastic parts.
- Warning : To reduce the risk of electric shock, use only with an extension cord intended for outdoor use, such as an extension cord of cord type SW-A, SOW-A, STW-A, STOW-A, SJW-A, SJOW-A, SJTW-A. or SJTOW-A.
- Do not force appliance. It will do the job better and with less likelihood of injury at the rate for which it was designed.
- Stay Alert. Watch what you are doing. Use common sense. Do not operate appliance when you are tired.
- Store Idle Appliances Indoors: When not in use, appliances should be stored indoors in a dry and high locked-up place out of reach of children.
- Maintain Appliance With Care. Keep cutting edge sharp and clean for best performance and to reduce the risk of injury. Follow instructions for lubricating and changing accessories. Inspect appliance cord periodically, and if damaged, have it repaired by an authorized service facility. Inspect extension cords periodically and replace if damaged. Keep handles dry, clean, and free from oil and grease.
- To reduce the risk of electric shock, this appliance has a polarized plug (one blade is wider than the other) and will require the use of a polarized extension cord. The appliance plug will fit into a polarized extension cord only one way. If the plug does not fit fully into the extension cord, reverse the plug. If the plug still does not fit, obtain a correct polarized extension cord. A polarized extension cord will require the use of a polarized wall outlet. This plug will fit into the polarized wall outlet only one way. If the plug does not fit fully into the wall outlet, reverse the plug. If the plug still does not fit, contact a qualified electrician to install the proper wall outlet. Do not change the equipment plug, extension cord receptacle, or extension cord plug in any way.

---

## WARNING

ONLY USE IDENTICAL REPLACEMENT PARTS WHEN SERVICING. TOLL-FREE HELPLINE: at 1-888-909-6757 (1-888-90WORKS).

---

**SAVE THESE INSTRUCTIONS**

---

## SPECIFIC SAFETY RULES

---

- Do not use the dethatcher in the rain or in moist, wet conditions.
- Do not work close to the edge of swimming pools or garden ponds.
- Please observe any local noise restrictions.
- Always wear eye protection.
- Wear a dust mask. Soil mixed with fertilizers may cause harmful chemicals to be inhaled.
- Wear hearing protection.
- Ensure that people and pets are at least 100' (30 m) away from dethatcher while in use.
- Replace worn or damaged parts only with identical replacement parts.
- Ensure that your work area is free of slippery spots or excessive quantities of stones.
- Do not dethatch on slopes greater than 15°.

---

### **W A R N I N G**

**ALWAYS WEAR EYE PROTECTION.** This tool can eject foreign objects into your eyes, posing the risk of permanent eye damage. Always wear safety goggles (not glasses). Ordinary eyeglasses have only impact-resistant lenses—they are not safety goggles.

---











**SAVE THESE INSTRUCTIONS**

---

# SYMBOLS

---



Some of the following symbols may be used on this product. Please study them and learn their meaning. Proper interpretation of these symbols will allow you to operate the product better and safer.

| SYMBOL  | NAME                       | DESIGNATION/EXPLANATION   |
|---|----------------------------|---|
| V   | Volts                      | Voltage   |
| A   | Amperes                    | Current   |
| Hz  | Hertz                      | Frequency (cycles per second)   |
| W   | Watts                      | Power   |
| min   | Minutes                    | Time  |
|    | Alternating Current        | Type of current.  |
|    | Direct Current             | Type or a characteristic of current.  |
| $n_0$   | No Load Speed              | Rational speed, without a load.   |
|    | Class II Construction      | Double-insulated construction.  |
| /min  | Per Minute                 | Revolutions, strokes, surface speed, orbits etc. per minute.  |
|    | Wet Conditions Alert       | Do not expose to rain or use in damp locations.   |
|    | Read the Operator's Manual | To reduce the risk of injury, users must read and understand the Operator's Manual before using this product. |
|    | Eye Protection             | Wear eye protection when operating this equipment.  |
|    | Ricochet                   | Thrown objects can ricochet and result in personal injury or property damage.                                 |
|   | Rotating tines             | Danger – Keep hands and feet away from rotating tines. Rotating tines can cause severe injury.                |
|  | Operating on a slope       | Do not dethatch a slope that has an angle greater than 15°.   |
|  | Keep Bystanders Away       | Keep all bystanders at least 100' (30 m) away.  |

# SYMBOLS

---

The following signal words and meanings are intended to explain the levels of risk associated with this product.

| SYMBOL  | SIGNAL         | MEANING  |
|---|----------------|--|
|  | <b>DANGER</b>  | Indicates an imminently hazardous situation, which, if not avoided, will result in death or serious injury.  |
|  | <b>WARNING</b> | Indicates a potentially hazardous situation, which, if not avoided, could result in death or serious injury. |
|  | <b>CAUTION</b> | Indicates a potentially hazardous situation, which, if not avoided, may result in minor or moderate injury.  |
|   | <b>CAUTION</b> | (Without Safety Alert Symbol) Indicates a situation that may result in property damage.                      |

## SERVICE

Servicing requires extreme care and knowledge and should be performed only by a qualified service technician. For service we suggest you return the product to your nearest **AUTHORIZED SERVICE CENTER** for repair. When servicing, use only identical replacement parts.

---

### **W A R N I N G**

To avoid serious personal injury, do not attempt to use this product until you read thoroughly and understand completely the operator's manual. If you do not understand the warnings and instructions in the operator's manual, do not use this product. Call GREENWORKS customer service for assistance.

---

---

### **W A R N I N G**



The operation of any power tool can result in foreign objects being thrown into your eyes, which can result in severe eye damage. Before beginning power tool operation, always wear safety goggles or safety glasses with side shields and, when needed, a full face shield. We recommend Wide Vision Safety Mask for use over eyeglasses or standard safety glasses with side shields. Always use eye protection which is marked to comply with ANSI Z87.1.

---

# ELECTRICAL

---

## DOUBLE INSULATED

This dethatcher has a plug that looks like the one shown below. (See Figure 1)

The dethatcher is double insulated to provide a dual thickness of insulation between you and the tool's electrical system. All exposed metal parts are insulated from the internal motor components using protective insulation.

**DO NOT MODIFY THE PLUG PROVIDED.** If it will not fit the outlet, have the proper outlet installed by a qualified electrician.

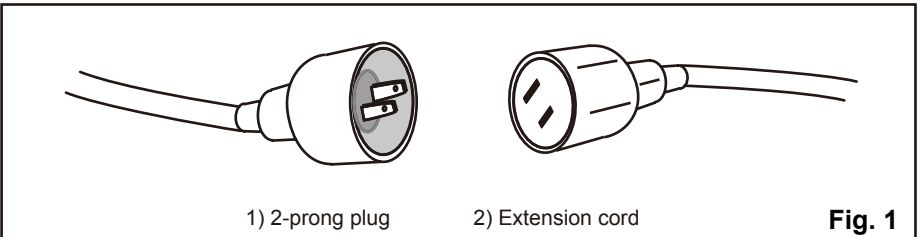

---

### **⚠ WARNING**

Use the proper circuit protection to avoid the risk of electric shock, fire or damage to the tool. The dethatcher is wired at the factory for 120 V operation. Connect to a 120 V, 15 A circuit and use a 15 A time-delayed fuse or circuit breaker. Replace a cut, worn or damaged power cord immediately to avoid shocks or fires.

---

### **⚠ WARNING**

To avoid injury, use only identical replacement parts when servicing the dethatcher. Call our toll-free helpline: 1-888-90WORKS (888.909.6757).

---

### **⚠ WARNING**

Double insulation does not take the place of normal safety precautions when operating this tool.

---

### **⚠ WARNING**

**TO AVOID ELECTRIC SHOCKS:**

1. Use only identical replacement parts when servicing a tool with double insulation. Servicing should be performed by a qualified technician.
  2. Do not use in wet or damp areas or expose to rain.
-

# ELECTRICAL

---

---

## **WARNING**

THIS DETHATCHER IS FOR OUTDOOR USE ONLY. DO NOT EXPOSE TO RAIN OR USE IN DAMP LOCATIONS.

---

## **GUIDELINES FOR USING EXTENSION CORDS**

USE THE PROPER EXTENSION CORD. Make sure your extension cord is in good condition. When using an extension cord, be sure to use one of heavy enough gauge to carry the current your product will draw. An undersized cord will cause overheating. The table below shows the correct size to use depending on cord length and nameplate ampere rating. If in doubt, use the next heavier gauge. The smaller the gauge number, the heavier the cord.

---

### **MINIMUM GAUGE FOR EXTENSION CORDS (AWG)**

(WHEN USING 120V ONLY)

| <b>Amp Rating</b> |                      | <b>Total Length of Cord in Feet (meters)</b> |                   |                      |                      |
|-------------------|----------------------|--|-------------------|----------------------|----------------------|
| <b>More Than</b>  | <b>Not More Than</b> | <b>25' (7.6 m)</b>                           | <b>50' (15 m)</b> | <b>100' (30.4 m)</b> | <b>150' (45.7 m)</b> |
| 0                 | 6                    | 18   | 16                | 16                   | 14                   |
| 6                 | 10                   | 18   | 16                | 14                   | 12                   |
| 10                | 12                   | 16   | 16                | 14                   | 12                   |
| 12                | 16                   | 14   | 12                | Not Recommended      |                      |

Make sure your extension cord is properly wired and in good electrical condition. Always replace a damaged extension cord or have it repaired by a qualified technician before use. Keep extension cords away from sharp objects, excessive heat and damp or wet areas.

Use a separate electrical circuit for tools. This circuit should not be less than #12 wire and should be protected with a 15 A time delayed fuse. Before connecting the motor to the power line, make sure the switch is in the OFF position and the electric current is rated the same as the current stamped on the motor nameplate. Running at a lower voltage will damage the motor.

---

## **WARNING**

Although this tool is double insulated, the extension cord and outlet must still be grounded while in use to protect the operator from electric shocks.

---

# KNOW YOUR DETHATCHER

---

The safe use of this product requires an understanding of the information on the tool and in this operator's manual as well as a knowledge of the project you are attempting. Before use of this product, familiarize yourself with all operating features and safety rules. (See *Figure 2*)

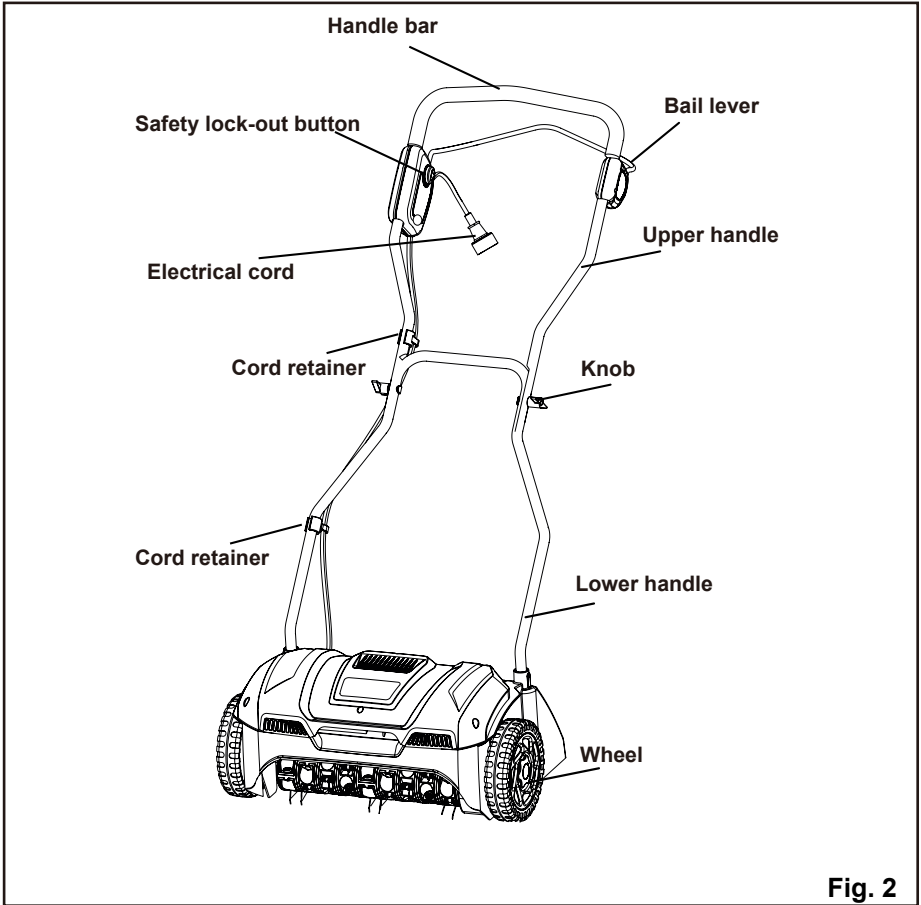







# ASSEMBLY

---

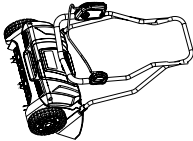
## UNPACKING

- This product requires assembly.
- Carefully remove the product and any accessories from the box. Make sure that all items listed in the packing list are included.
- Inspect the product carefully to make sure no breakage or damage occurred during shipping.
- Do not discard the packing material until you have carefully inspected and satisfactorily operated the product.
- If any parts are damaged or missing, please call **1-888- 909-6757** for assistance.

## PACKING LIST

| Part Name           | Figure   | Qty |
|---------------------|--|-----|
| Dethatcher          |   | 1   |
| Cord retainer       |   | 1   |
| Knob & bolt         |   | 2   |
| Hang for power cord |   | 3   |
| Screws              |   | 2   |
| Operator manual     |  | 1   |

# ASSEMBLY

---

---

## **⚠ WARNING**

Do not attempt to modify this product or create accessories not recommended for use with this product. Any such alteration or modification is misuse, and could result in a hazardous condition leading to possible serious personal injury.

---

---

## **⚠ WARNING**

Disconnect the dethatcher from the power supply until assembly is complete. Failure to comply could result in accidental starting and possible serious personal injury.

---

---

## **⚠ WARNING**

If any parts are damaged or missing, do not operate this product until the parts are replaced. Failure to heed this warning could result in serious personal injury.

---

### **INSTALLING THE LOWER HANDLE** (See Figure 3.1)

- Assemble the cord retainer on to the lower handle before installing the lower handle in to the unit.
- Insert the lower handle into the housing hole.
- Using the supplied screws, fasten the lower handle to the housing using a screwdriver (not supplied).

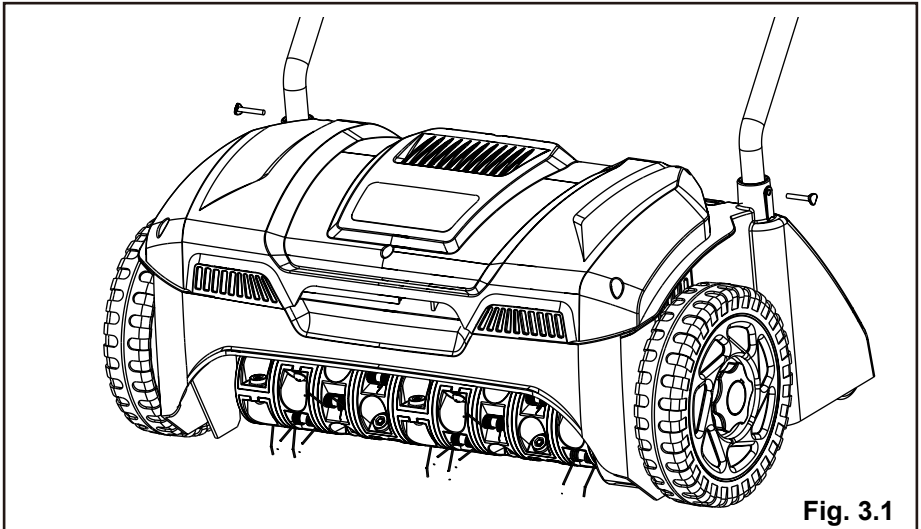

**Fig. 3.1**

# ASSEMBLY

---

## INSTALLING THE UPPER HANDLE (See Figure 3.2)

- Position the upper handle so the holes line up with the lower handle holes.
- Insert the supplied hex bolt through the hole from the outside of the handlebar.
- Thread the knob onto the hex bolt to tighten securely into place.

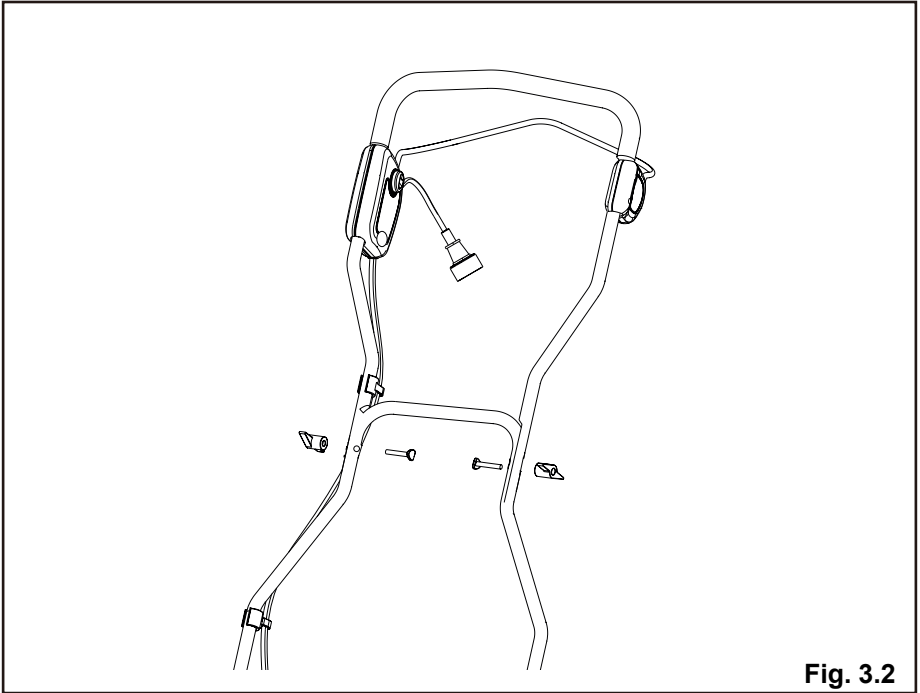

**Fig. 3.2**

# OPERATION

---

## STARTING AND STOPPING THE DETHATCHER *(See Figure 4)*

### STARTING THE DETHATCHER

- Plug the dethatcher into an approved outdoor extension cord.
- Press and hold the safety lock-out button. This makes the bale switch operational.
- Press the bale switch against to the handlebar to operate.

### STOPPING THE DETHATCHER

- Release the bail lever.

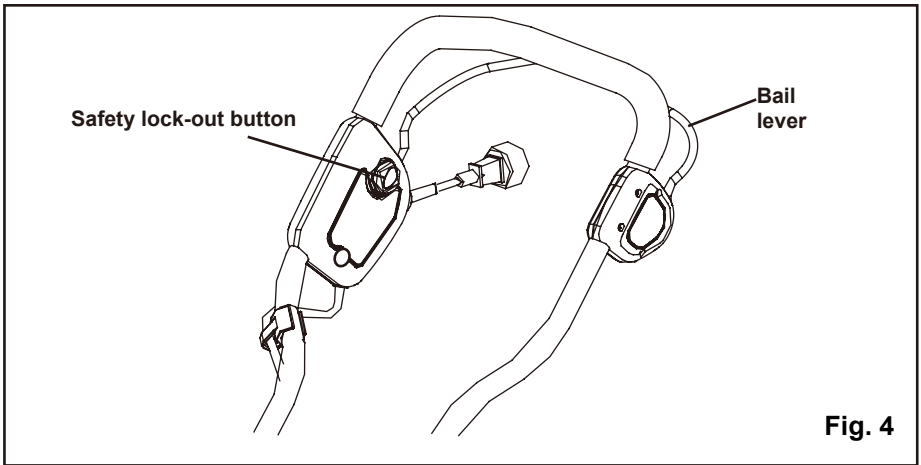

# OPERATION

---

## USING THE CORD RETAINER (See Figure 5)

This dethatcher is equipped with a cord retainer in order to prevent the extension cord from disconnecting from the power cord while the dethatcher is in use. The cord retainer hangs from the cord guide bar.

*NOTE: Do not plug the extension cord into the outlet until it has been connected to the cord retainer and plugged into the dethatcher.*

To use the cord retainer:

- Fold the extension cord in order to form a tight loop near the retainer.
- Push the loop through the bottom hole in the retainer.
- Slide the loop over the retaining clip, and pull it down until the cord is secured.

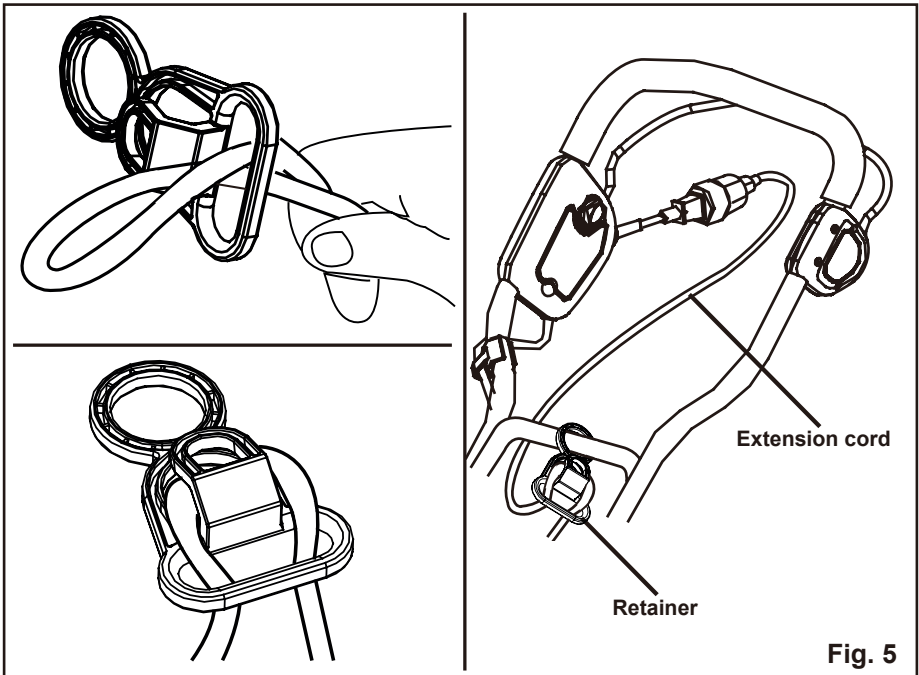

**Fig. 5**

# MAINTENANCE

---

The dethatcher cylinder can cause injuries! Prior to making adjustments, unplug unit and wait until the dethatcher cylinder has stopped. Wear heavy-duty work gloves when making adjustments. If the dethatcher cylinder is not yet worn but individual springs have broken, these must be replaced. Only identical replacement springs may be used.

Toll-free helpline: 1-888- 909-6757.

## REPLACING THE TINES (See Figure 7 - 8.)

- Disconnect dethatcher from the power source. Allow sufficient time for moving parts to totally stop.
- Turn the dethatcher over.
- Remove the two star-shaped screws (1), the flat washer (2) and the lock washer (3) which secure the tine casing. Remove the two nuts on the opposite side with a star-head screwdriver.
- Press the lock (4) on the edge of the shaft with a slotted screwdriver to separate the tine casing from the shaft.
- Replace the worn or broken tines with new ones.
- Fasten the tine casing back together using the flat washer and the lock washer in their original order.

---

## **⚠** WARNING

All the screws to mount the halves of the tine holder must have flat washer (2) and lock washer (3) on their threads to prevent screws from loosening during usage.

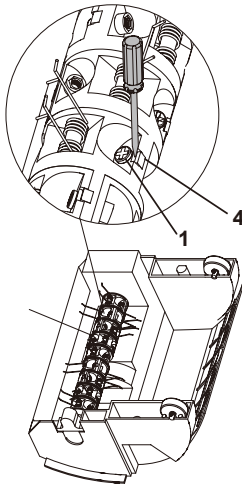

Fig. 7

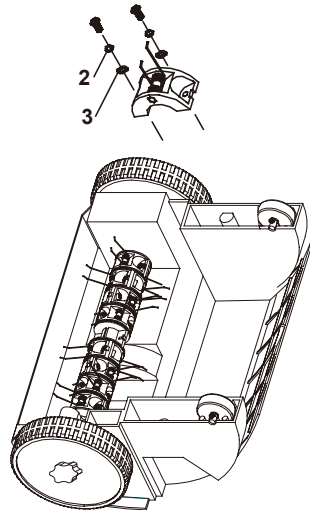

Fig. 8

# MAINTENANCE

---

## REPLACING THE TINES (See Figure 9)

- Remove the tine cartridge as demonstrated on page 16.
- Secure tine cartridge on a workbench.
- Push out the pin using a screwdriver (Not Supplied). This may require the use of a rubber mallet if more strength is required.
- Remove and discard the worn/broken tines.
- Replace the tine into position and slide the pin back into place pressing the pin against a solid surface to pressure it back into place.

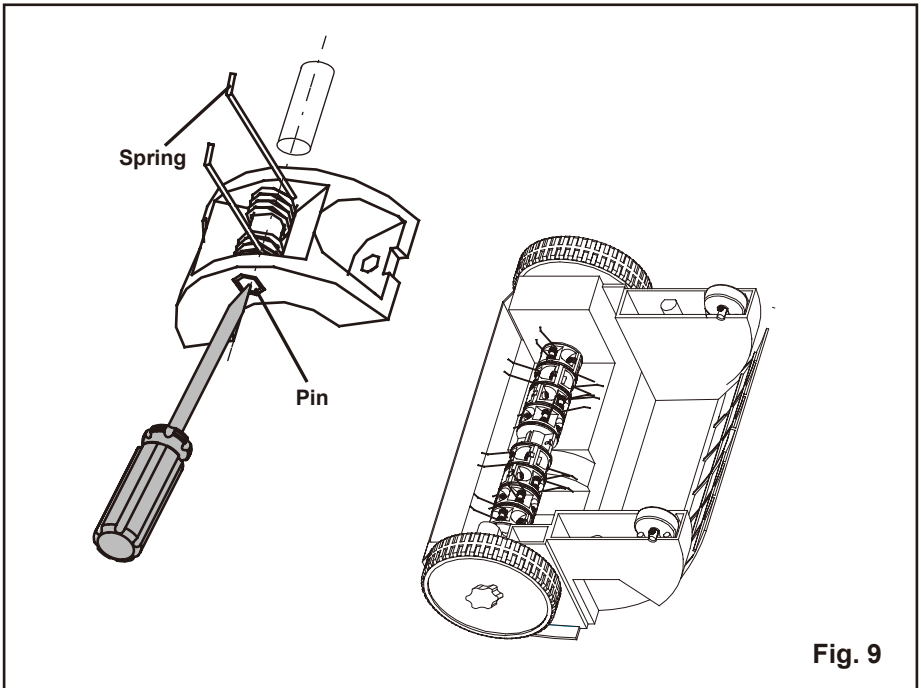

Fig. 9

# MAINTENANCE

---

## **DANGER! THE DETHATCHER CYLINDER CAN CAUSE INJURIES.**

Prior to maintenance, unplug from the power source and wait until the dethatcher cylinder has stopped. Wear heavy-duty gloves for performing maintenance. The lawn dethatcher should be cleaned after each use.

---

### **WARNING**

Always wear safety goggles or safety glasses with side shields during product operation. If operation is dusty, also wear a dust mask.

---

### **WARNING**

Before inspecting, cleaning, or servicing the machine, disconnect the plug from power source and wait for all moving parts to stop. Failure to follow these instructions can result in serious personal injury or property damage.

---

## **GENERAL MAINTENANCE**

Avoid using solvents when cleaning plastic parts. Most plastics are susceptible to damage from various types of commercial solvents and may be damaged by their use. Use clean cloths to remove dirt, dust, oil, grease, etc.

---

### **WARNING**

Do not at any time let brake fluids, gasoline, petroleum-based products, penetrating oils, etc., come in contact with plastic parts. Chemicals can damage, weaken, or destroy plastic which may result in serious personal injury. Only the parts shown on the parts list are intended to be repaired or replaced by the customer. All other parts should be replaced at an authorized service center.

---

# MAINTENANCE

---

## **Risk of injury and physical damage!**

Do not clean the lawn dethatcher under running water (particularly under high pressure).

Do not use hard or pointed objects for cleaning the lawn dethatcher.

To save space, the lawn dethatcher can be folded up for storage by releasing the knobs.

Take care, during this process, that the power cable does not become trapped.

Store the lawn dethatcher in a dry, closed space which children cannot access.

- Switch off the motor, unplug from the power source and wait until the dethatching cylinder stops.
- Always clean the bottom of the dethatcher after each use and before storage.
- Carefully inspect all tines and cartridges for damage and replace when required.

This device must not be disposed of with normal household waste. It must be disposed of in accordance with local regulations.

---

## **D A N G E R**

The dethatcher cylinder can cause injuries.

---

# TROUBLESHOOTING

---

| PROBLEM                                   | POSSIBLE CAUSE   | SOLUTION   |
|---|--|--|
| Abnormal noise.                           | Foreign objects on the dethatcher cylinder are hitting the dethatcher.           | 1. Switch off the dethatcher, remove the power cord from the outlet and wait until the cylinder has stopped rotating.  |
| Clattering in the unit. Whistling sound.  | Foreign objects blocking the dethatching cylinder.                               | 2. Remove foreign objects.<br>3. Check the dethatcher immediately.   |
| Whistling sound.                          | Belt slipping.   | Contact an authorized service center.  |
| Motor will not start.                     | Faulty cable. The conductor cross-section of the extension cable may be too low. | Contact your electrician.  |
| The dethatcher is hard to push.           | Blocked by foreign objects.  | 1. Switch off the motor, remove the plug from the socket and wait until the dethatcher has stopped rotating.<br>2. Remove the foreign objects.<br>3. After approximately one minute, switch on the dethatcher. |
|   | The grass is too tall.   | Mow the lawn before dethatching.   |
| Dethatching results are not satisfactory. | Spring tine wear.  | Adjust the dethatcher cylinder.  |
|   | Belt faulty.   | Contact an authorized service centre.  |
|   | Lawn has grown too tall.   | Mow the lawn before using the dethatcher.  |

# LIMITED THREE-YEAR WARRANTY

---



# greenworks

GREENWORKS hereby warrants this product, to the original purchaser with **proof of purchase**, for a period of three (3) years against defects in materials, parts or workmanship. GREENWORKS, at its own discretion will repair or replace any and all parts found to be defective, through normal use, free of charge to the customer. This warranty is valid only for units which have been used for personal use that have not been hired or rented for industrial/commercial use, and that have been maintained in accordance with the instructions in the owners' manual supplied with the product from new.

## ITEMS NOT COVERED BY WARRANTY:

1. Any part that has become inoperative due to misuse, commercial use, abuse, neglect, accident, improper maintenance, or alteration; or
2. The unit, if it has not been operated and/or maintained in accordance with the owner's manual; or
3. Normal wear, except as noted below;
4. Routine maintenance items such as lubricants, tines;
5. Normal deterioration of the exterior finish due to use or exposure.

## GREENWORKS HELPLINE (1-888-90WORKS):

Warranty service is available by calling our toll-free helpline, 9 a.m. to 5 p.m. EST. Monday – Friday at **1-888-909-6757 (1-888-90WORKS)**.

## TRANSPORTATION CHARGES:

Transportation charges for the movement of any power equipment unit or attachment are the responsibility of the purchaser. It is the purchaser's responsibility to pay transportation charges for any part submitted for replacement under this warranty unless such return is requested in writing by GREENWORKS.

# EXPLODED VIEW

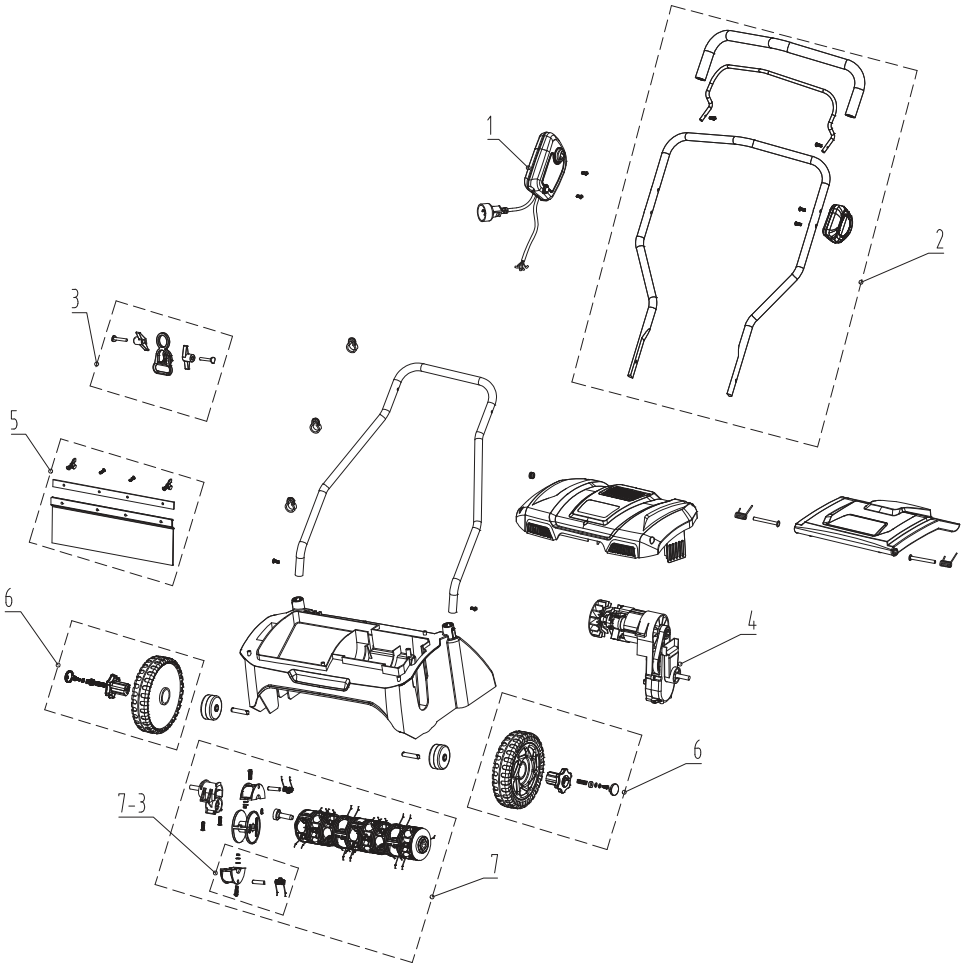

# PARTS LIST

---

| <b>ITEM NO.</b> | <b>PART NO.</b> | <b>DESCRIPTION</b>      | <b>QTY</b> |
|-----------------|-----------------|-------------------------|------------|
| 1               | R0201765-00     | Switch box assembly     | 1          |
| 2               | R0201766-00     | Upper handle assembly   | 1          |
| 3               | R0201758-00     | Wire hung-up assembly   | 1          |
| 4               | R0201771-00     | Motor gear box assembly | 1          |
| 5               | R0201760-00     | Rear Flap Assembly      | 1          |
| 6               | R0201762-00     | Wheel assembly          | 2          |
| 7               | R0201763-00     | Steel tine assembly     | 1          |
| 7.3             | R0201764-00     | Tine                    | 1          |

# greenworks

Greenworks Tools  
P.O. Box 1238  
Mooresville, NC 28115

Greenworks Tools Canada Inc.  
1110 Stellar Drive Unit 102  
Newmarket, ON, L3Y 7B7

**TOLL-FREE HELPLINE: 1-888-90WORKS (888.909.6757)**