

2 IN 1 CORDLESS STICK VACUUM CLEANER

VCH 9130



FOR A GOOD REASON

GRUNDIG



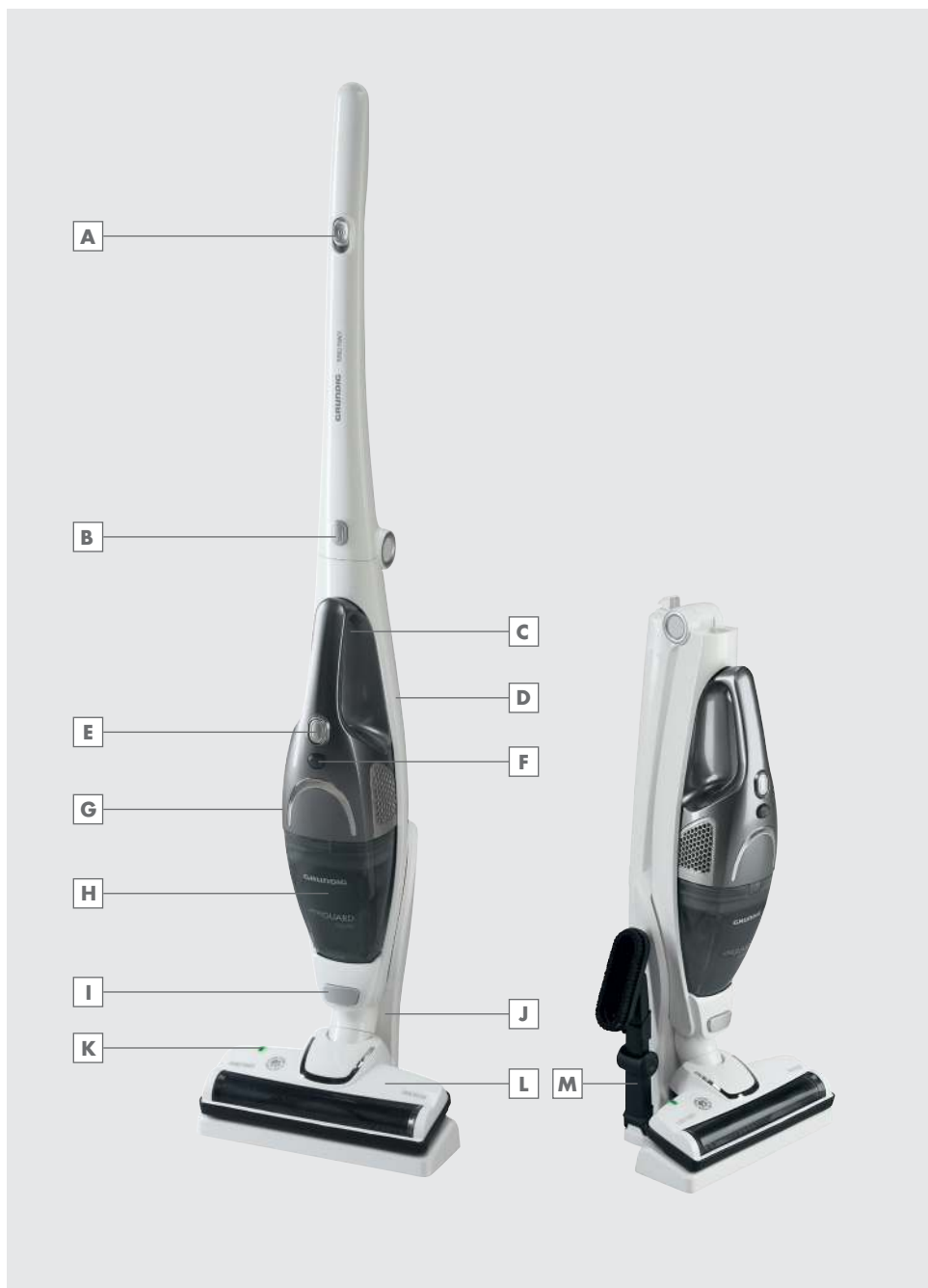

SAFETY

Please read this instruction manual thoroughly prior to using this appliance! Follow all safety instructions in order to avoid damages due to improper use!

Keep the instruction manual for future reference. Should this appliance be given to a third party, then this instruction manual must also be handed over.

- Always keep hair, clothing and any other utensils away from the appliance during operation in order to prevent injury and damages.
- The appliance is designed for domestic use only. Warranty will be voided if the appliance is used for industrial or commercial purposes.
- Observe these instructions in order to prevent damage to the appliance or danger arising from improper use.
- Do not use on wet surfaces and do not attempt to use on wet objects.
- Do not use the appliance in wet surroundings.
- Do not use the appliance with wet hands.
- This appliance is designed for vacuuming dirt and dust particles. Do not attempt to use it on large objects which could block and damage the appliance.
- Do not use to clean cigarette stubs, ash from a fireplace or matches. This could cause a fire.
- This appliance is not designed for cleaning people or animals.
- Do not insert any foreign objects into the suction intake. Always keep the suction intake free of all objects.
- Never operate the appliance without the filter.
- Clean the filter when necessary.
- Only use original GRUNDIG accessories when replacing parts.
- Check if the mains voltage on the rating label corresponds to your local mains supply.
- Always pull out the power cord after the charging process, before cleaning or carrying out any maintenance on the appliance or the charging unit.
- Avoid using extension cables or multipoint connectors. Plug the appliance directly in a wall socket if possible.
- For additional protection, this appliance should be connected to a household residual current device with a maximum rating of 30 mA. Consult your electrician for advice.
- Do not disconnect the plug by pulling on the cable.
- Never use the appliance if it or the power cord is visibly damaged. This also applies if the appliance has accidentally become wet. Please contact a service centre in this case.
- Our GRUNDIG Household Appliances meet all applicable safety standards; thus if the appliance or the power cord is damaged, it must be replaced by the dealer, a service centre or a similarly qualified and authorised service person to avoid any danger arising. Faulty or unqualified repair work may cause danger and risk to the user.
- Keep the appliance away from children.
- The appliance should not be used by the following persons, including children: those with limited physical, sensory or mental capabilities or those with a lack of experience and knowledge. This does not apply to the latter if they were instructed in the use of the appliance or if they use it under the supervision of a person responsible for their safety. Children should always be supervised to ensure that they do not play with the appliance.
- Do not dismantle the appliance under any circumstances. No warranty claims are accepted for damage resulting from improper handling.
- Do not use the appliance if the air duct and the ventilation slot are blocked. Always keep the air duct and ventilation slot free of dirt, hair and any other elements which could obstruct or block the air flow.
- Only use the LKC-173030-G power supply unit provided.

OVERVIEW

Dear customer,

Congratulations on the purchase of your new GRUNDIG 2 in 1 Cordless Stick Vacuum Cleaner VCH 9130.

Please read the following user notes carefully to ensure you can enjoy your quality product from Grundig for many years to come.

A responsible approach!



GRUNDIG focuses on contractually agreed social working conditions with fair wages for both internal employees and suppliers, as well as on the efficient use of raw materials with continual

waste reduction of several tonnes of plastic each year – and availability of at least 5 years for all accessories.

For a future worth living.
For a good reason. Grundig.

HEPA filter

HEPA stands for Highly Efficient Particulate Air. HEPA filters are highly efficient particulate air filters which trap over 99.9% of all airborne dust particles larger than 0.1 to 0.3 micrometres. Viruses, respirable dust, dust mite larvae and deposits, pollen, smoke particles, asbestos, bacteria various toxic dust and aerosols are trapped in the filter.

Special features

- Versatile usage: as a cordless handheld vacuum cleaner to clean working tops or furniture or as a beautifully designed cordless stick vacuum cleaner with electric brush
- Powerful 14.4 V NiMH batteries for a long and efficient service life
- High-performance electric brush for removing stubborn dirt and pet hair on any surface
- Efficient filter system with cyclone technology
- Up to 15 minutes cordless operation
- 8 hours charging time
- Holds up to 500 ml dry dirt
- Space-saving storage thanks to fold-down handle and attachment storage at charging station
- Simple and hygienic emptying of the container

Additional accessories:

- Washable HEPA-filter
- Crevice tool for cleaning crevices and corners difficult to reach
- Upholstery nozzle with brush attachment for fabrics, furniture, skirting boards or picture frames
- Charging station with attachment storage
- Power adaptor

Controls and individual parts

See the illustration on page 3.

- A** On/Off button for the cordless stick vacuum cleaner
 - B** Button for folding down the handle
 - C** Button for removing the handheld vacuum cleaner
 - D** Body
 - E** On/Off button for the handheld vacuum cleaner
 - F** Button for opening the dust container / power indicator
 - G** Handheld vacuum cleaner
 - H** Dust container
 - I** Button for removal of high-performance electric brush
 - J** Charging unit
 - K** Power indicator
 - L** High-performance electric brush
 - M** 3 in 1 nozzle and brush attachment
- Power adaptor

INDIVIDUAL PARTS

3 in 1 nozzle and brush attachment

The accessories include a 3 in 1 nozzle and brush attachment.

The brush attachment can be attached onto the upholstery nozzle to clean textile surfaces, furniture, baseboards and picture frames.

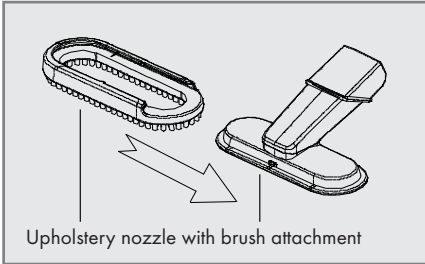

You can use the crevice tool to clean crevices and corners difficult to reach or attach the upholstery nozzle onto the crevice tool to extend it.

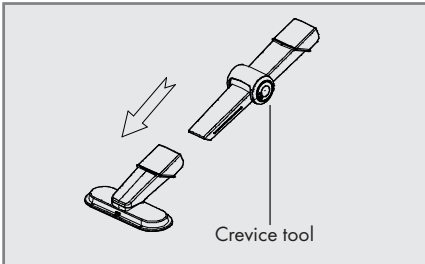

Placing the 3 in 1 nozzle and brush attachment **M** on the holder will prevent it from getting lost.

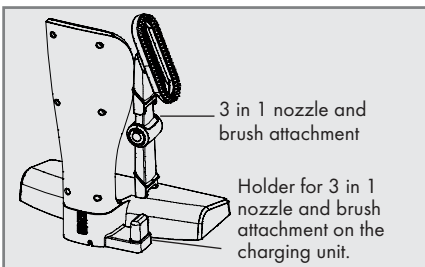

The Upholstery nozzle or the crevice tool can be attached to the handheld vacuum cleaner **G**. The tip of the crevice tool can be set in 3 different positions: top, middle and bottom.

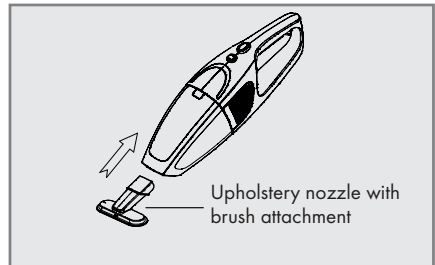
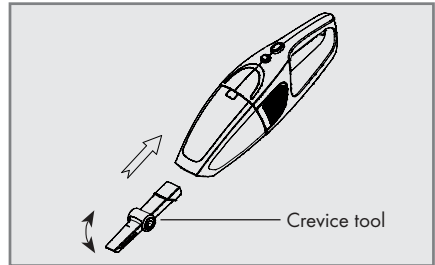

PREPARATION

Check if the mains voltage on the type plate (on the power adaptor, the handheld vacuum cleaner or the stick vacuum cleaner) corresponds to your local mains supply.

Assembly of the handheld vacuum cleaner onto the body

The handheld vacuum cleaner can be installed onto the body **D** and be removed again if necessary.

When installing the handheld vacuum cleaner **G** onto the body **D** plug it into the slot and push lightly towards the body **D**.

When removing the handheld vacuum cleaner **G**, push the button for removal of the handheld vacuum cleaner **C** and pull the handheld vacuum cleaner **G** out of the body **D**.

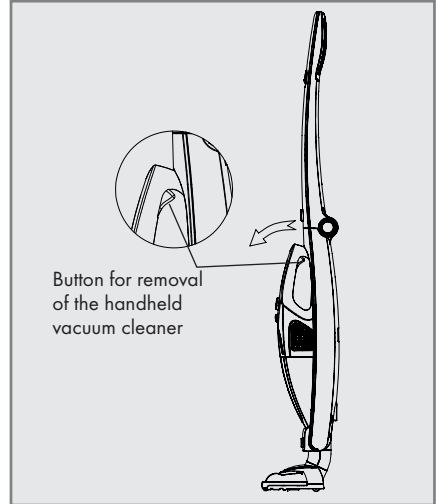
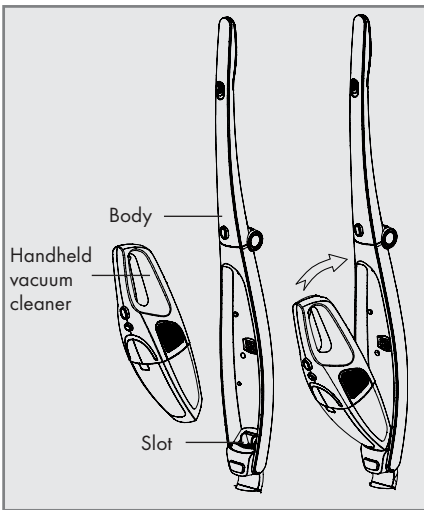

PREPARATION

Assembling the charging unit

1 Connecting the vacuum cleaner and the charging unit.

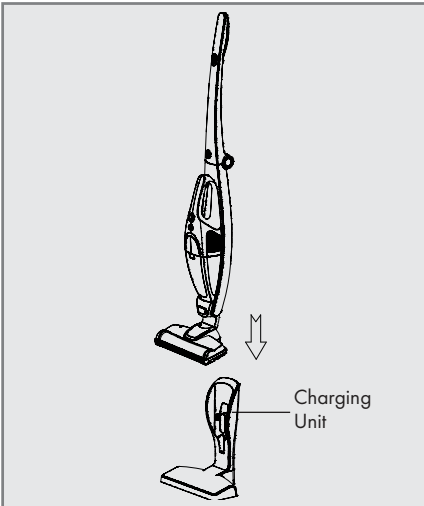
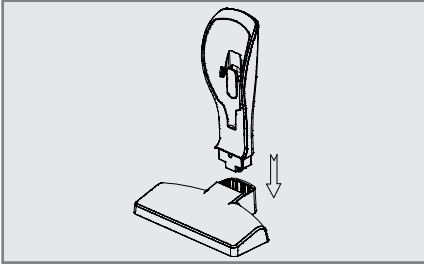

2 Connecting the power adaptor with the charging unit.

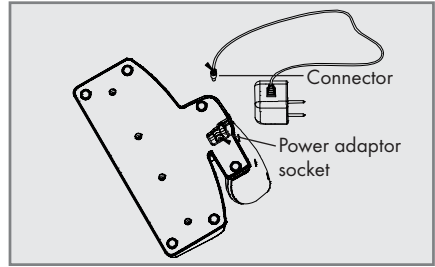

3 Connect the connector of the power adaptor with the socket under the charging unit **J**.

- When connecting the power adaptor with the wall socket, the power indicator **K** lights up red and indicates that the vacuum cleaner is being charged.
- If the power indicator **K** turns green, the vacuum cleaner has been fully charged.

Note

- The charging process will take about 6-8 hours.

OPERATION

Switching on and off the cordless stick vacuum cleaner

- 1 Pull out the vacuum cleaner from the charging unit **J**.
- 2 Press the On/Off button **A** to switch on the appliance.
- 3 After use, switch off the appliance with the On/Off button **A**.

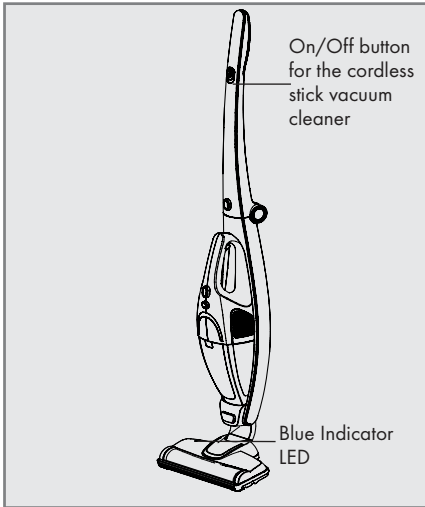

- 4 Insert the vacuum cleaner into the charging unit **J**.

Note

- If the vacuum cleaner is inserted into the charging unit **J** while it is "on", it turns off automatically.

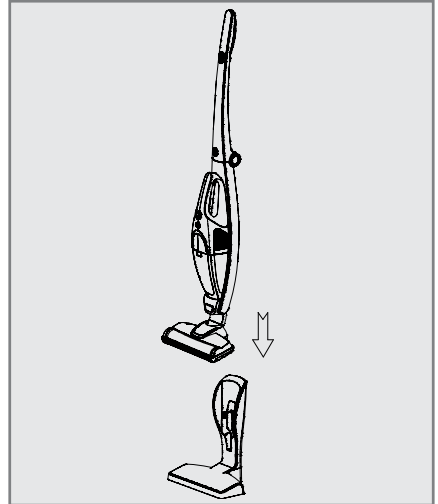

Switching on and off the handheld vacuum cleaner

- 1 Pull out the handheld vacuum cleaner **G** from the body **D**.
- 2 Press the On/Off button for the handheld vacuum cleaner **E** to switch on the appliance.
- 3 After use, switch off the appliance with the On/Off button **E**.

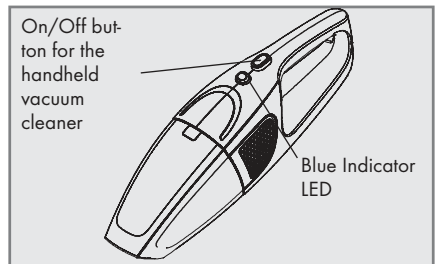

CLEANING AND CARE

Cleaning the dust container

Notes

- It is recommended that you clean the dust container after each use.
- When removing the filter in the dust container **H**, be careful not to shed the dust.

1 Push the button **F** for opening the dust container and remove the dust container **H**.

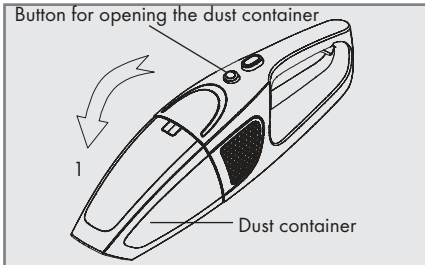

2 Remove the filter from the dust container **H**.

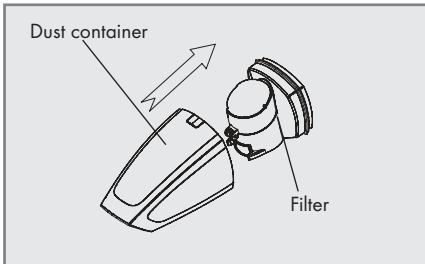

3 Remove the HEPA filter.

4 Open the cyclone cover.

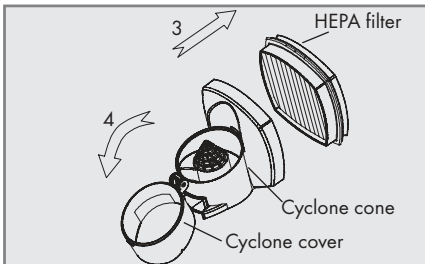

5 Clean the cyclone cone, its cover, the HEPA filter and the dust container **H** under running water.

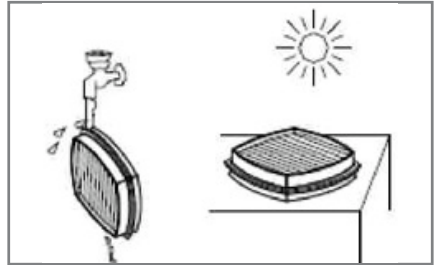



6 Clean the body of the handheld vacuum cleaner **G** with a soft and damp cloth.

7 After all parts are dry, close the cyclone cover, place the HEPA filter on the cyclone cone, re-insert them into the dust container **H** and attach the dust container **H** on the body of the handheld vacuum cleaner again.

CLEANING AND CARE

Cleaning the high-performance electric-brush

- 1 Use a screwdriver to open the lock by turning it from  to .

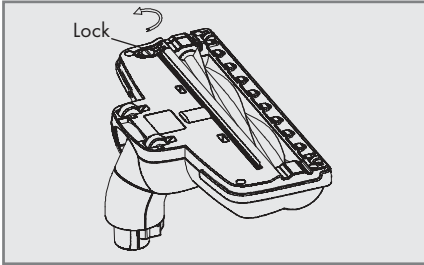

- 2 Remove the cover, pull out the brush and clean it.

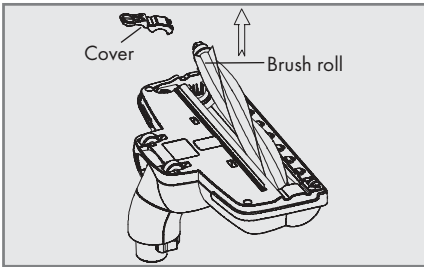

- 3 After the brush roll is cleaned and dry, re-insert it and close the cover by locking it again with a screwdriver.

Storage

You can store the appliance standing upright or folded down from the handle.

- 1 To store the vacuum cleaner folded down, push the button for folding down the handle  and fold the handle down.

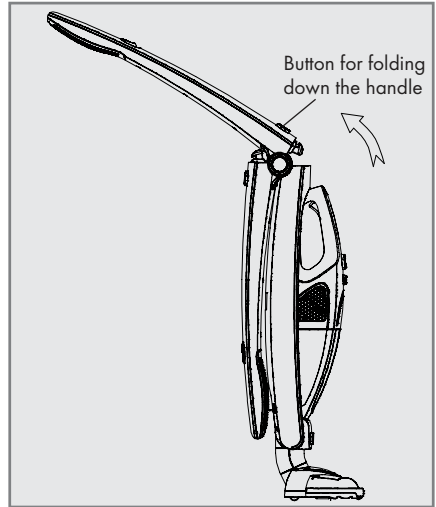

Troubleshooting

Problem	Possible cause/reason	Solution
Doesn't work.	Battery is low or flat.	Charge the battery.
	The handheld vacuum cleaner G might not be inserted into the body D properly.	Be sure to insert the handheld vacuum cleaner G into the body D properly.
Suction power is decreasing.	Dust container H is full.	Empty the dust container H .
	The HEPA filter could be blocked.	Clean or change the HEPA filter.
	The air inlet or high-performance electric brush L might be blocked.	Clean the high-performance electric brush L .
The vacuum cleaner cannot be charged.	The power adaptor O might not be plugged into the wall socket.	Plug the power adaptor O into the wall socket.
	The connector of the power adaptor O might not be plugged into the socket under the charging unit J .	Plug the power adaptor O into the socket under the charging unit J .
	The vacuum cleaner might not be inserted properly into the charging unit J .	Insert the vacuum cleaner into the charging unit J properly.
The vacuum cleaner can only be used for a very short time after charging.	The vacuum cleaner hasn't been charged enough.	Charge the vacuum cleaner properly (about 6-8 hours).
	The battery life has decreased.	Consult your GRUNDIG service partner.

Environmental note

This product has been manufactured with high-quality parts and materials which can be re-used and are suitable for recycling.



Therefore, do not dispose of the product with normal domestic waste at the end of its service life. Take it to a collection point for the recycling of electrical and electronic equipment, where the battery is taken out of the

device and disposed separately. This is indicated by this symbol on the product, in the operating manual and on the packaging.

Please consult your local authorities to find out where the nearest collection point is.

Help protect the environment by recycling used products.

Technical data

 This product conforms to the European directives 2004/108/EC, 2006/95/EC and 2009/125/EC.

Power supply

Power adaptor: LKC-173030-G

Input: 100 - 240 V~, 50/60 Hz

Output: 17.3 VDC, 300 mA

Batteries: NiMH



Power

Nominal power vacuum cleaner 80 W

Nominal power handheld vacuum cleaner 6 W

Protection class

II

Technical and design modifications reserved!

www.grundig.com
72011 908 1900 12/02

AUS GUTEM GRUND

GRUNDIG