

LEITNER

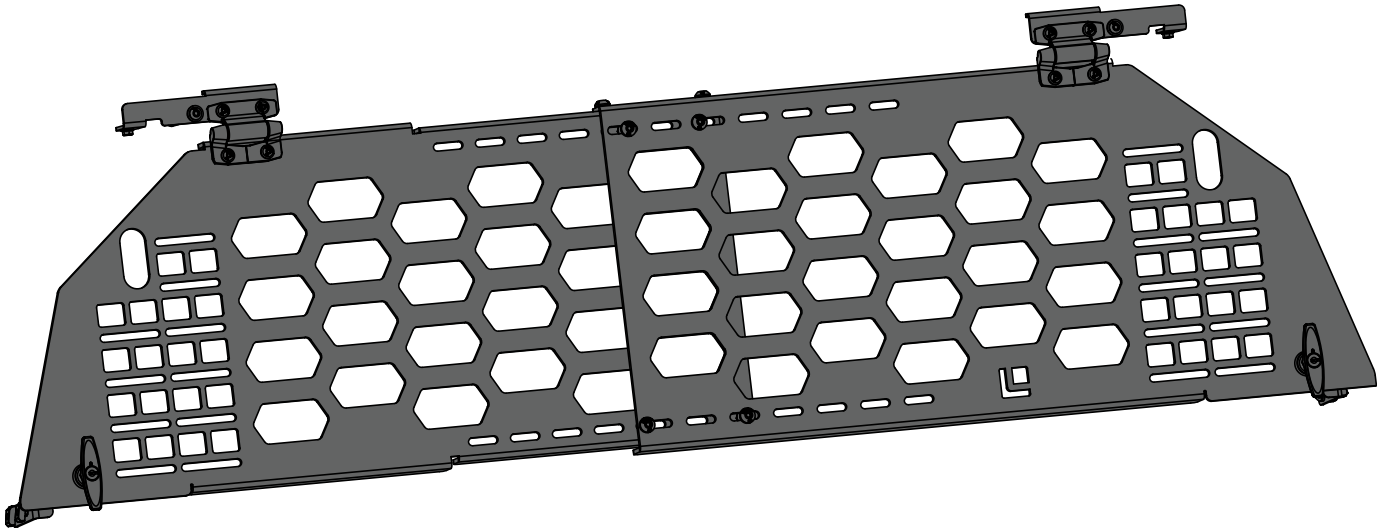

GATE KEEPER

LEITNERDESIGNS.COM | SUPPORT@LEITNERDESIGNS.COM | 949-395-3049

ASSEMBLY / INSTALLATION INSTRUCTIONS:

PART NUMBERS:

00-GTA-1844

TOOLS REQUIRED

- TORQUE WRENCH
- T30 TORX BIT SOCKET
- T40 TORX BIT SOCKET
- 10MM WRENCH
- 13MM WRENCH
- TAPE MEASURE

INSTALLATION TIME

1 HOUR

BASIC KNOWLEDGE OF HAND TOOLS REQUIRED

SKILL LEVEL



2= NOVICE

▼ READ BEFORE INSTALLING GATEK EEPER ▼

1. DON'T OVER-TIGHTEN BOLTS. ALL 8MM BOLTS = (16FT-LB) ALL 6MM BOLTS (10FT-LB)

2. LAY DOWN A LARGE AREA OF CARPET OR BLANKETS AS A WORK AREA TO AVOID SCRATCHING PARTS DURING ASSEMBLY.

3. ALTHOUGH THE GATEKEEPER IS LIGHT HAVING A FRIEND TO HELP IS RECOMMENDED.

▼ ASSEMBLY OVERVIEW ▼

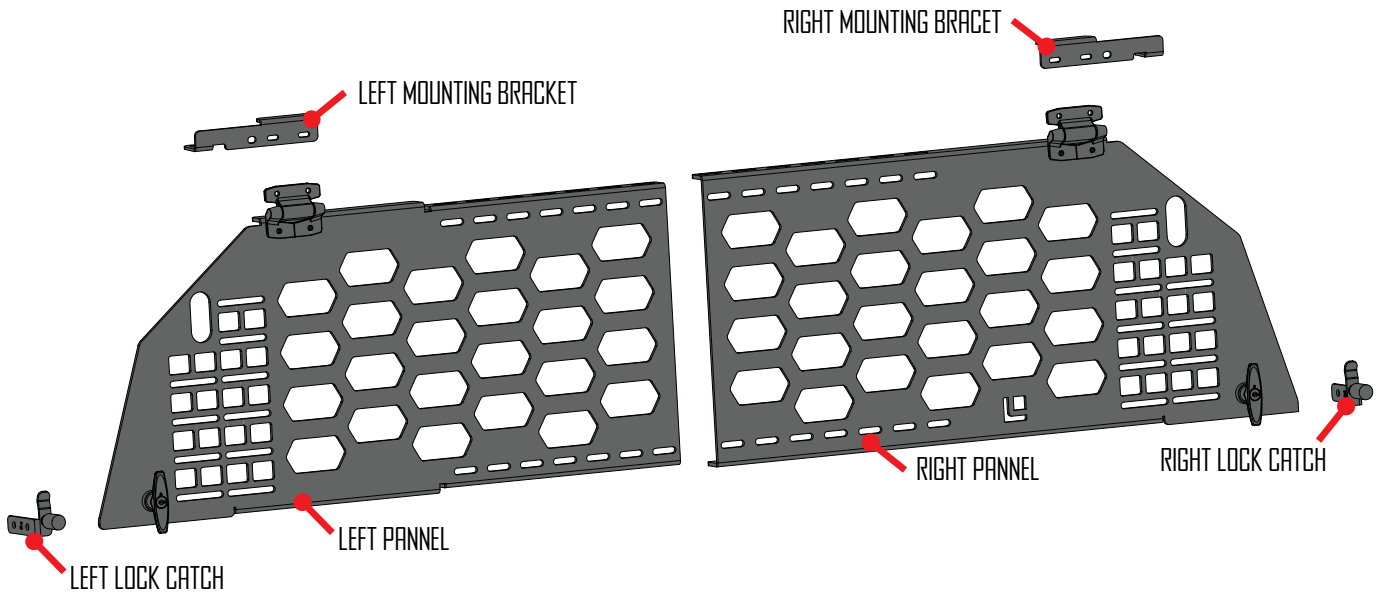

▼ GATE KEEPER HARDWARE ▼

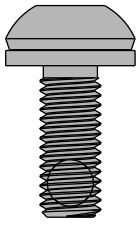

M8 X 20
[X6]

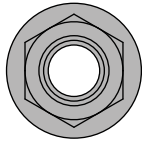

M8 LOCKNUT
[X6]

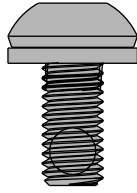

M8 X 14
[X4]

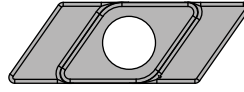

DROP IN NUT
[X4]

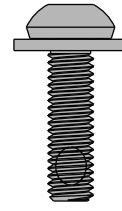

M6 X 20
[X4]

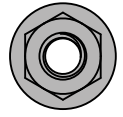

M6 FLANG NUT
[X4]

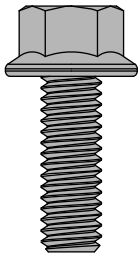

M8 X 25
[X2]

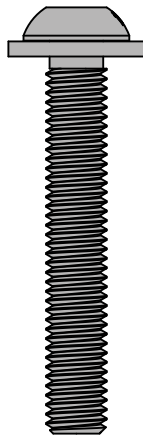

M8 X 50
[X2]

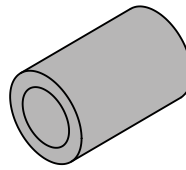

SHORT SPACER
[X2]

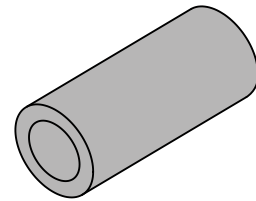

LONG SPACER
[X2]

CHECK: RACK FOR PROPER INSTALLATION

DO NOT FORGET THIS STEP!!

- THE ACS FORGED RACK NEEDS TO BE SQUARE ACCORDING TO THE ORIGINAL INSTALLATION INSTRUCTIONS BEFORE INSTALLING GATE KEEPER.
- TO VERIFY IF THE RACK IS SQUARE PARK THE VEHICLE ON LEVEL GROUND. NOW USING A TAPE MEASURE TAKE A DIMENSION BETWEEN THE INSIDE T-SLOT RAILS ON THE PASSENGER AND DRIVERS SIDE **LOWER RAILS** AS FAR REAR AS POSSIBLE. **[A]** SUBTRACT **14.25"** FROM THIS MEASUREMENT. THIS WILL GIVE YOU THE DESIRED WIDTH BETWEEN THE TOP LONG BAR EXTRUSIONS. **[B]**.
- EXAMPLE. IF THE LOWER RAIL DIMENSION IS 60" SUBTRACT 14.25" FROM 60" THE UPPER BAR DIMENSION SHOULD BE 45-3/4"

IF THESE MEASUREMENTS ARE OFF BY MORE THEN 1/4" YOU WILL NEED TO GO TO THE NEXT PAGE AND RE-ADJUST THE RACK SO THE GATE KEEPER CAN BE INSTALLED SMOOTHLY.

- NOTE: TOYOTA TACOMA'S WITH THE SUPPORTS THAT BOLT DIRECTLY INTO THE FLOOR OF THE TRUCK BED CAN SKIP THIS STEP AS THERE IS NO ADJUSTMENT POSSIBLE.

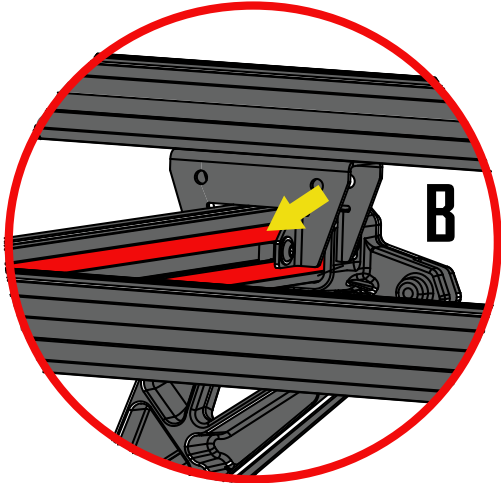
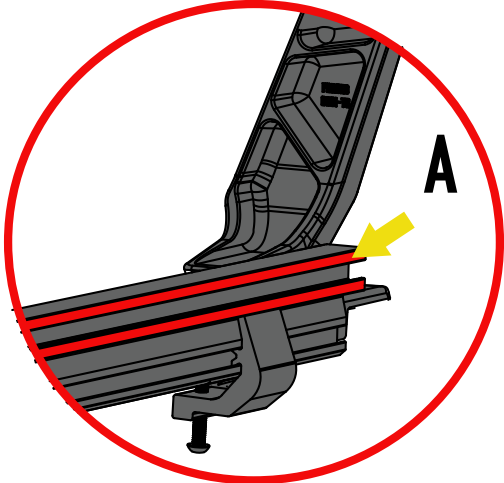
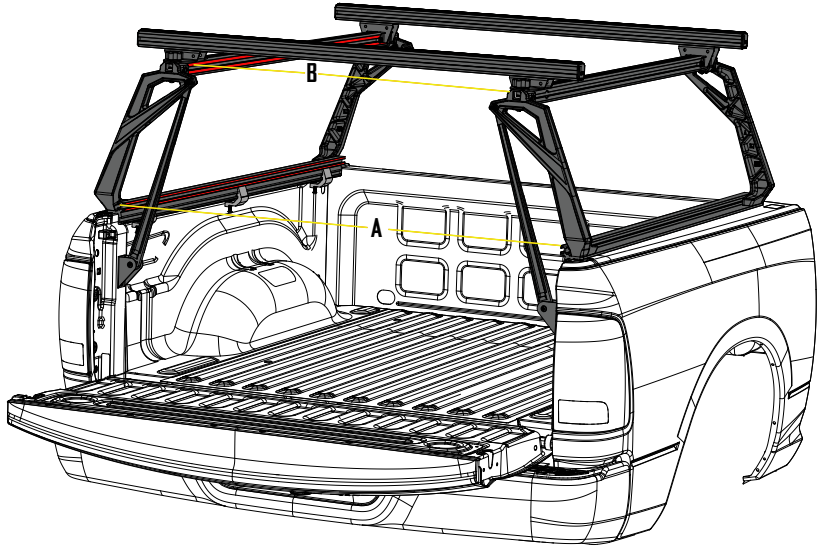

ADJUST: RACK TO PROPER DIMENSIONS

- REMOVE ALL ACCESSORIES, ROOF TOP TENTS, GEAR PODS, HYDROPODS ETC FROM RACK BEFORE ATTEMPTING ADJUSTMENT.

• LOOSEN THE FOUR SCREWS (2 PER SIDE) THAT HOLD ON THE REAR CROSS BAR FROM UNDERNEATH USING EITHER A 5MM ALLEN OR T40 TORX DEPENDING ON WHEN YOUR RACK WAS PURCHASED. YELLOW ARROWS (FIG A)

• NOW THAT THE UPPER BAR IS LOOSE HAVE A FRIEND HOLD THE PROPER DISTANCE BETWEEN THE UPPER BARS MEASURED PREVIOUSLY THEN TIGHTEN THE CROSS BAR BACK IN PLACE. THIS IS ALSO A GOOD TIME TO CHECK ALL FASTENERS ON YOUR RACK TO MAKE SURE NOTHING ON YOUR RACK IS LOOSE AND ALL FASTENERS ARE PROPERLY TORQUED.

• WE RECOMMEND INSTALLING THE GATE KEEPER BEFORE REINSTALLING YOUR ACCESSORIES SO THAT SMALL ADJUSTMENTS CAN BE MADE TO ENSURE PROPER FITMENT.

• NOTE: IN SOME CASES THE RACK MIGHT NOT HAVE BEEN INSTALLED PROPERLY AND THE REAR SUPPORTS THAT ARE DRILLED INTO THE D-PILLAR ARE NOT IN THE CORRECT LOCATION. IF YOU RUN INTO THIS SITUATION THE ONLY WAY TO GET THE PROPER SPACING WITHOUT REDRILLING HOLES IN YOUR VEHICLE IS TO SLOT THE HOLES IN THE LOWER MOUNTING BRACKET SO THAT THE CORRECT MEASUREMENTS CAN BE ACHIEVED. (FIG B)

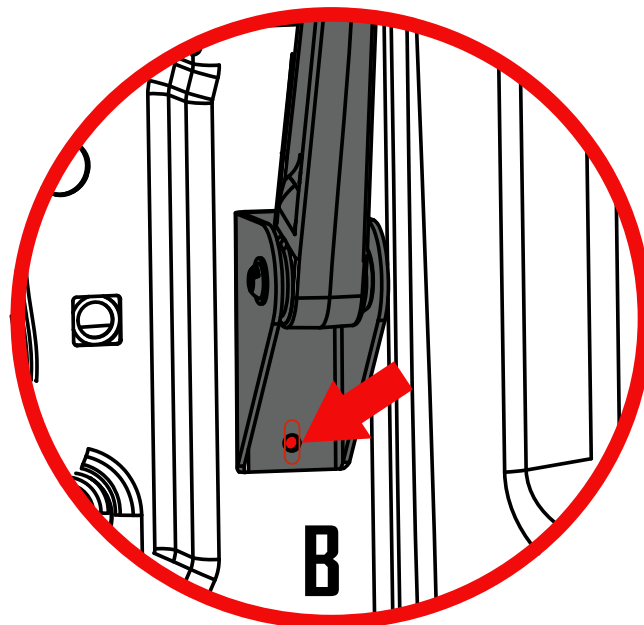
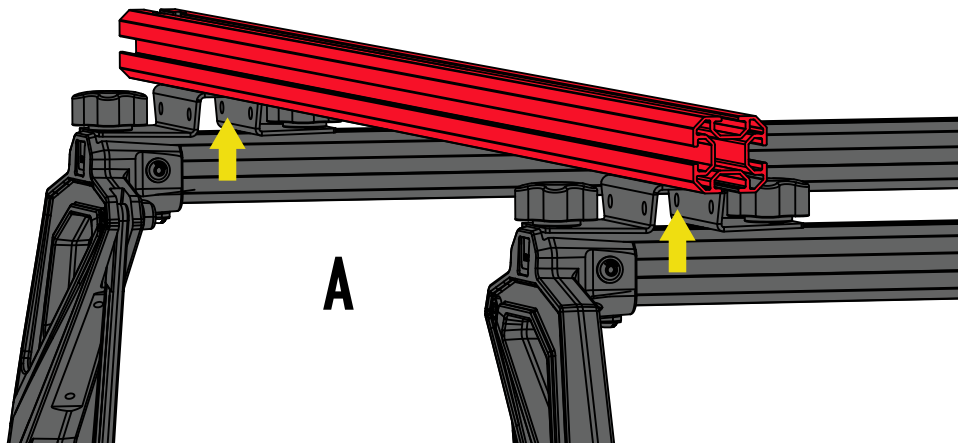

INSTALL: MOUNTING BRACKETS

- REMOVE BOLT SHOWN IN GREEN ON BOTH SIDES OF THE RACK
- REMOVE BOLT SHOWN IN RED ON BOTH SIDES OF THE RACK. IF YOU HAVE A TACOMA, TONNEAU OR NO DRILL NO SLIDE ACS FORGED RACK YOU WILL NOT HAVE THIS BOLT. DON'T WORRY WE HAVE SUPPLIED THE CORRECT HARDWARE TO FINISH YOUR INSTALLATION.

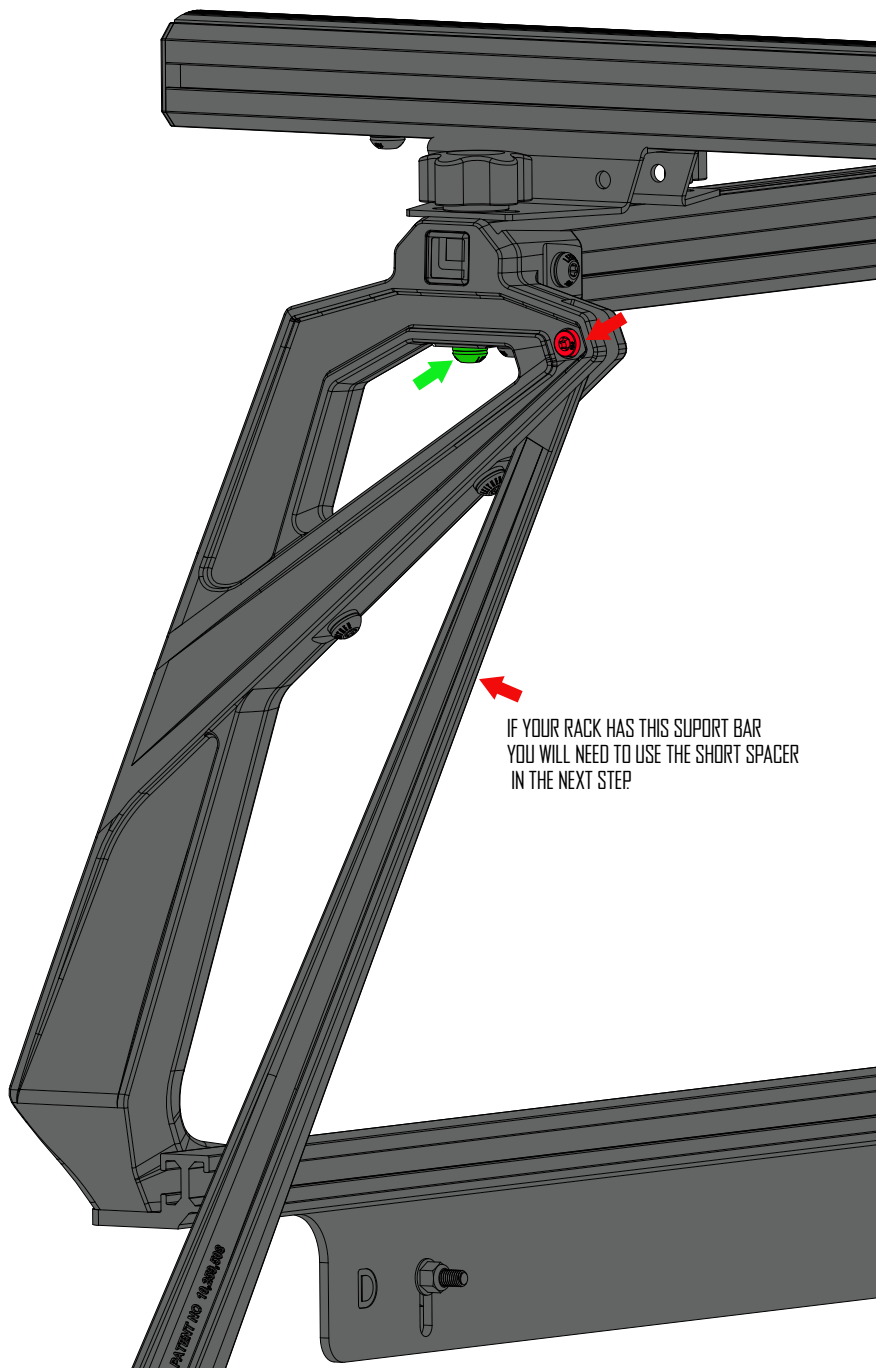

INSTALL: MOUNTING BRACKETS

- IF YOUR ACS FORGED RACK HAD THE RED BOLT AND SUPPORT BAR SHOWN ON PREVIOUS PAGE YOU WILL NEED TO USE THE SHORT SPACER.
- TOYOTA TACOMAS, NO DRILL NO SLIDE AND TONNEAU ACS RACKS WILL ALL USE THE LONG SPACER.
- INSTALL THE BRACKET AS ILLUSTRATED BELOW USING ONE M8 X 25 AND ONE M8 X 50 BOLT. TORQUE TO 16FT-LB
- REPEAT STEPS FOR RIGHT SIDE.

LEFT SIDE SHOWN

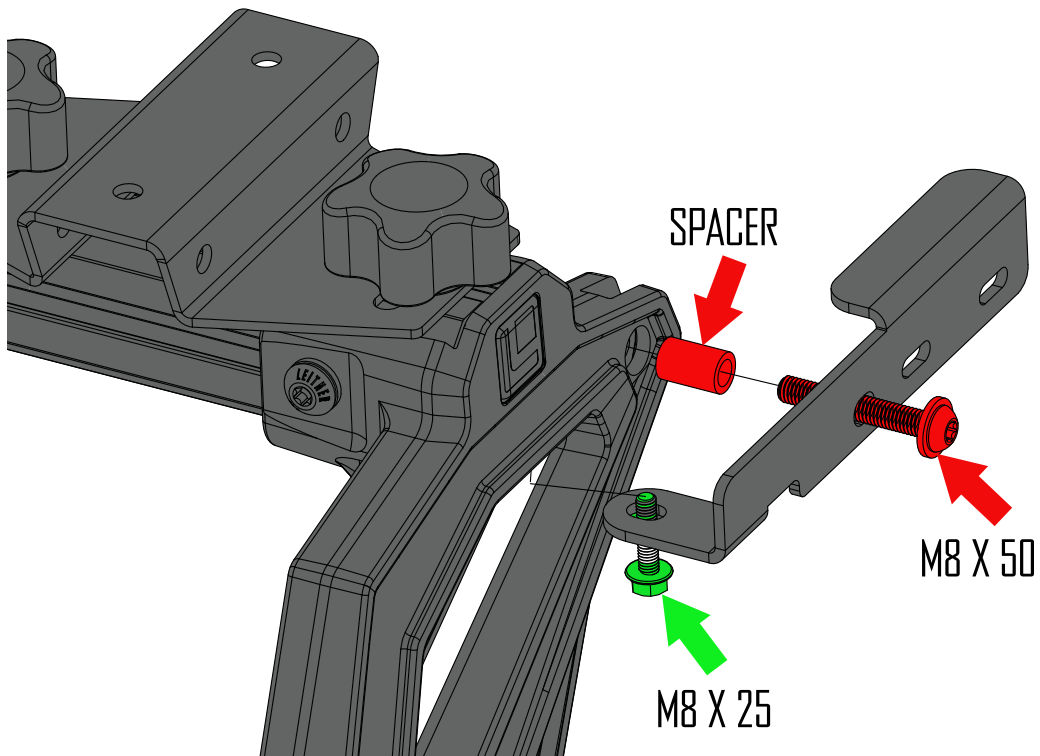

INSTALL: LOCK CATCH

· USING TWO M8 X 14 BOLTS AND 2 TRAKLOK NUTS INSTALL LOCK CATCH ON LEFT AND RIGHT SIDE LOWER EXTRUSION RAIL AS SHOWN. THE PARTS ARE CLEARLY MARKED LEFT AND RIGHT.

· THE BRACKETS HAVE A SMALL NOTCH. THIS NOTCH SHOULD LINE UP WITH THE END OF THE EXTRUSION.

· TIGHTEN THE BOLTS TO 16FT-LB

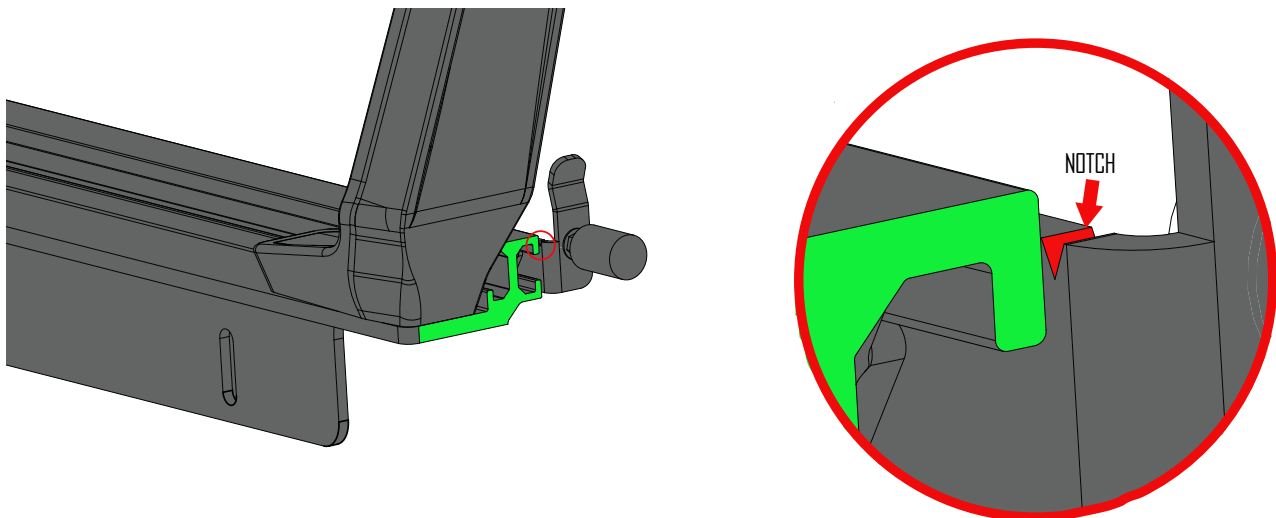
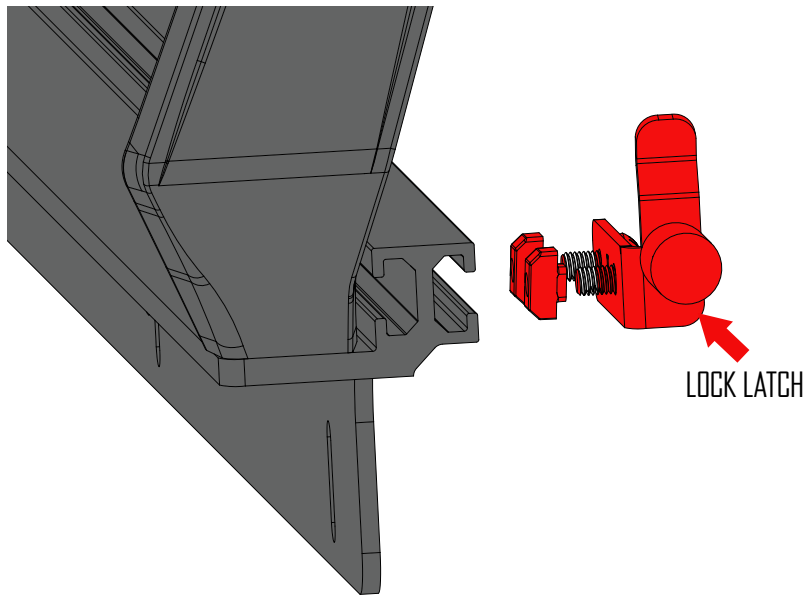

ADJUST: GATE KEEPER

•PRIOR TO INSTALLING GATE KEEPER ON BRACKETS YOU WILL NEED TO ADJUST IT SO THE HINGES WILL LINE UP WITH THE MOUNTING BRACKETS. THIS DOES NOT HAVE TO BE PERFECT AT THIS STAGE BUT WITHIN 3/8 OF AN INCH WILL DO THE JOB. (FIG 1)

•INSTALL SIX M8 X 20 BOLTS THROUGH THE FURTHEST APPART SLOTS POSSIBLE. FIX IN PLACE USING A M8 LOCKNUT. DO NOT TIGHTEN AT THIS TIME. (FIG 2)

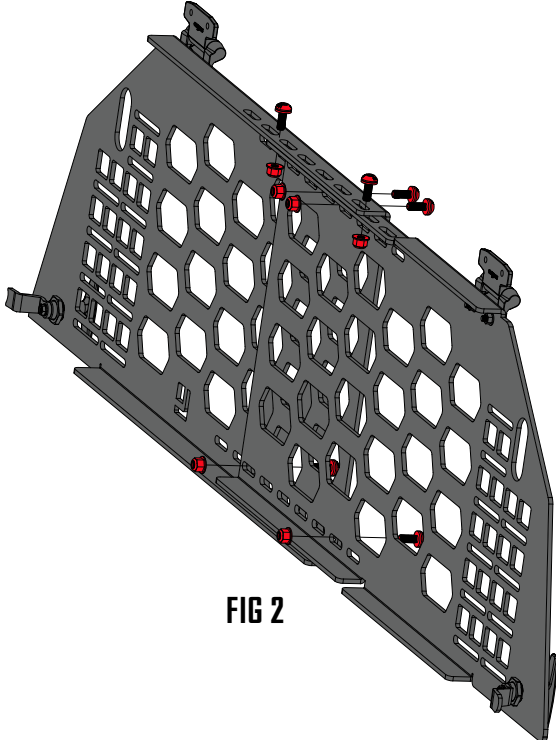
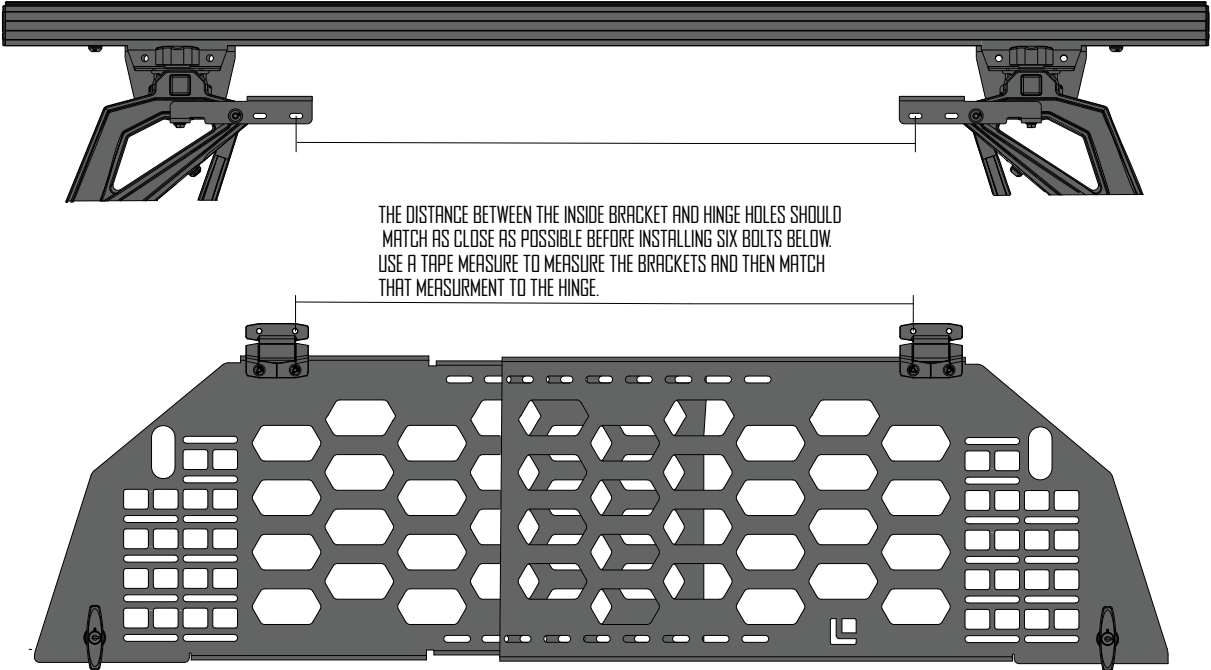

INSTALL: GATE KEEPER TO RACK

• USING FOUR M6 X 20 BOLTS AND FOUR M6 FLANGE NUTS INSTALL THE GATE KEEPER ASSEMBLY TO THE BRACKETS. TIGHTEN ENOUGH SO THAT THE HINGES CAN STILL MOVE LEFT TO RIGHT IN THE SLOTS OF THE MOUNTING BRACKET. THIS WILL ALLOW FOR LATCH ADJUSTMENT ON NEXT PAGE.

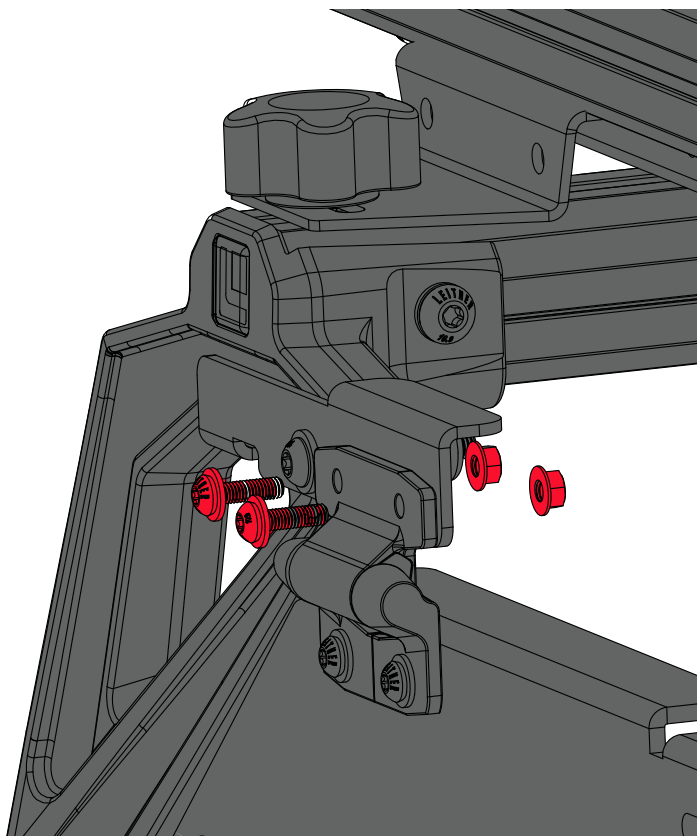
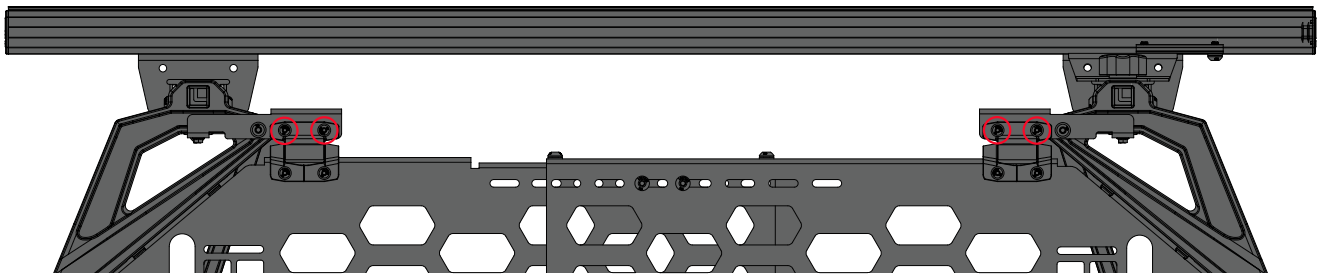

ADJUST: LOCK TO LOCK LATCH

- THE LOCKING PAWL ON THE LOCK NEEDS TO FULLY ENGAGE THE LOCKING CATCH MOUNTED ON THE ACS FORGED THAT YOU INSTALLED ON PAGE 7.
- ADJUST THE ENTIRE GATE KEEPER PANELS LEFT OR RIGHT SO THAT THE PAWL ENGAGES BUT DOES NOT GRIND ON THE INSIDE PORTION OF THE LOCKING PAWL.. THE SLOTS IN THE UPPER MOUNTING BRACKET ALLOW FOR THIS ADJUSTMENT.

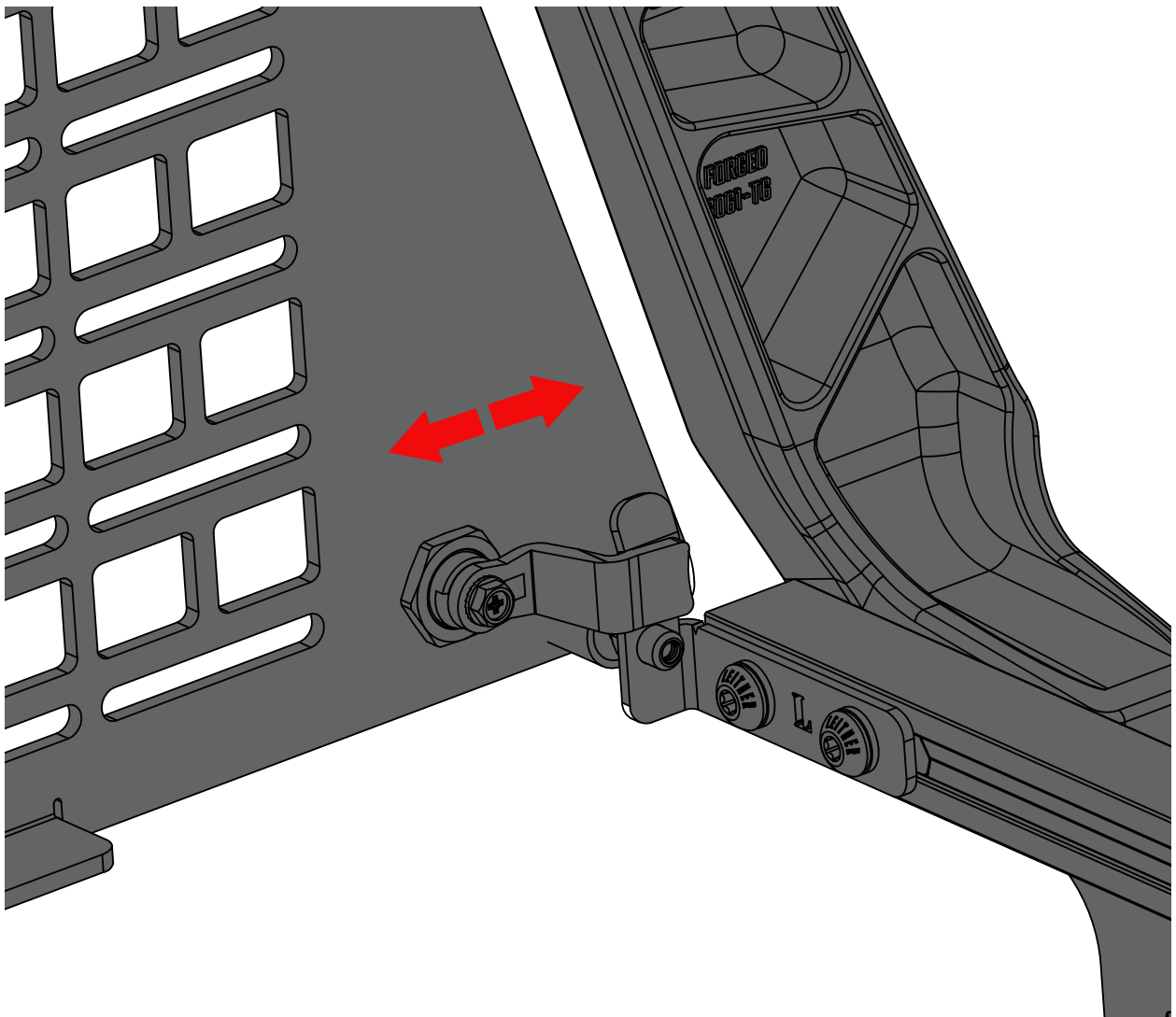

TIGHTEN: ALL REMAINING FASTENERS

- TIGHTEN THE FOUR M6 X 20 SCREWS ON THE HINGE USING A T30 TORX AND 10MM WRENCH. TORQUE TO 10FT-LB (GREEN CIRCLES).
- TIGHTEN THE SIX M8 X 20 SCREWS USING A T40 TORX AND 13MM WRENCH. TORQUE TO 16FT-LB (RED CIRCLES).

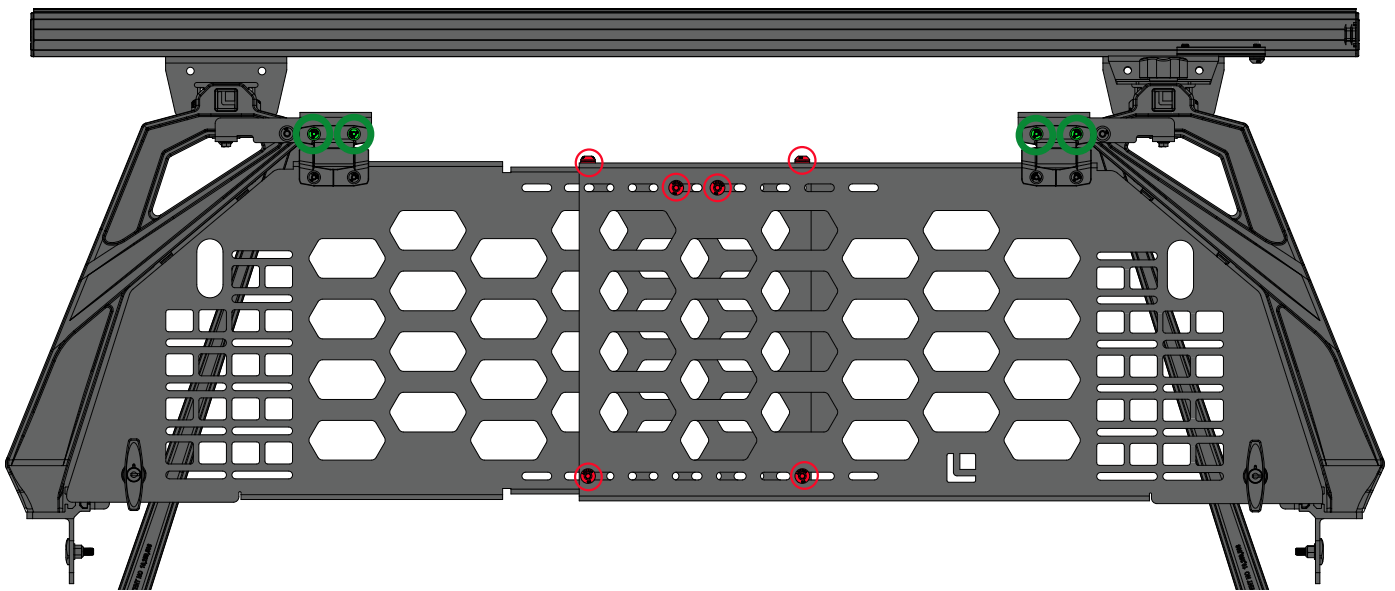

ADJUST: RUBBER STOP

- THE GATE KEEPER HAS ONE RUBBER STOP ON EACH SIDE BY THE LOCK. THIS MIGHT NEED ADJUSTMENT SO THAT THE LATCH IS TIGHT WITHOUT MOVEMENT YET STILL ALLOWING THE LATCH TO CLOSE WITH SOME PRESSURE WITHOUT BEING OVERLY FIRM TO CLOSE.
- TO ADJUST THE STOP LOOSEN THE JAM NUT WITH A 10MM WRENCH AND ADJUST EITHER INWARD OR OUTWARD TO ACHIEVE THE CORRECT FEEL.

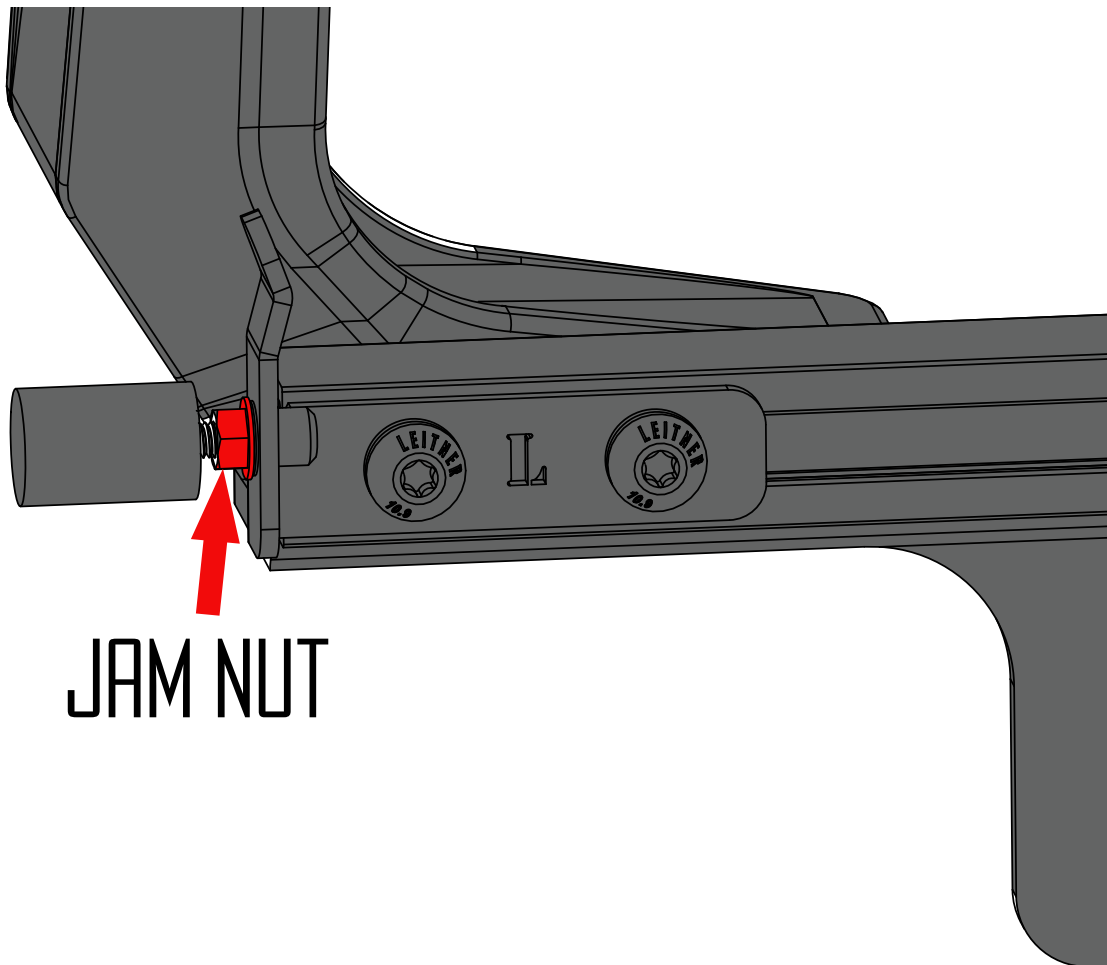

JAM NUT

USE GUIDELINES

WHEN USING LEITNER DESIGNS CARRIERS AND ACCESSORIES, THE USER MUST UNDERSTAND THE PRECAUTIONS. THE POINTS LISTED BELOW WILL ASSIST YOU IN USING THE RACK SYSTEM AND WILL ENCOURAGE SAFETY.

-FOR QUALITY FITS AND SAFETY, USE ONLY THE RECOMMENDED RACK OR ACCESSORIES. DO NOT ASSUME A RACK WILL FIT, ALWAYS CHECK THE CURRENT FIT GUIDE WHEN OBTAINING A NEW VEHICLE.

-THE MAXIMUM LOAD IS NOT TO BE EXCEEDED. (150# OFF ROAD – 300# ON ROAD). HOWEVER, **THIS LIMIT IS ALWAYS SUBORDINATE TO THE MAXIMUM LOAD RECOMMENDED BY THE MANUFACTURER OF THE VEHICLE ITSELF.** IT IS ALWAYS THE LOWER MAXIMUM RECOMMENDED LOAD THAT APPLIES. MAX TRUCK LOAD = LOAD CARRIER WEIGHT + ANY FITTED CARRIER ACCESSORIES + THE WEIGHT OF THE LOAD ITSELF.

-HIGH SPEED OFF ROAD DRIVING EVEN WITH A LIGHT LOAD CAN CAUSE DAMAGE TO THE RACK, ACCESSORIES AND VEHICLE BODY. DAMAGE CAUSED BY HIGH SPEED DRIVING AND ABUSE IS NOT COVERED UNDER WARRANTY.

-MAKE SURE ALL KNOBS, BOLTS, SCREWS, STRAPS, AND LOCKS ARE FIRMLY ATTACHED, TIGHTENED AND LOCKED BEFORE EVERY TRIP. KNOBS, BOLTS, SCREWS, STRAPS AND LOCKS MUST BE PERIODICALLY INSPECTED FOR SIGNS OF WEAR, CORROSION, AND FATIGUE. CHECK YOUR LOAD AT STOPS DURING THE TRIP TO ENSURE CONTINUED FASTENING SECURITY.

-CHECK LOCAL AND STATE LAWS GOVERNING PROJECTION OF OBJECTS BEYOND THE PERIMETER OF A VEHICLE. BE AWARE OF THE WIDTH AND HEIGHT OF YOUR CARGO SINCE LOW CLEARANCE BRANCHES, BRIDGES, AND PARKING GARAGES CAN AFFECT THE LOAD. ALL CARGO WILL AFFECT THE VEHICLE'S DRIVING BEHAVIOR. NEVER DRIVE WITH ANY LOCK, KNOB OR RACK IN AN OPEN OR UNLOCKED POSITION. ALL LONG LOADS SUCH AS, BUT NOT LIMITED TO, SAILBOARDS, SURFBOARDS, KAYAKS, CANOES, AND LUMBER MUST BE TIED DOWN FRONT AND REAR TO THE BUMPERS OR TOW HOOKS OF THE VEHICLE.

-ALL LOCKS MUST BE TURNED AND MOVED PERIODICALLY TO ENSURE SMOOTH OPERATION. USE GRAPHITE OR DRY LUBRICANT TO HELP THIS. LEITNER DESIGNS LOCKS ARE DESIGNED TO DETER VANDALISM AND THEFT BUT SHOULD NOT BE CONSIDERED THEFT PROOF. REMOVE VALUABLE GEAR IF YOUR VEHICLE IS UNATTENDED FOR AN EXTENDED PERIOD. PLACE AT LEAST ONE KEY IN THE GLOVE COMPARTMENT.

-FOR SAFETY TO YOUR VEHICLE AND RACK SYSTEM, OBEY ALL POSTED SPEED LIMITS AND TRAFFIC CAUTIONS. ADAPT YOUR SPEED TO THE CONDITIONS OF THE ROAD AND THE LOAD BEING CARRIED.

-DO NOT USE LEITNER DESIGNS LOAD CARRIERS AND ACCESSORIES FOR PURPOSES OTHER THAN THOSE FOR WHICH THEY WERE DESIGNED. DO NOT EXCEED THEIR CARRYING CAPACITY. FAILURE TO FOLLOW THESE GUIDELINES OR THE PRODUCT'S INSTRUCTIONS WILL VOID THE WARRANTY.

WARRANTY

LEITNER DESIGNS WARRANTS PRODUCT TO BE FREE FROM DEFECTS IN MATERIAL AND WORKMANSHIP, FOR TERMS SPECIFIED BELOW, PROVIDED THERE HAS BEEN NORMAL USE AND PROPER MAINTENANCE. ALL REMEDIES UNDER THIS WARRANTY ARE LIMITED TO THE REPAIR OR REPLACEMENT OF ANY ITEM FOUND BY THE FACTORY TO BE DEFECTIVE WITHIN THE TIME PERIOD SPECIFIED. IF YOU HAVE A WARRANTY CLAIM, FIRST YOU MUST CALL OUR FACTORY AT THE NUMBER BELOW FOR INSTRUCTIONS. YOU MUST RETAIN PROOF OF PURCHASE AND SUBMIT A COPY WITH ANY ITEMS RETURNED FOR WARRANTY WORK. UPON COMPLETION OF WARRANTY WORK, IF ANY, WE WILL RETURN THE REPAIRED OR REPLACED ITEM OR ITEMS TO YOU FREIGHT PREPAID. DAMAGE TO OUR PRODUCTS CAUSED BY ACCIDENTS, FIRE, VANDALISM, NEGLIGENCE, MIS-INSTALLATION, MISUSE, ACTS OF GOD, OR BY DEFECTIVE PARTS NOT MANUFACTURED BY US, IS NOT COVERED UNDER THIS WARRANTY.

THE WARRANTY TIME PERIOD IS AS FOLLOWS: (2) TWO YEARS FROM DATE OF PURCHASE.

HIGH SPEED OFF ROAD DRIVING EVEN WITH A LIGHT LOAD CAN CAUSE DAMAGE TO THE RACK, ACCESSORIES AND VEHICLE BODY. DAMAGE CAUSED BY HIGH SPEED OFF ROAD DRIVING AND ABUSE IS NOT COVERED UNDER WARRANTY.

ANY IMPLIED WARRANTIES OF MERCHANTABILITY AND/OR FITNESS FOR A PARTICULAR PURPOSE CREATED HEREBY ARE LIMITED IN DURATION TO THE SAME DURATION AND SCOPE AS THE EXPRESS WRITTEN WARRANTY. OUR COMPANY SHALL NOT BE LIABLE FOR ANY INCIDENTAL OR CONSEQUENTIAL DAMAGE.

SOME STATES DO NOT ALLOW LIMITATIONS ON HOW LONG AN IMPLIED WARRANTY LASTS, OR THE EXCLUSION OR LIMITATION OF INCIDENTAL OR CONSEQUENTIAL DAMAGES, SO THE ABOVE LIMITATIONS OR EXCLUSIONS MAY NOT APPLY TO YOU. THIS WARRANTY GIVES YOU SPECIFIC LEGAL RIGHTS, AND YOU MAY ALSO HAVE OTHER RIGHTS THAT VARY FROM STATE TO STATE.

FOR WARRANTY ISSUES WITH THIS PRODUCT PLEASE CALL LEITNER DESIGNS CUSTOMER SERVICE **949-395-3049** OR EMAIL US AT **SALES@LEITNERDESIGNS.COM**