

**morphyrichards®**  
smart ideas for your home

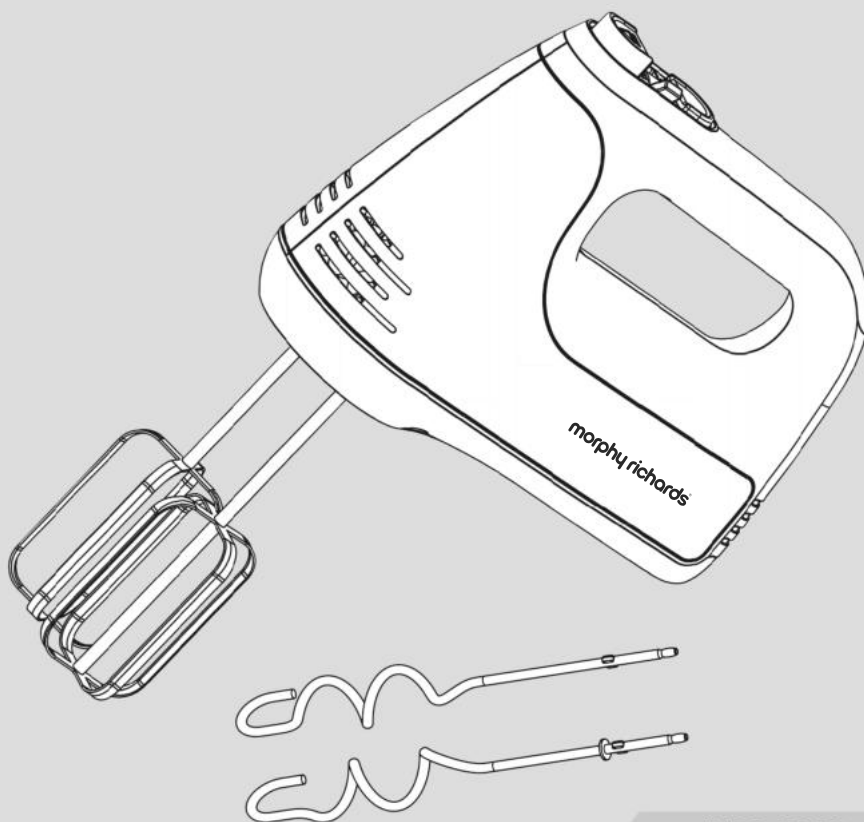

## Hand Mixer

 Please read and keep these instructions for future use



#10870390

[www.morphyrichards.com](http://www.morphyrichards.com)

## Health And Safety

The use of any electrical appliance requires the following common sense safety rules. Please read these instructions carefully before using the product.

- This appliance can be used by persons with reduced physical, sensory or mental capabilities, or lack of experience and knowledge, if they have been given supervision or instruction concerning the use of the appliance in a safe way and understand the hazards involved.
- This appliance shall not be used by children.
- Keep appliance and cord out of the reach of children.
- Do not use your hand mixer continuously for longer than 5 minutes with the Beaters. After using for this length of time, allow to cool for 20 minutes.
- Avoid touching moving parts. Keep hands, hair and clothing, and utensils away from the hand mixer attachments during operation, to prevent personal injury and/or damage to the appliance.
- Switch off the appliance and disconnect from the supply before changing accessories or approaching parts that move in use.
- If the supply cord is damaged, it must be replaced by the manufacturer, its service agent or similarly qualified persons in order to avoid a hazard.
- Children shall not play with the appliance.
- Unplug from the outlet when not in use, or when left unattended, and before assembling, disassembling or cleaning.
- For care and cleaning refer to page 6.

In addition, we offer the following safety advice.

### Location

- Do not use outdoors or in a bathroom.
- Always locate your appliance away from the edge of the worktop.

### Mains cable

- Do not let the mains cable hang over the edge of the worktop where a child could reach it.
- Do not let the lead run across an open space e.g. between a low socket and a table.
- Do not let the cable run across a cooker or other hot area which might damage the cable.
- The mains cable should reach from the socket to the base unit without straining the connections.
- The power cord cannot be replaced. Contact Morphy Richards for advice.

### Other safety considerations

- Do not use the appliance for anything other than its intended purpose.
- **WARNING: Misuse of appliance could cause personal injury.**
- The use of attachments or tools not recommended or sold by Morphy Richards may cause fire, electric shock or injury.

### Product specific safety

- Do not operate any appliance with a damaged cord or plug or after the appliance malfunctions or has been damaged in any manner.

### Electrical requirements

Check that the voltage on the rating plate of your appliance corresponds with your house electricity supply which must be A.C. (Alternating Current).

## Introduction

Thank you for your recent purchase of this Morphy Richards Hand Mixer. Your Hand Mixer comes with Beaters and Dough Hooks enabling you to make a multitude of dishes. Please read the instructions for information on how to use your Hand Mixer before use.

## Contents

Health And Safety .....	2
Introduction .....	3
Product Overview .....	4
Before First Use .....	5
Inserting The Beaters .....	5
Inserting The Dough Hooks .....	5
Using Your Hand Mixer .....	5
Turbo Mode .....	5
After Use .....	5
Top Tips .....	6
Care And Cleaning .....	6
Exclusions .....	6
Disclaimer .....	6
Warranty .....	7

## Product Overview

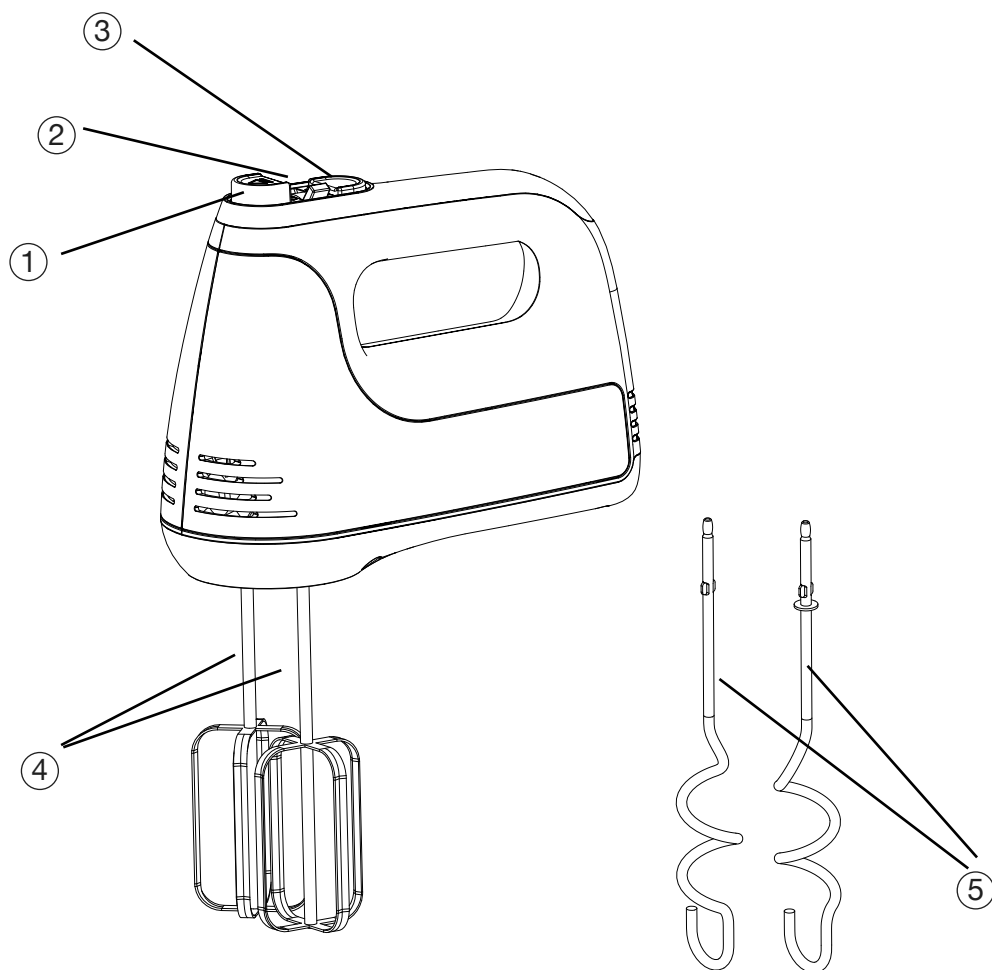

## Features

- |                    |                 |
|--------------------|-----------------|
| (1) Ejector Button | (4) Beaters     |
| (2) Speed Selector | (5) Dough Hooks |
| (3) Turbo Button   |                 |

## Before First Use

Before using your Hand Mixer for the first time, wash the Beaters (4) and Dough Hooks (5) in warm soapy water, rinse and dry.

Before assembling the Hand Mixer, be sure the power cord is unplugged from the wall power socket and the Speed Selector (2) is at the 0 position, then plug in the power socket.

## Important

**The max operating time should not exceed 5 minutes. A minimum of 20 minutes rest time to cool down must be maintained before the Hand Mixer is used again.**

## Inserting The Beaters

Your Hand Mixer is supplied with two Beaters (4). The Beaters (4) may be fitted in either Hand Mixer socket, as they are identical.

## Inserting The Dough Hooks

Your Hand Mixer is supplied with two Dough Hooks (5). One of your Dough Hooks (5) will have a washer on the shaft. Insert this into the larger hole on your mixer.

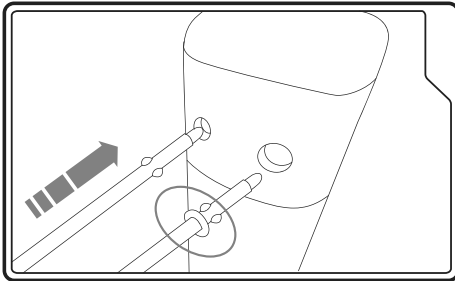

## Using your Hand Mixer

1. Plug the Hand Mixer into the wall power socket, ensuring the Speed Selector (2) is at 0.
2. There are 5 speed settings. Turn the Speed Selector (2) to your desired setting and the appliance will start working.

## Turbo Mode

To run the Hand Mixer at high speed for intermittent bursts, press the Turbo Button (3).

## After Use

1. When mixing is completed, turn the Speed Selector (2) to the 0 position, unplug the Hand Mixer from the wall power socket.
2. If necessary, scrape any excess mixture from the Beaters (4) or Dough Hooks (5) with a rubber or wooden spatula.
3. To remove the Beaters (4) or Dough Hooks (5) simply press the Ejector Button (1), ensuring the Speed Selector (2) is set to 0.

**WARNING: Ensure there are no utensils in the bowl before mixing**

## Top tips

1. Refrigerated ingredients, such as butter and eggs should be at room temperature before mixing begins.
2. To eliminate the possibility of shells in your recipe, break eggs into a separate container first, then add more to the mixture.
3. Follow individual recipes for mixing/blending times
4. Always start mixing at a lower speed. Gradually increase to the recommended speed as stated in the recipe.
5. When making dough, first mix the dry ingredients, oils, fats or butter, with the Beaters (4) for approximately 20-30 seconds on speed 2 until they form breadcrumbs. Change to the Dough Hooks (5) and add the water using speed 2. Reduce to speed 1 to knead the dough for 1 minute.

## Care And Cleaning

1. Ensure the Hand Mixer is un-plugged from the wall power socket before cleaning.
2. Wipe over the outside surface of the Mixer with a dampened cloth and dry with a dry cloth.
3. Wipe any excess food mixture from the power cord.
4. Wash the Beaters (4) and Dough Hooks (5) in warm, soapy water and wipe dry.
5. The Beaters (4) and Dough Hooks (5) are dishwasher safe.

**CAUTION: The Hand Mixer cannot be immersed in water or any other liquid**

## Exclusions

Morphy Richards shall not be liable to replace or repair the goods under the terms of the guarantee where:

- 1 The fault has been caused or is attributable to accidental use, misuse, negligent use or used contrary to the manufacturer's recommendations or where the fault has been caused by power surges or damage caused in transit.
  - 2 The appliance has been used on a voltage supply other than that stamped on the products.
  - 3 Repairs have been attempted by persons other than our service staff (or authorised dealer).
  - 4 The appliance has been used for hire purposes or non domestic use.
  - 5 The appliance is second hand.
  - 6 Morphy Richards reserves the right not to carry out any type of servicing under the guarantee at its discretion
- This guarantee does not confer any rights other than those expressly set out above and does not cover any claims for consequential loss or damage. This guarantee is offered as an additional benefit and does not affect your statutory rights as a consumer. Morphy Richards products are intended for household use only. See usage limitations within the location safety instructions.

## Disclaimer

Morphy Richards has a policy of continuous improvement in product quality and design. The company, therefore reserves the right to change the specification of it's models at any time.



For electrical products sold within the European Community. At the end of the electrical products useful life, it should not be disposed of with household waste.

Please recycle where facilities exist. Check with your Local Authority or retailer for recycling advice in your country

## Your 2 Years Warranty

**PLEASE AFFIX YOUR RECEIPT/PROOF OF PURCHASE HERE.  
IN THE EVENT OF A CLAIM UNDER THIS WARRANTY THE AFORESAID  
RECEIPT/PROOF OF PURCHASE MUST BE PRODUCED TOGETHER WITH THIS  
WARRANTY.**

Model number	(Lot number: )
Product name	
Date of purchase	
Place of purchase	

1. The party selling the product (“the seller”) to the original purchaser of this product (“the customer”) hereby warrants that this product will be of good quality and, in good working order and, free of defects and suitable for its intended purpose under normal household use, for a period of 2 (two) years from the date of purchase (“warranty period”) of this product.
2. In the event that the warranty period has not lapsed and the product is not of a good quality, or in good working order or, is defective or is not suitable for its intended purpose under normal household use, the customer may, subject to paragraph 3 below, return the product to the seller and have the following options available:
  - 2.1 Within the first 6 (six) months of the warranty: to receive a refund of the actual price paid or exchange the product for the same or similar product of the same purchased value;
  - 2.2 Within the second 6 (six) months of the warranty: to have the product exchanged for the same or similar product of the same purchased value.
3. The seller will not replace the product or refund the customer in terms of this warranty if the product:
  - 3.1 has been altered contrary to the instructions provided in the product manual;
  - 3.2 has been misused, abused or tampered with;
  - 3.3 is defective or not in working order due to ordinary wear and tear;
  - 3.4 is damaged resulting from the customer’s gross negligence, recklessness, malicious behavior or criminal conduct;
  - 3.5 has been utilised for commercial use.
4. This warranty applies only to the product that has been purchased from the seller and not to any expendables attached to or installed on the product by the customer.
5. Any claim in terms of the warranty must be supported by the original proof of purchase.
6. Note that the exchange item will only carry the balance of the warranty period as from the original date of purchase.

