

# NEOMITIS

Creator of innovative solutions for thermal comfort and energy savings in the home environment

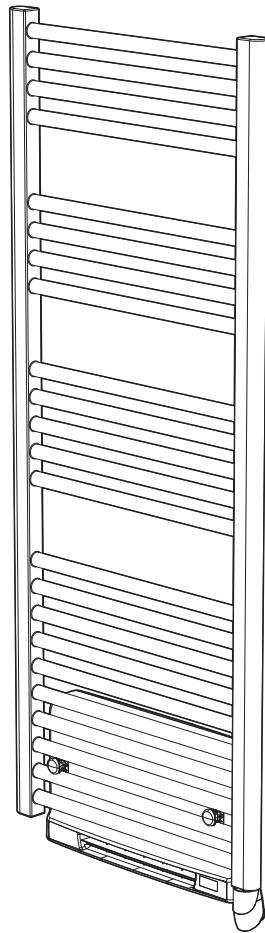

**Optional:**  
RF remote control



## INSTALLATION AND OPERATING INSTRUCTIONS

ELECTRIC TOWEL RAILS WITH THERMAL FLUID  
WITH PATENTED SMART BLOWER, EXTRA-SLIM STYLE  
OPTIONAL: INFRARED REMOTE CONTROL

GAUGE AND POWER CONSUMPTION INDICATION - OPEN WINDOW DETECTION - 7 DAY AND DAILY PROGRAMME  
WITH DUAL OPTIMIZATION FEATURE - BOOST - SETTING TEMPERATURE LIMITATION - PIN CODE LOCK

**Danaï's** *Neoboost*

*Patented blower with hot air flow and extra-slim style, alliance between stylish design and performance, ambient comfort, warm towels, energy savings through Pack + with innovative features*

# TABLE OF CONTENTS

<b>Installing the heating device</b> .....	<b>3</b>
<i>Warnings and precautions</i> .....	3
<i>Connecting, wall-mounting procedure</i> .....	4
<b>Overview</b> .....	<b>7</b>
<i>Benefits</i> .....	7
<b>Operating</b> .....	<b>8</b>
<i>Diagram</i> .....	8
<i>Power ON/Heating standby mode</i> .....	9
<i>Selecting the operating mode</i> .....	9
<i>Boost feature</i> .....	10
<i>Post-venting</i> .....	10
<i>Super comfort</i> .....	10
<i>Pack +: Gauge consumption, energy savings</i> .....	10
<i>Setting the Comfort mode temperature</i> .....	11
<i>Pack +: Consumption indication accumulated in kWh,energy savings</i> .....	11
<i>Child anti-tamper, keypad lock/unlock</i> .....	11
<i>Pack +: 7 day and daily programme integrated, energy savings</i> .....	11
<i>Pack +: Open window detection, energy savings</i> .....	13
<i>Information about remote control by pilot wire</i> .....	14
<i>Information about priorities between the different modes</i> .....	15
<i>Optional: Remotely management by RF remote control</i> .....	15
<b>User settings</b> .....	<b>16</b>
<i>Access</i> .....	16
<i>Backlight setting</i> .....	16
<i>Setting the Eco mode temperature lowering-level</i> .....	16
<i>Setting the frost protection temperature</i> .....	16
<i>Super comfort - Activation/deactivation</i> .....	17
<i>Pack +: Comfort setpoint temperature limit, energy savings</i> .....	17
<i>Setting of the maximum duration of authorised Boost</i> .....	17
<i>Setting of the maximum ambient temperature for the automatic stop of the Boost</i> .....	17
<i>Restoring factory settings</i> .....	18
<b>Installer settings</b> .....	<b>19</b>
<i>Access</i> .....	19
<i>Open window detection, activation/deactivation of the auto mode</i> .....	19
<i>Dual optimization feature</i> .....	19
<i>PIN code lock</i> .....	19
<i>Restoring factory settings</i> .....	21
<b>Expert settings</b> .....	<b>21</b>
<i>Access</i> .....	21
<i>Ambient temperature sensor adjustment</i> .....	22
<b>Power cut</b> .....	<b>22</b>
<i>Other remotely management by power shutdown</i> .....	22
<i>In case of power, backup</i> .....	22
<b>Troubleshooting</b> .....	<b>23</b>
<i>Diagnosis support</i> .....	23
<b>Technical informations</b> .....	<b>24</b>
<i>Maintenance</i> .....	24
<i>Product label</i> .....	24
<i>Dimensional specifications</i> .....	24
<i>Technical specifications</i> .....	25
<i>Information requirements for electric local space heaters</i> .....	26
<i>Legal guarantee (Extract of terms and conditions)</i> .....	27



# INSTALLING THE HEATING DEVICE

## WARNINGS AND PRECAUTIONS

### • Safety advice

All damage resulting from non-compliance with this advice gives rise to non-application of the terms of the manufacturer's warranty.

- Do not use the appliance outdoors.
- Your appliance is intended for domestic usage and must not be used for other purposes.
- **IMPORTANT: It is strongly NOT recommended to dry out synthetic clothes directly on towel rails.**

Unlike terry towels, this type of material (nylon, lycra, polyester, acrylic...) often present in the current clothes, are more sensitive to a direct heat source.

If the synthetic material is fragile, this can lead a color transfer on the heater body frequently indelible and then permanent.

- If the appliance has fallen on the ground, has been damaged or does not work properly, do not switch it on and ensure that the power supply to it has been cut off (by means of a fuse or of a circuit breaker).
  - Never disassemble the appliance. A badly-repaired appliance may present risks for the user. Please consult your local point of sales regarding any problems.
  - If the power supply cable is damaged, it must be replaced by the manufacturer, its after-sales service department or another electrical professional in order to avoid any dangers arising.
  - The heating appliance has been filled with a precise quantity of thermal fluid (a product safety data sheet is available upon request).
  - Should a leak occur, switch off the appliance, put it somewhere out of the way so that the fluid spill does not spread and so that the thermal fluid is not accidentally swallowed by a child, and then immediately contact the company that sold you the appliance or a representative of the manufacturer.
- Any tasks which require opening one of the closure plugs should only be carried out by a properly accredited representative of the manufacturer.
- When the heating appliance is scrapped, comply with legislation and regulations regarding disposal of the thermal fluid.



**- Important, caution, do not cover:**  
**To avoid overheating, risk of incident or premature degradation of the product, it is forbidden to cover the hot air outlet grid.**

**Be sure that nothing, no clothe, no object will obstruct or block the air flow.**

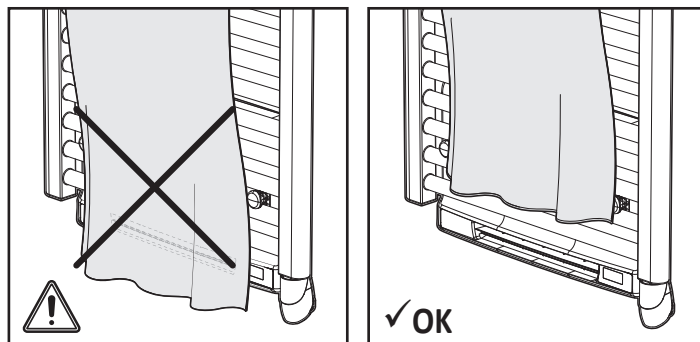

- This appliance can be used by children aged from 8 years and above and persons with reduced physical sensory or mental capabilities or lack of experience and knowledge if they have been given supervision or instruction concerning use of the appliance in a safe way and understand the hazards involved. Children shall not play with the appliance. Cleaning and user maintenance shall not be made by children without supervision.

Children of less than 3 years should be kept away unless continuously supervised.

Children aged from 3 years and less than 8 years shall only switch on/off the appliance provided that it has been placed or installed in its intended normal operating position and they have been given supervision or instruction concerning use of the appliance in a safe way and understand the hazards involved.

Children aged from 3 years and less than 8 years shall not plug in, regulate and clean the appliance or perform user maintenance.



**CAUTION - Some parts of this product can become very hot and cause burns. Particular attention has to be given where children and vulnerable people are present.**

When the appliance is in heating, make sure they don't lean on it and don't play nearby. Vulnerable and young children should not be left in the vicinity of the heater unless a suitable protective guard is fitted.

The normal cleaning is the responsibility of an adult who has read the instructions and understood the operation of the appliance.

Any other operation or technical intervention must

be performed by a qualified professional installer.

- **Warning:** In order to avoid a hazard for very young children, this appliance should be installed so that the lowest heated rail is at least 600 mm above the floor.



• **Suggestion, positioning, location**

**Before connecting up the electric towel rails to the mains power supply, switch off mains power at the main circuit breaker.**

The electric towel rails is a class II IP24 device, it can be installed in all the rooms of a house including in safety zone 2 and Out of Zone in bathrooms, but protected from splashing water.

The heating device must be installed in such a way that on-off switches and other control devices cannot be touched by a person located **in a bathtub or**

**- If the removal of the appliance is necessary, do not remove or refit the appliance onto the wall-mounting brackets without making sure it is cold and the main supply to the system is off.**

**in a shower cabinet** (in accordance with I.E.E. Wiring Regulations (BS 7671:2008)).

The electric towel rails must not be located immediately below a socket-outlet. The towel rails must be set up at least 15 cm from any obstacle (ie shelving, curtains, items of furniture, etc).

A means of disconnection mains supply capable of disconnecting all poles, having a contact separation of at least 3mm in accordance with local regulations and installation rules.

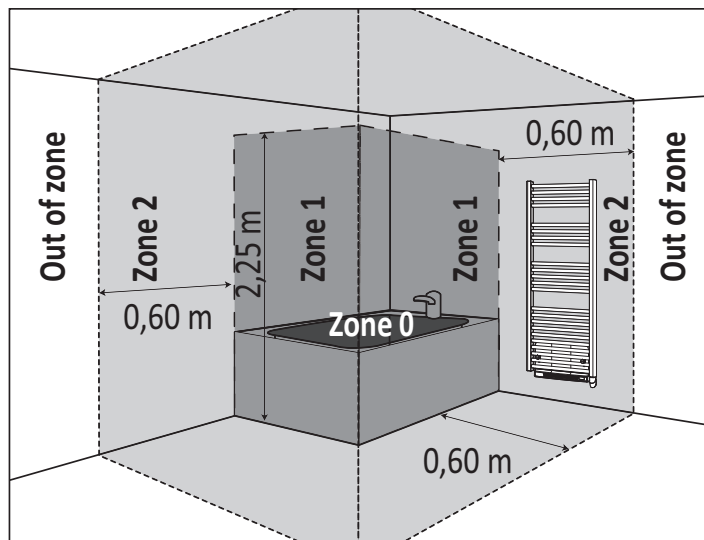

<b>Zone 0</b>	No electric heating device
<b>Zone 1</b>	
<b>Zone 2</b>	Electric heating device of class II and IPX4 protected by a differential circuit breaker 30mA.
<b>Out of zone</b>	Electric heating device of class I or II protected by a differential circuit breaker 30mA.

**This picture is only for your reference. In any case, the product must be installed by a qualified professional installer, according to applicable standards and directives of the country in which it is installed.**

**Locate the heater within minimum distances from obstacles.**

**Installation recommended** in the context of using automatic open window detection.

**Legend**

① = the favoured location

② = another location

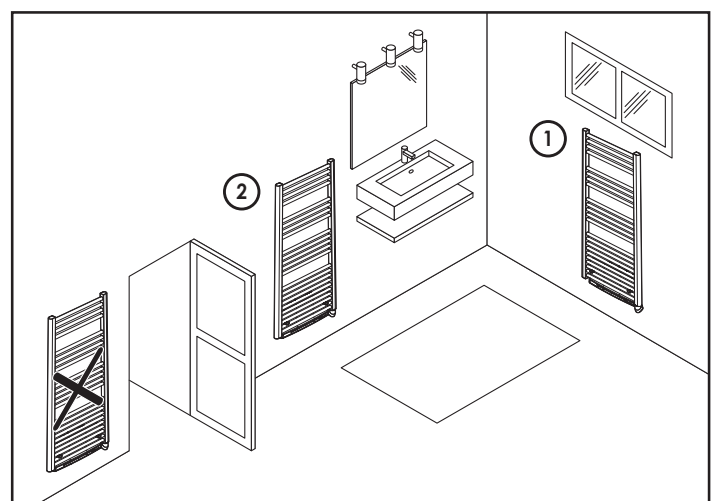

## CONNECTING, WALL-MOUNTING PROCEDURE

### • Connecting the device

All electrical installation work should be carried out by a suitably qualified Electrician or other competent person.

- The power supply of the device must have a mean of disconnection main supply capable of disconnecting all poles, having a contact separation of at least 3 mm in accordance with local regulations and installation rules, a protection by a 30mA differential switch and a protection device against overloads adapted to the characteristics of the connecting line.
- Before you first use the equipment, check that the voltage used does indeed match that listed on the device.
- This electric towel rails is a class II device (meaning that it has double electrical insulation). Connection to earth is prohibited.
- **The three wires** must be connected in an electrical connection box which complies with applicable standards.
- In accordance with European standards, the use of a plug to connect the equipment to a power socket is forbidden.

### - CONNECTING THE DEVICE

Monophase power supply 230V+/-10% - 50Hz.

 **You must insulate the pilot wire if it is not used. Do not connect the pilot wire (black) to ground.**

- Blue wire : Neutral
- Brown wire: Phase
- Black wire : Pilot wire

### • Positioning of wall-mounting brackets, tracing

**Important:** Leave a gap of at least 150 mm between the bottom part of the electric towel rails (under the controller) and the floor.

References	Power outputs (W)	A = Distance between lower and upper drill holes (mm)
TTS050B1A	500 + 1000*	462
TTS070B1A	700 + 1000*	840
TTS100B1A	1000 + 1000*	1218

\* PTC heating resistance with self-adaptive power of 850W to 1000W max. according to environment.

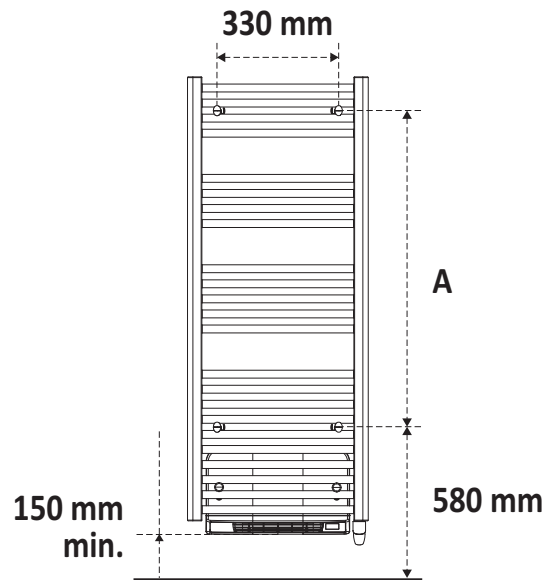

**Use the drilling template supplied to attach your towel rails to the wall.**

#### Stage 1

Open the template and position it against the wall, at the desired location.

Ensure that the bottom of the template touches the floor or the top of the skirting board, in order that the fitting height can be adjusted.



**Important:** in the presence of very young children, it is recommended that the template be positioned at least 30 cm above the floor.

#### Stage 2

Find the power of your electric towel rails and drill the corresponding holes into the wall.



#### Stage 3

Remove the template then screw the wall-mounting brackets of the electric towel rails into the wall.

**Important:** use a screw anchor which is suitable in relation to the wall type (screw and screw anchor not supplied).



See our video "How to install the wall-mounting brackets" by scanning the QR code with your smartphone.



## • Description of wall-mounting brackets

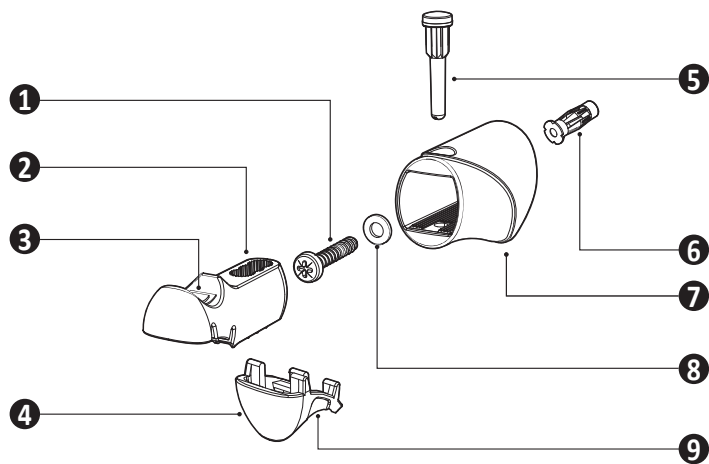

- 1 Fixing screw of the wall-mounting bracket  $\varnothing$  6mm max
- 2 Support
- 3 9 Compensator damper pad
- 4 Locking part
- 5 Pin
- 6 Screw anchor. **Important:** adapt the type of screw anchor to the nature of the partition wall (Example: plasterboard)
- 7 Sleeve
- 8 Washer

### 1- Mounting of the 4 patented wall-mounting brackets

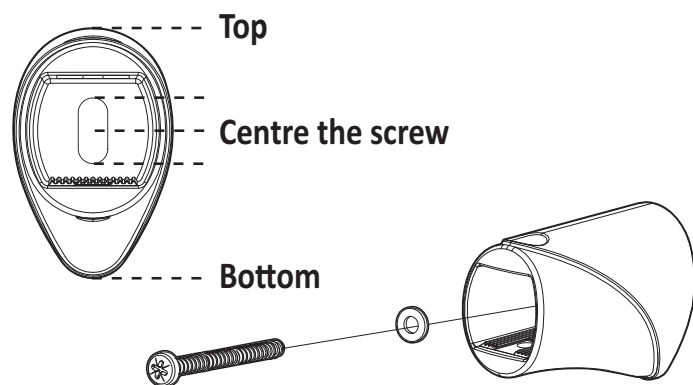

### 2- Insertion and setting the depth of the supports

#### 1- Insertion

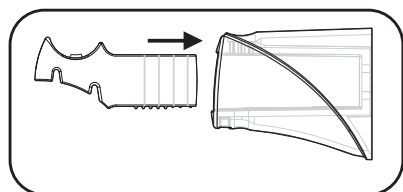

### 2- Setting of the depth

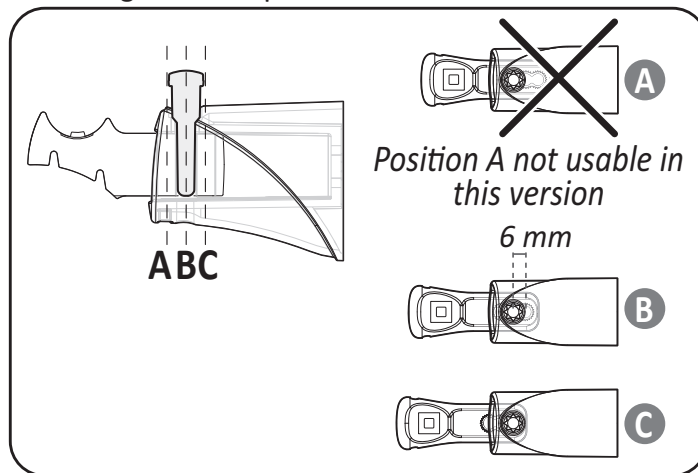

### 3- Locking

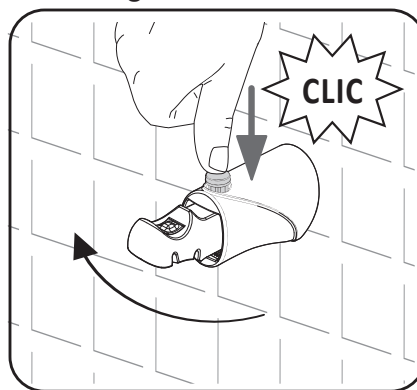

### 3- Setting up of the straight towel rails on the wall-mounting brackets

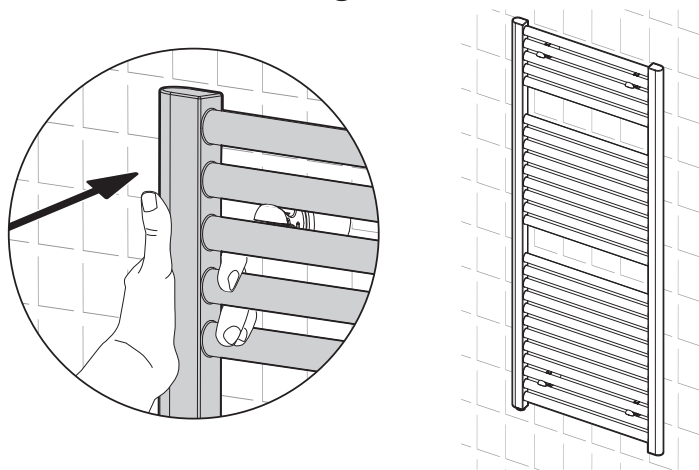

### 4- Locking of supports

Insert the locking parts (1 per support) making sure to position the notches in the 2 grooves located below the head of the mobile support.

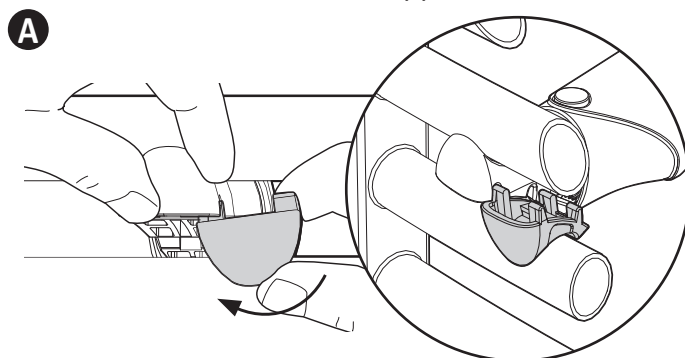

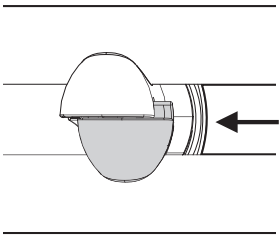
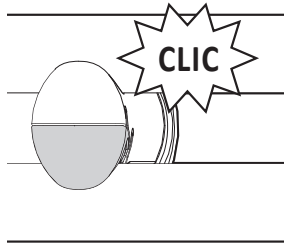
**B****C****Important :**

Each locking part (1) is equipped with a small pad in translucent silicone (2). This pad serves to counterbalance the assembly and the mounting tolerances. In some cases, if inserting the locking part is difficult, you may need to remove the small silicone pad to facilitate insertion.

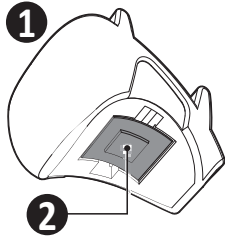

The towel rails is now secured and locked on its supports.

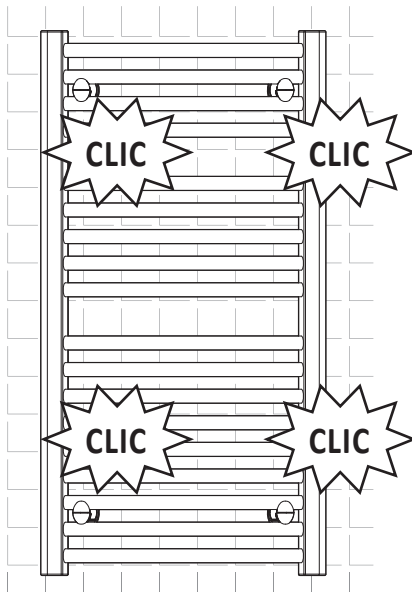
**Important:**

Before heating on, it is imperative to remove the protective caps located at the ends of the towel rails.

Indeed, these are exclusively intended to protect the angles of the device during transport.

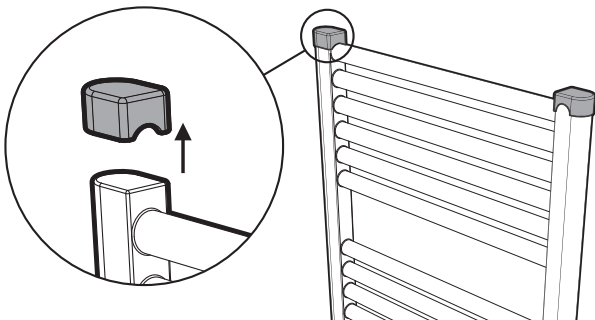

# OVERVIEW

Thank you for choosing one of our products we are confident that you will get many years of service.

Our range of electric towel rails with thermal fluid and digital controls with blower with innovative style was designed and developed to bring you the comfort of heating without maintenance and significant energy savings thanks to the + Pack: your Neomitis towel rails incorporates innovative technologies designed for your comfort and to increase your energy savings, control performance PID (stability), open window detection, 7 day and daily programme, optimization feature.

In new build or renovation applications, our products will provide you with comfort and satisfaction!

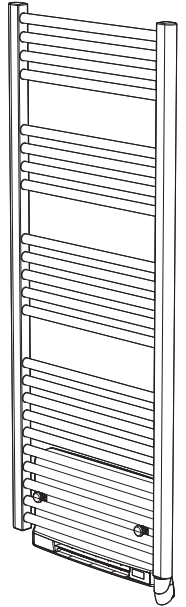

## BENEFITS

- A range of straight towel rails adapted to the dimension of your bathroom\*:

**3 powers :** 500W + 1000W\*, 700W + 1000W\* and 1000W + 1000W\*.

**3 heights :** 927, 1305 et 1683 mm.

**2 widths :** 508 et 558 mm.

\* Refer to table 24.

- **Patented innovation:**

The blower with integrated controller is protected by an European patent.

- **Extra-slim style, very thin blower, allowing:**

- to maintain a minimum distance between the towel rails and the wall, ideal for small spaces;
- to integrate harmoniously with the towel rails, the blower is almost invisible, the towel rails aesthetics is preserved.

- **Smart electronic controller:**

This means stable and accurate temperatures in your bathroom all year round by controlling 2 types of heating:

- **Ambient heating:** in comfort mode, heating the room through the towel rails and drying towels;
- **Instant additional heating:** for a rapid temperature rise, switching on or off the blower, instant heat.

- **Setting temperature can be viewed in all operating modes.**

- **Help for the visually impaired:**

The button power on/Heating standby mode is in relief to be easily identifiable to the touch.

- **Boost:**

Adjustable up 90 minutes, by 10 minutes step, increases the speed at which your bathroom heats up and also allows damp clothes and towels to dry quickly.

- **Super comfort feature:**

Additional instantaneous heating, the hot air blower enables automatic and swift room temperature increase, after an Eco phase, Frost protection or Stop by the means of a regulated heating on of the blower.

- **Easy to set:** the display have a white backlit for easy access and viewing. The interface is simple, straightforward and intuitive.

- **The Pack + features, assist in Energy Savings!**

- **Gauge consumption:** Automatic indication of the level of consumption according to the setting temperature.

- **Power consumption indication:** posting of the estimated amount of energy consumed in kWh since 24h or the last reset to 0 of the energy meter.

- **Open window detection:** Automatic switching to frost protection mode when the device detects a significant drop in temperature.



# OPERATING

## DIAGRAM

- **7 day and daily programme:** you have the option, for each day of the week, of assigning five different program profiles (P1, P2, P3, non-stop Comfort, non-stop Eco).

- **Dual optimization feature, allows you to optimize your programming by favouring comfort or savings:** Dependent on various parameters: inertia of the room, ambient temperature, desired temperature, seasonality, the device will calculate and optimize its programming for the periods of comfort and economy (Eco) depending on your preference:

- **Whilst in the OPTI ECO (priority to economy) mode,** the processors within the device will calculate the best compromise to guarantee maximum energy efficiency throughout the programmed periods of temperature variation (increase / decrease). This mode effectively accepts a slight reduction in the temperature levels both at the beginning and the end of the comfort periods, to maximize energy efficiency.

- **Whilst in the OPTI COMFORT (priority to comfort) mode,** the processors within the device will calculate the best compromise to guarantee maximum user comfort throughout the programmed periods of temperature variation (increase / decrease). This mode will look to anticipate and maintain the set comfort temperature during all detected periods of occupancy within the area.

- **Permanent dust filter:** easily accessible from the side of the towel rails, extractable by the left or right, it can be cleaned with a little water and a sponge, without disassembling the device.

- **Child anti-tamper:** The control panel can be locked, making changes impossible.

- **Special safety for social or private rental housing:**

- Limits of the adjustment range of the Comfort setting temperature.
- PIN code lock of settings reserved for professionals.

- **Safety overheating:**

- Immersion heater with dual safety:
  - Safety level 1: an integrated thermostat protects the towel rails against any temporary overheating ;
  - Safety level 2: an integrated thermofuse is triggered if the overheating itself extended beyond the authorized temperature limit.
- Ambient temperature limit during the Boost: when Boost is active, the towel rails must heat the room up to an ambient temperature limit. When it is reached, the Boost automatically stops.

- **Security anti-obstruction:**

In case of accidental blockage of ventilation grid or dust filter, the device switches to safety mode and the blower stops automatically.

- **Active memory:** Permanent backup of all settings and programming, backup date and time of 16hrs typical.

- **4 patented wall-mounting brackets:**

- Innovative style, transparent and discreet.
- Quick to install: up to 3 times less than a standard screw installation.
- Easy to install, towel rails is secured by wall-mounting brackets before locking.
- Setting of the depth ideal for renovation.
- Mechanical strength, high resistance to weight and heat.

- **Optional: RF remote control (separately sold):** supplied with a wall base or a table stand, you can remotely control Danais Neoboost.

- **Optional hangers (separately sold):** 2 ergonomics hangers fixed on the towel rails for easily hanging towels or bathrobes.

### Buttons overview

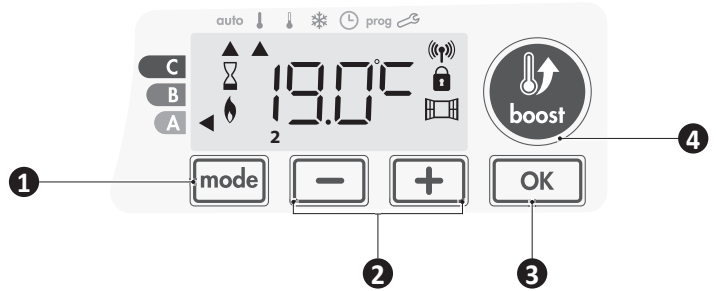

- 1 Selecting operating modes
- 2 Plus and minus buttons  
Used to set temperatures, time, date and programmes
- 3 Save settings
- 4 Boost

### Indicators overview

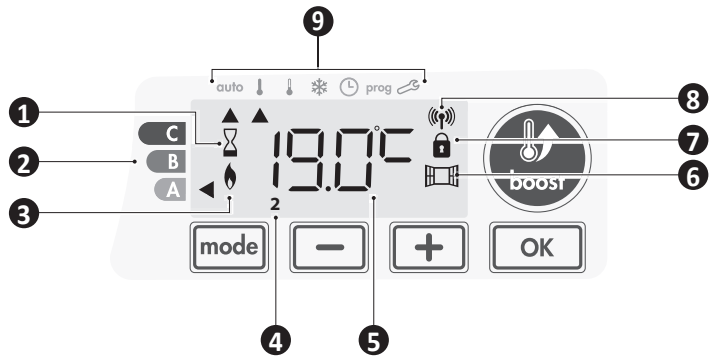

- 1 Boost indicator light
- 2 Gauge consumption
- 3 Heating indicator
- 4 Days of the week (1=Monday ... 7= Sunday)
- 5 Setting temperature
- 6 Open window detection indicator
- 7 Keypad locked
- 8 Radio transmission indicator
- 9 **Operation modes:**
  - auto Auto mode
    - ↓ Comfort mode
    - ↓ Eco mode
    - \* Frost protection mode
    - 🕒 Time and date setting mode
  - prog Programming mode
  - 🔧 Settings

**Important:** In Auto, Comfort, Eco and Heating standby modes, backlight turns off automatically after 20 seconds if no buttons are pressed. It will be necessary to reactivate it by pressing one of the keypad buttons before making settings.



#### Note:

Before carrying out any setting procedures, ensure that the keypad is indeed unlocked (voir page 11).



## POWER ON / HEATING STANDBY MODE

**Power on feature:** When this feature is first used, press the button (switch) so that it switches to the I located below the blower to put the device in operation.

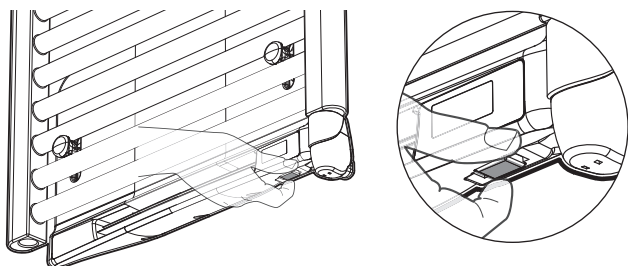

The device is in Auto mode, the Auto and Comfort modes are selected and the preset temperature appears.

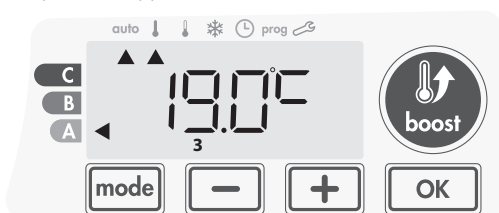

**Note :** The heating indicator light will come on only if the measured temperature is below the preset temperature. If the ambient temperature is below the set temperature by 2°C, the blower will switch ON (see page 10 Super comfort for further details).

**Standby feature:** Since the button (switch) is on I, press it to switch it to the other position.

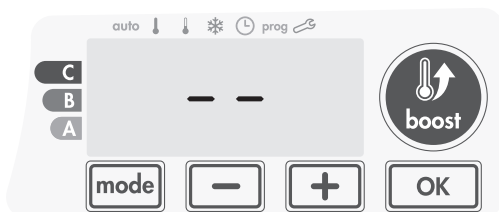
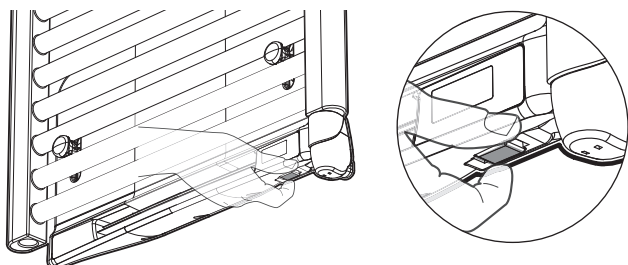

**Note:** The settings that are adjusted during operation are automatically saved and will be applied at the time of the next use.

**Example:** If the blower is in operation and you want to switch off the device, at the next putting into use, the Boost and the timer count will be restarted. The return to the selected mode before the Boost activation will apply a when the blower stops.



**Important:** Before carrying out any setting procedures, ensure that the keypad is indeed unlocked (see page 11).

## SELECTING THE OPERATING MODE

The **mode** button allows you to adapt the operating schedule of your device to your needs, depending on the season, whether your home is occupied or not. By pressing the **mode** button once or several times, select the required mode.



**Mode sequence:**

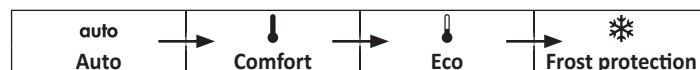

### Mode overview

### Display

#### • auto Auto Mode

In Automatic Mode, the device will automatically change from Comfort mode to Eco mode according to the established programme.



### 3 different cases depending on your set-up:

#### 1 7 day and daily programme

Your device has been programmed and is executing Comfort and Eco mode orders in line with the settings and time periods you have selected (see "7 day and daily programme integrated" chapter page 11).

#### 2 Programming by pilot wire

If you do not want to use the programming feature, your device's default setting is non-stop Comfort for 7 days a week, meaning you do not have to change any settings. Orders sent by the pilot wire will only be applied in Auto mode, thus your device will automatically receive and apply the programmed orders sent by your power manager or your time switches (see "Information about remote control by pilot wire" chapter page 14).

#### 3 Without programme

If the 7 day and daily programme is not enabled or no orders are being sent by pilot wire, then your device's factory settings mean that it will operate in non-stop Comfort mode, 7 days of the week.

#### • Comfort mode

Non-stop Comfort mode, the device will operate 24 hours a day to achieve the temperature which has been set (e.g. 19°C). The Comfort mode temperature level can be set by the user (see "Setting the comfort mode temperature" chapter page 11).



#### • Eco mode

Eco, which means the Comfort Mode temperature minus 3.5°C. This enables you to lower the temperature without having to reset the Comfort Mode temperature. Select this mode for short-term absences (between 2 and 24h) and during the night.



#### • Frost protection mode

This mode enables you to protect your home against the effects of cold weather (frozen pipes, etc.), by maintaining a minimum temperature of 7°C in it at all times.

Select this mode when you will be away from your home for a long time (more than 5 days).

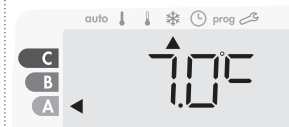

**Restoring factory settings:** See page 18 and 21.

## BOOST FEATURE

**Important:** the Boost mode can be enabled at any time, whatever the current operating mode (Auto, Comfort, Eco or Frost protection).



To activate Boost mode, press , the desired temperature setting will be set at maximum for the time period you request. 60 minutes will flash by default.

**Note:** if the heating indicator is switched on, the blower switches on and heats the room in addition to the heat emitted by the device.

### - First press: Boost.

During the first minute: the boost symbol and the heating indicator appear and the duration count flash.



During the first minute, you can modify the Boost duration from 0 to the maximal authorised duration of the Boost, such as defined during the advanced settings (see page 17 for more details) by intervals of 5 minutes (or more quickly by push superior to 2 seconds) by pressing  and . This modification will be saved and effective for the next Boost. After 1 minute, the Boost count begins and the time is running, minute by minute.

**Comment:** After 1 minute, you can modify temporarily the duration: it will be valid only for this active Boost and therefore non-recurring.

### The Boost can stop for 3 different reasons:

- An order "Stop" has been sent by your energy manager through the pilot wire:

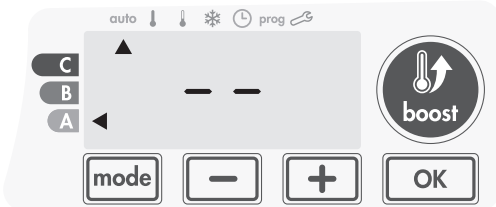

The blower stops, -- appears. The cursor moves above **auto**. When the order Comfort will be sent, the blower will be restarted until the count end.

- **FiLlE** appears on the display:



The blower continues to operate but does not heat up. Check if nothing is put in front of the ventilation grid to not block the air flow. The filter could be plug by dust, it must be cleaned (see page 24).

**Comment:** if the filter is obstructed or if the grid is covered involuntary, a special sensor switches off the blower heating. The normal operating of the device will start again at the next start-up, if the filter or the grid is not obstructed, and only after the blower has cooled down.

- If the ambient temperature reaches the maximal Boost temperature during the count:

The blower switches off but the Boost mode is always active: the count is always displayed, the Boost symbol and the heating indicator flash on the display. When the temperature drops under the maximal authorised temperature, the blower will be restarted until the count ends.

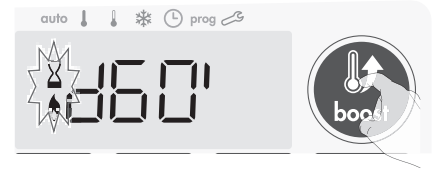

### - Second press = Boost cancellation.

The cursor moves above the previous active mode and the setting temperature appears.

## POST-VENTING

When the blower switches off, the venting continues to operate during few seconds to preserve and optimize the product life time.

Seconds appear and begin to count down, the keypad is inactive during the post-venting.



## SUPER COMFORT

The blower could be used as an instant additional heating in case of important difference between the ambient temperature and the setting temperature desired.

The Super Comfort switches on if the difference between the ambient temperature and the setting temperature is higher than 2°C.

The Super Comfort is enabled by default (see chapter User settings then the subchapter Super Comfort mode page 17).

**Example:** the device is in Eco set 17,5°C, you decide for a transition in Comfort mode: the difference between 21°C and 17,5°C is 3,5°C, so higher than 2°C. The blower starts up automatically to help the temperature increase and attain the 21°C requested.



The Boost symbol and the heating indicator appears on the display and the cursor above the selected mode will flash.

**SCF** and the setting temperature Super Comfort appears alternately on the display.

The Super Comfort stops if:

- The difference is less or equal to 0,5°C.

- The difference is always upper than 2°C after 1hr of Super Comfort.

**Comment:** the Super Comfort is valid in Comfort and Auto-Comfort mode only.





## PACK +: GAUGE CONSUMPTION, ENERGY SAVINGS

France's Agency for Environment and Energy Management (ADEME) recommends a Comfort setting temperature lower or equal to 19°C.

In the device display, a selector indicates the energy consumption level by positioning it in front of the colour: red, orange or green.



So, depending on the setting temperature, you can choose your level of energy usage. As the temperature setting increases, the consumption will be higher.

The gauge appears in Auto, Comfort, Eco and Frost protection modes and whatever the temperature level.

<p><b>C - Red colour</b> High Temperature level: it is advisable to significantly reduce the setting temperature.</p>	<p><b>Setting temperature &gt; 22°C</b> When the setting temperature is higher than 22°C</p>	
<p><b>B - Orange colour</b> Average temperature level: it is advisable to slightly reduce the setting temperature.</p>	<p><b>19°C &lt; Setting temperature ≤ 22°C</b> When the setting temperature is higher than 19°C and lower or equal to 22°C</p>	
<p><b>A - Green colour</b> Ideal temperature.</p>	<p><b>Setting temperature ≤ 19°C</b> When the setting temperature is lower or equal to 19°C</p>	

## SETTING THE COMFORT MODE TEMPERATURE

You can access the Comfort temperature set up from the Auto and Comfort Mode. It is preset to 19°C.

Using  and  you can adjust the temperature from 7°C to 30°C by intervals of 0.5°C.

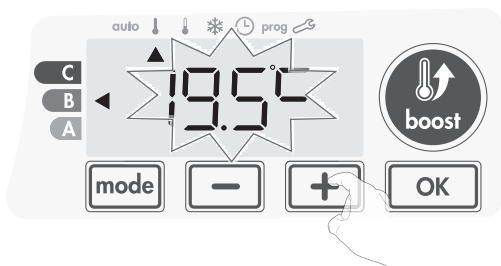

**Note:** you can limit the Comfort temperature, see page 17, Comfort setpoint temperature limit.

## PACK + : CONSUMPTION INDICATION ACCUMULATED IN KWH, ENERGY SAVINGS

It is possible to see the estimation of energy consumption in kWh since the last reset of the energy meter.

### • Display of the estimated power consumption

To see this estimation, from Auto, Comfort, Eco or Frost protection mode, then press .



To exit the display mode of consumption: press a button, the device is automatically in the previous active mode.

### • Resetting the energy meter

To reset the energy meter, from Auto, Comfort, Eco or Frost protection mode, then proceed as follows.



1- Press .

2- Press simultaneously  and  for more than 5 seconds.

To exit resetting the energy meter, press a button, the device is automatically in the previous active mode.

## CHILD ANTI-TAMPER, KEYPAD LOCK/UNLOCK

### • Keypad lock

To lock the keypad, press the  and  buttons and hold them down for 5 seconds. The padlock symbol  appears on the display, the keypad is locked.



### • Keypad unlock

To unlock the keypad, press the  and  buttons hold them down for 5 seconds again. The padlock symbol  disappears from the display, keypad is unlocked.

 **Important: when the keypad is locked, only the button (switch) is active.**

If the device is on Heating standby mode when the keypad is locked, you have to unlock it for the next heating on to access the setup.

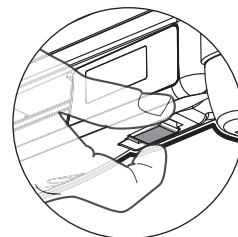

## PACK + : 7 DAY AND DAILY PROGRAMME INTEGRATED, ENERGY SAVINGS

In this mode, you have the option of programming your device, by setting one of the five programmes on offer for each day of the week.

### • Access to the programming mode

From Auto, Comfort, Eco or Frost protection mode, press  or 5 seconds to enter into the programming mode.

### Schematic sequence of programming settings:



### • Setting day and time

In this mode, you can set day and time to program your device in line with your needs.

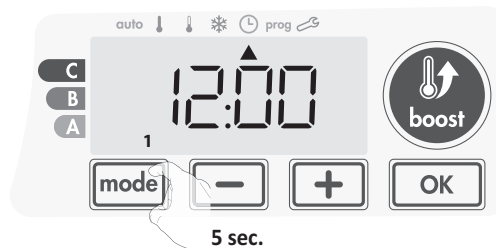

1- From Auto, Comfort, Eco or Frost protection mode, press  for 5 seconds.

The cursor moves to the setting day and time mode.



2- Select using  or .

The two hour figures will flash.

The hours will scroll quickly, if you press the  or  and hold them.



Save by pressing .

3- The two minute figures will flash.

Select using **-** or **+**.

Save by pressing **OK**.

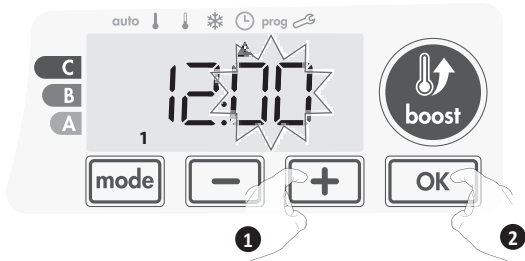

4- The cursor above the number 1 (which represents the Monday) will flash.

Select the date using **-** or **+**.

Save by pressing **OK**.

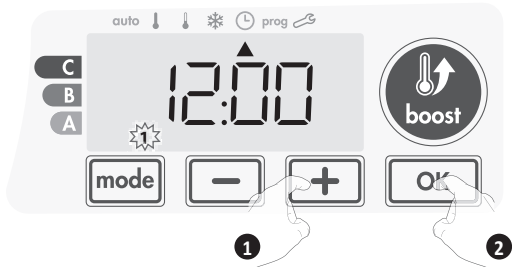

5- To change and/or allocate programmes press **mode**. To exit the setting time and day mode, press **mode** 3 times.

### ● Choices programmes

Schematic sequence of programmes:

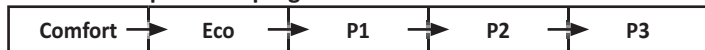

Your device's default setting is non-stop Comfort for 7 days a week.

### ● Programmes overview

- **Comfort:** your device will operate in Comfort mode, 24 hours a day, as regards each day selected.

**Note:** You can set the Comfort mode temperature to the temperature you require (see the Setting the Comfort mode temperature section page 11).

- **Eco:** The device will operate 24 hours a day in Eco mode.

**Note:** You can set the temperature-lowering parameters (see Setting the eco mode temperature lowering-level page 16).

- **P1:** your device will operate in Comfort mode from 06:00 to 22:00 (and in Eco mode from 22:00 to 06:00).

- **P2:** your device will operate in Comfort mode from 06:00 to 09:00 and from 16:00 to 22:00 (and in Eco mode from 09:00 to 16:00 and from 22:00 to 06:00).

- **P3:** your device will operate in Comfort mode from 06:00 to 08:00, from 12:00 to 14:00 and from 18:00 to 23:00 (and in Eco mode from 23:00 to 06:00, from 08:00 to 12:00 and from 14:00 to 18:00).

### ● Potential modifications of programmes

If the default time schedules for the P1, P2 and P3 programmes does not suit your routines, you can change them.

**Modifying the P1, P2 or P3 programmes.**

If you modify the time schedules for the P1, P2 or P3 programmes, the schedules will be modified for all the days of the week for which P1, P2 or P3 had been set.

1- If you just set the time and day, go to step 2.

From Auto, Comfort, Eco or Frost protection mode, press **mode** for 5 seconds.

When the cursor moves above the setting time symbol ⌚, press **mode** shortly.

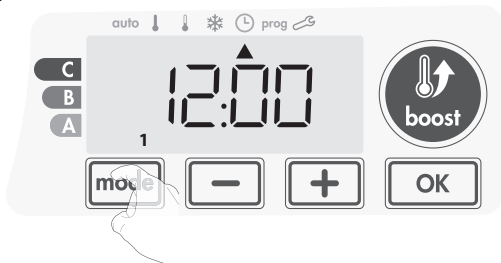

2- Press **-** or **+**. The cursor moves above prog.

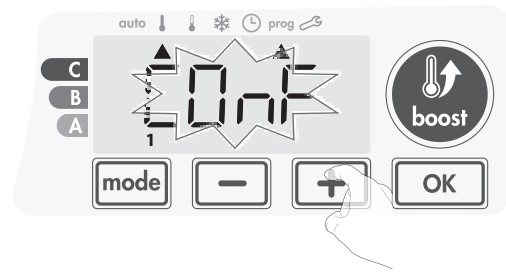

3- With **-** or **+**, select P1.

P1 will flash. Press **OK** for 5 seconds.

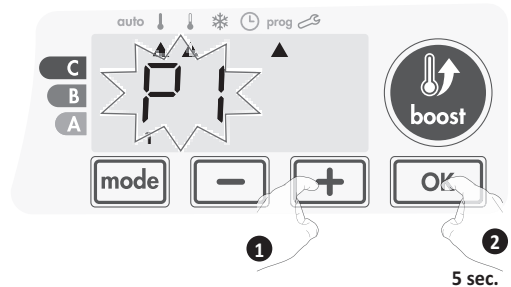

4- The P1 start time (which by default is 06:00) will flash.

Using **-** or **+**, you can change this time, by increments of 30 minutes.

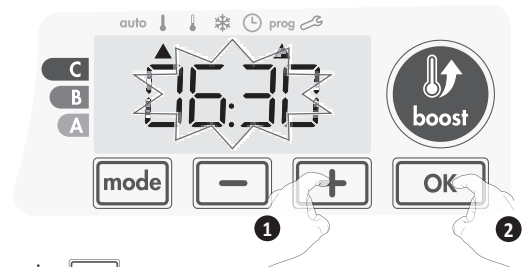

Save by pressing **OK**.

5- The P1 end time (which by default is 22:00) will flash. Using **-** or **+**, you can change this time, by increments of 30 minutes.

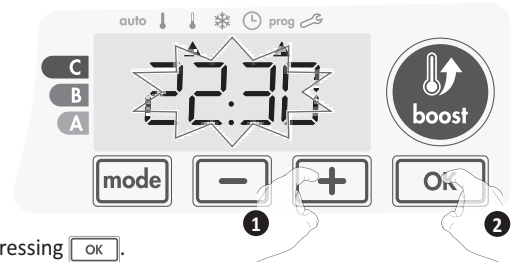

Save by pressing **OK**.

6- Press **mode** to exit the programming Mode and return to Auto Mode.

**Note:** without action on the keys, it will return to Auto after a few minutes.

### ● Choices and allocation programmes

**Prior information:**  
Display area



Correspondence days / numbers	
Monday	1
Tuesday	2
Wednesday	3
Thursday	4
Friday	5
Saturday	6
Sunday	7

- 1- If you just set the time and day, the cursor moves automatically under PROG.

From Auto, Comfort, Eco or Frost protection mode, then press **[mode]** for 5 seconds. When the cursor positioned under the set time symbol ⌚, press **[mode]** again.

The days of the week will scroll on display with the programmes that you set for them, meaning Comfort **CONF** every day.

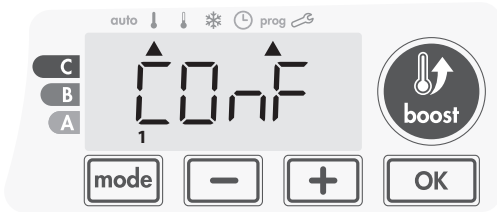

- 2- Press **[-]** or **[+]**.

The programme set for day 1 (1= Monday, 2 = Tuesday, etc.) will flash.

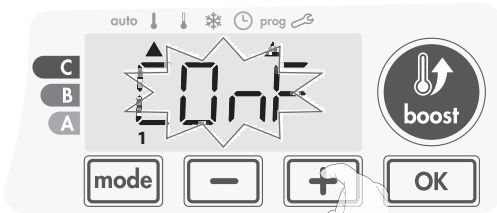

- 3- Choose the programme you want for this day with **[-]** or **[+]**. Save by pressing **[OK]**.

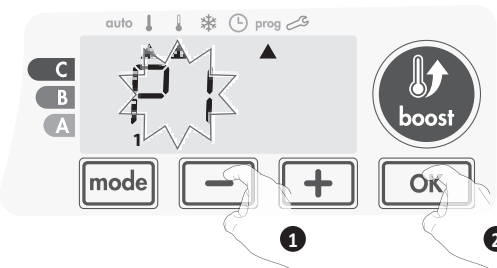

- 4- The programme assigned to the second day of the week (Tuesday) will flash. Repeat the procedure described previously (in point 3) for each day of the week.

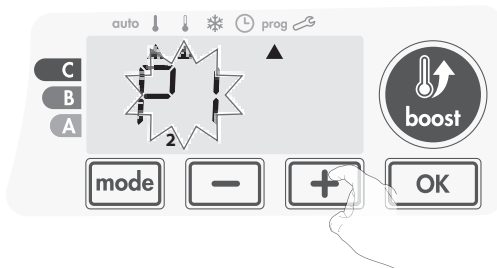

- 5- Once you have chosen a programme for each day, confirm your selection by pressing **[OK]**. The days of the week will successively scroll on display with the programmes that you set for them (P1, P2, P3, CONF or ECO). To exit the Programming mode, press **[mode]** twice.

### ● Viewing the programmes that you have selected

- From Auto, Comfort, Eco or Frost protection mode, press **[mode]** for 5 seconds. Press **[mode]** twice, the programme for each day of the week (Comfort, Eco, P1, P2 or P3) will scroll on display in front of you.
- To exit the programme viewing mode, press **[mode]** twice.

### ● Manual and temporary exemption from a running programme

This function allows you to change the setting temperature temporarily until the next scheduled change in temperature or the transition to 0:00.

### Example:

- 1- The device is in Auto mode, the running programme is Eco 15,5°C.

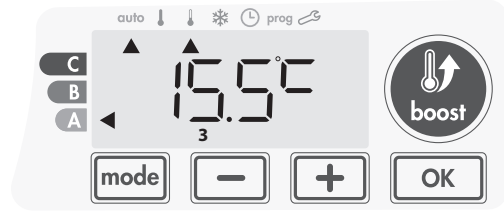

- 2- By pressing **[-]** or **[+]**, you can change temporarily the desired temperature up to 18°C for example.

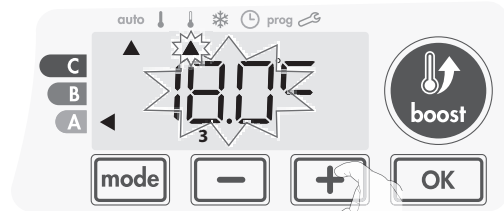

**Note:** The cursor corresponding to the operating mode, i.e Eco mode in our example, is blinking during the duration of the temporary derogation.

- 3- This change will be automatically cancelled at the next change of programme or transition to 0:00.



## PACK + : OPEN WINDOW DETECTION, ENERGY SAVINGS

### ● Important information about the open window detection

**Important:** the open window detection is sensitive to temperature variations. The device will react to the window openings in accordance with different parameters: temperature setting, rise and fall of temperature in the room, outside temperature, location of the device...

If the device is located close to a front door, the detection may be disturbed by the air caused by opening door. If this is a problem, we recommend that you disable the automatic mode open window detection (see page 19). You can, however, use the manual activation (see page 14).

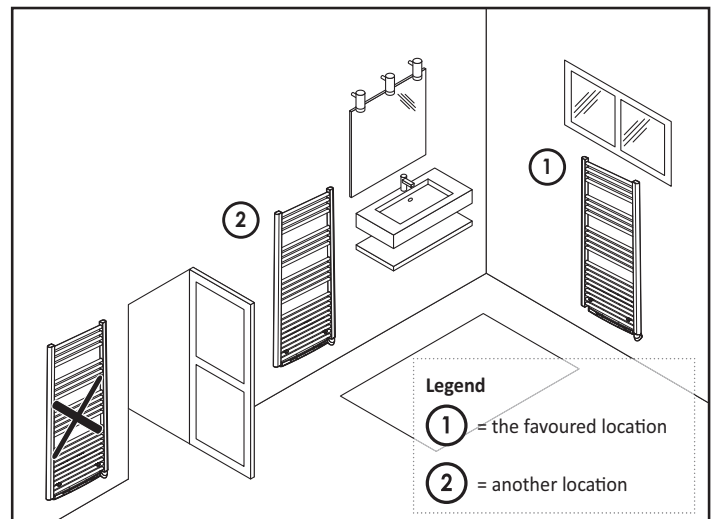

## ● Overview

Lowering temperature cycle by setting frost protection during ventilation of a room by opened window. You can access the open window detection from the Comfort, Eco and Auto modes. Two ways to enable the detector:

- **Automatic activation**, the lowering temperature cycle starts as soon as the blower detects a temperature change.
- **Manual activation**, the cycle of lowering temperature starts by pressing a button.

## ● Automatic activation (factory settings)

To disable this mode, see page 19.

The device detects a temperature fall. An open window, a door to the outside, can cause this temperature fall.

**Note:** The difference between the air from the inside and the outside must cause a significant temperature fall to be perceptible by the device.

This temperature drop detection triggers the change to Frost Protection mode.

## ● Manual activation

By pressing  for more than 5 seconds, the device will switch on Frost protection mode.

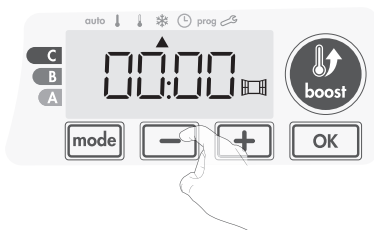

## ● Frost protection digital meter

When the device performs a lower temperature cycle due to open window, a meter appears on the display to show the cycle time. The counter is automatically reset at the next time to Frost protection by opened window (automatic or manual activation).

## ● Stop the Frost protection mode

By pressing one button, you stop the Frost protection mode.

**Note:** if a temperature rise is detected, the device may return to the previous mode (active mode before the open window detection)

# INFORMATION ABOUT REMOTE CONTROL BY PILOT WIRE

## ● Overview

Your device can be controlled by a central control unit through a pilot wire, in which case the different operating modes will be remotely enabled by the programmer. You can only control the device by pilot wire in the Auto mode. In the other modes, the orders transmitted by the pilot wire will not be executed.

In general, a pilot wire control system makes it possible to impose externally a lowering of the temperature setpoint, combined with the internal programming.

If several lowering requests appear simultaneously, priority is given to the lowest temperature setpoint, thus maximizing savings (see opposite information on priorities for different modes).

When a signal is sent from the pilot wire, the self learning optimization function is suspended.

Below the different views of the display for each order sent by pilot wire:

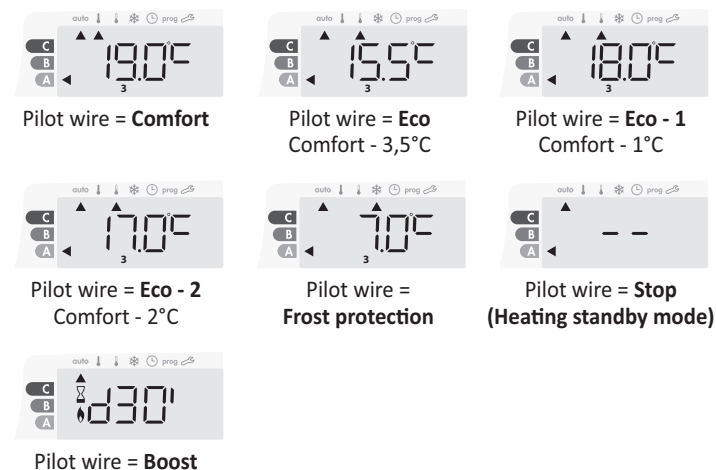



## ● Exemption to an order coming from a pilot wire external programmer

This feature allows you to modify temporarily the setting temperature until the next order sent by the central control unit or the transition to 00:00.

**Example:**

- 1- The device is in Auto mode. The central control unit sent an Eco order 15,5°C.



- 2- By pressing  or , you can modify temporarily the setting temperature up to 18°C for example.

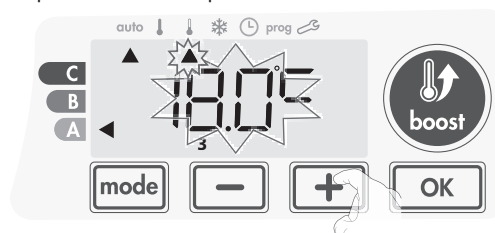

**Note:** The cursor corresponding to the operating mode, i.e Eco mode in our example, is blinking during the duration of the temporary derogation.

- 3- This modification will be automatically cancelled at the next order sent by the central control unit or the transition to 00:00.

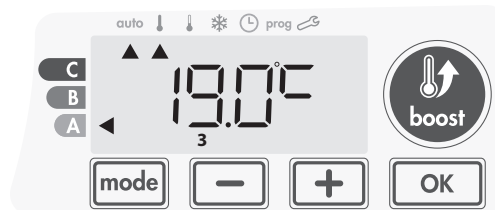

## INFORMATION ABOUT PRIORITIES BETWEEN THE DIFFERENT MODES

### ● Principe

In **Comfort, Eco and Frost protection modes**, only orders of the open window sensor will be considered.

In **Auto mode**, the device can receive different orders coming from :

- 7 day and daily programming integrated (Comfort or Eco orders);
- 6-order pilot wire if connected to central control unit;
- Open window detector;

In general, it is the lowest received order which prevails except when the pilot wire is connected to an energy management system, in this case the orders of the pilot wire take priority.

- If an open window is detecting, switching to frost protection takes precedence unless a load shedding order is present on the pilot wire.
- The Boost activation will take precedence over others orders received except when the standby (stop) order is present on the pilot wire, the device will switch off and the Boost will be not activated.

### ● Examples

- + 7 day and daily programming = Comfort
- + Pilot wire 6 orders = Eco

### = Eco



- + 7 day and daily programming = Comfort
- + Pilot wire 6 orders = Eco
- + Open window detector = Frost protection

### = Frost protection



## OPTIONAL: REMOTELY MANAGEMENT BY RF REMOTE CONTROL

### ● Overview

Your device can be managed by a wireless RF remote control.

Only the RF pairing procedures to operate on the controller are described in this instructions manual.

For installing and using the remote control, refer to its instructions manual.

### ● RF pairing between the remote control and the blower

The remote control and the blower are not bonded together at the factory, then proceed as follow:

- 1- From Frost protection mode, press **OK** for 5 seconds.

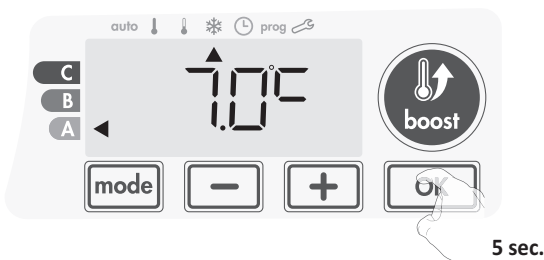

- 2- Your device is in pairing mode. Then proceed to the remote control pairing (refer to its installing and using instruction manual).

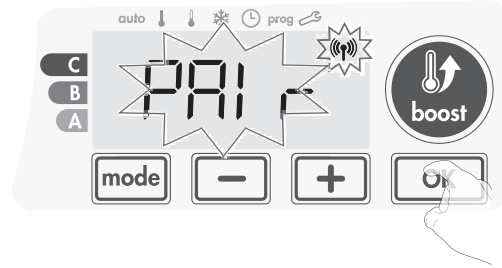

- 3- When both device and remote control are linked, the symbol appears and is constantly displayed. The device returns automatically to the frost protection mode: your device can be remotely controlled by the remote control.



### ● Check the RF signal strength

You can check at any time the RF transmission performance between your device and the remote control.

To view the RF reception level, from Frost protection mode, press **+** for 5 seconds. Then the level appears on the display.

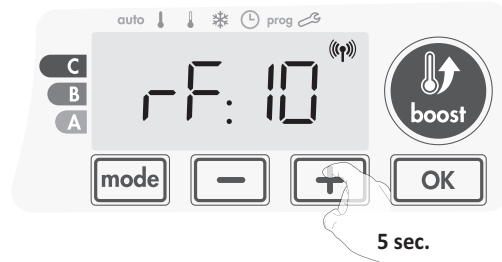

### 1 = Low RF transmission level:

To improve the RF transmission performance between the 2 devices and ensure the remotely management is optimized:

- Please ensure the RF transmission is not interrupted, move the remote control.
- Move the remote control closer to the blower.

### 10 = High RF transmission level, the location of the remote control is optimized.

### ● RF pairing cancellation

You can cancel at any time the RF transmission between the blower and the remote control.

From Frost protection mode press simultaneously on **-** and **mode** for 5 seconds.

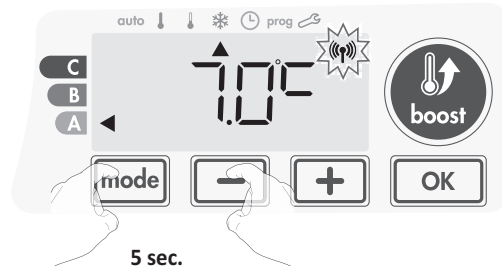

The symbol disappear from the display, the remote control and the device are not associated.





# USER SETTINGS

## ACCESS

You access to User settings in 3 steps:

From Auto, Comfort, Eco or Frost protection mode :

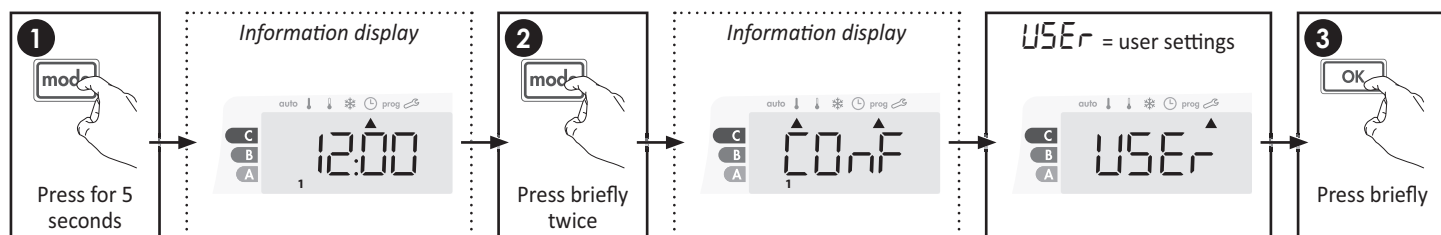

### Setting sequence:

Backlighting → Eco mode temperature lowering-level → Frost protection temperature → Super comfort → Comfort setting temperature limit → Maximal Boost duration → Maximum ambient temperature

## BACKLIGHT SETTING

1- Three modes can be set:

- L1 = Temporary backlighting: Backlight of the display when a button is pressed.
- L2 = Non-stop backlighting: Backlight of the display all the time.
- L3 = In this version, the device will work according to the L1 mode.

L3 mode is the default setting.

Press **-** or **+** to choose the setting you require.

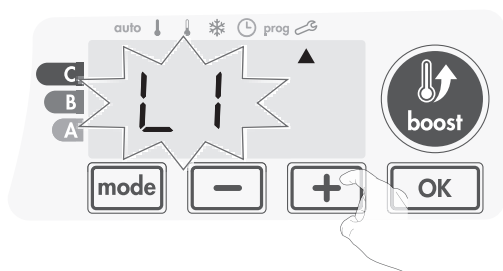

2- Press **OK** to save and move to the next setting.

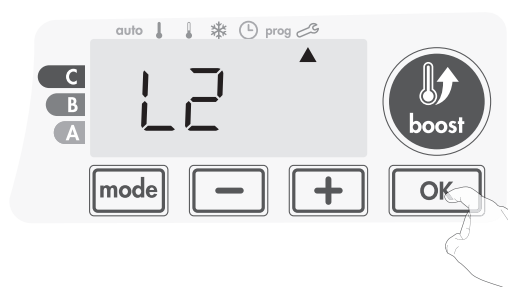

To exit the user settings, press **mode** twice.

## SETTING THE ECO MODE TEMPERATURE LOWERING-LEVEL

The drop in temperature is set at -3.5°C compared to the set temperature of the Comfort mode. You can adjust the lowered level from -1°C to -8°C, by intervals of 0.5°C.

**Important:** whatever the lowering level set, the Eco setting temperature will never exceed 19°C.

3- Press **-** or **+** to obtain the temperature level you require.

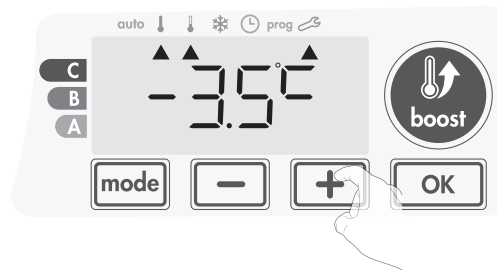

4- Press **OK** to save and move to the next setting.

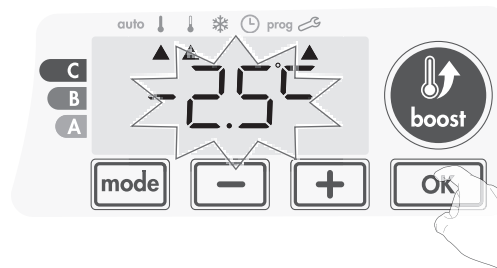

To exit the user settings, press **mode** twice.

## SETTING THE FROST PROTECTION TEMPERATURE

Your device is preset at 7°C. You can adjust the Frost protection temperature from 5°C to 15°C, by intervals of 0.5°C.

5- Press **-** or **+** to obtain the temperature you require.

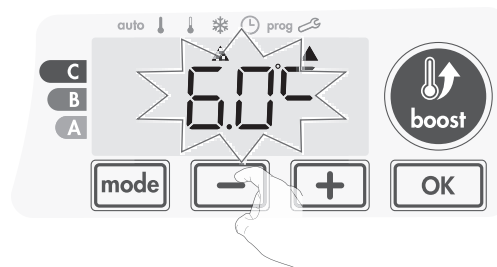

6- Press **OK** to save and move to the next setting.  
To exit the user settings, press **mode** twice.

## SUPER COMFORT - ACTIVATION/ DEACTIVATION

By default, the Super comfort is enabled.

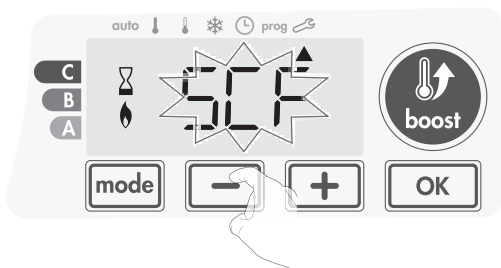

SCF flashes, then YES appears on the display. The Boost symbol and the heating indicator appear on the display.

7- Press **-** or **+** to enable or disable the Super comfort.



YES = Super Comfort enabled.

NO = Super Comfort disabled.

8- To save and move automatically to the next setting, press **OK**. To exit the user settings, press **mode** twice.



## PACK + : COMFORT SETPOINT TEMPERATURE LIMIT, ENERGY SAVINGS

You can limit the setting temperature range by introducing a maximum and/or minimum setting, preventing unintentional changes in temperature.

### • Low temperature limit

Locking of the setting range using a minimum temperature stop, preventing the temperature from being set below that temperature.

The minimum setting is preset to 7°C. You can adjust from 7°C to 15°C by intervals of 1°C.

9- To change the minimum temperature setting, press **-** or **+** then save by pressing **OK**.

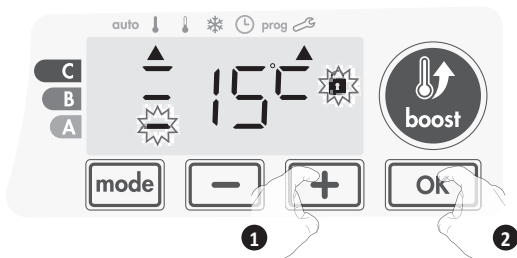

If you do not want to change it, press **OK**: the device proposes automatically to set the maximum setting. To exit the user settings, press **mode** twice.

### • High temperature limit

Locking of the setting range using a maximum temperature increase, preventing the temperature from being set above that temperature.

The maximum setting is preset to 30°C. You can adjust from 19°C to 30°C by intervals of 1°C.

10- To change the maximum temperature setting, press **-** or **+**.

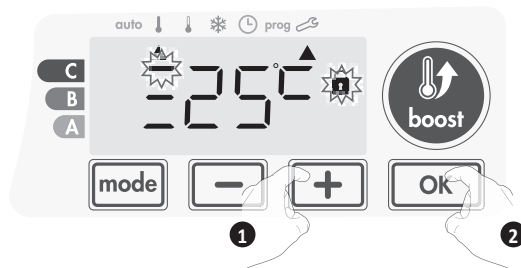

To save and move automatically to the next setting, press **OK**. To exit the user settings, press **mode** twice.

## SETTING OF THE MAXIMUM DURATION OF AUTHORISED BOOST

The maximum duration of Boost is preset at 60 minutes. You can adjust it from 30 to 90 minutes by intervals of 30 minutes.

11- The Boost symbol and the heating indicator appear on the display and the preset duration of 60 minutes flash.



12- Press **-** or **+** to display the desired duration.

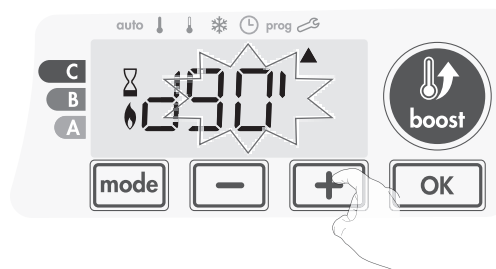

13- To save and move automatically to the next setting, press **OK**.

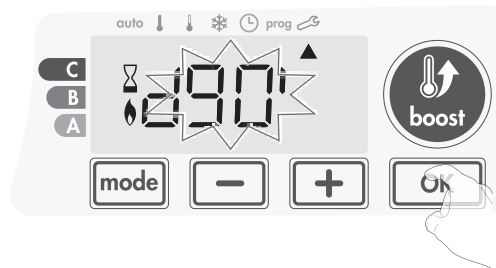

To exit the user settings, press **mode** twice.

## SETTING OF THE MAXIMUM AMBIENT TEMPERATURE FOR THE AUTOMATIC STOP OF THE BOOST

When the Boost is enabled, the blower has to heat the room until the temperature limit: the maximum ambient temperature. When it is reached, the Boost stops automatically.

It is preset at 35°C, you can adjust it from 25°C to 39°C by intervals of 1°C.

The Boost symbol and the heating indicator appear on the display and the maximum temperature flashes.

14- You can set the Boost maximum temperature by pressing or from 25°C to 39°C by intervals of 1°C.

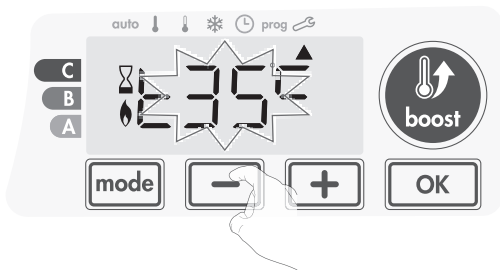

15- To save and move automatically to the next setting, press . To exit the user settings, press twice.

## RESTORING FACTORY SETTINGS

In order to a coming back to factory settings, proceed in the following order:

1- From the setting of the temperature unit, press . *rest* appears on the display.



2- *no* appears. Press or to select *yes*.

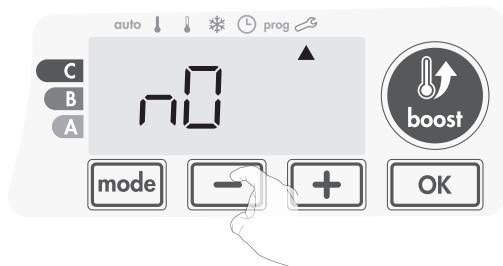

*yes* = Factory settings reset

*no* = Factory settings not reset

3- Press for 5 seconds. The device returns to its initial configuration and goes back automatically to the home display of the user settings.

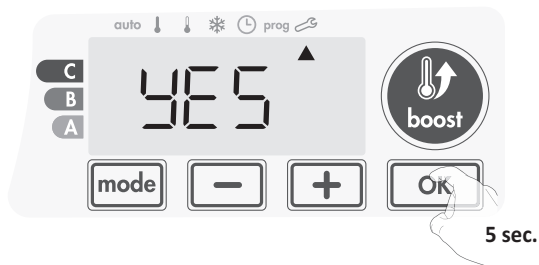

The following factory values will be effective:

Parameters	Factory settings
<b>Operating</b>	
Comfort setting temperature	19°C
Boost duration	60 min.
Keypad lock	Disabled

Parameters	Factory settings
<b>User settings</b>	
Backlighting	L3
Eco mode temperature lowering-level	-3,5°C
Frost protection temperature	7°C
Super Comfort	Enabled
Minimum set of Comfort setting temperature	7°C
Maximum set of Comfort setting temperature	30°C
Maximal Boost duration	60 min.
Maximum ambient temperature for the automatic stop of the Boost	35°C

Press to exit the user settings.



# INSTALLER SETTINGS

## ACCESS

You access to User settings in 4 steps:

From Auto, Comfort, Eco or Frost protection mode :

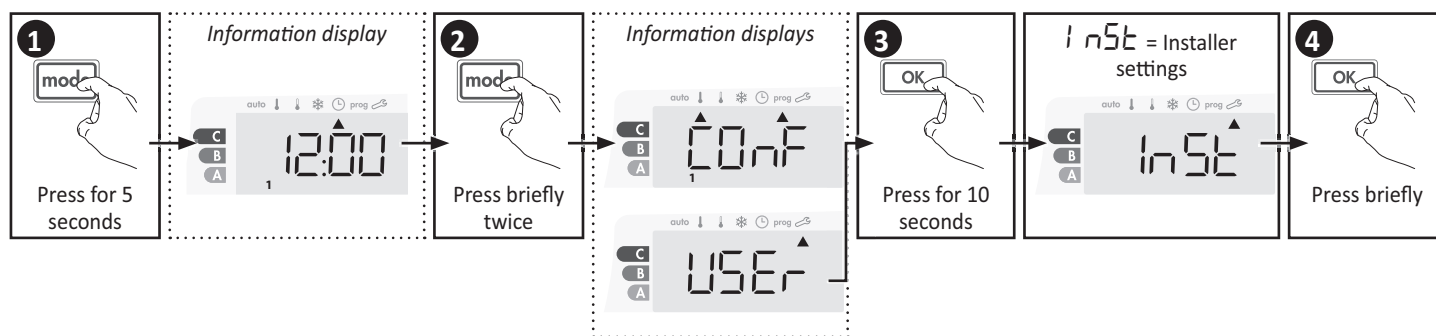

### Setting sequence:

Open window detection → Dual optimization feature → PIN code lock → Restoring factory settings

## OPEN WINDOW DETECTION, ACTIVATION/ DEACTIVATION OF THE AUTO MODE

The automatic mode enabled is the default setting.

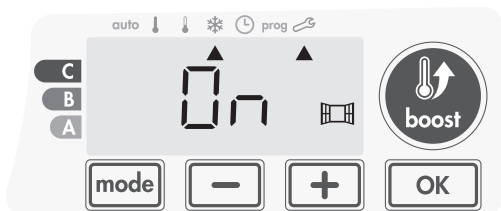

1- Press **-** or **+**.

**On** = automatic mode enabled.  
**OFF** = automatic mode disabled.

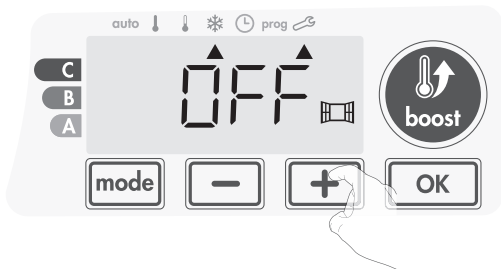

2- To save and move automatically to the next setting, press **OK**. To exit the user settings, press **mode** 3 times.

## DUAL OPTIMIZATION FEATURE

### ● Overview

- **Dual function optimization, priority to comfort or energy savings, the choice is yours:** Depending on various parameters: room inertia, ambient temperature, desired temperature, the device calculates and optimizes the programming for each heating period whether set to Comfort or Savings (Eco):

- **In OPTI ECO mode (efficiency priority),** the devices inbuilt algorithms will calculate the best compromise in order to guarantee maximum energy savings throughout the programmed increase and decrease phases. In this mode, a slight drop in the temperature level at the beginning and end of the comfort period is allowed to maximize energy savings.

- **In OPTI COMFORT mode (priority to comfort),** the device intelligence calculates the best compromise in order to guarantee maximum comfort during the programmed increase and decrease phases. In OPTI COMFORT mode, the priority is given to anticipating and maintaining the comfort temperature during periods of detected occupancy.

### ● Optimization choice

The **OPTI COMFORT** mode is activated by default.

The word **Opti** will appear briefly on the display then it will alternate with the set mode **CONF**, **ECO** or **OFF**.

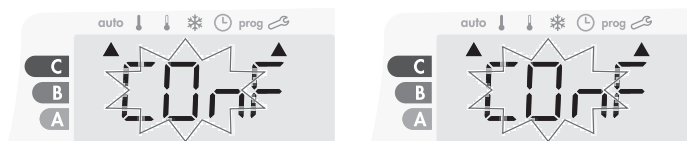

1- Press **-** or **+**.

**CONF** = Optimisation feature activated for OPTI COMFORT mode, priority to comfort.

**ECO** = Optimisation feature activated for OPTI ECO mode, priority to energy efficiency.

**OFF** = Optimisation feature deactivated.

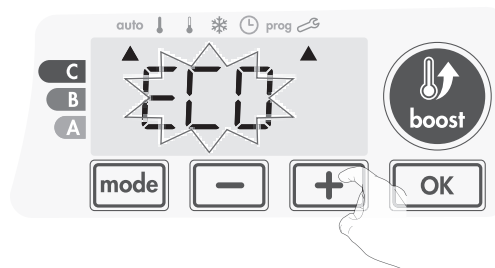

2- To save and move automatically to the next setting, press **OK**. To exit the installer settings, press **mode** 3 times.

## PIN CODE LOCK

### ● Overview

Your heating device is protected by a safety code against unauthorised use. The PIN code (Personal Identity Number) is a customisable 4 numbers code. When enabled, it prevents access to the following settings:

- Selecting the Comfort mode : The access to the Comfort mode is forbidden, only the Auto, Eco and Frost protection modes are available.
- Minimum and maximum limits of the setting temperature range (the Comfort temperature modification is forbidden out of the authorised setting range).

- Programming mode.
- Open window detection settings.
- Setting the Eco mode temperature lowering-level.
- Setting the Frost protection temperature.
- Optimization choice.

3 important steps are needed for the first use of the PIN code lock:

- 1 - PIN code initialisation**, enter the preset PIN code (0000) to access to the feature.
- 2 - Activation of the PIN Code** to lock settings which will be protected by the PIN code.
- 3 - Customizing the PIN code**, replace 0000 by the customized code

### ● PIN code initialisation

By default, the PIN code is not enabled. *OFF* appears on the display.

- 1- By default registered PIN code is 0000.

Press **-** or **+** to select 0. It is blinking. Save by pressing **OK**.

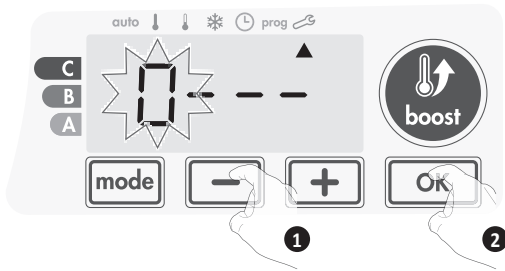

- 2- For others numbers, select 0 by press **OK**.

When 0000 appears, press on **OK** again to save.

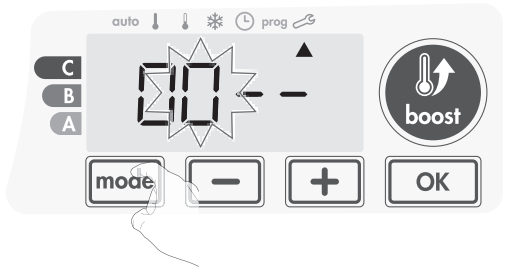

The PIN code is initialized, the next setting automatically appears: PIN Code activation.

### ● Activation/deactivation of the PIN Code

- 1- *OFF* appears on the display.

Press **-** or **+** to enable PIN code.

*On* appears on the display.

*On* = PIN code enabled

*OFF* = PIN code disabled

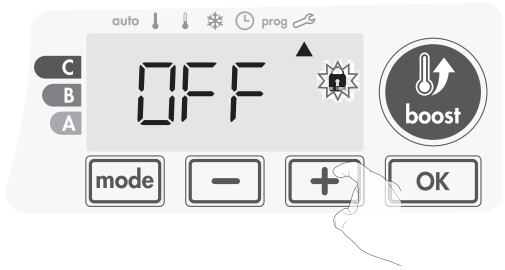

- 2- Press **OK** to save and return to the home installer settings display.

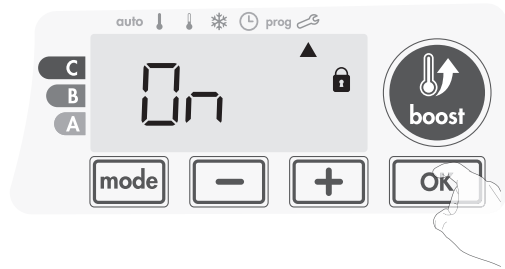

The PIN code is enabled. Any modification of reserved settings listed in "Overview" is now impossible.

### ● Customizing the PIN code

If you have just activated the PIN code, follow the stages described below. Alternatively, you must copy the steps 1 and 2 of the initialisation process as well as the steps 1 and 2 of the activation process before personalising the PIN code.

Please remember that the personalisation of the PIN code can only be set once the initialisation and activation of the PIN code has been completed.

- 1- When *On* appears, press **OK** for at least 5 seconds.

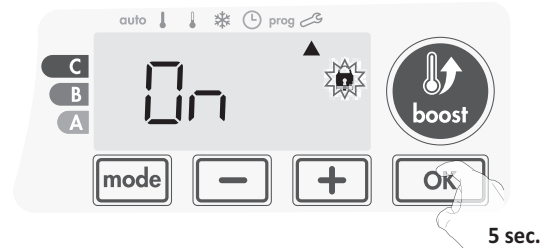

- 2- The 0000 code appears and the first number blinks. Press **-** or **+** to select the first desired number then press **OK** to save. Repeat this operation for remaining 3 numbers.

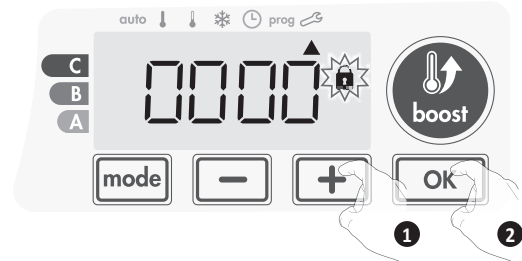

- 3- Press **OK** to confirm. The new code is now saved.



- 4- Press again on **OK** to exit setting PIN code mode and go back to the home display of the installer settings.



To exit the Installer settings, press **mode** twice.

## RESTORING FACTORY SETTINGS

If the PIN code protection is disabled, the user and installer settings are re-initialized:

- From the PIN code setting, press **OK**. *rEST* appears briefly on the display.



- nO* appears. Press **-** or **+** to select *YES*.

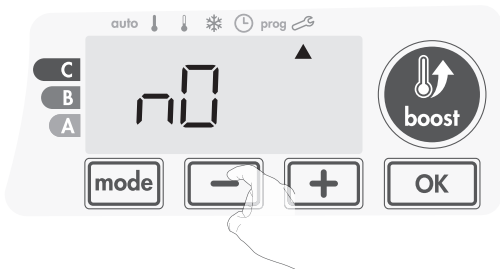

*YES* = Factory settings reset  
*nO* = Factory settings not reset

- Press the key **OK** for 5 seconds. The device returns to its initial configuration and goes back automatically to the home display of the installer settings.

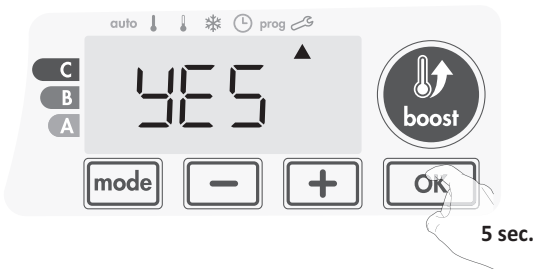

The following factory values will be effective:

Settings	Factory settings
<b>Operation</b>	
Comfort setting temperature	19°C
Boost duration	60 min.
Keypad lock	Disabled
<b>User settings</b>	
Backlighting	L3
Eco mode temperature lowering-level	-3,5°C
Frost protection temperature	7°C
Super Comfort	Enabled
Minimum set of Comfort setting temperature	7°C
Maximum set of Comfort setting temperature	30°C
Maximal Boost duration	60 min.
Maximum ambient temperature for the automatic stop of the Boost	35°C
<b>Installer settings</b>	
Automatic open window detection	Enabled
Dual optimization feature	Opti comfort
PIN code protection	Disabled
Value of the PIN code	0000

To exit the installer settings, press **mode** twice.



## EXPERT SETTINGS

### ACCESS

You access to expert settings in 5 steps.

From Auto, Comfort, Eco or Frost protection mode :

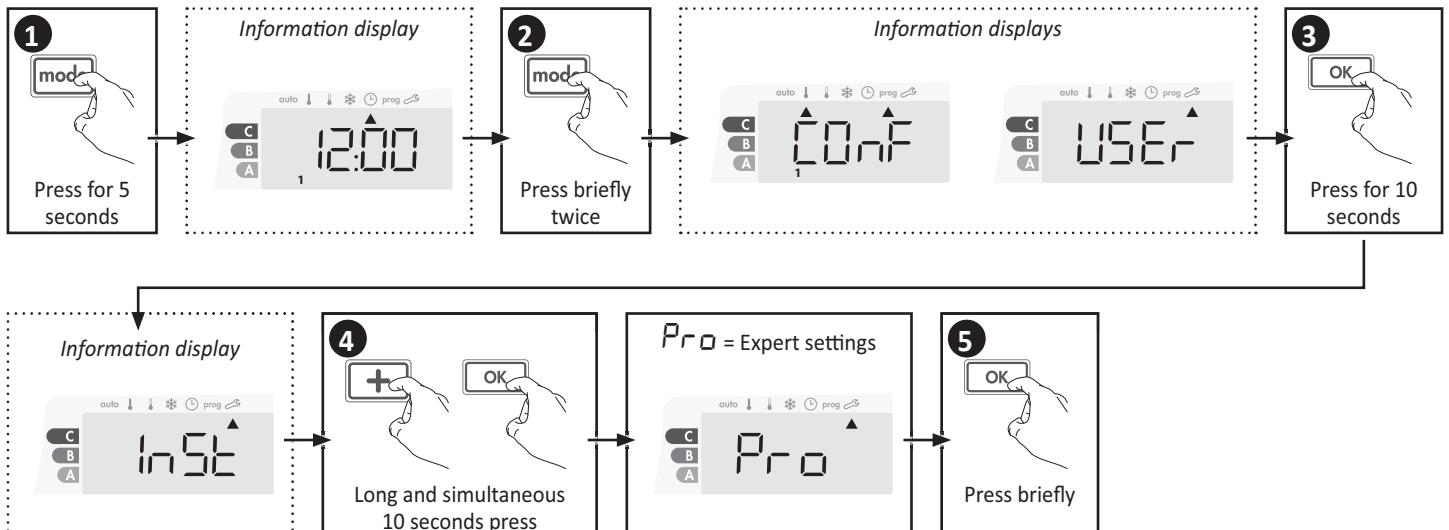

## AMBIENT TEMPERATURE SENSOR ADJUSTMENT

### ● Overview

**Important:** This operation is reserved for professional installers only; any wrong changes would result in control anomalies.

In which case? If the temperature measured (measured by reliable thermometer) is different by at least 1°C or 2°C compared to the setting temperature of the device.

The calibration adjusts the temperature measured by the ambient temperature sensor to compensate for a deviation from + 5°C to - 5°C by intervals of 0.1°C.

### ● Ambient temperature sensor adjustment

#### 1- If the room temperature difference is negative, example :

Setting temperature (what you want) = 20°C.  
Ambient temperature (what you read on a reliable thermometer) = 18°C.  
Difference measured = -2°C.

**Important:** Before carrying out the calibration it is recommended to wait for 4h after the setting temperature modification to insure that the ambient temperature is stabilized.

To correct, then proceed as follows :

Sensor temperature = 24°C

(The measured temperature may be different due to the location of the thermostat in the room).



Decrease the temperature measured by the ambient temperature sensor by 2°C by pressing **-**.

In our example the measured temperature by the sensor goes from 24°C to 22°C.

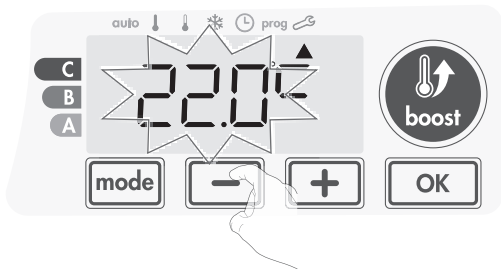

#### 2- If the room temperature difference is positive, example :

Setting temperature (what you want) = 19°C.  
Ambient temperature (what you read on a reliable thermometer) = 21°C.  
Difference measured = +2°C.

To correct, then proceed as follows :

Sensor temperature = 21°C.

(The measured temperature may be different due to the location of the thermostat in the room).



Increase the temperature measured by the ambient temperature sensor by 2°C by pressing **+**.

In our example the measured temperature by the sensor goes from 21°C to 23°C.

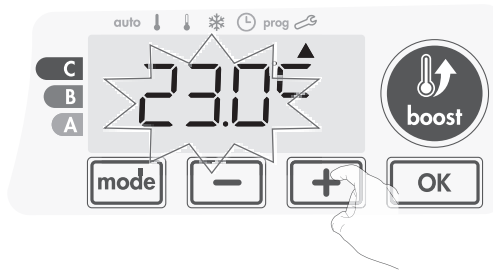

To validate press **OK**.

**ELEC** appears. This is a special setting dedicated to the production and already set in factory, please do not modify. To exit the Expert settings, press **mode** 3 times.

Information displays appear each time when **mode** is pressed. They are also settings adjusted in factory, please do not modify. Any wrong changes would result in control anomalies.

### ● The reset to zero of the sensor calibration

To put the value of the correction to "0", do the following :

- 1- When the temperature measured by the sensor appears, press **-** or **+** for at least 3 seconds.

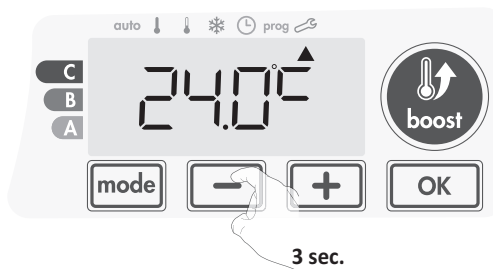

- 2- To validate press **OK**. To exit the Expert settings, press **mode** 3 times.



## POWER CUT

### OTHER REMOTELY MANAGEMENT BY POWER SHUTDOWN



**Important :** The power supply of the device should be cut when working on the electrical system only. The load shedding does not be operated by an additional system with mechanized power shutdown (with contactor...). Unlike pilot wire shedding, the load shedding with frequent mechanized power shutdowns can cause deterioration of the device depending of the quality of switching elements used. This type of deterioration would not be covered by the manufacturer's warranty.

If remotely stop or standby orders should be frequently operated, you must use the pilot wire.

### IN CASE OF POWER CUT, BACKUP

- After short power cuts (less than 16 hrs), the device will start up again without any outside input being required – you do not have to do anything. All the settings and the correct time will be saved.

When the main power supply returns, your device will again operate using correct time and the settings that were programmed before the power cut (as regards desired temperature, operating mode, programmes, etc.). It will start up again in the mode which was active before the power outage

- If the Super Comfort was activated before the power cut, then the quick heating will be activated until the difference between the room tempera-

ture and the requested temperature is reduced (see page 10).

- If the Boost was switched on before the power cut, then the heating will be activated until the end of the remaining time (see page 10).
- **For longer power supply cuts (more than 16 hrs)**, check the timer setting. All the other settings are automatically and permanently saved.



## TROUBLESHOOTING

### DIAGNOSIS SUPPORT

#### • Heating body

##### Temperature differences on the heating device:

- The surfaces of the different parts of the heating device may present, in normal operating, temperature differences more or less noticeable to the touch according to the methods of use.

This has no effect on the safety and performance requirements applicable for the product.

For example, the last rail located on the top of the towel rails is often cooler than the others, indeed, when the thermal fluid rises in temperature, it expands in the heating body, which requires us not to fill it completely.

##### The device doesn't heat:

- Check the position of the circuit breaker / power supply protection fuse in your fuse board.
- Check the active operating mode (see page 9), you could be in "Heating standby mode" or in Auto mode, with an imposed stop order by the energy manager (see page 14).
- Check the ambient temperature using a thermometer: if it is elevated, the device has reached the desired temperature setting, therefore it is normal that it doesn't heat more.
- Switch the power off for 5 seconds at the mains supply then switch back on again.

##### The room temperature is not high enough, the device is not providing enough heat:

- Check the active operating mode (see page 9), you may be in Eco, Frost protection or in Auto mode, with an imposed lowering by the integrated programming or the energy manager. Switch to the permanent Comfort mode.
- Check the active temperature setting and increase it if necessary (see page 11).
- If the problem persists, check the towel rails sizing compared with the bathroom dimension and insulation.

##### The device heats continuously and is hot on the surface:

- In operating, it is normal that the device surface is hot, the surface temperature is limited.
- Check that the blower located at the bottom of the towel rails, is not influenced by an airstream.
- Check that the setting temperature has not been changed.
- If the problem persists, check the towel rails sizing compared with the bathroom dimension and insulation.

##### Several situations can generate a slight metallic slam:

- The device is fixed on an irregular wall.
- The device is fixed on an uninsulated wall.
- The device is in a stream of cold air.
- The device is badly positioned in the wall-mounting brackets.
- Heat up or sudden temperature change.

#### • Controller/blower

##### The ambient temperature is lower than the setting temperature:

- Check the programming mode. You may be in a programmed Eco period.
- Check the time setting.
- Otherwise, switch the power off for 5 seconds at the mains supply then switch back on again.

##### The ambient temperature measured by a thermometer doesn't correspond to the setting temperature after several hours.

- An offset is always possible, you can refine the device setting (see page 22).

##### The device does not heat while the heating indicator is on:

- The heating symbol is lit on the display, the unit is cold, contact your installer.

##### After a subsequent temperature drop at the opening of a window, the device will not enter in Frost protection mode:

- Check that the automatic mode of the open window detection is enabled (see page 19).
- Check the location of your device (see page 13).
- Check that the temperature difference between the room air and outside air is significant.

##### The device automatically enters in Eco or Frost protection mode in your presence and closed windows:

- If the device is connected to a central programming via pilot wire, check the programming of the central.
- Disable the automatic open window detection mode (see page 17).

##### The device is programmed and you observe a delay between the active mode Comfort or Eco and your requirement:

- The optimization function can generate slight offsets to guarantee the level of comfort at the right time or to save energy by slightly anticipating an Eco passage.

##### The blower stops prematurely:

- Check if the filter is not obstructed by the dust, and if necessary, clean it (see page 24).
- Check if the room temperature is not too elevated. In this case, the blower stops automatically.
- If your housing is located above an altitude of 1000m, this last may cause an increase of the air temperature at the device exit, the blower stops prematurely. This will not damage the product.

##### $E \square$ I appears on display:

- Switch the power off for 5 seconds at the mains supply.

##### $Fl \square$ appears on display:

- The filter is obstructed by the dust. Clean it or replace it.

##### $--$ appears on display, the device is in heating standby mode:

- Check that your energy manager or programmer is in heating standby mode.

##### The device is in Auto mode, remotely controlled by an energy manager or programmer, but the programming orders are not executed by the device:

- Make sure the energy manager or the programmer is in good condition, refers to the using instructions.
- Change the batteries of the energy manager or the programmer if this one contains it.

##### No symbol appears on the display screen.

- Check if the switch is on I.
- Check the position of the circuit breaker / power supply protection fuse in your distribution / fuse board.

##### You want to increase or decrease the setting temperature but pressing a key on the keyboard has no effect:

- If the padlock symbol is displayed, the keypad lock is enabled. Unlock the keypad as shown in the manual, child anti-tamper section (see page 11).
- Check the changes, restrictions temperature settings (see page 17).

##### You made a mistake while setting the advanced settings:

- Just restore factory settings – see the "Restoring factory settings" paragraph (see pages 18 and 21).

**If the problem persists, then contact your installer.**

# i TECHNICAL INFORMATIONS

## MAINTENANCE

### • Maintenance and cleaning of the towel rails

Before any maintenance work, switch off the device by pressing the button (switch).

The device can be cleaned with a damp cloth; **never use abrasives or solvents.**

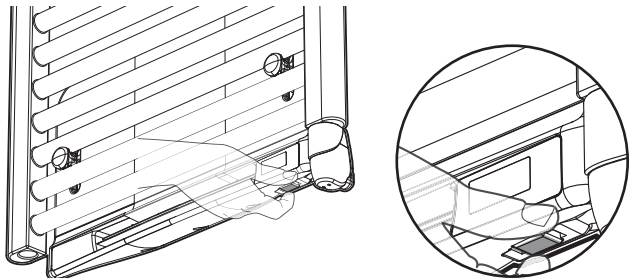

### • Maintenance and cleaning of the dust filter

The blower is equipped with a removable dust filter which retains impurities from the air aspirated into the room.

When the filter is saturated, the dust accumulation may cause its stop.

In Boost mode, the writing **Fi Lt** appears on the display.



Before any action of filter removal, switch off the device by pressing the button located under the blower.

To clean the filter, proceed in the following order:

- 1- Press the filter strip by the right or the left side then take it out from its slot.

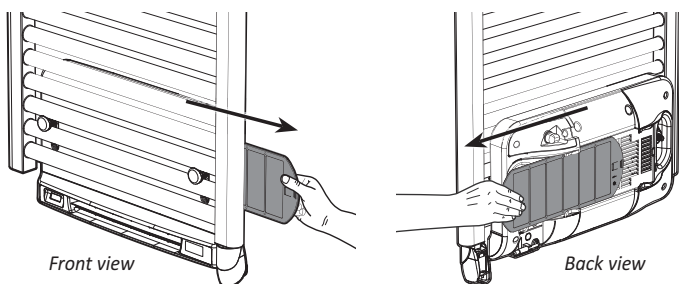

- 2- Use a vacuum cleaner to eliminate the dust deposited on the filter. If the filter is very dirty, wash it under the water tap with a damp sponge. After washing the filter, let it dry.

**Important :** it is recommended to clean the filter at least once a month unless the writing **Fi Lt** appears on the display prematurely.

- 3- Once cleaned and dried, replace the filter in its slot by inserting it into the runners.

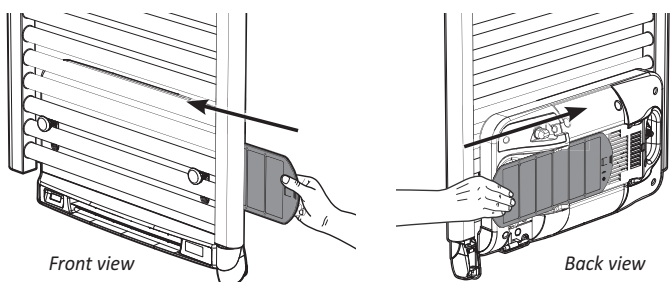

## PRODUCT LABEL

The product label is the identity card of your device. It contains all informations required of its traceability through time.

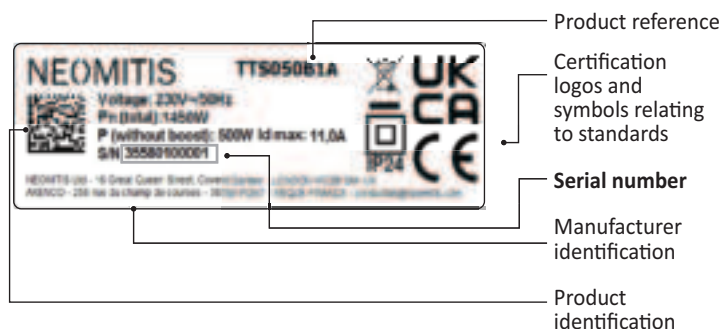
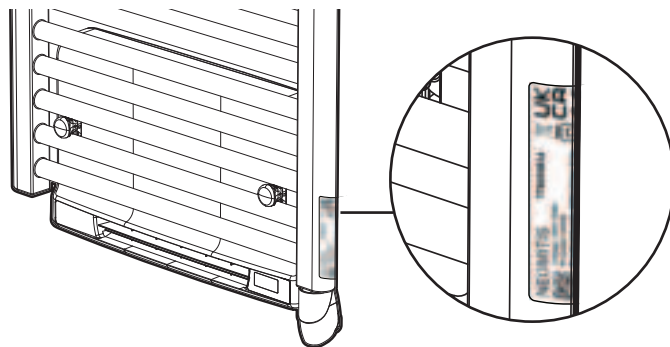

**Important :** the serial number allows the manufacturer to identify your device. If you contact your installer about the product you have purchased, take the references of your towel rails.

**Make sure to keep instructions even after the product installation.**

## DIMENSIONAL SPECIFICATIONS

References	Towel rails power + blower power consumption/ PTC (W)	Steel height (mm)	Complete height (mm)	Width (mm)	Depth** (mm)	Number of towels spaces
TTS050B1A	500 + 1000*	860	927	508	105	2
TTS070B1A	700 + 1000*	1238	1305	508	105	3
TTS100B1A	1000 + 1000*	1616	1683	558	105	4

\* PTC heating resistance with self-adaptive power of 850W to 1000W max. according to environment.

\*\* For the depth of Danais Neoboost installed, add adjustable distance from +0 to +6mm to the value of its depth.

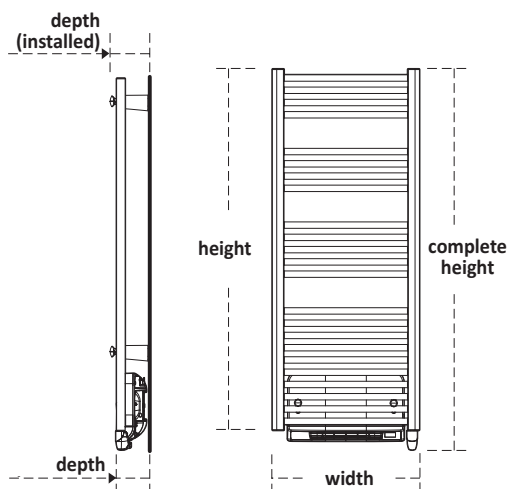

## TECHNICAL SPECIFICATIONS

### General specifications:

- Power supply: 230V +/-10% 50Hz.
- Switch power on/ standby heating : 10000 approved cycles.
- Radio frequencies: 2,4035 Ghz/ 2,4055 Ghz / 2,4075 Ghz.
- Maximum transmitted radio power: <1mW.
- Consumption in heating standby mode: <1W.
- Integrated overheating protection.

### Unit integrated blower:

- Integrated overheating protection.
- PTC resistance with self-adaptive power from 850W to 1000W max according to environment.

### Order by immersion heater, class II:

- Maximum power according to the product label.
- Zero-voltage control device.
- PID (Proportional Integral Derivative) electronic control with microprocessor.

### Environment:

- Class II, IP24.
- Operating temperature: 0°C à +40°C.
- Storage temperature: -20°C à +65°C.
- NTC electronic temperature sensor

### Features:

- Adjustment of the setting temperature from +7°C à +30°C.
- Saving settings users in case of power failure.
- Pilot wire 6 orders.

### Informations:

#### Data plate:

- Id max = maximal intensity at startup.
- In = nominal intensity. This intensity varies according to the temperature and operating conditions.

**Simplified UK Declaration of conformity** : Hereby, NEOMITIS Limited declares that the radio equipment type Danaïs Neoboost is in compliance with Radio Equipment Regulations 2017 (2017 No. 1206) and RoHS Regulations 2012 (2012 No.3032).



The full text of the UK declaration of conformity is available at the following internet address: <https://www.neomitis.com/UKCA-declaration.html?lang=en>

Neomitis Ltd: 16 Great Queen Street, Covent Garden, London, WC2B 5AH  
UNITED KINGDOM - [contactuk@neomitis.com](mailto:contactuk@neomitis.com)

### Simplified EU declaration of conformity:

Hereby, AXENCO, declares that the products mentioned in this manual are in compliance with directives 2014/35/EU, 2014/30/EU, 2011/65/EU and 2009/125/CE.



The full text of the EU declaration of conformity is available at the following internet address: <https://www.neomitis.com/CE-Declaration-2126.html?lang=en>

Axenco: ZI Montplaisir - 258 Rue du champ de courses - 38780 Pont-Evêque  
- France - [contact@imhotepcreation.com](mailto:contact@imhotepcreation.com)

Neomitis Ltd and Axenco belong to Axenco Group.



The symbol , affixed on the product indicates that you must dispose of it at the end of its useful life at a special recycling point, in accordance with European Directive WEEE 2012/19/EU. If you are replacing it, you can also return it to the retailer from which you buy the replacement equipment. Thus, it is not ordinary household waste. Recycling products enables us to protect the environment and to use less natural resources.

## INFORMATION REQUIREMENTS FOR ELECTRIC LOCAL SPACE HEATERS

<b>Contact details</b>				NEOMITIS LIMITED 16 Great Queen Street, Covent Garden, London, WC2B 5AH UNITED KINGDOM - contactuk@neomitis.com	
<b>Model identifier(s):</b> TTS050B1A / TTS070B1A / TTS100B1A					
Item	Symbol	Value	Unit	Item	Unité
<b>Heat output</b>				<b>Type of heat output / room temperature control</b>	
Nominal heat output	$P_{nom}$	0.5/0.7/1.0	kW	Single stage heat output and no room temperature control	no
Minimum heat output (indicative)	$P_{min}$	0.000	kW	Two or more manual stages, no room temperature control	no
Maximum continuous heat output	$P_{max.c}$	0.5/0.7/1.0	kW	Mechanic thermostat room temperature control	no
<b>Power consumption</b>				Electronic room temperature control	
In off mode	$P_o$	N.A	W	Electronic room temperature control plus day timer	no
In standby mode	$P_{sm}$	0,70	W	Electronic room temperature control plus week timer	yes
In idle mode	$P_{idle}$	0,70	W	<b>Other control options (multiple selections possible)</b>	
In networked standby	$P_{nsm}$	N.A	W	Presence detection	non
Standby mode with display of information or status	yes			Open window detection	yes
Seasonal space heating energy efficiency in active mode	$\eta_{s,on}$	98	%	Distance control option	no
				Adaptive start control	yes
				Working time limitation	no
				Black bulb sensor	no
				Self-learning functionality	non
				Control accuracy	yes

# LEGAL GUARANTEE (EXTRACT OF TERMS AND CONDITIONS)

## Clause 6 - Guarantee:

### 6.1. Guarantee of patent defects - Principle:

Our products must be verified by the customer upon delivery.

Any and all claims, reservations or disputes regarding missing items and patent defects must be submitted in the manner set forth in these General Terms and Conditions.

In the event of patent defects, the defective parts shall be replaced by us, subject to verification of the alleged defects.

We shall not be held responsible for patent defects or missing parts of which the purchaser was aware before entering into the sales agreement.

The customer shall have to provide any and all evidence as to the reality of the defects noted (paperwork, photographs, etc.), and our company reserves the right carry out, directly or indirectly, any and all checks and verifications, notably on-site. Notice of the missing items or of the patent defects which were noted at the time of delivery, and those discovered after acceptance and intake of the products, shall have to be provided by the customer in writing within twenty-four hours following the date on which the latter discovered the said missing item or defect. No notice shall be taken into account if it is provided more than eight full days following delivery of the products.

Once said timeframe has expired, the customer shall no longer be able to put forward as ground non-conformity of the products as regards patent defects or missing items, or raise said non-conformity in a counterclaim in its defence at the time of legal proceedings regarding the collection of monies owed brought by our company.

### 6.2. Guarantee of hidden defects:

Our company guarantees its products against the hidden defects which existed on the date on which products are delivered, in accordance with the law, under the terms set forth hereinafter. Our guarantee only applies to products which have lawfully become the property of the purchaser. It only applies to products which were manufactured in full by our company. Our guarantee covers hidden defects. Since our customers are trade professionals, a hidden defect is defined as an unacceptable manufacturing defect affecting a product which renders the latter unfit for the intended use thereof which is not liable to be detected by the purchaser before it is used. "Unfit for the intended use thereof" means that the defect prevents the piece of equipment from operating. Thus, the design of the product is not covered by the hidden defects guarantee – our customers are deemed to have received all of the technical information regarding our products. We do not guarantee against malfunctions or damage or wear and tear arising out of adaptations or fitting of our products which are special or unusual or usual. Likewise, allegations regarding occasional or variable malfunctions, a lack of comfort, unhappiness regarding the results obtained, aesthetic defects, in particular, are not covered by the guarantee against hidden defects. A defect is not hidden if, despite the fact that the purchaser was not aware of it in good faith, it could have been discovered by carrying out basic verifications.

Our guarantee is limited to the replacement or repair of defective parts. It does not give rise to compensation.

### 6.3. Contractual guarantee:

A specific contractual guarantee can be provided by our company for such equipment. In such case it shall be strictly limited to the stipulations set forth by us.

### 6.4. Terms covering the application of guarantees:

Any and all requests for coverage in respect of the guarantee must be made using our After-Sales Service Return Request Form. All claims must be made by the Customer to the Supplier's After-Sales Service Department, given that no direct claims by the user shall be taken into account. The guarantee request shall be taken into account upon production of a dated purchase receipt. It is the responsibility of the purchaser, who alleges a defect, regardless of the defect in question, to provide proof of the existence and of the nature thereof. An application is forwarded by the purchaser to our staff. Likewise, any and all guarantee requests shall have to be accompanied by evidence that it does not fall under one of the said exclusion cases.

The purchaser must do his or her utmost to enable said defects to be officially recorded and remedied. He or she must furthermore absolutely abstain from replacing the products or have said replacement carried out by a third party, failing which guarantee coverage shall not be provided. The guarantee coverage is limited to merely exchanging or repairing the defective part. If it proves indispensable, after examination by the Supplier's Technical Staff, replacement of the appliance in full shall be carried out as a temporary measure.

Said replacement measure, taken as a temporary measure, under no circumstances whatsoever constitutes an acknowledgment of responsibility on our part. In the event of replacement of the defective part or of the appliance as a whole, transport, removal and fitting costs are excluded from the guarantee. In the event of immediate replacement as a temporary measure, the defective equipment shall have to reach our staff within fifteen calendar days of the replacement thereof. Failing which, the replaced equipment shall be invoiced.

All returns shall be carried out in suitable packaging, with the equipment properly wedged. The cost of the return shall be borne by the customer.

No returns of parts shall be accepted unless approved beforehand by our After-Sales Service Department. The customer shall receive an assessment carried out by our After-Sales Service Department in the event that the latter concludes that the return was unjustified.

The guarantee coverage excludes any and all compensation in respect of damages. The installer must be insured against any eventual damage.

Moreover, our guarantee automatically ceases to apply when our customer has not notified us of the alleged defect within a timeframe of thirty full days from the date of the facts cited as justifying the claim for guarantee coverage.

The onus is on the customer to provide evidence of the dates referred to in the claim.

### 6.5. Specific exclusion in respect of apparent defects:

Defects and damage to the products delivered consecutive upon circumstances relating to carriage, to storage and/or to preservation conditions at the customer's premises, in particular in the event of an accident of any type whatsoever, shall not give rise to an entitlement under the guarantee provided by our company.

The guarantee does not apply to equipment already resold by our purchaser.

### 6.6. General exclusions in respect of the all the guarantees:

All guarantees are invalid as soon as our products have been used under usage or performance circumstances for which they were not intended or which do not constitute normal usage.

The guarantees do not apply if the following conditions have not been complied with, to wit notably:

- Storage away from sources of humidity and the effects of bad weather;
- Set-up and installation in accordance with best practice;
- Utilisation with a 230V domestic power supply;
- Utilisation compliant with the Supplier's instructions for installation and use.

The guarantees do not apply to any eventual damage which is the consequence of overvoltage or other faults which occur in power supply and distribution circuits. The guarantees apply to cor-

rosion defects only if the appliances are used in accordance with the usual circumstances which apply in a single housing unit or in the tertiary sector; in particular they must not be:

- Subject to intensive and continuous ambient humidity (from swimming pools, etc.);
- Cleaned using acidic substances which are liable to affect their properties.

The development of a shade of colour over time is a natural phenomenon and cannot give rise to a guarantee claim.

The guarantees do not come into play if the acquirer cannot provide evidence of full payment for supplies and/or if the installation and usage instructions provided by the vendor were not complied with, and less specifically in the event that the damage caused arose out of the actions of the purchaser or of the servants thereof, out of force majeure circumstances or out of unforeseen circumstances. The guarantees do not apply in the event of a defect originating either in the components supplied by the purchaser and in the event of a design having been required by the purchaser, without the vendor having taken part in said end design process, or if the product did not meet aims determined by the customer of which the vendor was not notified.

All points not mentioned in writing in the order are not guaranteed. All damage caused by normal wear and tear is also excluded from the guarantee.

The guarantees only apply to products produced in production runs, to the exclusion of prototypes and samples.

### 6.7. Specific exclusions in respect of central heating radiators as regards all of the guarantees:

- The system must be set up in accordance with best practice, and notably in accordance with D.T.U. 60.1 and 65.11 and the fascicules (booklets) CCO, CC1, CC2 and CC3 drawn up by the Commission Centrale des Marchés (the French State's central tendering committee);
- The water used to supply heating circuits must not be aggressive, corrosive, etc.;
- The circuit must be free of material formed by metal, scale, grease, etc.;
- The system must not contain traces of dissolved gases (in particular oxygen).

All common forms of corrosion are caused by the presence of oxygen, therefore all risks of oxygen entering the system must imperatively be avoided.

To do so, it is necessary:

- To carry out effective upstream bleeding of the circulation pump and bleeding of high points (located in high pressure areas);
- To make the expansion system large enough, in order to avoid frequent addition of supplementary water;
- To have high pressure continuously at all points in the system;
- Also avoid unusual additions of water, due to leaks, parasitical bleeding or other causes, in general avoid all factors which present a risk of oxygen getting into the system, notably should gas-permeable materials be used;
- Heating bodies, after initially being filled, must be filled with water and must not be drained periodically;
- In the event that the use of a corrosion-inhibitor is rendered necessary, it must be compatible with all the materials present in the system. The choice of it and verification of its effectiveness must therefore be appropriate in relation to the system in question;
- The installer will take care to use joints made of material which is compatible with that of the heating body in order to prevent all abnormal electro-erosion phenomena;
- In the event that anti-freeze is used, it must be of a quality appropriate for use in a central heating system and must never be used pure, rather diluted to the relevant percentage (neither above or below) before it is put into the system;
- The operating pressure of the heating body guaranteed by the manufacturer must correspond with the normal maximum operating pressure. In the event that a test is carried out on the system, the maximum values in respect of the latter are set out by the standard NF EN 442-1, sections 5.2 and 5.3.

### 6.8. Guarantee period:

The guarantee period for missing parts and patent defects varies depending on the nature of the defect in question and on the type of equipment in question:

- As regards electric radiators, electric decorative radiators, electric radiant panel heaters, electric towel rails and accessories: a guarantee lasting 30 months from delivery of the appliance up to a maximum of 36 months after its manufacturing date in the case of a non-compliance defect;
- As regards spare parts: 2 years from the exchange.
- As regards wall sockets, room thermostats, programmers, programmable smart and connected digital room thermostats, thermostatic radiator valves and gateways, a 3-year guarantee from delivery of the appliance.
- As regards wired mechanical room thermostat, analogue cylinder thermostat, motorised zone valves, thermoelectric actuator, a 2-year guarantee from delivery of the appliance.

The guarantee for hidden defects is provided for duration of 30 months from delivery.

The spare parts vital for the use of the product or equivalent spare parts continue to be available for 10 years from the date the appliance was last marketed.

Work carried out under the guarantee does not have the effect of extending the duration of the guarantee.

- For electric underfloor heating, the warranty periods are as follows depending on the type of product:
- Underfloor heating with glued-down covering: 20 years.
- Electric underfloor heating with floating parquet: 15 years.

These warranties take effect from the date of purchase of the product and apply under the following conditions:

- If the inspection and guarantee form has been correctly filled in and returned within 1 month of installation and six months after purchase, the ohmic value and insulation value tests must be carried out before installation, after installation of the product and after installation of the covering.
- If the installation complies with the rules in force mentioned in the in the installation instructions, in the Cahier de Prescription Technique of February 2013 and the BS7671 18th Edition Part P National Wiring Regulations.
- If the electric heating mats are not diverted from their intended their primary function as intended by NEOMITIS.

The warranty will lapse in the following cases:

- If the floor covering above the electric underfloor heating system has been damaged, repaired, replaced or covered by one or more successive coverings.
- If the floor covering above the electric floor heating system is covered by furniture or carpets on the floor, which could damage the heating cable.
- If the underfloor heating system is fed continuously as a result of a thermostat fault or a high temperature demand or when operating without a thermostat.
- If a voltage error occurs, even momentarily.
- If any modification is made to the heating element (cold junction, termination or if the heating cable has been shortened or lengthened).

The warranty is limited to the replacement or repair of parts found to be defective by the NEOMITIS after-sales service and excludes any service and all labour, travel or transport costs as well as any compensation for damages, in the case of a factory defect in the product.

# NEOMITIS

**NEOMITIS® LIMITED** - 16 Great Queen Street, Covent Garden, London, WC2B 5AH UNITED KINGDOM

Registered in England and Wales No: 9543404

Tel: +44 (0) 2071 579 967 - Fax: +44 (0) 2071 250 267 - E-mail: [contactuk@neomitis.com](mailto:contactuk@neomitis.com)



[www.neomitis.com](http://www.neomitis.com)