

PORODO



Porodo

10000mAh MagSafe Power Bank with Real-Time Voltage Display

SKU: PDPBFCH085DG

Table of Contents

Product overview	2
Specifications	2
Schematic View	3
Usage and Recharging Methods	4
Recharging Instructions	4
Safety Guidelines	5
Material Content	6
Troubleshooting	8
Battery Safety Warnings	9
Warranty	10
Contact Us	10

Thank you for the purchase. We are committed to provide you with a reliable and efficient device that keeps your gadgets charged and ready to go. Before using the product, please carefully read this User Manual to guarantee correct usage and keep it secure for future reference.

Product Overview

1. Power Display

The digital display clearly shows the current power level. When the device is not in use or when the low power mode is activated, the display lamp will turn off, and no output will be provided. This ensures efficient energy management and prevents unnecessary power drain.

2. Charging and Discharging Status

During the discharging process, the low power indicator will be turned off, signaling that the device is being drained of power. The output button will also be disabled, and the digital display will shut down when the power is exhausted.

Specifications

Battery Capacity	10000mAh
USB-C Input	5V/3A, 9V/2A, 12V/1.5A, 18W Max
USB-C Output	5V/3A, 9V/2.22A, 12V/1.67A, 20W Max
Wireless Output	5W/ 7.5W/ 10W/ 15W

Total Output	5V/3A, 15W Max
Product Weight	200g
Product Size	15 x 69 x 105mm
Model Number	PB085

Schematic View

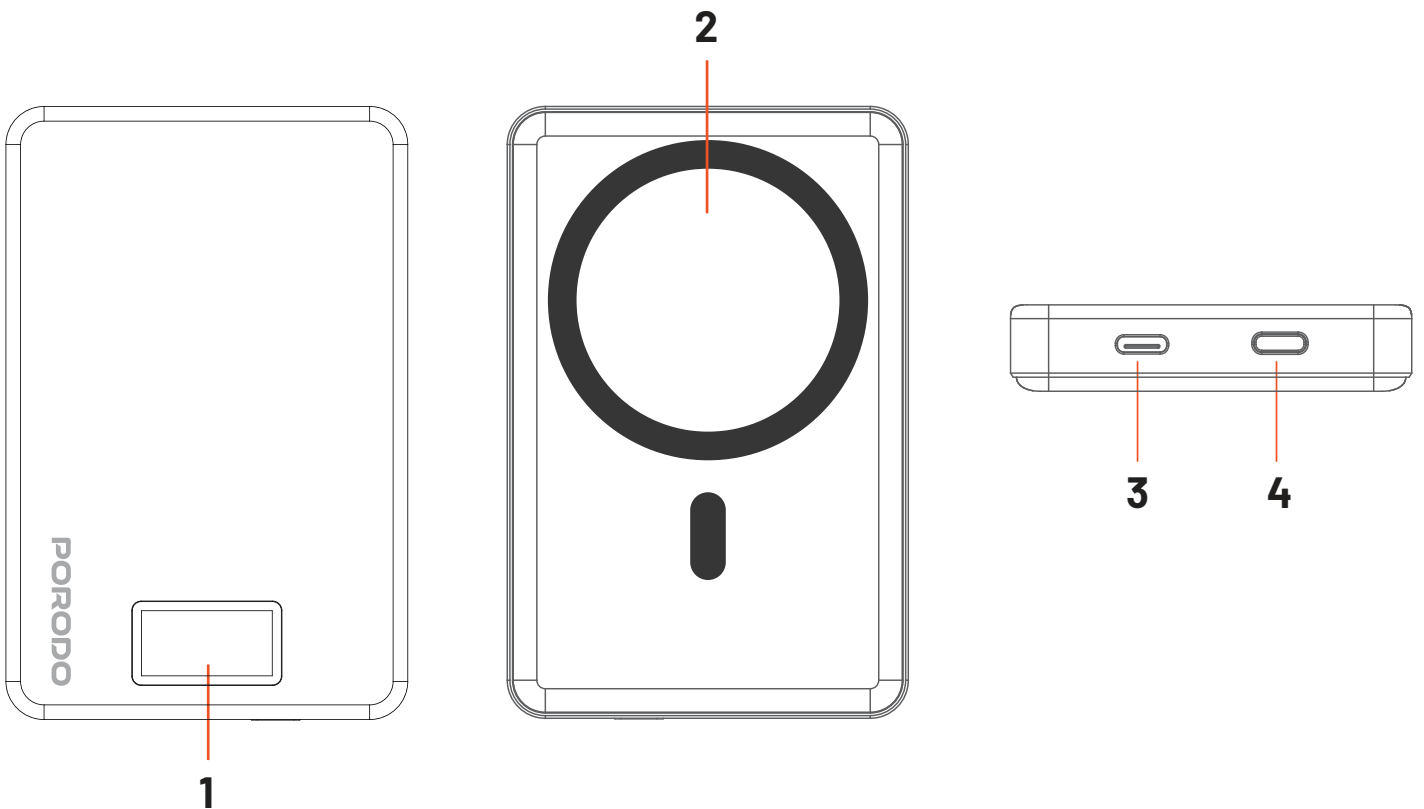

1. Display

2. Wireless Output

3. Type-C Input/Output

4. Power Switch

Usage and Recharging Methods

1. The power bank can charge various digital devices, such as smartphones, tablets, and other USB-powered devices. To use, simply connect your device to the power bank via a compatible Type-C cable, and it will begin charging your device.
2. When the power bank's battery is low, recharge it by connecting it to a power source using the provided Type-C charging cable. You can recharge the power bank through any USB port, such as those on a computer, wall AC adapter, or car charger. Ensure you use a suitable charging cable to optimize recharging speed and efficiency.

Recharging Instructions

1. Charging Status (Input)

When the power bank is charging, the digital display will flash to indicate the current charging status. Once fully charged, the display will show "100%" and the light will remain steady, signaling that the battery is at full capacity.

2. Discharging Status (Output)

While the power bank is discharging (charging other devices), the digital display will continuously show the current battery percentage. When the power level drops below 0%, the display will show "0%" and flash at a rate of 1Hz, signaling that the battery is critically low.

Note: If the power bank's battery voltage drops below 3V, the power bank will automatically shut off to protect its internal components.

Safety Guidelines

- 1.** The power bank should be placed on a flat, stable surface during use. If the device comes into contact with the human body, limit this contact to under 10 seconds to prevent any risk of discomfort or overheating.
- 2.** The recommended working temperature range for the power bank is between 0°C and 35°C. Using the device in environments outside this range (i.e., above 35°C or below 0°C) may compromise its performance and longevity.
- 3.** Keep the power bank away from water, fire, and other liquids. Do not expose the device to water or damp environments, as this could lead to leakage, short circuits, and other electrical malfunctions.
- 4.** To ensure optimal performance and heat dissipation, do not cover the power bank with paper, cloth, or other objects that could obstruct airflow and cooling.
- 5.** Always supervise the power bank when in use. Never leave the device unattended during operation.
- 6.** Do not attempt to disassemble or maintain any internal components. Unauthorized disassembly could lead to malfunction or void the warranty.
- 7.** Handle the power bank with care. Avoid dropping, shaking, knocking, or applying excessive pressure. Such impacts can damage the internal components and pose safety hazards.
- 8.** Never short-circuit the anode and cathode of the device. Doing so may cause overheating, smoke, fire, and other serious hazards. Ensure that the voltage of the charger you use matches the power bank's requirements to avoid overload.
- 9.** Keep the power bank out of reach of children and pets to prevent accidental misuse, injury, or damage.
- 10.** Always unplug the charger after the power bank is fully charged. If you notice any unusual signs such as odor, heat, discoloration, or deformation, immediately disconnect the power bank from its power source and deactivate the device.

- 11.** If using an external power adapter for charging, ensure that it has certification and meets the required safety standards. Failure to use the correct adapter may result in electrical overload, damage, or fire.
- 12.** If the battery needs to be replaced, only a qualified technician should handle the replacement. Never attempt to replace the battery yourself. Incorrect battery replacement could lead to explosion or other safety issues. Only use batteries that are compatible with this power bank.
- 13.** Avoid exposing the power bank to extreme environmental conditions such as direct sunlight, excessive heat, or cold, as these could impair its functionality and lead to potential safety risks.
- 14.** If the power bank is not in use for an extended period, store it in a cool, dry place away from excessive heat or moisture. Do not allow the device to soak in any liquids or expose it to extreme temperatures.

Material Content

To ensure environmental protection and safe disposal, please do not dispose of this power bank with general household waste. Instead, it should be taken to a designated recycling center authorized by the government. Recycling ensures that harmful substances are properly handled and that valuable materials are recovered.

Hazardous Substances						
Component Name	Pb	Cd	Hg	Cr(VI)	PBBs	PBDEs
Shell	○	○	○	○	○	○
PCB	×	○	○	○	○	○
Battery	○	○	○	○	×	×
Screw	○	○	○	○	×	×
Metal components	○	○	○	○	--	--
Data line	○	○	○	○	○	○

This table is prepared in accordance with the provisions of SJ/T 11364.

○: Indicates that the content of toxic and harmful substances in all homogeneous materials of the component is within the limit requirements specified in GB/T 26572.

×: Indicates that the components marked with an "X" exceed the limit requirements specified in GB/T 26572 for at least one homogeneous material of the component. These components cannot be replaced due to technical reasons, but with future technological advancements, replacement or improvement may be possible.

—: According to GB/T 26572, there are no requirements for the content of PBBs and PBDEs in metal components.



Environmental Protection Period

The environmental protection period of this product under normal usage is 5 years.

Important Notes:

1. The "hazardous substances" listed in this table do not pose any harm to human health or the environment when the product is used as intended.
2. The information provided about the "hazardous substances" and their components is intended to inform consumers and recycling professionals about the presence of relevant substances, aiding in the proper disposal of product waste.

Troubleshooting

Problem	Possible Cause	Solutions
The indicators fail to show a full charge status after the product has been charging for an extended period.	<ol style="list-style-type: none"> 1. The product has not been charged for enough time. 2. There is a malfunction with the adapter or the product. 	<ol style="list-style-type: none"> 1. Charge the product for 12 hours. 2. Contact a service center for assistance.
The remaining power of the product cannot be detected.	<ol style="list-style-type: none"> 1. The product has no remaining power. 2. The power button or indicator is malfunctioning. 3. product has experienced a power failure. 	<ol style="list-style-type: none"> 1. Charge the product. 2. Contact a service center for assistance.
The product is unable to charge other devices.	<ol style="list-style-type: none"> 1. The product's battery power is low. 2. There is no power transmission through the USB cable or adapter. 3. An incompatible adapter has been selected. 4. The product's power management system is preventing charging of the device. 	<ol style="list-style-type: none"> 1. Charge the product. 2. Replace the USB cable or adapter. 3. Use a compatible connector that suits the product's interfaces. 4. The product may be incompatible with the device.
The product can charge other devices, but it cannot fully charge them.	The battery of the product has been completely used up.	Charge the product.
When using the remaining power to charge other devices, the product unexpectedly stops working or fails to display any power.	An external short circuit or overload in the product has caused it to shut down automatically for self-protection.	Charge the product to reactivate it.

Battery Safety Warning

1. If you notice any unusual smells, overheating, discoloration, deformation, leakage, or other abnormal conditions during use, immediately stop using the power bank to prevent potential hazards.
2. If the battery liquid comes into contact with your skin, wash it off with water immediately. Seek medical attention if necessary.
3. When the power bank is not in use, dispose of it properly by following local recycling or disposal guidelines to ensure safety and minimize environmental impact.



Warranty

Products that you buy directly from our **Porodo** website or shop come with a 24-month warranty.

When you buy **Porodo** products from any of our approved sellers, you only get a 12-month warranty. If you want to extend this warranty, go to our website at **porodo.net/warranty** and fill out the form with your information. Don't forget to upload a picture of the product too. After we've checked and accepted your request, we'll send you an email to confirm that your product's warranty has been extended.

For more info, please check:
porodo.net/warranty

Contact Us

If you have any questions about this Privacy Policy, please contact us at:

info@porodo.net

Website: **porodo.net**

Service Support: **support@porodo.net**

Instagram: **porodo**