

PORODO



Porodo

**4G LTE WIFI 6 Pocket Router
10000mAh Power Bank**

SKU: PD-PBFCH087

Table of Contents

Overview	2
Schematic View	2
Specifications	3
Connecting PC to the Internet via 4G/3G	4
System Requirements	6
Connect to the Internet via Wi-Fi	6
Managing the Web UI Page	7
Wi-Fi Connection	8
Data Management	9
Connection Settings	9
APN Settings	10
Safety Precautions	11
Disposal	12
Warranty	12
Contact Us	12

Before using the product, please carefully read this User Manual to guarantee correct usage and keep it secure for future reference.

Overview

This device supports LTE and WCDMA networks across 13 frequency bands. It can create a Wi-Fi hotspot that supports up to 10-8 devices, including computers, smartphones, tablets, and other electronic devices. To connect, simply follow the on-screen prompts based on your Wi-Fi device or computer's system. The device automatically connects to the network using LTE or WCDMA, depending on the operator's settings. Once powered on, you can easily access the Internet.

Schematic View

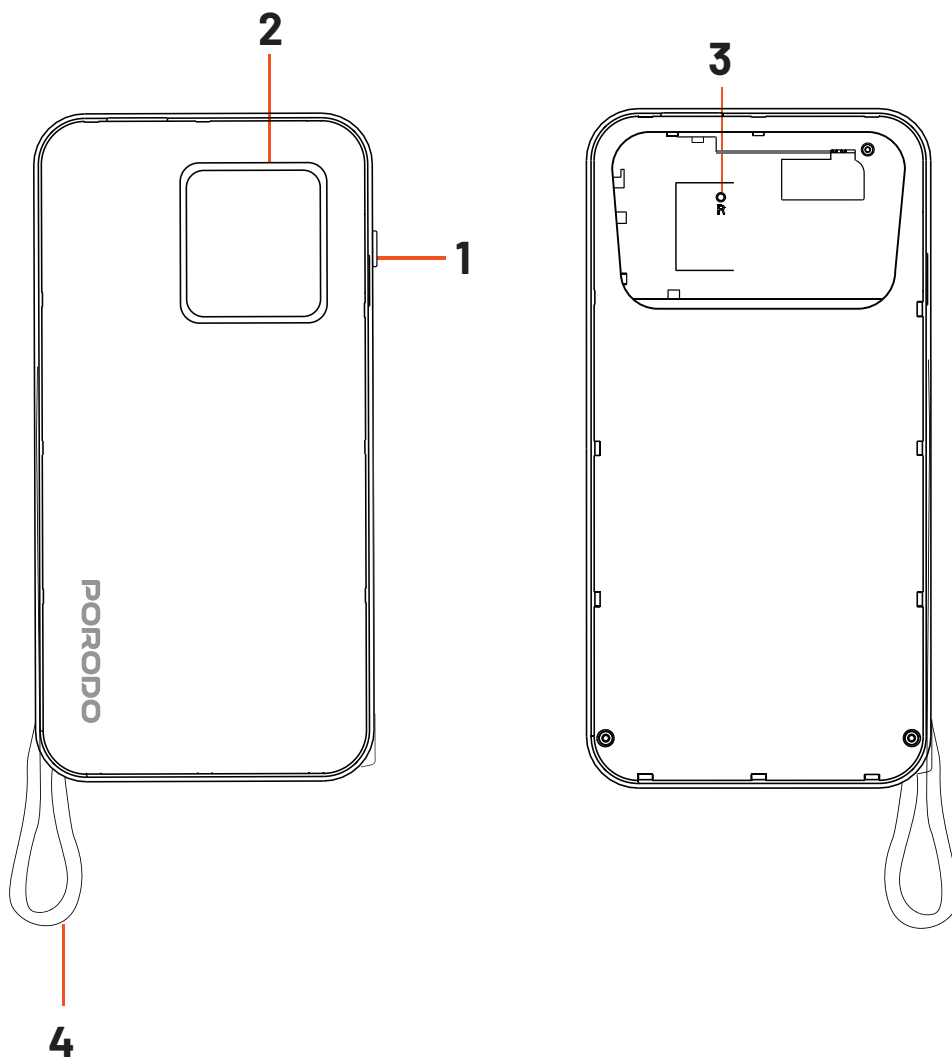

- 1.** Power on/off button: Press and hold the power button to turn the device on or off. Wake the device up when it is dormant.
- 2.** LCD Screen: Displays the current device status.
- 3.** Reset Button: The device will reboot and restore the factory defaults by using a pin for 5 seconds while the device is powered on.
- 4.** Type-C Super Fast Charging Cable: Used for charging the device. Can also be connected to a PC or portable computer.
- 5.** Charging Port: Used for charging the device. Connect it to a PC or portable computer.
- 6.** Type-C Charging Por: Used to charge devices with a Type-C interface.

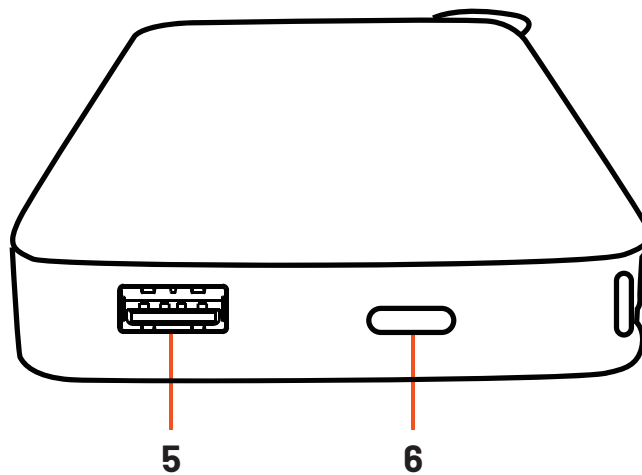

Specifications

Battery Capacity	10,000mAh
Input (USB-C)	5V/3A, 9V/2A, 12V/1.5A, 18W Max
Output (USB-C)	5V/3A, 9V/2.2A, 12V/1.67A, 20W Max
Total Output	5V/3A, 15W Max
Max Users	16
Operating Time	26H

Standby Time	15 Days
SIM Card Slot	Nano Card Holder
Model Number	PB087
Wireless Technology	4G LTE (TDD-LTE, FDD-LTE, TD-SCDMA, WCDMA)
4G Frequency Bands	FDD: B20/8/7/3/1 TDD: B40/38 WCDMA(3G): B8/1
4G Download Speed	TDD-LTE: 300Mbps, FDD-LTE: 150 Mbps
4G Upload Speed	TDD-LTE: 300Mbps, FDD-LTE: 50 Mbps
WiFi Bands	2.4GHz
WiFi Standards	802.11 b/g/n/ax
Product Size	18.7 x 71 x 130.5mm
Product Weight	228g

Connecting PC to the Internet via 4G/3G

If your computer does not have a built-in wireless card, you can still connect to the internet by installing the necessary drivers. Simply follow the instructions provided in the connection guide to complete the installation process.

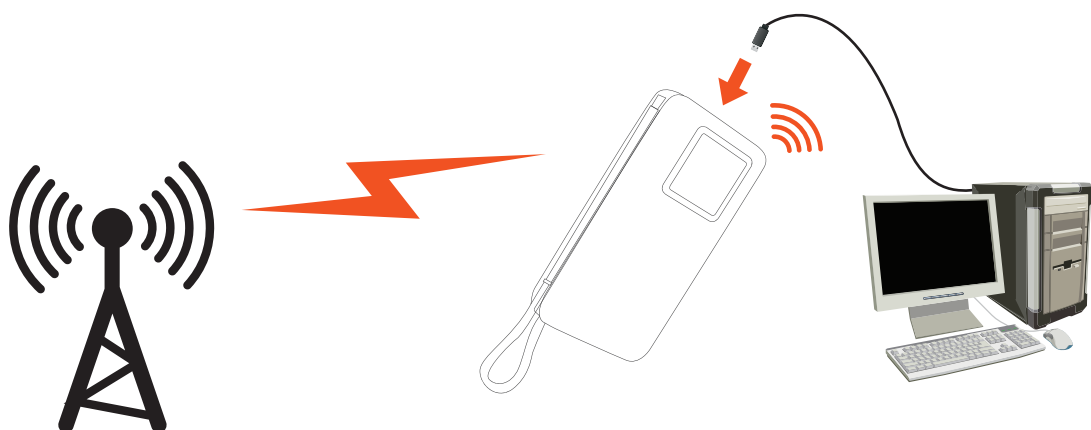

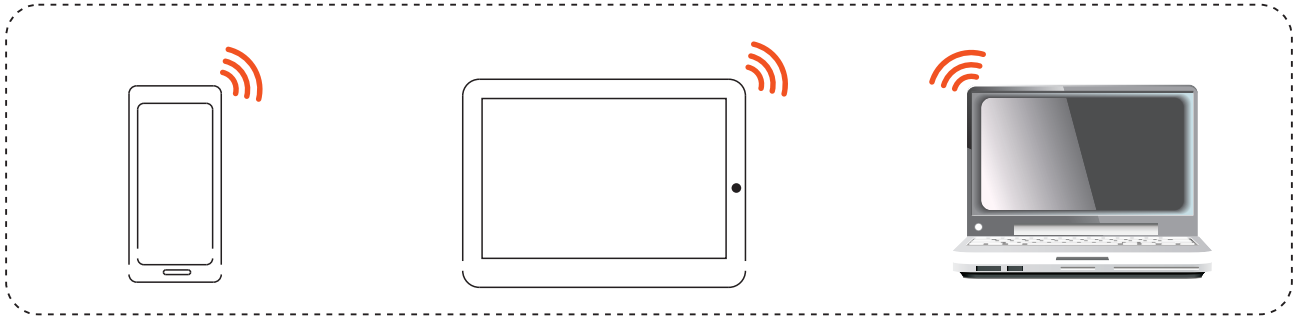

- 1.** If the system does not support automatic CD-ROM installation when the device is connected to the computer, please navigate to "My Computer," locate the CD-ROM drive, and manually run the driver installation.
- 2.** If the automatic installation fails, check if any antivirus or security software is running. If it is, close the software and then try the installation again.
- 3.** If the driver installs successfully but the device is not recognized as a dongle by the computer when connected via USB, ensure that the USB connection is properly established and try again.

Follow the steps below to check if the "AutoRun" feature is enabled on your computer:

- a)** For Windows 7, click Start, then go to Control Panel → Hardware and Sound → AutoRun. Ensure that the option "Use AutoRun for all media and devices (U)" is checked.
- b)** For Windows XP, click Start, then select Run and type gpedit.msc. Click OK, then navigate to Group Policy → Computer Configuration → Local Computer Policy → Administrative Templates → System. Check the setting to confirm if AutoRun is enabled.

System Requirements

Operating System (OS):

Windows XP (32-bit/64-bit)

Windows 7 (32-bit/64-bit)

Windows 8

Windows 10

Windows Vista (32-bit/64-bit)

Browser:

Microsoft Edge

Internet Explorer 7.0 or higher

Safari 4.0 or higher

Connect to the Internet via Wi-Fi

1. When you connect the device for the first time, you will be prompted to enter a password. You can find this information using the following method:
 2. The default Wi-Fi name and password will be displayed on the device's screen.
- Tips:** For enhanced Wi-Fi security, please log into the Web UI page to set a strong Wi-Fi password.

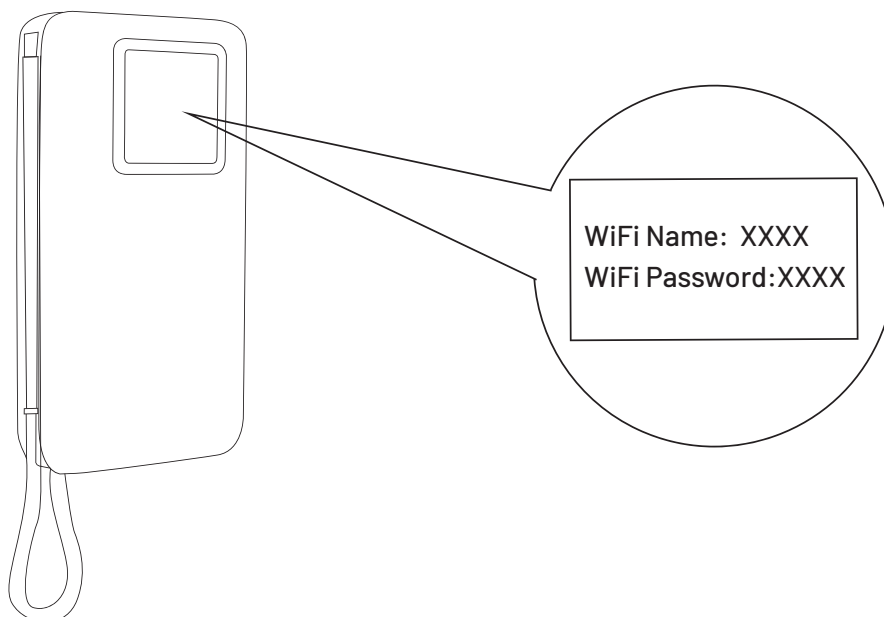

Managing the Web UI Page

1. Account Management

1.1 To log into the management page, follow these steps:

1.2 Open your browser and enter `http://192.168.0.1` in the address bar. If the IP address conflicts with another device, the system will automatically update to a new IP address.

1.3 Enter your password to log into the management page. The default password is admin.

1.4 Once you've logged into the management page, you can access the SMS, Advanced Settings, and Quick Settings functions.

Tips: Click on the top-right corner to change the login password.

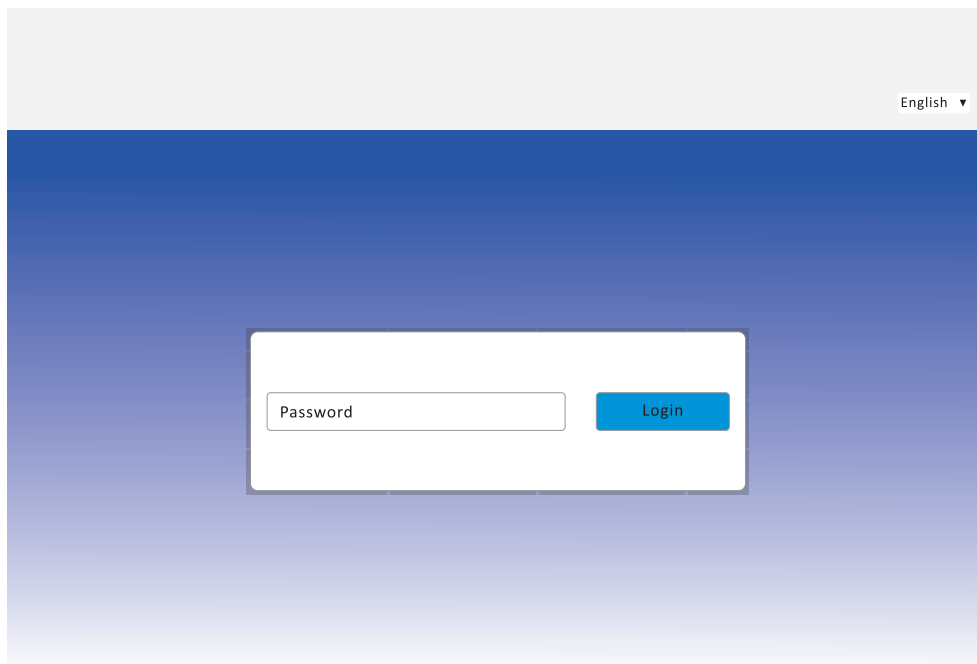

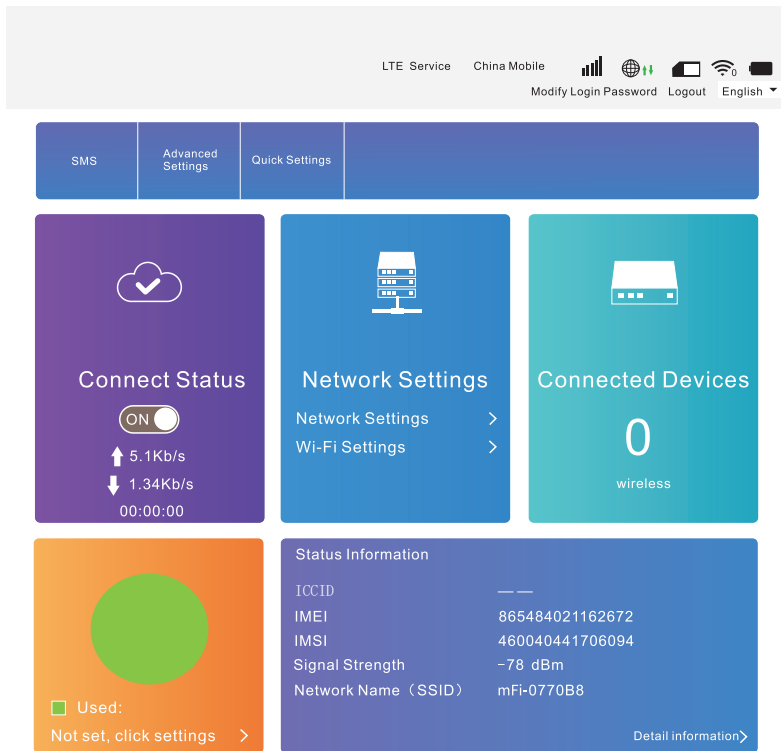

Wi-Fi Connection

Go to Network Settings and click on Wi-Fi Settings to view the Wi-Fi password. Both the main SSID and guest SSID can support up to 10 Wi-Fi users simultaneously.

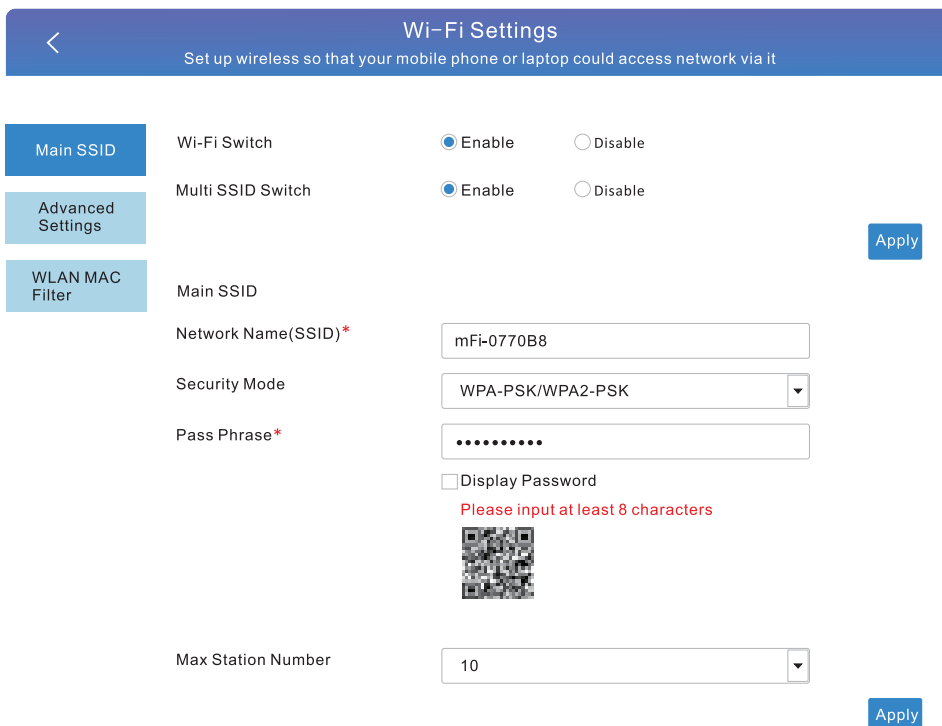

Data Management

Click on Data Management to enter the section, where you can set daily and monthly statistics plans. As shown, you can also create and apply a flow plan.

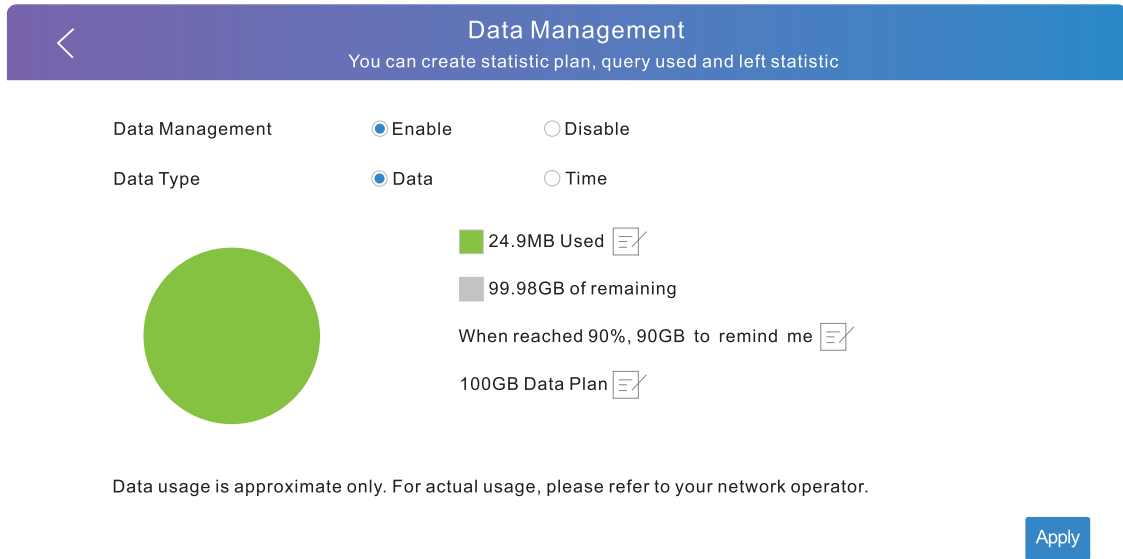

The flow management interface displays the current internet upload and download speeds, usage statistics and connection time for the current session, as well as the total usage and connection time for the current month.

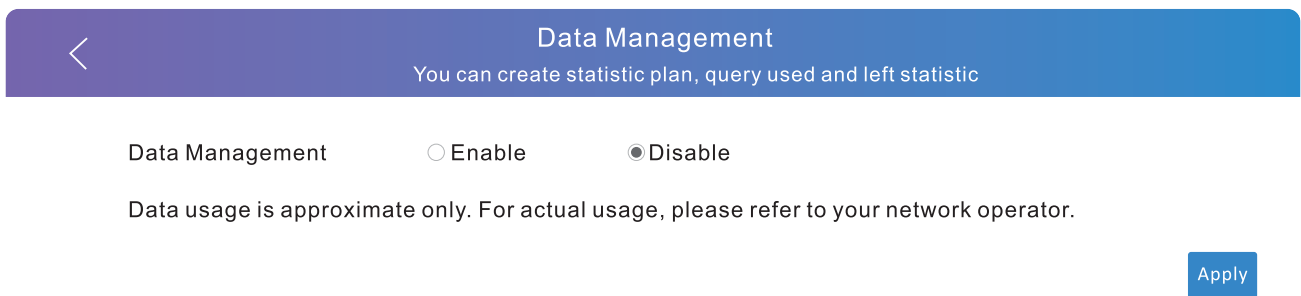

Connection Settings

Selecting the "Automatic" network configuration will display a list of available networks. The list includes all networks detected by the device, allowing the user to choose an available network. The device will then automatically register and connect to the selected network.

Connection Settings

Connection Mode: Network Selection

Network Selection: Automatic (Selected) Manual

Automatic (Dropdown)

Search

Network List

Option	network status	Operator	MCCMNC	Network Type	Sub-standard
<input checked="" type="radio"/>	current	UNICOM	46001	4G	FDD-LTE
<input type="radio"/>	Available	UNICOM	46001	3G	WCDMA
<input type="radio"/>	Forbidden	CT	46001	4G	FDD-LTE
<input type="radio"/>	Forbidden	CMCC	46000	3G	TD-SCDMA
<input type="radio"/>	Forbidden	CMCC	46000	4G	TD-LTE

Registered

APN Settings

When in Automatic Mode, the APN settings will be automatically configured based on the inserted SIM card. (Note: SIM-locked devices do not support this feature.)

Connection Settings

Connection Mode: APN

Current APN: 162532

Network Selection: Mode Auto Manual

APN: Profile 162532 (Dropdown) Cancel

PDP Type: IPv4 (Dropdown)

Network information: Profile Name* (Text Field)

APN* (Text Field)

Authentication: NONE (Dropdown)

User Name (Text Field)

Password (Text Field)

Dial NO.: *99#

Apply

Safety Precautions

- 1.** Avoid using the equipment in dusty, wet, or dirty environments, or near strong magnetic fields, as this can cause internal circuit failure.
- 2.** Do not use the equipment during thunderstorms, as this may lead to equipment failure or an electric shock hazard.
- 3.** Use the equipment within a temperature range of -10°C to $+40^{\circ}\text{C}$, and store it and its accessories within a temperature range of -20°C to $+60^{\circ}\text{C}$. Extreme temperatures, whether too high or too low, may cause equipment failure.
- 4.** Place the equipment and its accessories in a well-ventilated, cool environment, away from direct sunlight. Do not cover the equipment with towels or other items. Avoid placing the equipment in a closed environment, such as a box or case, as this can lead to overheating and damage due to poor heat dissipation.
- 5.** Do not place the equipment in direct sunlight, such as on the instrument panel or windowsill.
- 6.** Avoid exposing the equipment and its accessories to rain or moisture, as this could lead to fire or electric shock.
- 7.** Keep the equipment away from heat sources or exposed flames, such as electric heaters, microwave ovens, stoves, candles, or any other areas that may produce high temperatures.
- 8.** The equipment will become warm after extended use. If the temperature becomes too high, avoid touching it for prolonged periods, as this could cause low-temperature burns, skin irritation, or pigmentation.
- 9.** When using the equipment, refrain from touching the antenna, as it may impact communication quality.
- 10.** Keep the equipment and its accessories out of reach of children and pets to prevent injury or potential equipment damage or explosion.

Disposal

This product must not be disposed of as unsorted household waste. It is important to separate such waste for proper treatment and recycling, in compliance with local waste management regulations.

Warranty

Products that you buy directly from our **Porodo** website or shop come with a 24-month warranty.

When you buy **Porodo** products from any of our approved sellers, you only get a 12-month warranty. If you want to extend this warranty, go to our website at **porodo.net/warranty** and fill out the form with your information. Don't forget to upload a picture of the product too. After we've checked and accepted your request, we'll send you an email to confirm that your product's warranty has been extended.

For more info, please check:
porodo.net/warranty

Contact Us

If you have any questions about this Privacy Policy, please contact us at:

info@porodo.net

Website: **porodo.net**

Service Support: **support@porodo.net**

Instagram: **porodo**