



RAVEK

POLARIS RANGER 1500XD 2024+ *TAIL LIGHT*

PLUG & PLAY MULTI-FUNCTION



INSTRUCTION MANUAL



RAVEK

POLARIS RANGER 1500 2024+ **PLUG & PLAY MULTI-FUNCTION TAIL LIGHT**

Part #: 64-1011

Fitment: Polaris Ranger 1500XD 2024+

PARTS INCLUDED:

- **UTV Multi-function Tail Light (1x)**
- **Main Harness (1x)**
- **Tail light Extension Harness (1x)**
- **Work Light Harness (1x)**
- **Battery Positive Harness (1x)**
- **Zip Tie (10x)**
- **Adhesive Promotor Wipe (2x)**
- **Rubbing Alcohol Wipe (2x)**
- **Heat Shrink (1x)**
- **Battery Negative Harness (1x)**
- **Rocker Switch (1x)**

INSTALL VIDEO TUTORIAL

DON'T LIKE INSTRUCTIONS?

**VISIT OUR WEBSITE
TO ACCESS THE
VIDEO TUTORIAL.**



NOTE: Throughout this process, be sure to keep track of any screws or fasteners you remove as they will be re-installed in the same location.

NOTE: Make sure your vehicle is off and key is out of the ignition before starting.

1

MAKE YOUR CONNECTIONS

i Access the multipin harness on your Ranger 1500XD and locate the connectors labeled “RIGHT APEX” and “LEFT APEX.” Plug the extension harnesses into these connectors, then connect the tail light to their corresponding extension connectors. [SEE FIGURE 1A – 1D]

- **NOTE:** If your Ranger 1500XD does not have the RAVEK TSK system installed and you wish to run this light as a standalone setup, please call 855-617-2787 for assistance.

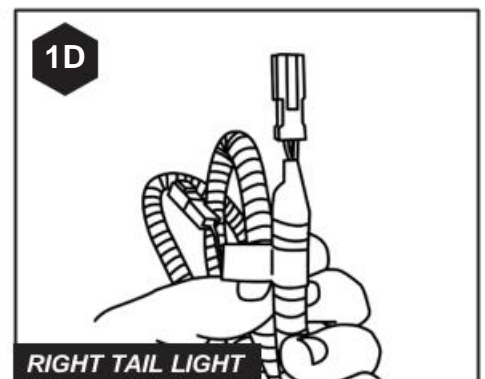
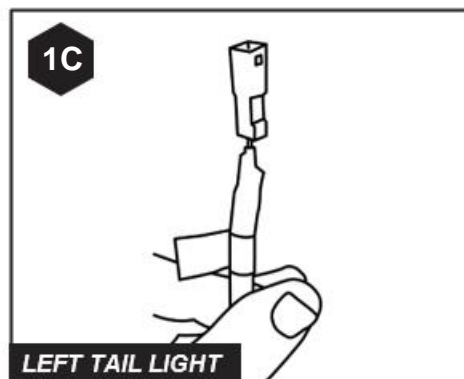
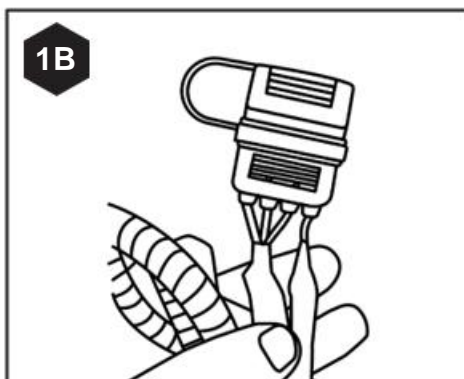
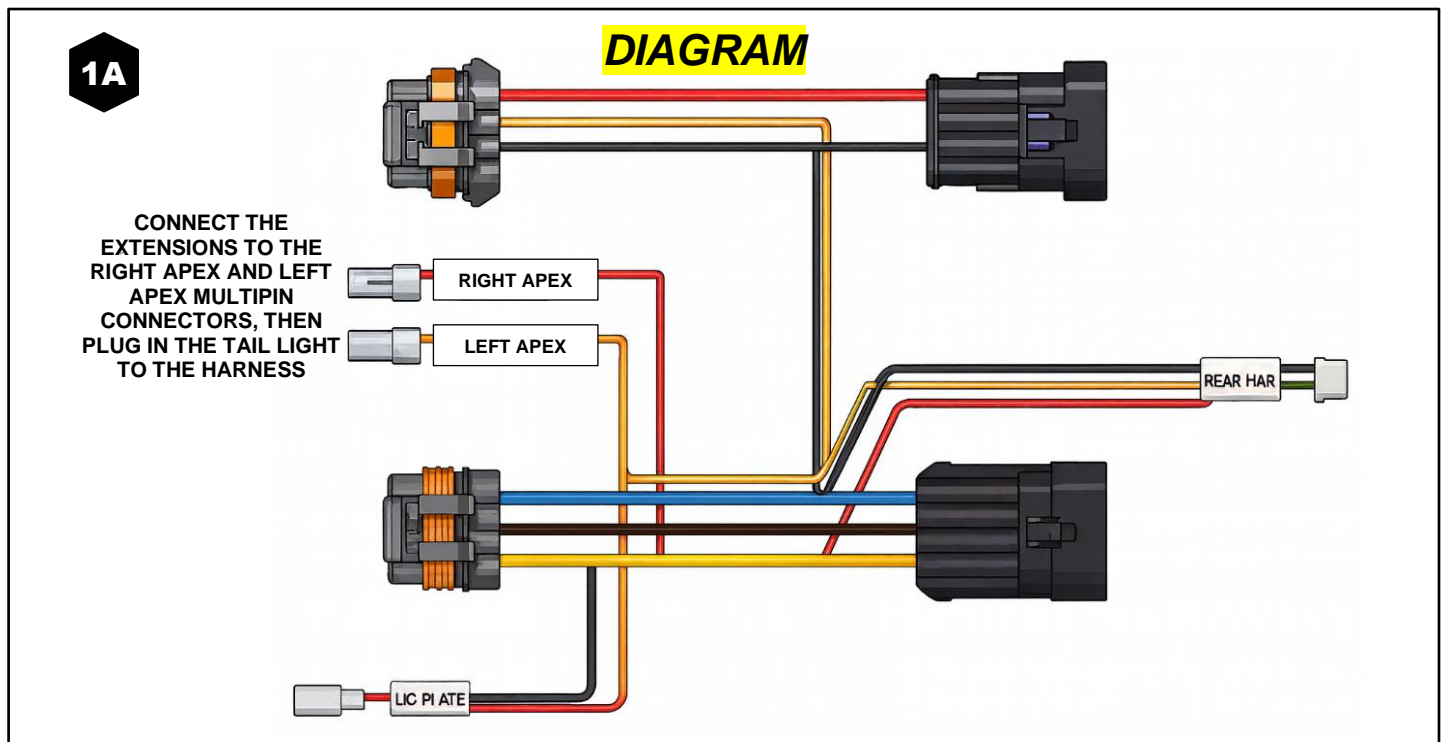



Set your Main Harness (harness with the controller box) in the engine compartment and make the following connections [SEE FIGURES 1E – 1G]:

- Plug in the 1-pin connector coming out the white wire on the Main Harness to the Work Light Harness (harness with relay)
- Plug in the trailer connector coming out the Main Harness to the connector on the Tail Light Extension Harness on the middle of the Ranger 1500XD
- Plug in the 4 pin connector coming out the Main Harness to the connector on the light connector on the light to the left side of the Ranger 1500xd

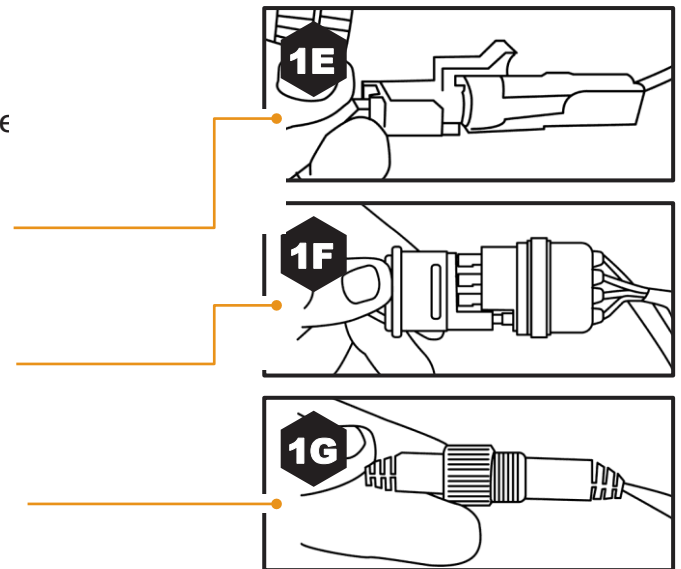

Remove one rocker switch knock out from the rocker switch panel by gently prying it off using a SMALL FLATHEAD SCREWDRIVER. You'll be installing the rocker switch provided in this slot in a future step. [SEE FIGURES 1H & 1I]

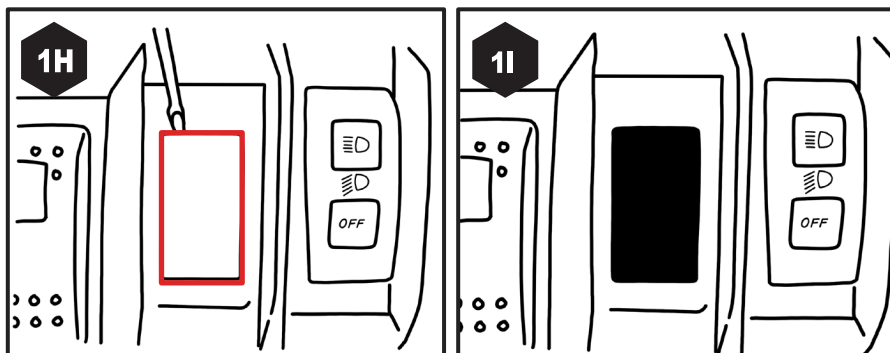

2

MOUNT LIGHT

i

Wipe your tailgate's surface using one of the rubbing alcohol wipes provided. Let dry.

Wipe the same surface with one of the adhesive promoter wipes provided. Let dry. [SEE FIGURES 2A-2]

Figures A & B for visual reference of how to install your light [SEE FIGURES A & B]

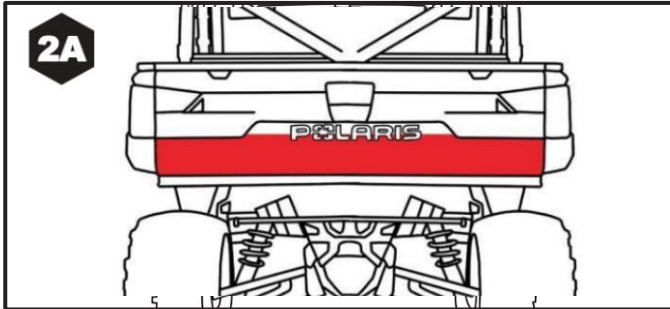

ii

Locate the four mounting clips provided in the kit. [SEE FIGURE 2D]

Clean the back surface of the mounting clips using a rubbing alcohol wipe. Let dry. [SEE FIGURE 2E]

Wipe down the surface of the mounting clips with the adhesive promoter wipe. Let dry. [SEE FIGURE 2F]

Place the double sided tape on to the back surface of the mounting clips and place them on the back of the light. [SEE FIGURE 2D - 2I]

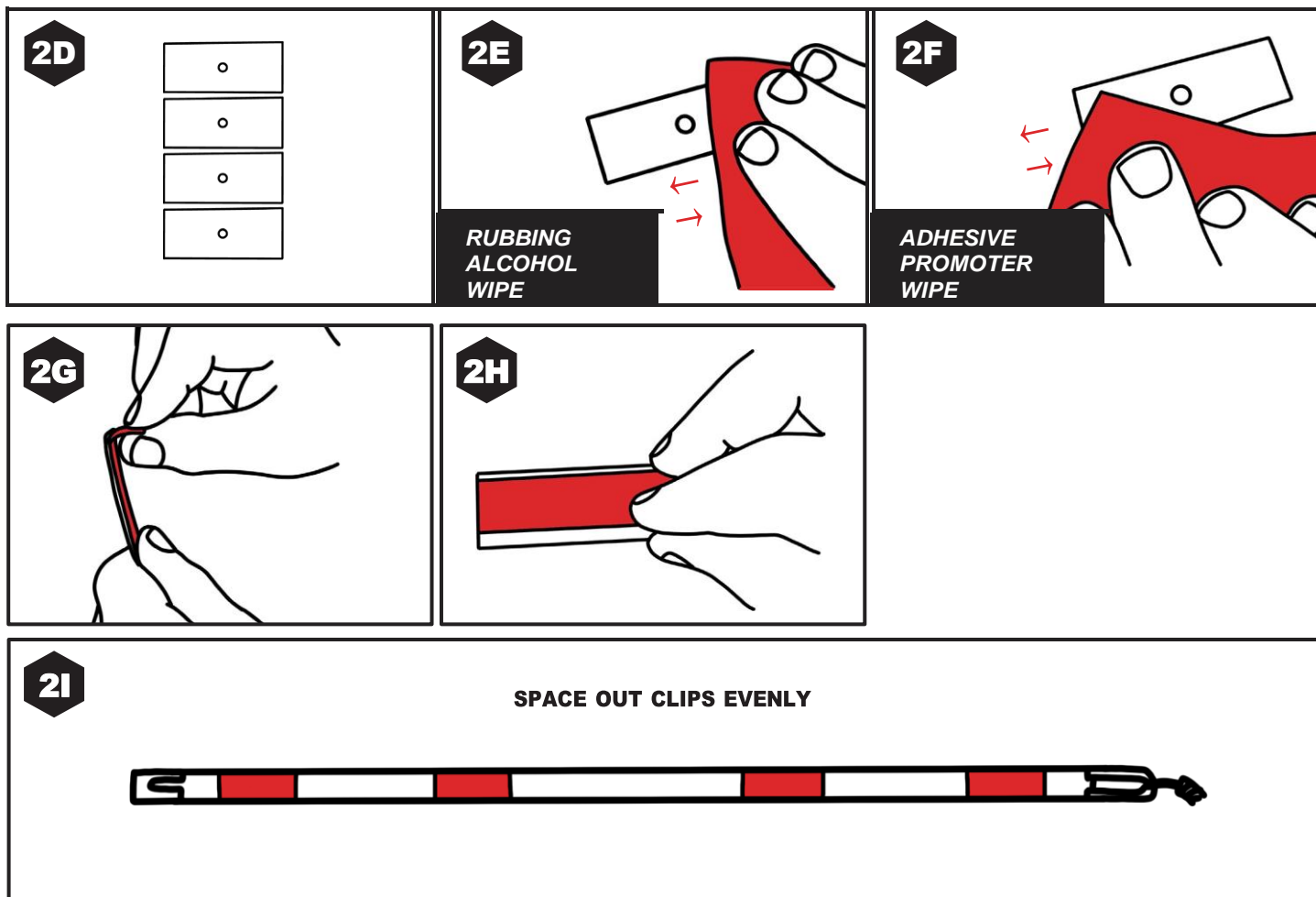

iii

If your light's wire has a corrugated loom and you prefer not to use it—or you're installing the hidden-wire setup—simply grab the loom and peel it off. The loom is split, so it removes easily by hand with no tools needed. [SEE FIGURE 2J]

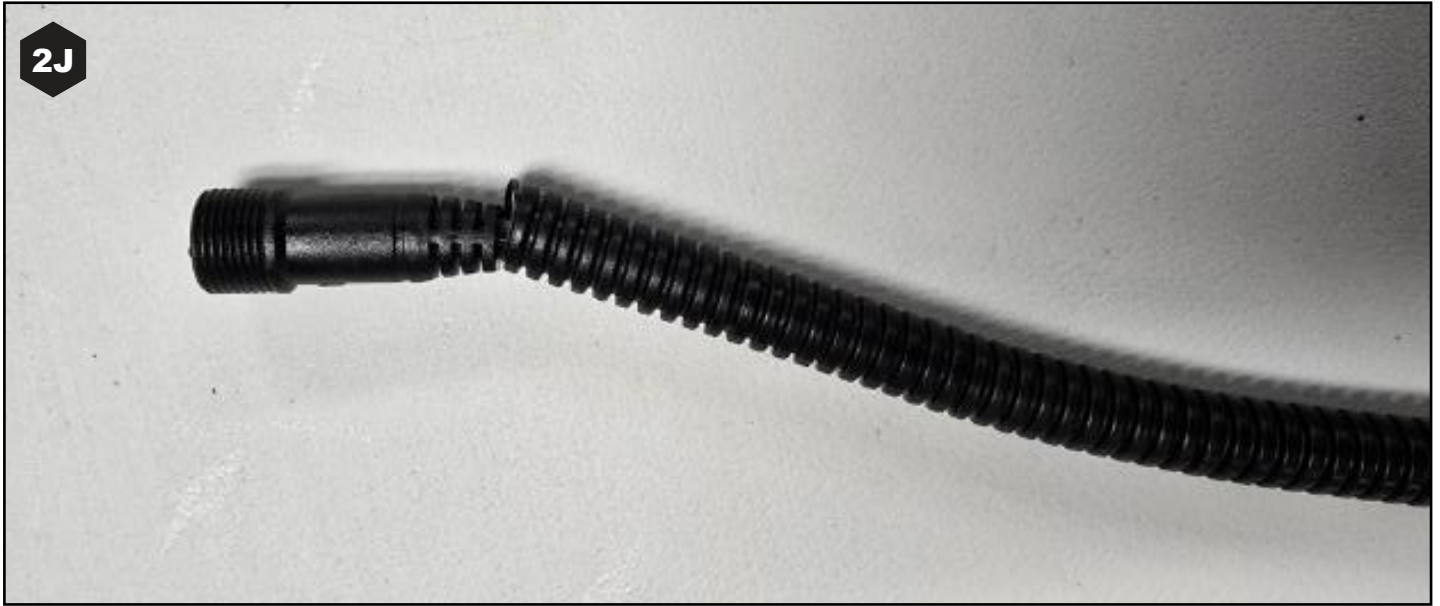

iv

Identify your mounting location, peel the adhesive on the mounting clip, position the light with the outer clips fully extended, tape the top and left edges of the end cap as a guide, mark the midpoint and the taper point on the end cap, remove the light while leaving the clip in place, transfer the intersecting marks onto the vehicle, drill a ½" hole at that mark, and reinstall the light by feeding the wire through the drilled hole.

[SEE FIGURE 2K – 2N]

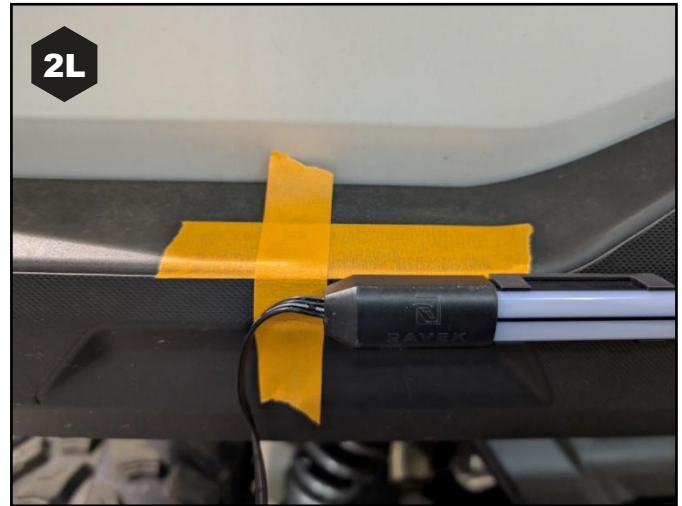

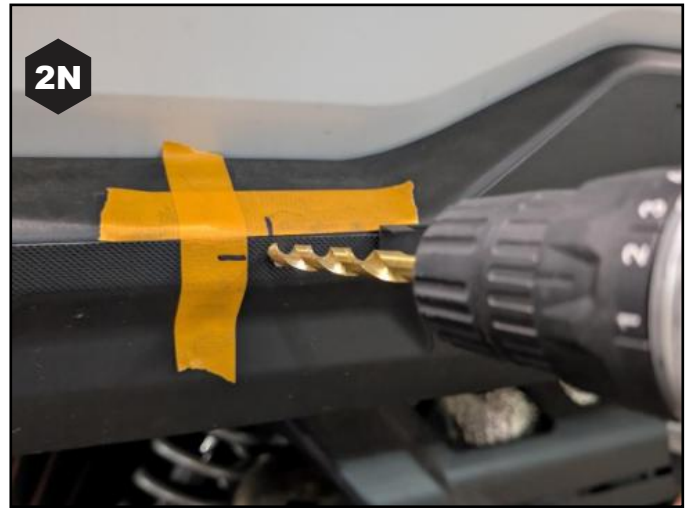
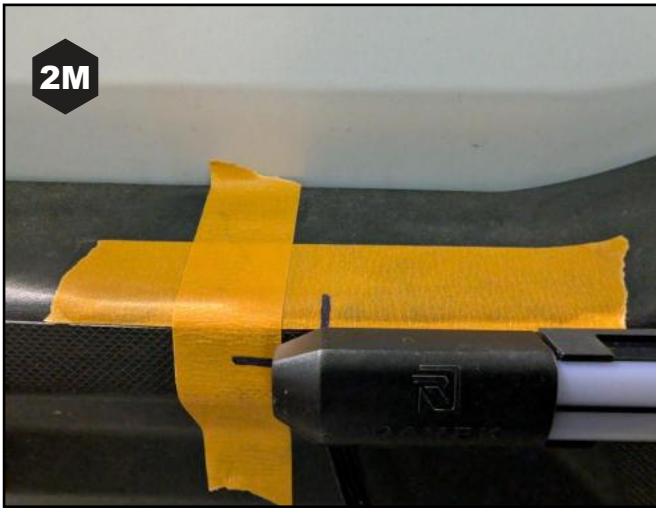

V

Peel off the double sided tape protective film and stick the light to the clean tailgate surface. [SEE FIGURE 2O]

NOTE: Install the light so the RAVEK logos on the end caps are right side up. [SEE FIGURE 2P]

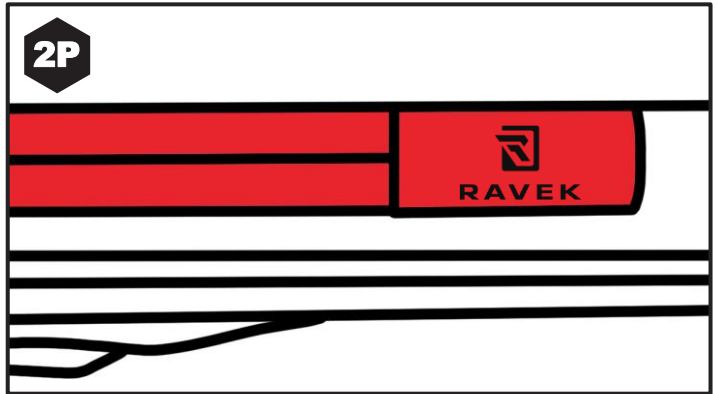
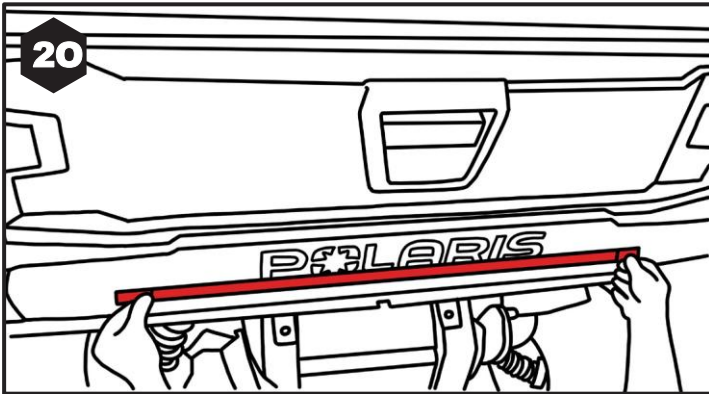

3

HOOK UP ROCKER SWITCH

i

Grab both your Battery Negative and Battery Positive Harnesses. Hook the ring terminal to the corresponding accessory battery terminal and re-install 10mm nut on positive and negative battery terminals. [SEE FIGURES 3A & 3B]

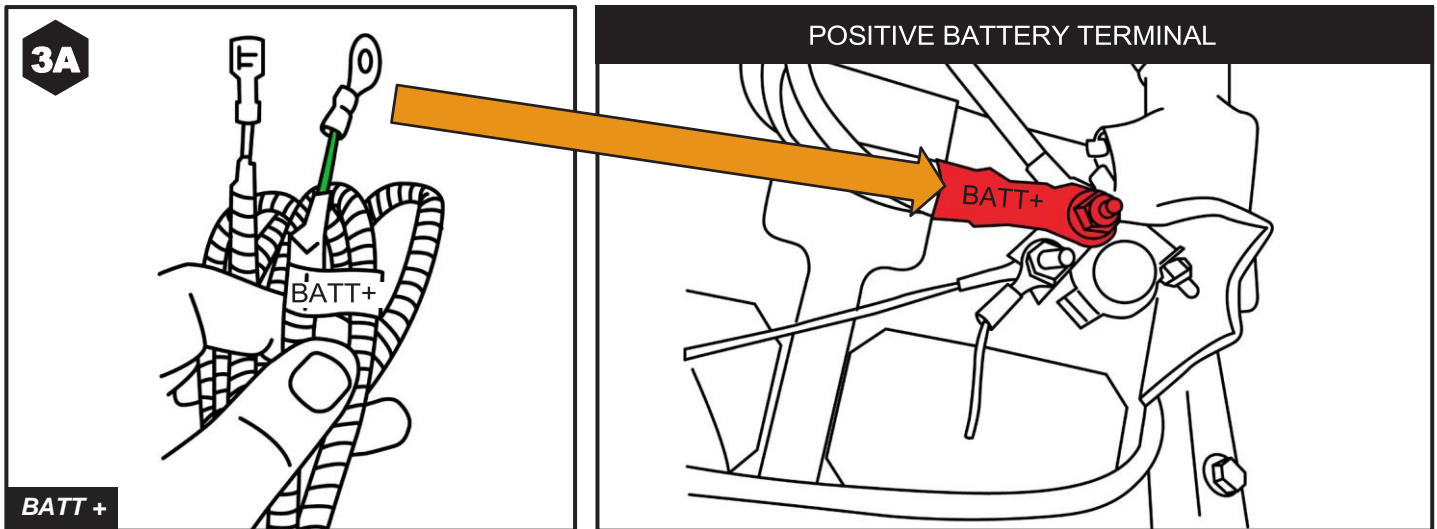

ii

Grab the red spade connector on the Work Light Harness, the two black spade connectors from the Battery Negative Harness, and the green spade connector from the Battery Positive Harness, and bundle all four spade connectors together.

Route all four spades to the open rocker switch location referenced in step 1.i. [SEE FIGURES 4C-4F & DIAGRAM A]

NOTE: Be sure to keep all wiring away from hot or moving components.

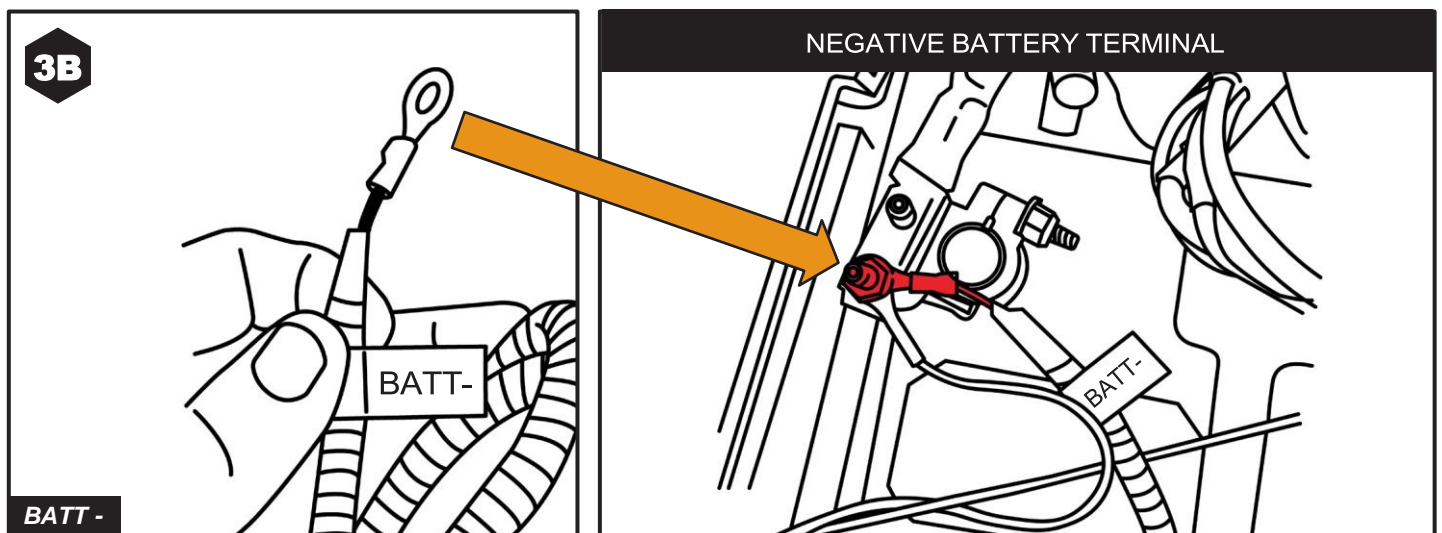

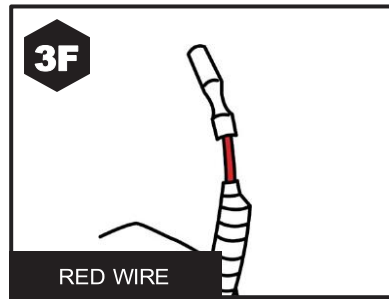
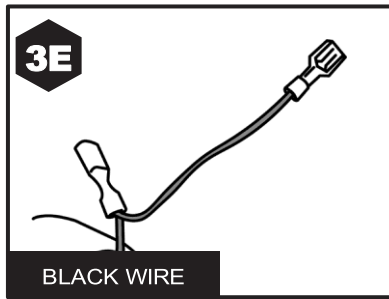
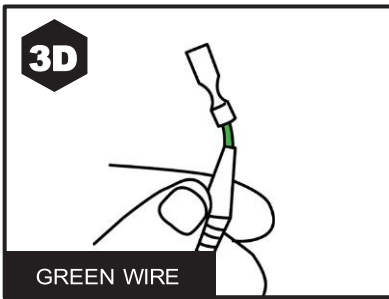
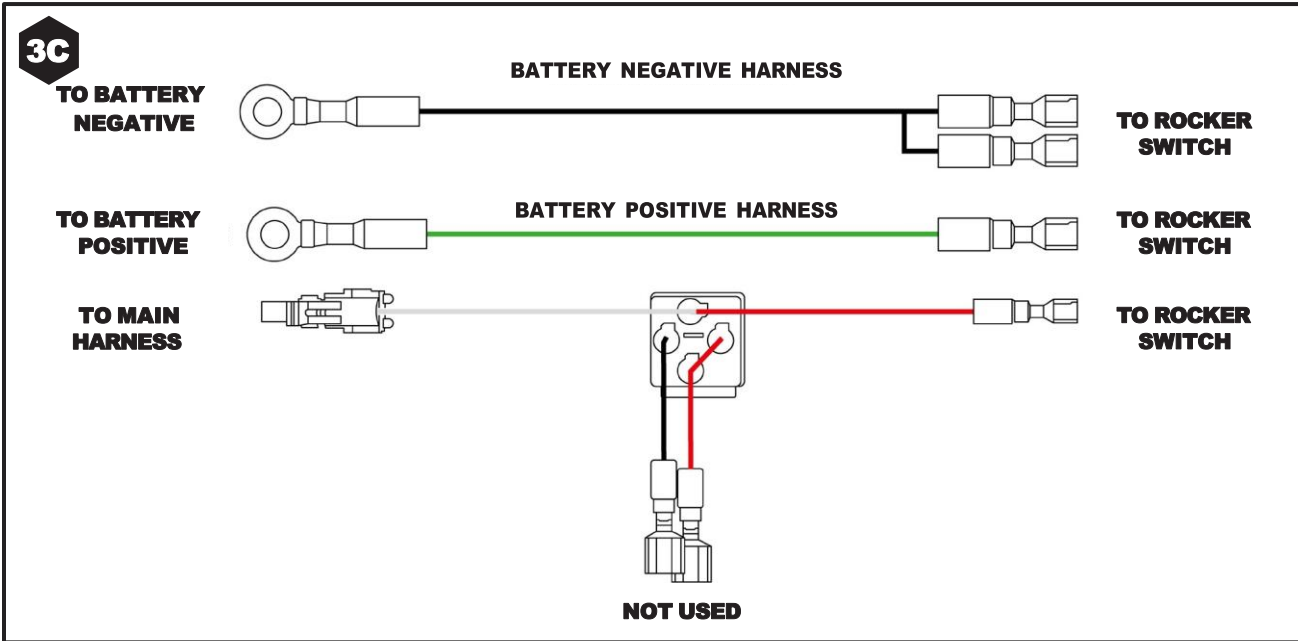

Reference diagram below to connect each spade connector to the appropriate spade terminal on the backside of the rocker switch.

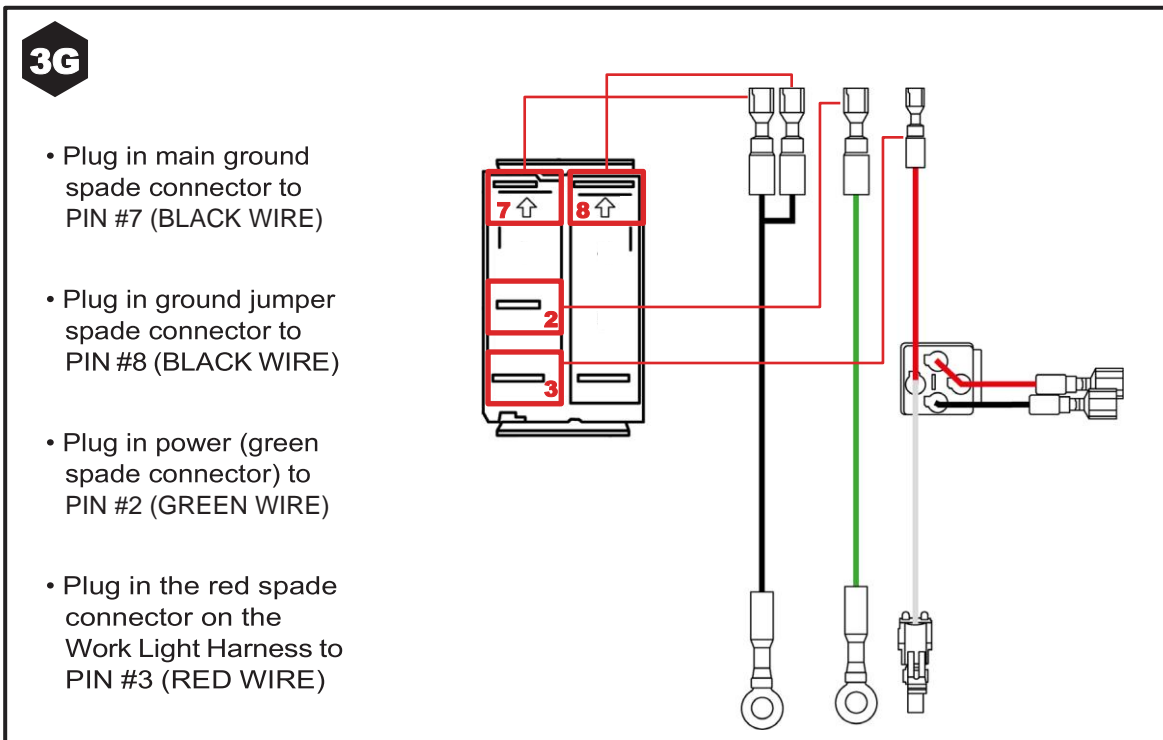



Now is time to confirm light works as designed:

- Red Running Light
- Brake Light
- White Work Light (with vehicle on or off)

NOTE: If you have a turn signal kit hooked up to your Ranger 1500XD; verify the turn signal feature built into the light.



TIDY UP YOUR MACHINE



Go over all your wiring and secure it to the different frame tubes and OEM harnesses.

NOTE: Stay away from hot or moving components.



Once all of your wiring is secured with the help of the zip ties, cut all the excess zip ties using side cutter pliers.



RAVEK

BUILT FOR MORE

WHY RAVEK

Stock UTVs don't come with enough storage, lighting, comfort, and protection. That's why we started RAVEK.

We live to design, manufacture, and test innovative SxS upgrades that elevate the riding experience. Here's what you can expect from us:

- Durable products built to last (100% lifetime guarantee)
- UTV upgrades thoughtfully designed & tested by riders
- Outstanding installation support (videos & USA customer service)
- Constant flow of epic riding content (check out our social media)

We're confident your RAVEK product will earn its place on your machine. Please call or e-mail us if we can help.

- Harry & Ricky (Brothers & Owners)



YOU BREAK IT, WE REPLACE IT. NO QUESTIONS ASKED