

**Installation & Operating Instructions
RS Pro 10...150A AC CCT2
CURRENT TRANSFORMER**

1. INTRODUCTION

CT Transducer is a very reliable, efficient and robust current transformer for measurement of AC current.

It provides 4...20 mA or 0...5/10 V DC output. It can be used for network analysis, monitoring.

2. FEATURES

- 1) Measurement of AC current for frequency 50/60Hz, provides proportional 4... 20 mA or 0... 5/10 V DC.
- 2) High electric isolation between primary conductor and output.
- 3) Easy and safety electrical connection by means of self lifting clamp provided.
- 4) Compact model size.
- 5) Wire sealable terminal covers.
- 6) High accuracy : Class 0.5 all models.

3. TECHNICAL PARAMETERS

Measuring range (In)	0...150A
Frequency range	50/60 Hz
DC Output	DC: 4... 20 mA , 0... 5/10 V
Max. burden resistance at output	For Current O/P : R = 600 max. @24V Aux. B R = 300 max. @15V Aux. B For Voltage O/P : R = 1M min. for 10A to 20A CT Ducer. B R = 200k min. for 100A to 150A CT Ducer.
Accuracy (IEC 60688)	± 0.5 %
Isolation test voltage (IEC 61010-1)	3kV AC, 50 Hz, 2 Seconds Input terminals Vs Housing
Auxiliary voltage	24 V DC, ±15%
Response time	< 350ms
Installation category	III
Thermal nominal continuous rated current	1.2 x In
Protection class	IP20
Operating temperature	0 °C < TU < +70 °C, 0...95% rH, without condensation
Storage temperature	-40 °C < TL < +90 °C
Max. temperature of primary conductor	100 °C

5. CONNECTIONS

1.0 Connection diagram for Rish CT (Current O/P):

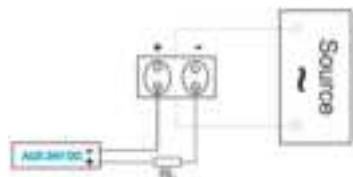

Fig. 1.0 (Loop-Powered)

1.1 Connection diagram for Rish CT (Voltage O/P):

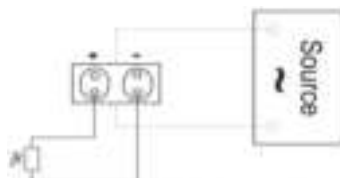
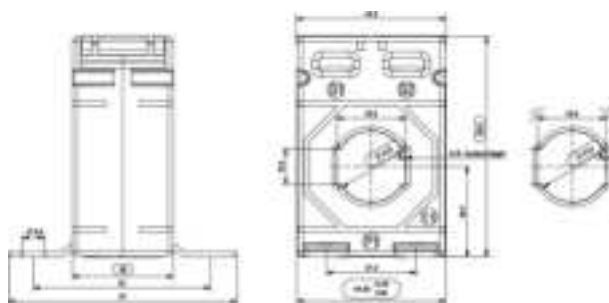

Fig. 1.1 (Self-Powered)

6. MODELS

44x 21x 30 mm	Transformer width: 44 mm	Bus bar: 20x10 mm
Model	Transformer height: 65 mm	Round conductor: 21 mm
Dimensions:	Transformer depth: 30 mm	



7. OPTIONS

Types	Primary Current	Bus bar: 20x10 mm
CCT2 (44/21/30)	10	4... 20mA DC
	20	
	50	
	100	
	150	

Types	Primary Current	Voltage Output
CCT2 (44/21/30)	10	0... 5/10 V DC
	20	
	50	
	100	
	150	

8. CONNECTIONS

The CCT2 comes with M4 screws with self lifting clamp strap assembly. Insert the output wires and tighten them with the help of a screw driver.

Mounting

For mounting use wall mounting clamps provided with the CCT2.

Scope of supply:

1. CCT2 1 No.s
2. Wall Mounting Clamp
3. Test Certificate 1. No.s
4. Operating Instruction Manual.

The Information contained in these installation instructions is for use only by installers trained to make electrical power installations and is intended to describe the correct method of installation for this product. However, Company has no control over the field conditions which influence product installation. It is the user's responsibility to determine the suitability of the installation method in the user's field conditions. Company only obligations are those in Company standard Conditions of Sale for this product and in no case will Company be liable for any other incidental, indirect or consequential damages arising from the use or misuse of the products.

FOR MORE INFORMATION VISIT THIS SITE
<http://www.rs-components.com/index.html>



Every part matters