

Item # 1012858311
Model # 113A062OAT

ASSEMBLY/USE CARE INSTRUCTIONS

DAPHNE SLEEPER SOFA OATMEAL

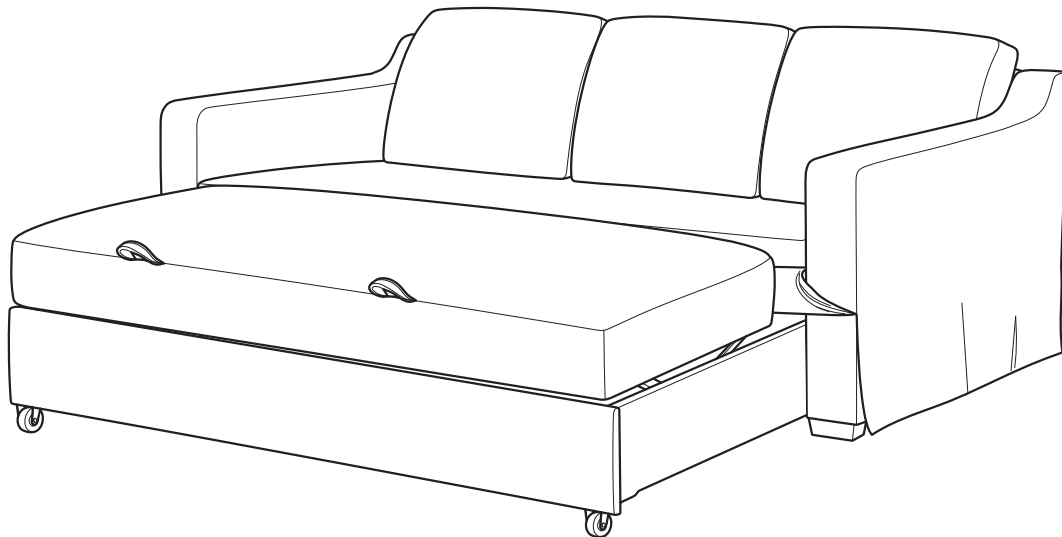
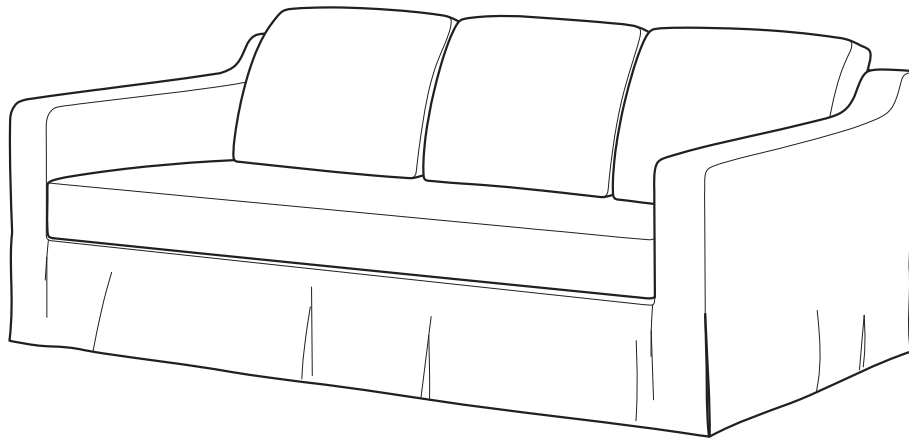

THANK YOU

We appreciate the trust and confidence you have placed in our product through the purchase of this DAPHNE SLEEPER SOFA. We strive to continually create quality products designed to enhance your home. Visit us online to see our full line of products available for your home improvement needs. Thank you for choosing DAPHNE SLEEPER SOFA!

Table of Contents

Table of Contents	2	Pre-assembly (continued)	5
Safety Information.....	2	Function	6
Warranty	3	Function (continued)	7
1 Year Warranty	3	Maintenance	8
What is Covered	3	Care and Cleaning	8
What is Not Covered	3	Troubleshooting.....	8
Pre-assembly	4	Table	8
Planning Assembly	4		
Tools Required	4		
Package Contents	4		

Safety Information



DANGER

- Keep small parts away from children during assembly.
- Read and follow instructions carefully.



WARNING

- Read these instructions carefully and keep in a safe place.
- **TO GUARANTEE THE SAFE USE OF THIS PRODUCT, FOLLOW THE WARNINGS, GUIDELINES AND RECOMMENDATIONS IN THIS MANUAL.**
- Adult assembly required. We recommend a team of 2 for handling and assembly.
- Small parts may present choking hazard prior to assembly.
- Do not stand, step or climb on unit.



CAUTION

- Do not use power tools to assemble your furniture. Power tools may strip or damage parts/product.
- Do not overtighten connectors (screws, bolts, etc.). Overtightening can lead to product damage.
- Be sure to check all packing materials carefully for small parts that may have come loose inside the carton during shipment. If parts are missing, contact the store to obtain any missing parts.
- **DO NOT USE SUBSTITUTE PARTS.**
- This product should only be used on a flat, level surface.
- Product is designed to hold on two or three average adult. Exceeding this limit may damage the product or cause injury to the user.
- This product is designed for home use and not intended for commercial use.

Warranty

1 YEAR WARRANTY

WHAT IS COVERED

We guarantee this product to be free of manufacturing defects to the original purchaser for one year from original date of purchase.

Our products carry a one-year limited warranty pursuant to the terms set forth herein. This warranty is valid only to the original purchaser with proof of purchase, and constitutes the original purchaser's sole and exclusive remedy. Pursuant to this warranty. We warrant that all products sold pursuant to this Agreement shall be free of any defects in parts and workmanship if used under normal operating conditions.

THIS IS THE ONLY WARRANTY MADE BY US. IT IS MADE EXPRESSLY IN LIEU OF ALL IMPLIED WARRANTIES OF MERCHANTABILITY OR FITNESS FOR ANY PARTICULAR PURPOSE.

Should any parts or workmanship prove defective, we will, at our discretion, either repair or replace the product at no charge (parts only) to the original purchaser for the duration of the product's full warranty.

At all times, we reserve the right to substitute materials with that of a similar quality if the original material is not available. We will not be responsible for any freight charges incurred in repairing or replacing products.

WHAT IS NOT COVERED

This warranty does not cover commercial use, acts of nature, and abusive use.

WE DO NOT WARRANT DAMAGE DUE TO MISUSE OR NEGLIGENCE. This remedy is the original purchaser's **SOLE AND EXCLUSIVE REMEDY** under the Contract of Sale, and in no event shall consequential damages be recovered by the original purchaser. This warranty gives you specific legal rights, and you may also have rights which vary from state to state.

Pre-assembly

PLANNING ASSEMBLY

Ensure you have all parts and hardware required before you start the assembly.

Placing all parts on a clean cloth is recommended to prevent damaging the parts.

Put all hardware or small part in one place to avoid you missing or losing them during assembly.



NOTE: You can prepare other tools or equipment that is deemed necessary besides those listed below.

TOOLS REQUIRED



Gloves

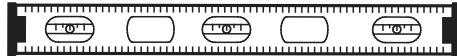

Level

PACKAGE CONTENTS

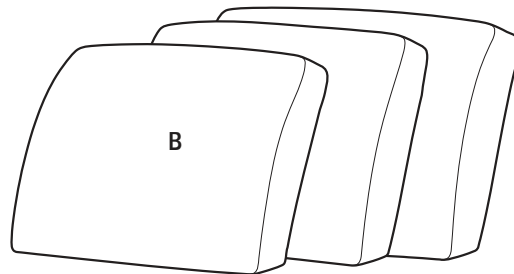
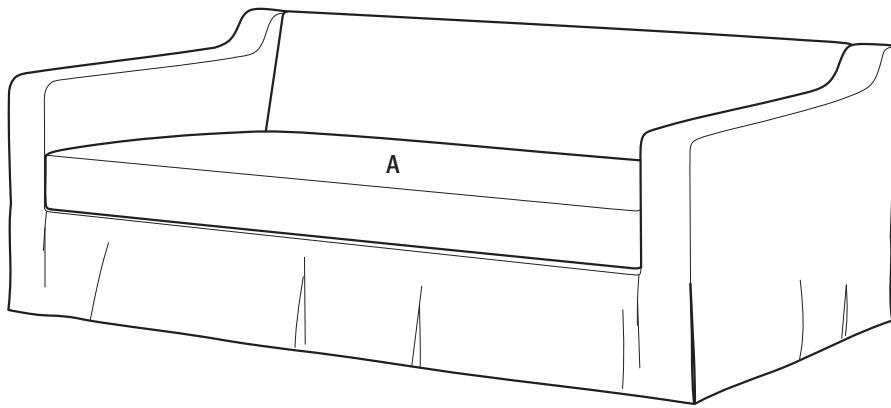

Part	Description	Quantity
A	Sofa Body	1
B	Back Cushion	3

Assembly

1 Back Cushion Placement

- Place back cushions (part B) onto the Sofa Body (part A) as shown.

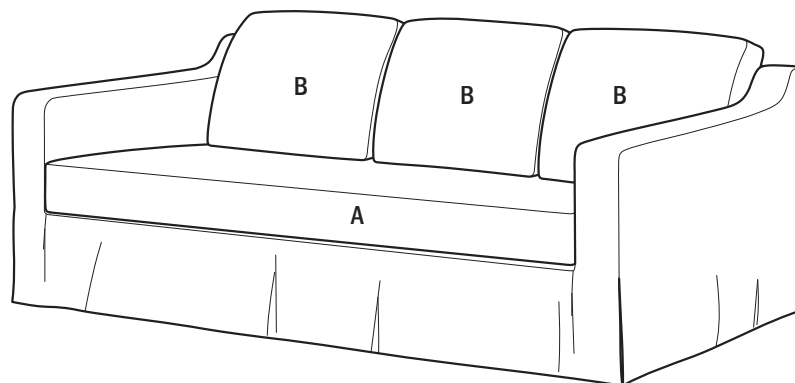
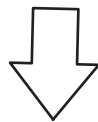
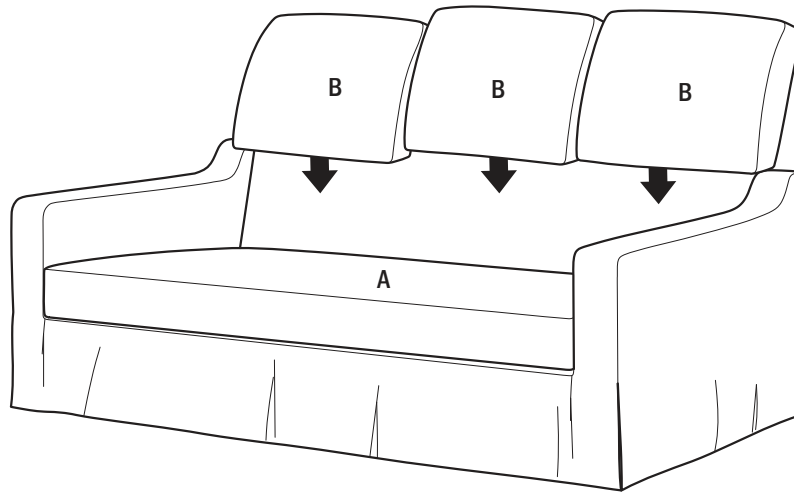

Function

- 1** Insert the skirt edge between arm and seat cushion as shown.

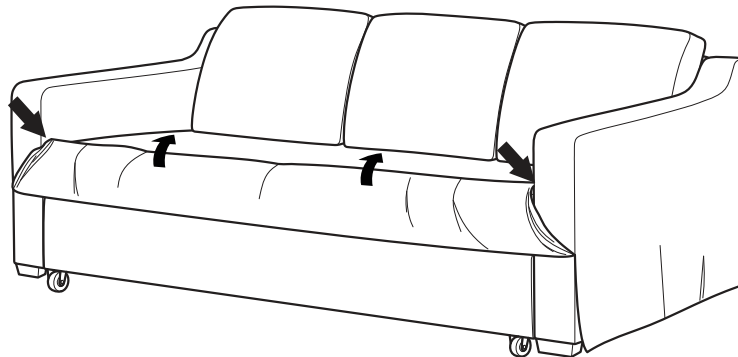

NOTE: Step 1 to 3 is to convert the sofa position to chaise.
Ensure the skirt already stay in place as step 1 shows before operating the unit.

- 2** Slowly pull out the extended seat as shown.

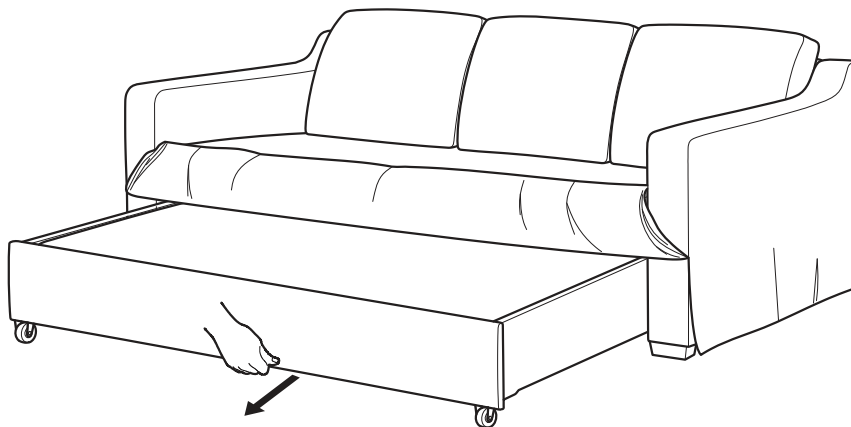

- 3** Gently pull out the extended cushion as images shown.

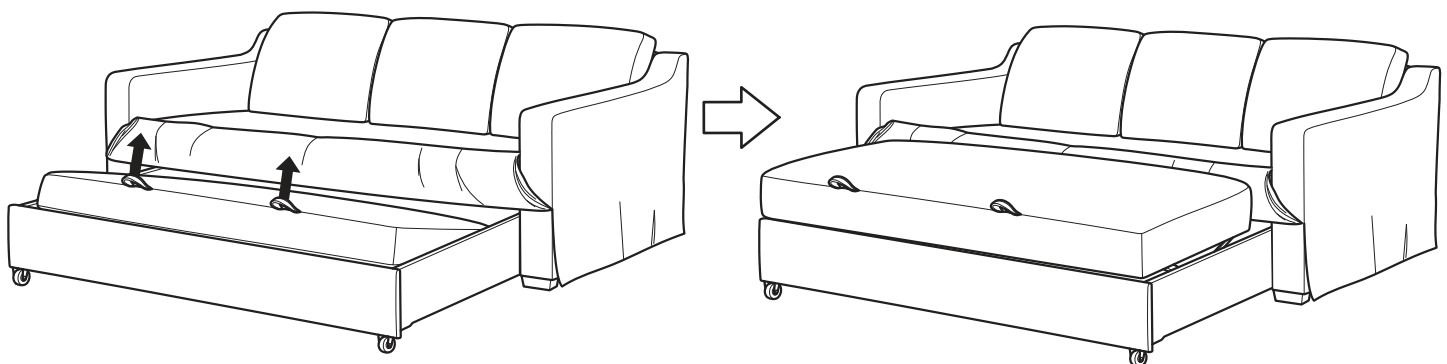

Function (continued)

- 4** Lift and release the extended seat cushion as image shown, and then push it in under the sofa.

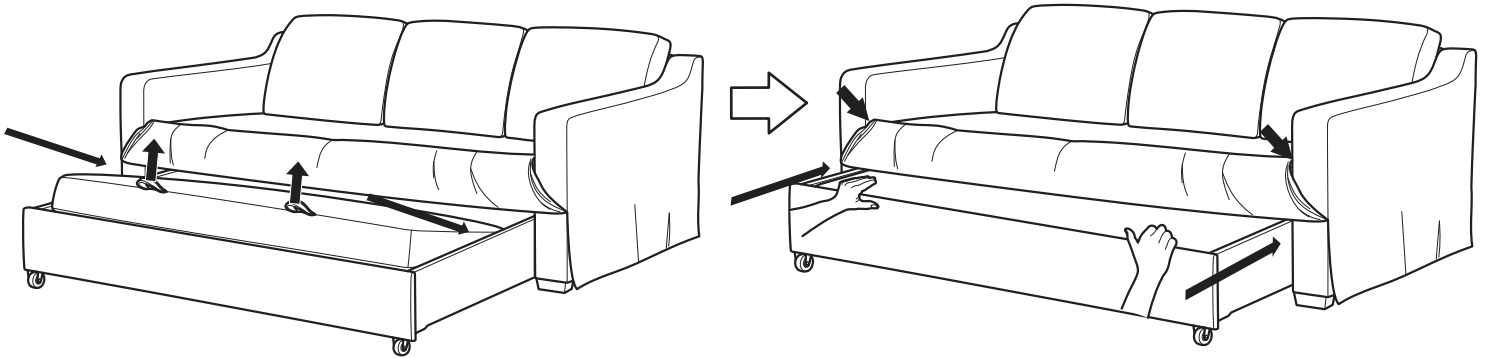

NOTE: Step 4 to 6 is to convert chaise position to sofa.
Ensure the skirt already stay in place as step 4 shows before operating the unit.

- 5** Put back the decorative skirt as image shown.

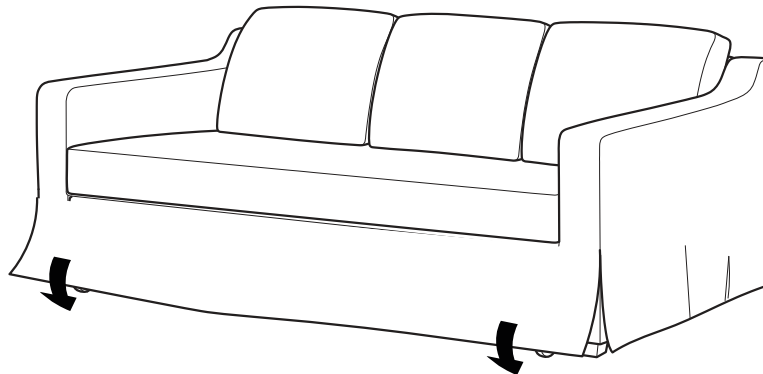

- 6** Introduction of operating the unit complete.

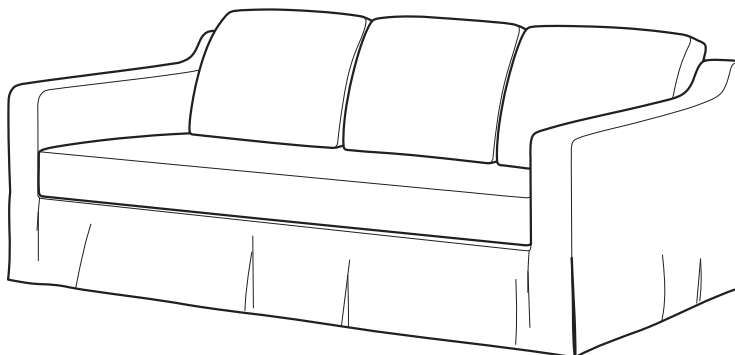

Maintenance

- To keep your DAPHNE SLEEPER SOFA looking its best, dust frequently and gently with a soft, non abrasive cloth. Do not use harsh chemical or abrasive cleaners as they can damage and ruin your sofa. Regularly vacuuming will reduce the amount of dust and debris in the fibers and keep your DAPHNE SLEEPER SOFA neat and clean. Therefore, prolong the life of your sofa by regularly vacuuming low suction. If pilling occurs, we recommend a simple battery operated pilling tool to remove them.

Care and Cleaning

- Spot cleaning. Treat spills and stains as soon as possible. Gently scrape off any dirt or mop any liquid from the surface.
- Always apply cleaning agents to a clean cloth first, not directly to the surface of the fabric. This method will help prevent stains from funneling into the textures or patterns of the fabric.
- Use a water-based upholstery cleaner, then wipe with a slightly damp cloth and pat dry. For best results, consider cleaning entire fabric panels this way.
- Avoid heat. Do not place your DAPHNE SLEEPER SOFA near heating vents or heating items to avoid moisture buildup and possible burn marks and burns.
- Avoid direct sunlight. UV rays will fade any colored fabrics, so keep them out of direct sunlight whenever possible.

Troubleshooting

TABLE

Step	Problem	Possible reason	Solution
1	Can't operate the extended seat	The skirt stuck between the seat and extension.	Carefully take out the skirt and try to operate again.
2	Hard to pull out the extended seat	There maybe foreign object stuck on the wheel	Clean the wheel
3	The skirt is flared out	Wrinkle	Depend on the fabric, you can steam iron to wrinkle free.