

# 4" SLIM SELECTABLE WHITE LED LIGHT

## Install Guide and Manual

### COMPONENTS

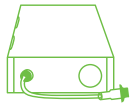

IC Rated Junction Box

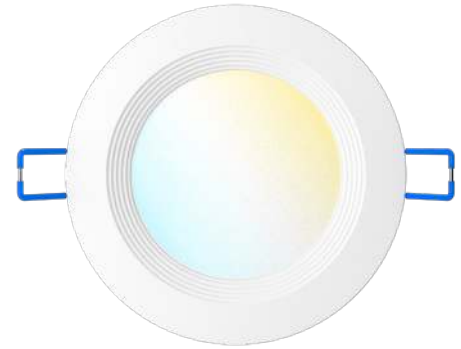

### EASY INSTALLATION



Turn Power OFF

1. Turn off circuit breaker that provides power to the light switch for the recessed lights.



4" Housing

Required Tools: Ladder, Drywall Saw, Wire Strippers.

2. Cut a hole in the ceiling in the desired location accordingly to the dimension indicated.

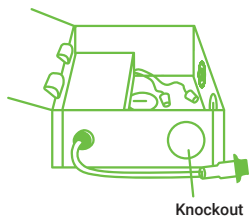

Knockout

3. Run electrical wire from the power source (switch) through the mounting hole.  
4. Open the junction box and remove the appropriate knockout(s) on the side plate.

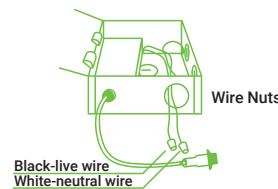

Wire Nuts

Black-live wire  
White-neutral wire

5. Connect the supply wires to the junction box wires using the wire nuts provided.

- White to white
- Black to black

6. Tuck the connected wires inside the junction box and close the cover.

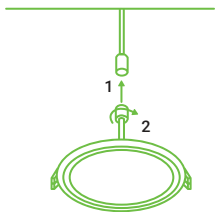

7. Connect the junction box to the slim down light. Tighten the connector by hand.

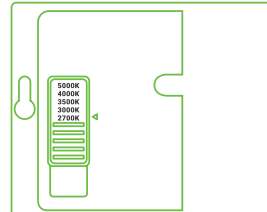

8. Turn on power and test light.

9. BEFORE PROCEEDING:

On back of j-box, slide the CCT Selection Switch to choose from five color temperatures (2700K, 3000K, 3500K, 4000K, 5000K). Try each CCT to determine which suits your room.

- Light will use the preferred setting whenever you turn on switch.
- Turn off light switch and continue install.

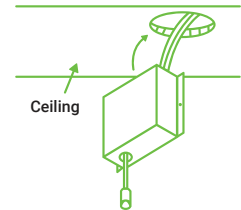

Ceiling

10. Insert junction box through the hole in the ceiling.  
• **New construction applications:** Hardwire box shall be secured to studs, joists, or similar fixed structural units.  
• **Remodel applications:** Do not require the hardwire box to be firmly secured after the mounting plates studs, joists, or structural units have been concealed.

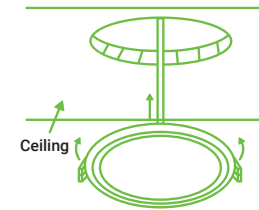

Ceiling

11. Push up the spring clips to insert the luminaire in the opening in the ceiling.  
12. Turn on circuit breaker and test the light.

### WARNING

- To reduce the risk of fire, electric shock or injury to people:
- This product should be installed in accordance with the applicable installation code by a person familiar with the construction and operation of the product and the hazards involved.
  - Abide by related regional and local laws or regulations.
  - Do not alter, relocate or remove wiring.
  - Do not make or alter any open holes in enclosure or electrical components.
  - Proper grounding is required to ensure safety.
  - Check for damage during shipping prior to install. If the product is damaged, do not use it.
  - Turn off the switch and circuit breaker before installing this LED light.
  - Use safety precautions. Safety eyeglasses and gloves are recommended.
  - Please review instructions carefully before proceeding.

### SPECIFICATIONS

Voltage	120V
Wattage	10W
Usage	Indoor
Housing	Polycarbonate
Weight	0.42 lbs
Warranty	7 years