

120W WALL PACK

Install Guide and Manual

COMPONENTS

- 
3X
Screws
- 
3X
Wall Anchors
- 
3X
Wire Nuts
- 
1X
Trim Plate
- 
1X
Attached Level
- 
1X
Attached Rubber Gasket



EASY INSTALLATION JUNCTION BOX INSTALLATION



- PRIOR TO INSTALL:**
- Prepare trim plate by removing knockouts.
 - Prepare backplate by removing center knockout.

- REQUIRED TOOLS:**
- Drill, Philips Screwdriver, Flathead Screwdriver, Junction Box, Caulking Tool & Caulk, Wire Stripper/Cutters

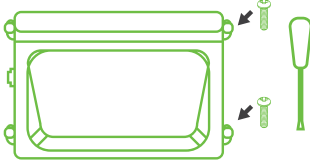

- 1. Turn off power at fuse or circuit breaker before installing or servicing.**
 - If you are replacing an existing HID/HPS fixture, allow fixture to cool before removing from the wall.
- 2. Open cover by unscrewing 2x door screws on side of wall pack, then lift off pinned hinges.**
 - Disconnect TP24 connector, if connected.

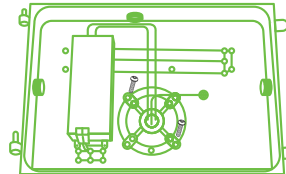

- 3. Drill 2x holes in base plate to match J-Box holes.**
- 4. Use internal level to position wall pack on wall.**

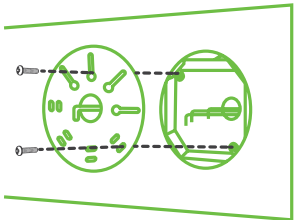

- 5. Slide trim plate between wall and back plate.**
 - Pull supply wires through center hole.
- 6. Align 2x holes in base plate with junction box. Secure base plate with 2x screws to wall.**

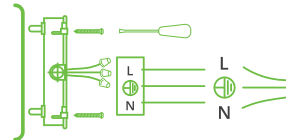

- 7. Connect internal wires to power supply using 3x wire nuts.**
 - Live to Live (black);
 - Neutral to Neutral (white);
 - Ground to Ground (yellow/green)

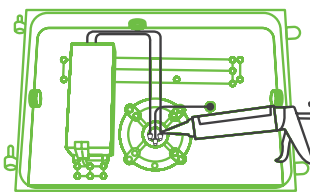

- 8. Seal 3x open holes with waterproofing material, such as caulk (not included).**

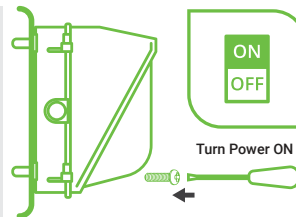

- 9. Slide cover onto base plate.**
- 10. Connect TP24 connector.**
- 11. Secure cover to back plate with 2x door screws.**
 - Ensure no wiring is pinched.
- 12. Turn ON power to verify successful installation.**

WARNING

- To reduce the risk of fire, electric shock or injury to people:
- This product should be installed in accordance with the applicable installation code by a person familiar with the construction and operation of the product and the hazards involved.
 - Abide by related regional and local laws or regulations.
 - Proper grounding is required to ensure safety.
 - Check for damage during shipping prior to install. If the product is damaged, do not use it.
 - Turn off the switch and circuit breaker before installing this LED light fixture.
 - Use safety precautions. Safety eyeglasses and gloves are recommended.
 - Please review instructions carefully before proceeding.

J-BOX COMPATIBILITY

This fixture is compatible with 4" octagon / square / round and 3.5" round new work / round old work junction boxes.

Our Wall Pack base plate includes 8 potential drilling holes. The outside circle includes a 3.54" (90mm) distance between holes. The inner circle holes are 2.76" (70mm) apart.

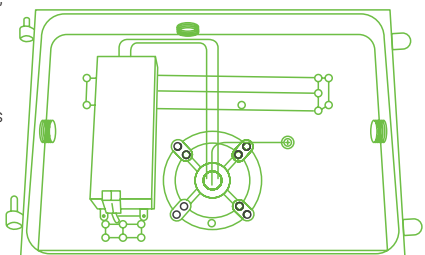

120W WALL PACK

Install Guide and Manual



COMPONENTS

- 
3X
Screws
- 
3X
Wall Anchors
- 
3X
Wire Nuts
- 
1X
Trim Plate
- 
1X
Attached Level
- 
1X
Attached Rubber Gasket

EASY INSTALLATION DIRECT MOUNT WITH CONDUIT



- PRIOR TO INSTALL:**
- Prepare trim plate by removing knockouts.
 - Prepare backplate by removing center knockout.

- REQUIRED TOOLS:**
- Drill, Philips Screwdriver, Flathead Screwdriver, Junction Box, Caulking Tool & Caulk, Wire Stripper/Cutters

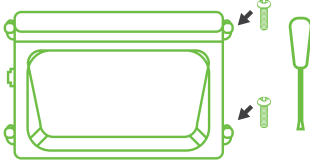

- 1. Turn off power at fuse or circuit breaker before installing or servicing.**
- If you are replacing an existing HID/HPS fixture, allow fixture to cool before removing from the wall.
- 2. Open cover by unscrewing 2x door screws on side of wall pack, then lift off pinned hinges.**
- Disconnect TP24 connector, if connected.

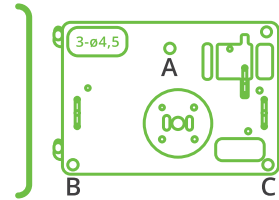

- 3. Drill 3x holes in base plate (A, B, C).**
IF REPLACEMENT: Skip to step #7.
IF NEW INSTALL:
- 4. Use internal level to position base plate on wall. Mark 3x drill points on wall to match baseplate holes (A, B, C).**
- 5. Drill 3x holes in wall.**
- 6. Add 3x wall anchors in drilled holes.**

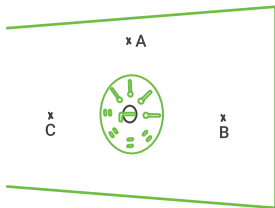

- 7. Slide trim plate between base plate and wall.**
- 8. Pull supply wires through center hole.**
- 9. Align 3x holes in base plate with wall anchors. Secure base plate with 3x screws to wall.**

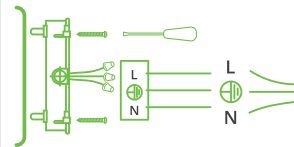

- 10. Connect internal wires to power supply using 3x wire nuts.**
- Live to Live (black);
 - Neutral to Neutral (white);
 - Ground to Ground (yellow/green)

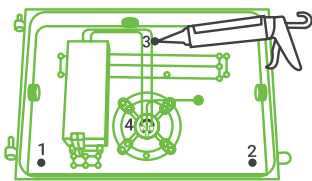

- 11. Seal 4x open holes for waterproofing with caulk (not included).**

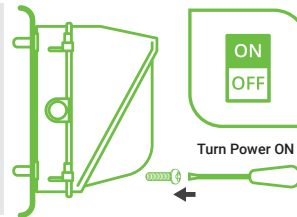

- 12. Slide cover onto base plate.**
- 13. Connect TP24 connector.**
- 14. Secure cover to back plate with 2x door screws.**
• Ensure no wiring is pinched.
- 15. Turn ON power to verify successful installation.**

WARNING

- To reduce the risk of fire, electric shock or injury to people:
- This product should be installed in accordance with the applicable installation code by a person familiar with the construction and operation of the product and the hazards involved.
 - Abide by related regional and local laws or regulations.
 - Proper grounding is required to ensure safety.
 - Check for damage during shipping prior to install. If the product is damaged, do not use it.
 - Turn off the switch and circuit breaker before installing this LED light fixture.
 - Use safety precautions. Safety eyeglasses and gloves are recommended.
 - Please review instructions carefully before proceeding.

SPECIFICATIONS

| | |
|-----------------------------|----------|
| Voltage | 120-277V |
| Wattage | 120W |
| Current | 1/0.44A |
| Power Factor | 0.97 |
| Lumens | 12000 |
| Color Temperature | 5000K |
| Color Rendering Index (CRI) | 80 |
| Beam Angle | 110° |