

Sunco

Lighting made better.

User Manual

5/6" LED

**Selectable Gimbal
Retrofit Downlight**

SKU: DL_G56-12W-27K_5K

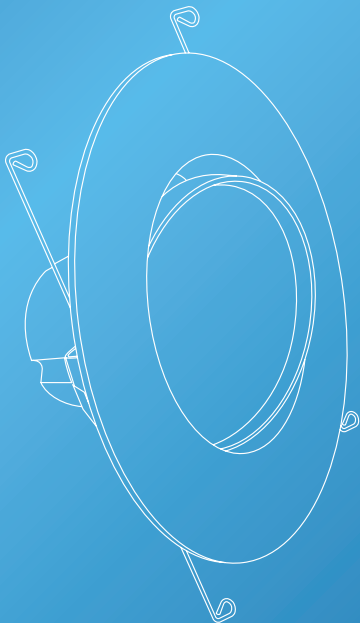

support@sunco.com
(844) 334-9938



What's in the Box?

Gimbal Downlight

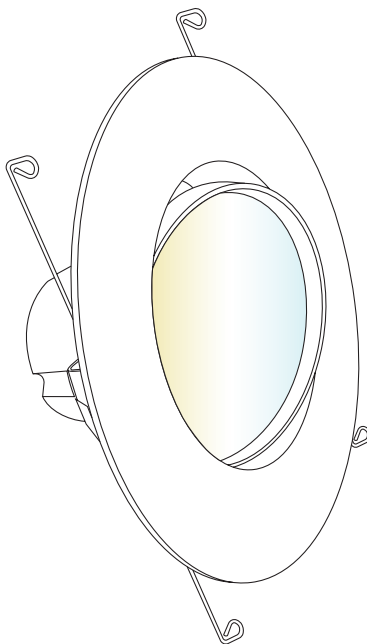

Let there be light!
(literally)



Light Fixture

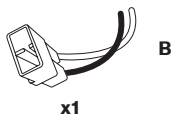

TP24 Connector

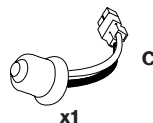

E26 Base

Before You Start

Safety Information

To reduce the risk of fire, electric shock, or physical injury:

- Turn off circuit breaker before installing this fixture.
 - This product should be installed by a person familiar with the construction and operation of the product and hazards involved. Safety eyeglasses and gloves are recommended.
 - Abide by related regional and local laws or regulations.
 - Proper grounding is required to ensure safety.
 - Do not alter, relocate, or remove wiring during installation.
 - Do not make or alter any open holes in wiring enclosure or electrical components during installation.
 - Check for shipping damage before installing. If the product is damaged, do not use it.
 - Keep fixture away from corrosive substances.
 - Suitable for damp locations at temperatures ranging from -4°F to 104°F. Not for use where directly exposed to water.
 - Clean the fixture regularly to ensure proper operation. Do not clean with harsh solvents.
- Use safety precautions and abide by regional and local laws or regulations.
 - This product is not compatible with 3rd party sensors.
 - This product is not compatible with photo controls.
 - This product is not compatible with occupancy sensors.
 - This product is not compatible with timing devices.



WARNING:

Cancer & Reproductive Harm - www.P65Warnings.ca.gov

This device complies with Part 15 of the FCC rules. Operation is subject to the following two conditions:

- 1) This device may not cause harmful interference.**
- 2) This device must accept any interference that may cause undesired operation. Please review all instructions carefully prior to installation.**

Quickstart Guide

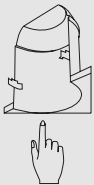

Step 1

Locate the recessed housing.

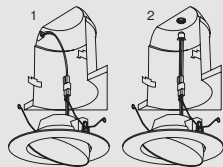

Step 2

Determine type of connector available.

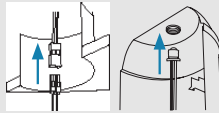

Step 3

Connect the adapter with lamp base connector.

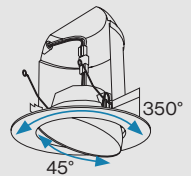

Step 4

Push down light into can until secure.

Installation Guide

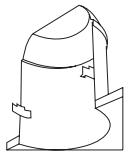

STEP 1

- Turn off the circuit breaker before installation.
- Locate the housing and remove the previous fixture.

NOTE: Light fixture may be hot! Allow time for fixture to cool after the power is off.

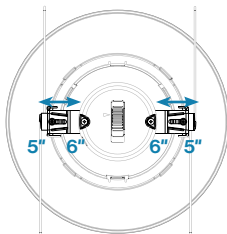

STEP 2

- Determine the size of the can opening (5" or 6").
- To adjust the spring brackets, loosen its screw, shift it to the 5 or 6 position, then tighten the screw.

(B)

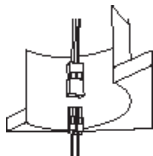

(C)

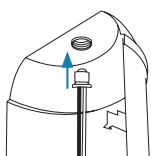

STEP 3

- Determine the type of connector available, then connect the wires.

(B) TP24 Connector

(C) E26 Base

Installation Guide (Cont.)

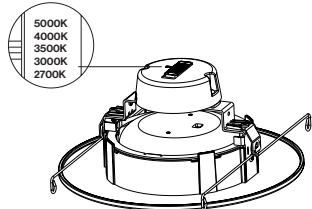

STEP 4

- a. Use the switch on the back of the retrofit to select one of five color temperatures.

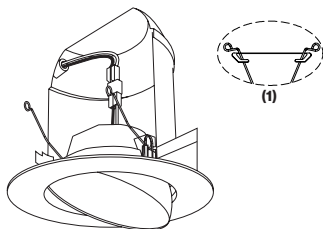

STEP 5

- a. Line up the trim ring with opening, then push the downlight into the can. Ensure that both ends of each spring are installed into the C-clips (1).

- b. Tuck all the wires into the can.

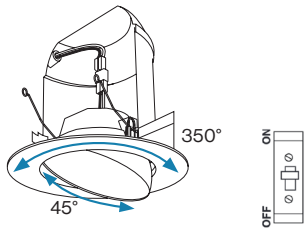

STEP 6

- a. Adjust the gimbal position to aim the light. The gimbal rotates 350° and tilts 45°.

- b. Turn on circuit breaker and test light.

Product Details

Recommended Dimmers

Brand	Model
LUTRON	AYCL-153P-WH
LUTRON	DVCL-153P-WH
LUTRON	MACL-153M-WH
LUTRON	PD-6WCL-WH-P
LUTRON	P-PKG1WB-WH
LUTRON	SCL-153P-WH
LEVITON	D26HD-2RW
CLOUDY BAY	CBLD001WHA
KASA SMART	HS220

Scan for the full compatible dimmer list!



Specifications

Voltage	120 V	Average Lifetime	50,000 Hours
Wattage	12 W	Lumens	800 lm
Beam Angle	90°	Moisture Rating	Damp Rated
Efficacy	67 lm/W	CRI	80+
Weight	0.75 lbs	Usage	Indoor
Housing Material	PC	IC Rated	No
Dimmable	Yes	Warranty	7 Years

Common Troubleshooting

Feeling in the dark about an issue with your product? No worries! Our troubleshooting section is here to shed some light and provide you with easy-to-follow solutions for any problem.

If you still need some assistance, please feel free to contact us with any questions. Our team of lighting experts are happy to help brighten your day.

Installation

Light isn't turning on.

Double check if fixture is properly connected and circuit breaker hasn't been tripped.

Light isn't bright enough.

Check proper wattage and for unobstructed fixture.

Dimming

Light not dimming to lowest setting.

Ensure minimum dimmer load requirement is met.

Light not dimming smoothly.

Verify dimmer compatibility with fixture.

Light not compatible with dimmer switch.

Check light-dimmer compatibility. Consider purchasing compatible switch if necessary.

Common Troubleshooting

Flickering

Light is flickering when turning on.

Check that fixture wiring connections are secure.

Light flickering with other lights on the same circuit.

Check that the lights on the same circuit are not overloading the circuit.

Light flickering when turned on.

Verify fixture compatibility and that it is grounded.

Light flickering when dimmed.

Verify dimmer switch compatibility.

Buzzing

Fixture buzzing with power outages.

Verify light is connected to surge protector securely.

Fixture buzzing with appliances or electronic devices.

Look for nearby interferences that can cause buzzing. Such as televisions, radios, computers, etc.

Fixture buzzing when dimmed.

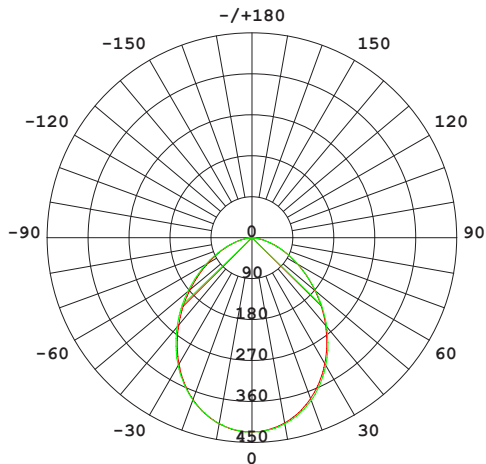

Verify dimmer switch compatibility.

Light Distribution Angle



*Not a lighting nerd?
No worries, you can skip this page*

AVERAGE BEAM ANGLE (50%): 91.1 DEG

	CO/180	90.5°
	C90/270	91.8°

UNIT:cd Luminous Intensity Distribution 1

Lighting distribution angle refers to the spread of light emitted from a light source. It is an important factor to consider when selecting a fixture or bulb, as it affects the way it will illuminate an area. There are two main types of lighting distribution angles:

A symmetric lighting distribution emits light evenly in all directions, creating a cone-shaped pattern that provides a pool of light. This type of lighting is ideal for general lighting and illuminating large areas. Common applications for symmetric lighting include general area illumination, security lighting, and perimeter lighting. Symmetric lighting is also used to a certain degree in up-lighting.

An asymmetric lighting distribution angle, also known as beam angle, creates a pattern that focuses light in a specific direction. This type of lighting is ideal for task lighting as it reduces glare and light spill in other areas. Common applications include task lighting in spaces such as landscape settings, retail stores, museums, and much more.

It is important to note that the lighting distribution angle can also be affected by other factors such as the reflector design of the light source, the type of lens used, and the distance between the light source and the surface being illuminated.

Sunco

Lighting made better.

support@sunco.com
(844) 334-9938

REV1.0