

23.8" 100HZ Portable Monitor w/Stand

User Manual



In order to ensure your safe use of this product, please read this manual carefully before using this product and keep it properly.



Email: uperfectglobal02@163.com



Chapter 01 Preparations

Checking the Package Contents



Portable Monitor



Power Adapter



User Guide



HDMI Cable



Type-C to Type-C Cable

Note:

- If any of the above items is damaged or missing, please contact us immediately. (support@uperfect.com)
- The appearance of the components may differ from the images shown.

The functions of the bracket & keyboard

The bracket supports 180° opening up.



0°~180° Adjustable



Interface Function Introduction

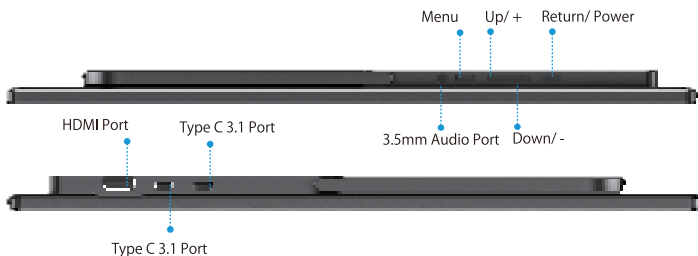

A. 3.5mm Audio Port

Headphone/ Sound Box Extension Port

B. Menu

Press to enter the OSD menu or confirm your setting

C. Up/ +

Press to quick adjust Volume/ Go to former step/ Turn up

D. Down/ -

Press down to quick adjust Brightness/ Go to next step/ Turn down

E. Return/ Power

Press to return to the former step or exit menu setting and turn off the monitor
Long press to turn off the monitor

F&G. Type C 3.1 Port

Full featured Type C port. For signal and power transmission.

H. HDMI Port

For audio and video signal transmission

I. VESA

4 M4*6mm VESA holes

Chapter 02 Specifications

Color	Black
Model	M238F01-J
Resolution	1920*1080
Brightness	300 cd/m ²
Color Gamut	100% sRGB
Display Color	8 Bit
VESA	M4*6mm
Interfaces	HDMI
	Type C 3.1 Port * 2
	3.5mm Audio Port
	Micro USB-B OTG Port
Panel Type	IPS
Refresh Rate	100Hz

Chapter 03 Connecting

TYPE-C signal transfer

Note: For a more stable power supply, it is recommended to use our original power adapter to power.

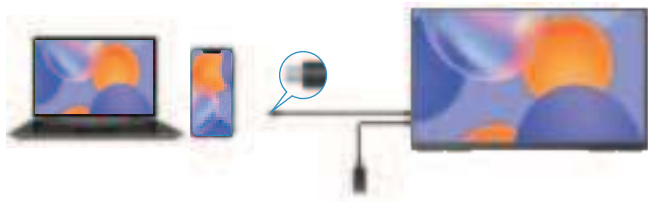

HDMI signal transfer

Note: For a more stable power supply, it is recommended to use our original power adapter to power.

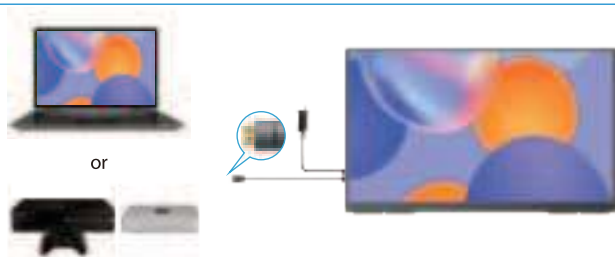

Chapter 04 Screen Adjustment

On-Screen Display Menu Introduction

PICTURE



COLORSETTINGS

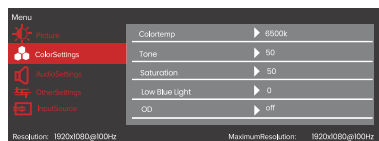

AUDIOSETTINGS

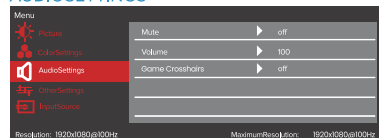

OTHERSETTINGS

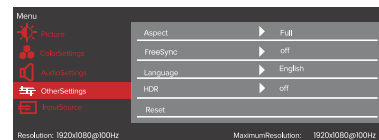

INPUTSOURCE

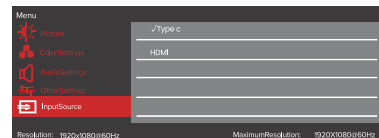

Chapter 05 Setting Up(Windows10)

Extend Mode / Duplicate Mode/ Display Mode

Way1: Set on the device's Display Settings

A: Verify that your cables are connected properly to the new monitors.

B: Right-click anywhere on your desktop and select Display settings to open the Display page.

C: Scroll down to Multiple displays, then select an option from the drop-down list to determine how your desktop will display across your screens. For the largest work area, select Extend desktop.

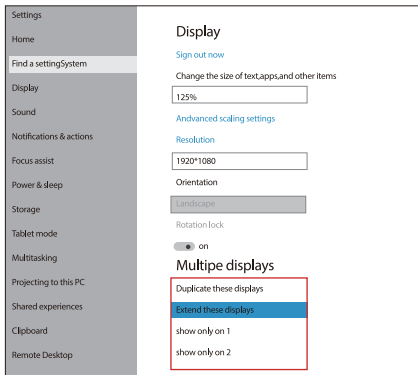

Note: If you cannot see the additional monitor(s) listed, click Detect. If does not work, try restarting your computer and do steps again.

Way2: Set via Windows key + P keyboard shortcut

A: Enter the "Windows" key and "P" keyboard at the same time.

B: select an option from the drop-down list to determine how your desktop will display across your screens.

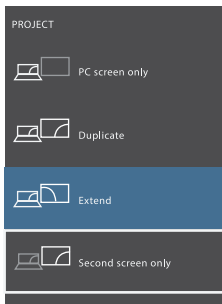

Rotate the Screen

- 1: Right-click anywhere on your desktop and select Display settings to open the Display page.
- 2: Under the "Select and rearrange displays" section, select the monitor that you want to adjust.
- 3: Under the "Scale and layout" section, use the Orientation drop-down menu to select Landscape or Portrait screen.

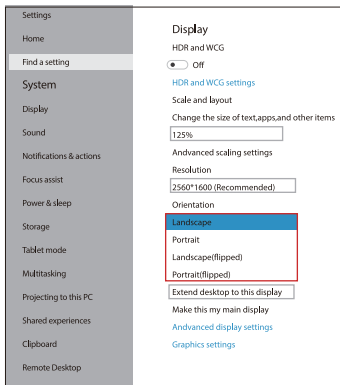

Chapter 06 Q&A

Important Tips:

If you find any issues with your monitor, please contact us at support@uperfectmonitor.com before returning it. We will help you solve your problems and try our best to make you satisfied. We take full responsibility for our products.

If there are any defects that cannot be solved, we will refund or send you a replacement.

Q: Why does my monitor not turn on?

1. Please check whether the Type-C port of your device is a full-featured Type-C port, which can support power and signal transmission. If not, please use HDMI to Mini HDMI cable to transmit video signal, and use USB-C to USB-C cable to connect external power supply.
2. This may be caused by insufficient power supply. The minimum power requirement for the monitor is PD 18W. Especially when you need to run the display at 2K 120hz, the power consumption will be relatively large, it is recommended to use an external power supply, otherwise the monitor may not work properly.
3. If the above steps still cannot solve your issue, please feel free to contact us.

Q: It says "no signal", what to do?

1. When connecting with a USB-C cable, make sure your device supports USB3.1./Thunderbolt 3. If not, please add a Mini HDMI to HDMI cable for signal transmission.
2. Please make sure to use the original cables.
3. Please try another device. If it still fails, please tell us for a replacement.

Q: Why does my monitor turn off when I turn up the brightness?

This is caused by insufficient power supply. Turning up the brightness will increase the power consumption, which can be solved by an external power supply.

Q: Abnormal conditions occurred - such as a splash screen, spots when using the monitor or constant restarts.

1. It is generally caused by an insufficient power supply. The monitor require high power support. Please use the original cable included to power the monitor.
2. If you use a mobile power bank to power the monitor, please confirm whether the power of the power bank reaches 30W or more. In addition, if you need a power bank, please contact us at support@uperfectmonitor.com
3. If none of the above solutions work, please try another device. If it still failed, please contact us for a replacement.

Chapter 07 Service Support

Dear Customer,

Thank you for purchasing the Portable USB Monitor!

We offer 100% money back guarantee in 30 days and 90 days replacement, 12 month warranty for any issue, professional tech support to ensure no-worry service.

Any query or problem, please contact us via support@uperfect.com

