

Owner's Manual

40FT Container House

I. Product Model

No.	Standard	Product No.	Model No.
1	American Standard (110V)	1002420400140080A001	002-20-4001A-US
2	British standard (220V)	1002320400140080A001	002-20-4001A-UK
3	Australian Standard (240V)	1002220400140080A001	002-20-4001A-AUS

II. Layout

1. Plan sketch

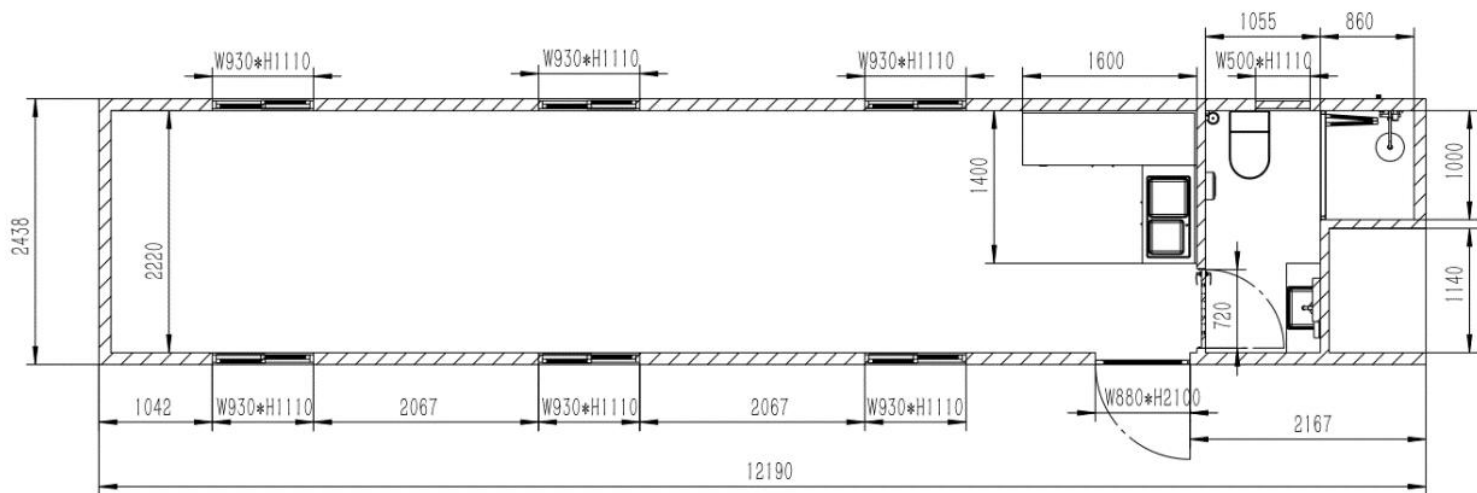

2. Circuit diagram

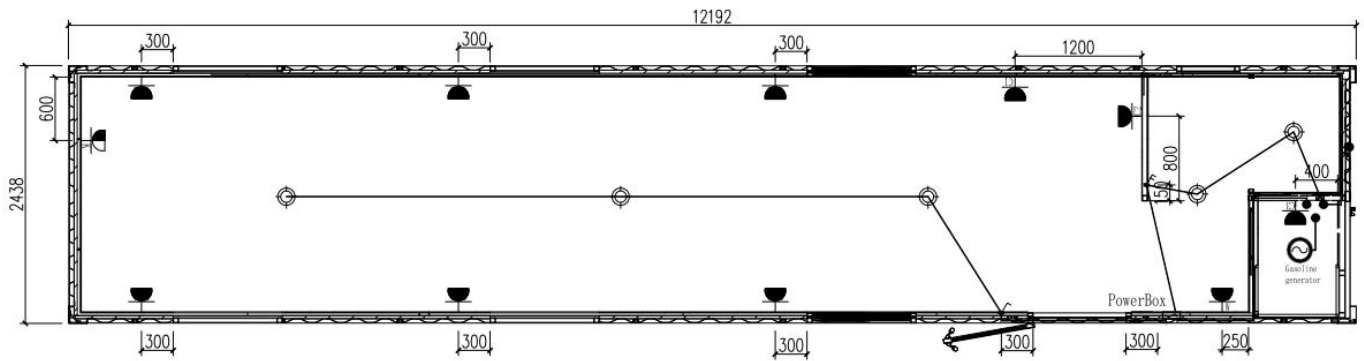

Electrical and Lighting

CODING	THE NAME OF THE MATERIAL	LEGEND	NOTES
1	PowerBox		bottom to 2100mm
2	Ceiling lamp		bottom to 2590mm
3	Single link single control switch		bottom to 1530mm
4	Double link single control switch		bottom to 1530mm
5	Concealed socket switch		bottom to 1100mm
6	Air conditioning socket		bottom to 1800mm
7	Toilet socket		bottom to 1530mm
8	Kitchen socket		bottom to 920mm
9	Kitchen socket		bottom to 1200mm
10	Equipment socket		bottom to 800mm
11	Gasoline generator		

3. Waterway diagram

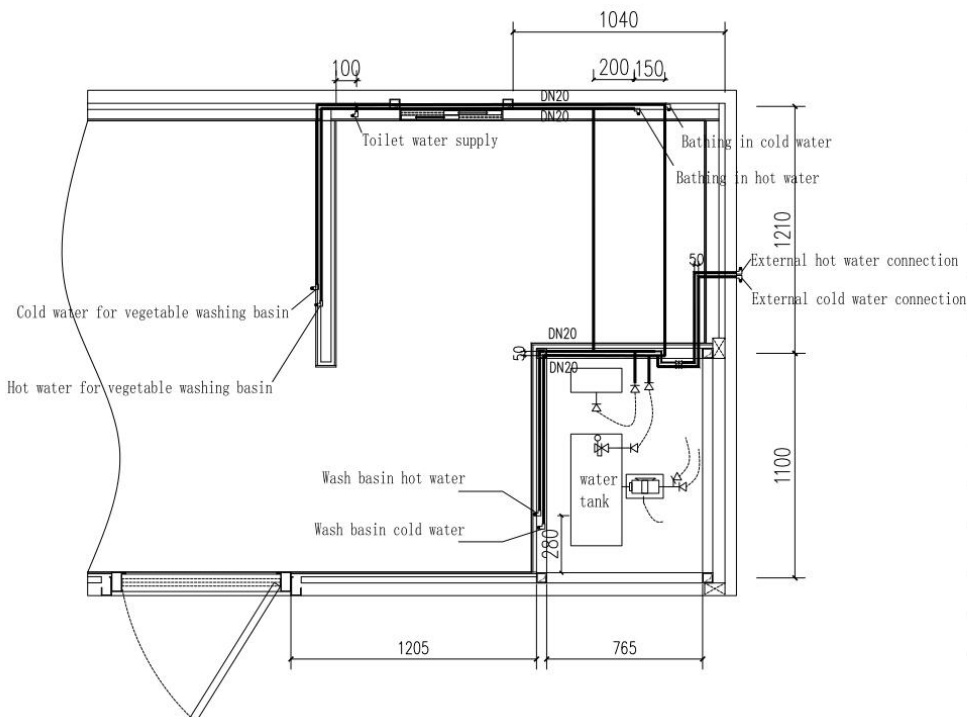

CODING	THE NAME OF THE MATERIAL	LEGEND
1	hot water pipe	
2	90 degree elbow	
3	90 degree internal thread elbow	
4	90 degree external thread elbow	
5	tee	
6	inner thread tee	
7	bridge elbow	
8	ball valve	
9	Metal baided hose	
10	water pump	
11	water tank	

Layout of cold and hot horizontal planes

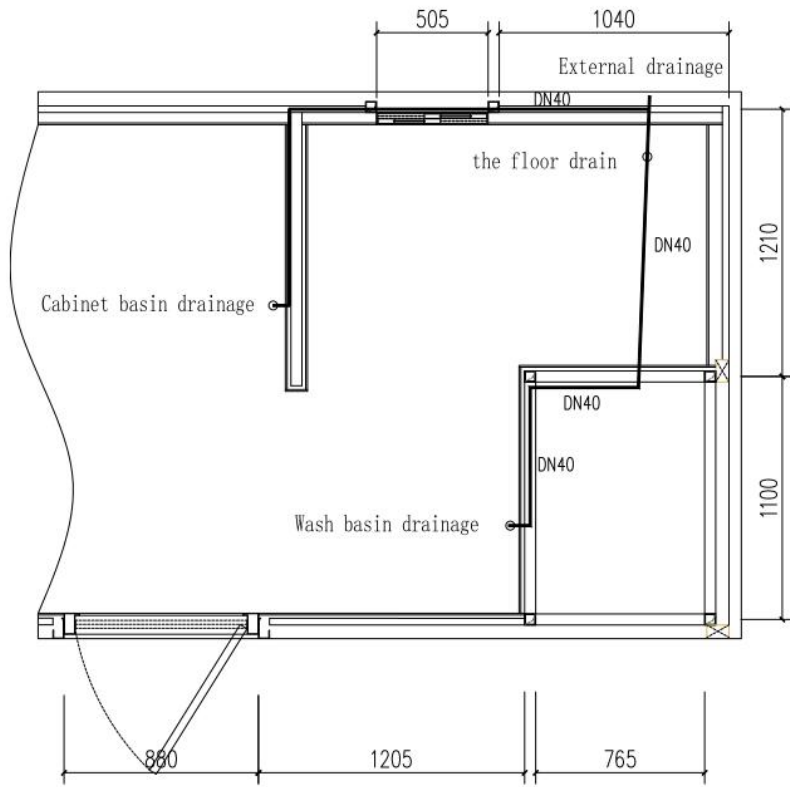

Drainage layout plan

III. Specifications

1. **Overall Dimension:**L12190mm*W2440mm*H2900mm (L40FT*W8FT*H10FT)
2. **Package size:**L12190mm*W2440mm*H2900mm (L40FT*W8FT*H10FT)
3. **Main Structure:**
 - ▶ Main Part: 40HQ Container steel structure,light gray RAL7035
 - ▶ Wallboard: 50mm TPS board+9mm wood-plastic composite board
 - ▶ Roof board: 50mm TPS board+9mm wood-plastic composite board
 - ▶ Floor: 15MM ecological board+3MM anti slip and wear-resistant plastic-flooring
 - ▶ Doors and Windows: white broken bridge aluminum outward-opening window/white broken bridge aluminum sliding window/burglarproof door/wood door
 - ▶ Bathroom : ventilating fan/closestool/wash basin/mirror cabinet/Shower head/folding shower partition/floor drain/UV board
 - ▶ Furniture: L-shaped combination cabinet (with double kitchen basins)

- ▶ Drain off Water: water tank (200L) /cold-hot water1/2"/drain Φ 40/toilet discharge Φ 125
- ▶ Power Distribution: circuit breaker/ceiling light/switch/socket
- ▶ Attachment: X

4. Configuration Table:

Name	Specifications
Aviation Socket	16A
Circuit Breaker	
Ceiling Light	LED ceiling light (moistureproof, dustproof, anti-mosquito)、265mm、18W、6000K、circle
Switch	unilateral switch/biswitch
Socket	Three-hole
Louver Ventilating Fan	Louver Ventilating Fan
Dynamo	3000W
Water tank booster pump	180W
Burglarproof Door	burglarproof door,870×2095, thickness100,white
Wood Door	Wood door,W720×H1960,thickness 40, XFJ-019, white
Broken Bridge Aluminum Outward-opening Window	Broken Bridge Aluminum Outward-opening Window,W500×H1110,white,double layer hollow tempered glass
Broken Bridge	broken bridge aluminum sliding window,W930×H1110,WHITE,double layer

Aluminum Siding Window	hollow tempered glass, screen window
Curtain	Roller window shades, curtain size1190×1200,aluminum alloy cover,crescent aluminum lower rail,bead pulling system
L-shaped combination cabinet	L-shaped combination cabinet,1600×1400×W500×H900,quartz worktop, with double kitchen basins
Wash-basin	W405×L305×H130,white,cabinet, mirror box
Shower Faucet	Shower Faucet
Shower Partition	Folding shower partition,W995×H2050, double folding door
Ceramic Toilet	Ceramic Toilet
Water Tank	830×500×500,white,200L
Hot Cold Water Inlet Pipe	20PPRpipe, Joint specification 20*1/2
Drain-pipe	40PVC pipe

5. **Fire Resistance:** A1/B2 (Optional)

IV. Localized illustrations and additional notes

V. Product replaceable parts list

No.	Name	Specifications
1	Aviation Socket	16A
2	Circuit Breaker	
3	Ceiling Light	ceiling light (moistureproof, dustproof, anti-mosquito) ,265mm,18W,6000K, circle
4	Switch	unilateral switch/biswitch

5	Socket	Three-hole
6	Louver Ventilating Fan	Louver Ventilating Fan
7	Dynamo	3000W
8	Water Tank Booster Pump	180W
9	Wood Door	Wood Door, W720×H1960, thickness 40, XFJ-019, white
10	Broken Bridge Aluminum Outward-opening Window	Broken Bridge Aluminum Outward-opening Window, W500×H1110, white, double layer hollow tempered glass
11	Broken Bridge Aluminum Siding Window	Broken Bridge Aluminum Siding Window, W930×H1110, white, double layer hollow tempered glass, screen window
12	Curtain	Roller window shades, curtain size 1190×1200, aluminum alloy cover, crescent aluminum lower rail, bead pulling system
13	Shower Partition	Folding shower partition, W995×H2050, double folding door
14	Wash-basin	W405×L305×H130, white
15	Shower faucet	Cold-hot water faucet
16	Basin Drainer	Basin drainer, stainless steel
17	S-shaped sewer pipe	S-shaped sewer pipe, gray
18	Shower Nozzle	Shower Nozzle
19	Soap Net	Soap Net

20	Toilet	Side toilet
21	Toilet Brush	Toilet Brush
22	Tissue Holder	Tissue Holder,Stainless steel
23	Water Tank	830×500×500, white, 200L

KEEP THESE OWNER'S MANUAL FOR FUTURE REFERENCE.