



YOSHIMURA

RESEARCH&DEVELOPMENT OF AMERICA, INC.

5420 DANIELS STREET STE A, CHINO CA., 91710 · (800) 634-9166 · (909) 628-4722 · FAX (909) 591-2198

www.yoshimura-rd.com

MICRO TURN SIGNAL ADAPTER PLATES

Honda Grom 074BG121220

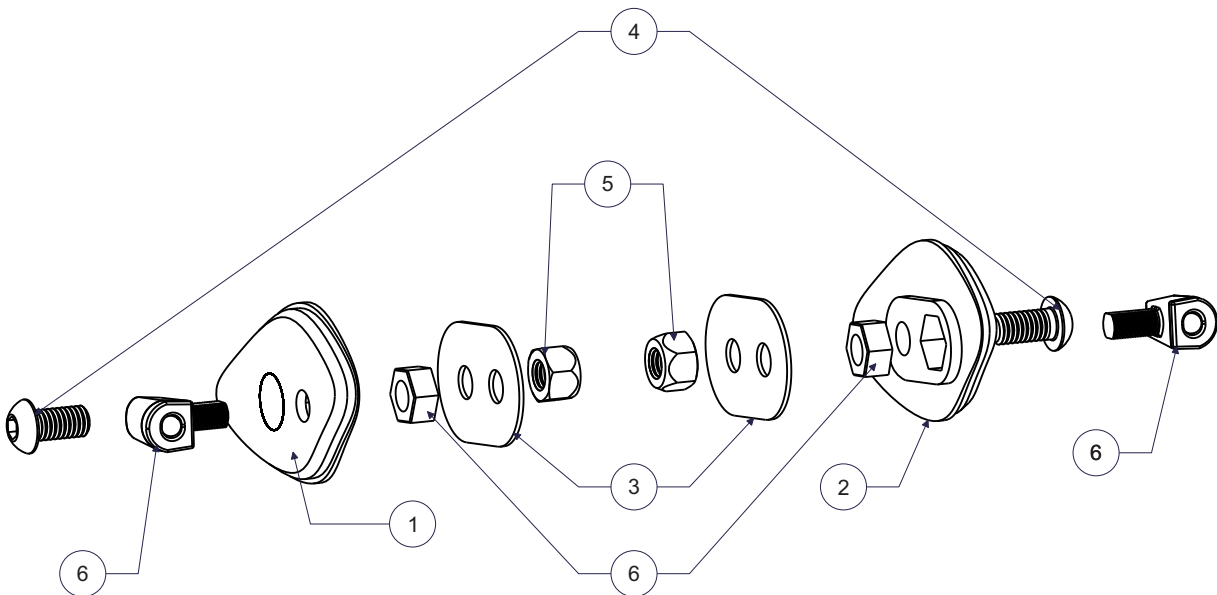

No.	Item	Description	Qty.
1	074BG121220-R	Right Front Turn Signal Plate	1
2	074BG121220-L	Left Front Turn Signal Plate	1
3	074BG121210-B	Turn Signal Backing Plate	2
4	M6X12BHS	6mm x 12mm Button Head Cap Screw	2
5	6MMLN	M6 X 1.0 Nylon Lock Nut	2
6	072BGMICRTSR	Micro LED Turn Signal Kit	1

Removal

1. Remove the four bolts securing headlight assembly to frame and carefully pull out headlight assembly.
2. Locate and disconnect left and right turn signal connectors.
3. Remove meter cover by unscrewing the two bolts on the underside and gently pull down. Locate and unscrew the cap nut holding the turn signal in place.
4. Disassemble and remove left and right turn signals from turn signal holder.
5. Cut the stock turn signal wires 4" from the connector.

Left Turn Signal Plate

Front of Bike

Rear of Bike

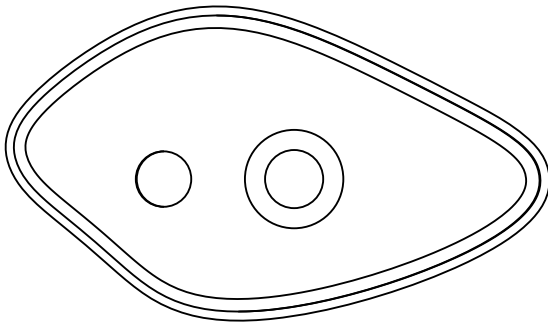

Right Turn Signal Plate

Rear of Bike

Front of Bike

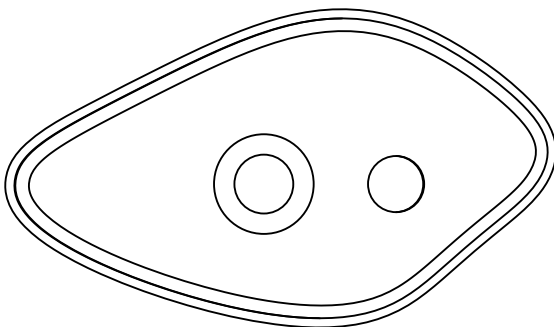

Installation

1. Place the micro turn signal in the front hole and plastic hex nut in inside pocket of *074BG121220-R* right, front turn signal plate.

Note: Proper positioning of the micro turn signal in the adapter plate is dependent on the orientation of the plastic nut. If the turn signal is not facing forwards, remove and rotate the plastic nut in the adapter plate pocket and re-install the turn signal. Repeat until turn signal is facing forward.

Rear of Bike

Front of Bike

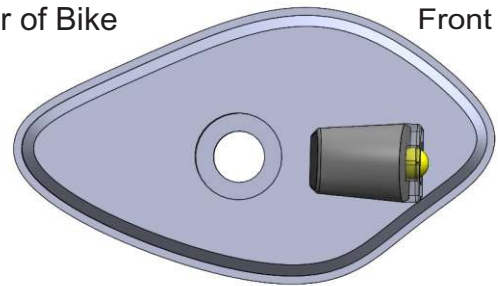

Right Turn Signal

2. Install the micro turn signal and front turn signal plate *074BG121220-R* onto the outside of turn signal bracket. Install *074BG121220-B*, turn signal backing plate on inside of turn signal holder and secure using *M6X12BHS* screw and *6MMLN* lock nut.

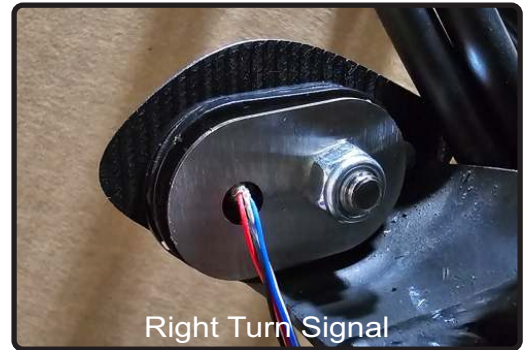

3. Repeat steps for opposite side.

4. Re-install the meter cover by lining up the cover with the back of the meter. Make sure cover is resting on the front side of *074BG121220* to ensure best fit. Re-install back cover screws on meter display.



5. Using the solder shrink connectors supplied in the micro turn signal kit, connect turn signal wires to micro light wires as follows:

Right (Blue Connector):

Green (Harness) - Black
Blue (Harness) - Blue

Left (Orange Connector):

Green (Harness) - Black
Orange (Harness) - Blue

- a) Strip the stock turn signal wire ends 1/4" - 1/2" and insert into *BN-SSS-22-18*, solder shrink connectors provided in the kit.
- b) Center the spliced wire ends in the middle and using a heat gun or lighter, apply heat evenly on the outer edges of the solder shrink connector to shrink and hold wires in place.
- c) Making sure that the stripped ends are centered, heat the center of the solder shrink connector evenly until the solder begins to liquify.
- d) Allow to cool completely and tug both ends of the wires to verify that connection is secured.

Scan for link to solder shrink connector instruction video.



Scan QR code on micro turn signal packaging for wiring diagram.

Note¹: The white running light wire and red brake light wire on the micro signals will not be used. Bundle back up and tuck away.

Note²: A red front light is prohibited in most states. Check with local laws and regulations prior to installation.

6. Re-install headlight assembly using the four stock bolts.
7. Check for proper function of headlight, turn signals, and that all components are secure prior to riding.